

**United States Department of the Interior
Heritage Conservation and Recreation Service**

**National Register of Historic Places
Inventory—Nomination Form**

See instructions in *How to Complete National Register Forms*
Type all entries—complete applicable sections

1. Name

historic Homeplace

and/or common

2. Location

N of Washington on LA 182

street & number La. Hwy. 182 ___ not for publication

city, town Washington vic. Beggs ___ vicinity of congressional district 6th - Gillis W. Long

state La. code 22 county St. Landry code 097

3. Classification

Category	Ownership	Status	Present Use	
<u>___</u> district	<u>___</u> public	<u>X</u> occupied	<u>___</u> agriculture	<u>___</u> museum
<u>X</u> building(s)	<u>X</u> private	<u>___</u> unoccupied	<u>___</u> commercial	<u>___</u> park
<u>___</u> structure	<u>___</u> both	<u>___</u> work in progress	<u>___</u> educational	<u>X</u> private residence
<u>___</u> site	Public Acquisition	Accessible	<u>___</u> entertainment	<u>___</u> religious
<u>___</u> object	<u>___</u> in process	<u>X</u> yes: restricted	<u>___</u> government	<u>___</u> scientific
	<u>___</u> being considered	<u>___</u> yes: unrestricted	<u>___</u> industrial	<u>___</u> transportation
		<u>___</u> no	<u>___</u> military	<u>___</u> other:

4. Owner of Property

name J. T. Stephenson

CONTINUED

street & number Homeplace Rt. 2, Box 76-A

city, town Bunkie, ___ vicinity of state Louisiana

5. Location of Legal Description

courthouse, registry of deeds, etc. St. Landry Parish Courthouse

street & number

city, town Opelousas state Louisiana

6. Representation in Existing Surveys

title La. Historic Sites Survey has this property been determined eligible? ___ yes X no

date 1980 ___ federal X state ___ county ___ local

depository for survey records La. State Historic Preservation Office

city, town Baton Rouge state Louisiana

7. Description

Condition excellent good fair deteriorated ruins unexposed**Check one** unaltered altered**Check one** original site moved

date _____

Describe the present and original (if known) physical appearance

Homeplace plantation is set amid the flat cotton country north of the town of Washington. The hall-less plan has two large rooms front and rear with a small staircase in one of the rear rooms. The two front rooms are entered from the front gallery through a pair of front doors each of which is flanked by a pair of six over six windows. The three bay front gallery is constructed with Doric posts and a balustrade composed of small square posts placed at angles to each other. The front fenestration has shoulder molded frames with pediment shaped tops. The front roofline features two large dormers which are framed in aedicule motifs with cyma recta moldings and crowning pediments. The interior features unusually low ceilings and a chimney set against the end walls with simple aedicule mantles which have cyma recta moldings. In the early twentieth century the rear gallery was enclosed. More recently this enclosed area had been expanded to create a kitchen-family room space. This extension is low in scale and has little visual impact when the house is viewed from the front.

8. Significance

Period	Areas of Significance—Check and justify below			
<input type="checkbox"/> prehistoric	<input type="checkbox"/> archeology-prehistoric	<input type="checkbox"/> community planning	<input type="checkbox"/> landscape architecture	<input type="checkbox"/> religion
<input type="checkbox"/> 1400–1499	<input type="checkbox"/> archeology-historic	<input type="checkbox"/> conservation	<input type="checkbox"/> law	<input type="checkbox"/> science
<input type="checkbox"/> 1500–1599	<input type="checkbox"/> agriculture	<input type="checkbox"/> economics	<input type="checkbox"/> literature	<input type="checkbox"/> sculpture
<input type="checkbox"/> 1600–1699	<input checked="" type="checkbox"/> architecture	<input type="checkbox"/> education	<input type="checkbox"/> military	<input type="checkbox"/> social/ humanitarian
<input type="checkbox"/> 1700–1799	<input type="checkbox"/> art	<input type="checkbox"/> engineering	<input type="checkbox"/> music	<input type="checkbox"/> theater
<input checked="" type="checkbox"/> 1800–1899	<input type="checkbox"/> commerce	<input type="checkbox"/> exploration/settlement	<input type="checkbox"/> philosophy	<input type="checkbox"/> transportation
<input type="checkbox"/> 1900–	<input type="checkbox"/> communications	<input type="checkbox"/> industry	<input type="checkbox"/> politics/government	<input type="checkbox"/> other (specify)
		<input type="checkbox"/> invention		

Specific dates c. 1826

Builder/Architect

Statement of Significance (in one paragraph) Criterion C

Homeplace plantation house is significant in the area of architecture as an unusually grand version of the normally unpretentious Creole raised cottage form. It has the classic plan two rooms wide with no hall, but with the addition of handsome Greek Revival features such as pedimented aedicule dormers, Doric gallery posts, shoulder molded fenestration and cyma recta molded mantels. This type of house, with its two front rooms and two front doors, was usually an urban residence or a plantation dependency. It is unusual to see it enlarged to the scale of a full blown plantation house as it is at Homeplace.

9. Major Bibliographical References

Title Abstract, St. Landry Parish Courthouse

10. Geographical Data

UTM NOT VERIFIED
ACREAGE NOT VERIFIED

Acreage of nominated property approx. 1/2 acre

Quadrangle name _____

Quadrangle scale _____

UMT References

A

1	5	5	9	0	2	8	0	3	3	9	4	2	2	0
Zone			Easting				Northing							

B

Zone			Easting				Northing							

C

Zone			Easting				Northing							

D

Zone			Easting				Northing							

E

Zone			Easting				Northing							

F

Zone			Easting				Northing							

G

Zone			Easting				Northing							

H

Zone			Easting				Northing							

Verbal boundary description and justification

See sketch map

List all states and counties for properties overlapping state or county boundaries

state code county code

state code county code

11. Form Prepared By

name/title J. T. Stephenson

CONTINUED

organization

date June 1980

street & number Rt. 2, Box 76-A

telephone

city or town Bunkie

state Louisiana 71322

12. State Historic Preservation Officer Certification

The evaluated significance of this property within the state is:

national state local

As the designated State Historic Preservation Officer for the National Historic Preservation Act of 1966 (Public Law 89-665), I hereby nominate this property for inclusion in the National Register and certify that it has been evaluated according to the criteria and procedures set forth by the Heritage Conservation and Recreation Service.

State Historic Preservation Officer signature

Robert B. DeBlieux

Robert B. DeBlieux

title State Historic Preservation Officer

date 8/6/80

For NCRS use only
I hereby certify that this property is included in the National Register.

John G. ...
Keeper of the National Register

date 8/1/80

Chief of Registration

date

FHR-8-300A
(11/78)

UNITED STATES DEPARTMENT OF THE INTERIOR
HERITAGE CONSERVATION AND RECREATION SERVICE

**NATIONAL REGISTER OF HISTORIC PLACES
INVENTORY -- NOMINATION FORM**

FOR HCRS USE ONLY	
RECEIVED	AUG 13 1980
DATE ENTERED	

CONTINUATION SHEET

ITEM NUMBER 4 PAGE 2

Owners (Continued)

Dr. Richard T. Stephenson
2123 Perkins Road
Baton Rouge, La.

FHR-8-300A
(11/78)

UNITED STATES DEPARTMENT OF THE INTERIOR
HERITAGE CONSERVATION AND RECREATION SERVICE

**NATIONAL REGISTER OF HISTORIC PLACES
INVENTORY -- NOMINATION FORM**

FOR HCRS USE ONLY
RECEIVED AUG 13 1980
DATE ENTERED

CONTINUATION SHEET

ITEM NUMBER 11

PAGE 2

Form Prepared By (Continued)

Dr. Richard T. Stephenson
2123 Perkins Road
Baton Rouge, La.

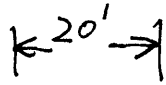

AUG 13 1980

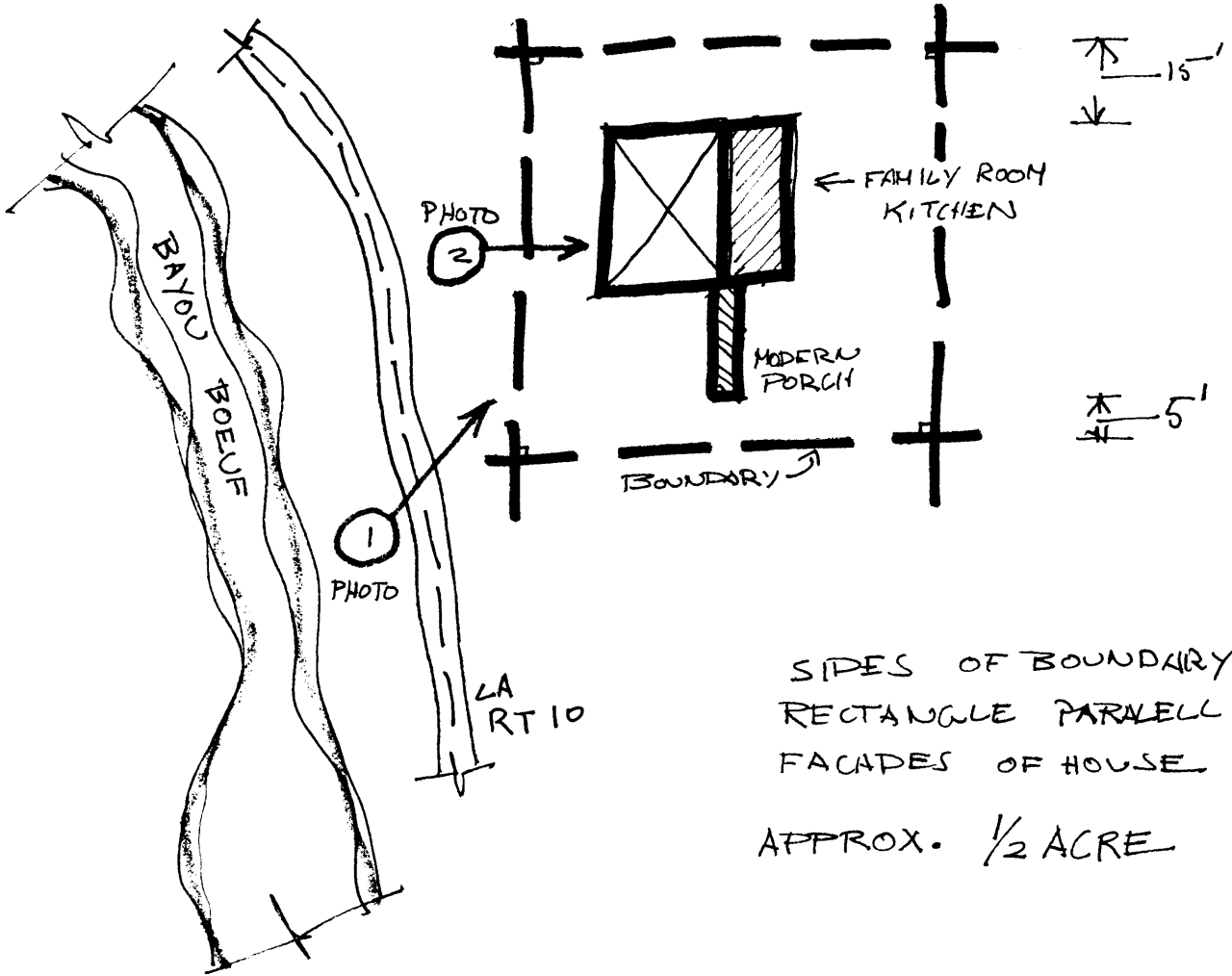

SIDES OF BOUNDARY
RECTANGLE PARALLEL
FACADES OF HOUSE
APPROX. 1/2 ACRE