

1. Historic Name (s) FROST FARM		22. Map & Lot No. 3 - 39	
Original Owner Benjamin Frost		23. Original Range/Lot 1 - 5 - 3	
Present Name FROST FARM		24. U.S.G. S. Quadrant (15'/75') Monadnock	
3. Owner's Name Carl Niemela		25. UTM Reference 18 742900 4750570	
4. Owner's Address Route 2, Box 83 Peterborough, N.H., 03458		Zone Easting Northing	
5. Location Korpi Road		26. Zoning: Rural <input checked="" type="checkbox"/> Village <input type="checkbox"/>	
6. Open to Public Yes No <input checked="" type="checkbox"/>	7. Visible from road Yes <input checked="" type="checkbox"/> No	8. Ownership Private <input checked="" type="checkbox"/> Local State Institutional	27. Prehistoric Site Object Historic Site Structure Building <input checked="" type="checkbox"/>
9. Local Contact/Organization Dublin Conservation Commission		28. Significance Evaluation	

11. Architect	29. Theme Primary Agriculture Secondary Settlement Other Ethnic development
12. Builder Benjamin Frost	30. Endangered Yes No <input checked="" type="checkbox"/>
13. Date 1806	31. Original Site <input checked="" type="checkbox"/> Moved <input type="checkbox"/>
14. Style Cape Colonial (Altered)	32. Major Alterations & Date 1901 & 1914 alterations 1950's, roofline raised, new chimney
15. Original Use Farmhouse	33. Owner Questionnaire Completed <input checked="" type="checkbox"/>
16. Present Use Farmhouse	
17. Condition Interior Exterior fair-good	

SEE CONTINUATION SHEET

18. Description
A two-part frame early 19th-century farmhouse consisting of 1 1/2-story "Cape Cottage" and a long, narrow one-story ell extending to the north. The entire roofline of the "cape" section has been newly raised to 2-story elevation and slope altered, but original cornice line is visible on the east. Random fenestration of 2/2 and 6/6 windows. The house's early origins are evident in the lines of the wing, the narrow clapboards, and some remaining small-paned window sash.
Just across the road is a large 19th-century barn bearing the inscription "Frost Farm 1806" on the lintel of the main door. (See continuation sheet.)

19. History
See continuation sheet

20. Significance
Farmhouse identified with early 19th-century settlement, industry, and farming, and later with the development of Dublin's Finnish-American community. (Frost's difficulty in harnessing waterpower for his mill exemplified scarcity of usable water in Dublin and consequent lack of industrial development in 19th century.)

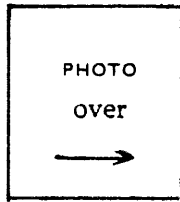

21. Source of Information
History of Dublin, 200, 579, 592, 766-67
Peterborough Transcript, 3/6/66.

34. Prepared by:
WM / WLB / MN

35. Organization

36. Date 3/31/79 & 1/29/81

DUBLIN, NEW HAMPSHIRE: HISTORIC RESOURCES INVENTORY

37. PHOTO S. Bauhan 12/14/82

Roll No. AD
Picture No. 0
Direction ^{Facing} Southwest, back view

S. Bauhan 12/14/82
AD
0
Facing North, front view barn

DUBLIN, NEW HAMPSHIRE: HISTORIC RESOURCES INVENTORY

CONTINUATION SHEET

19. History

Benjamin Frost (177801825), a farmer and miller who came from Jaffrey, built the house in 1806, the year of his marriage to Annis Pierce of Jaffrey. Nearby, Frost "built a grist mill - but for want of suitable head and fall of water, it was not practicable to operate it" (Town History, p.579), and he later sold it to Nathan Hunt of Jaffrey, who, by means of machinery, developed a small woolen mill on the site. Farm was inherited by his son Cyrus Frost, 2nd (b.1807), a farmer and carpenter, who occupied the property until 1852 when he moved to Peterborough. Among subsequent owners was Irish-born Sylvester Doyle (b. 1839) who served 3 years in the Civil War, and remodeled the house c.1901.

The house was acquired in 1913 by Finnish-born farmer Konstu Korpi, whose family has occupied it ever since, and whose daughter is the present owner. Korpi remodeled the house in 1914 and his son-in-law John R. Niemela (1900-1966) further enlarged it (fireplace, new walls, large dormer) in the 1950's.

The house has served as a center for Dublin's Finnish-American community (of which there are several families in this area of town) and as a boarding house for cooperative of Finnish-American woodworkers, mostly from Northern Michigan.

18. Description (continued)

Barn has recently been extensively repaired by its owner (a contractor-builder) retaining wooden materials and all possible original features. A long, 1-story equipment shed forming the back of the barnyard collapsed in 1962 and has recently been rebuilt with 3 arched bays, following the lines of the original.

HISTORIC NAME

Frost Farm

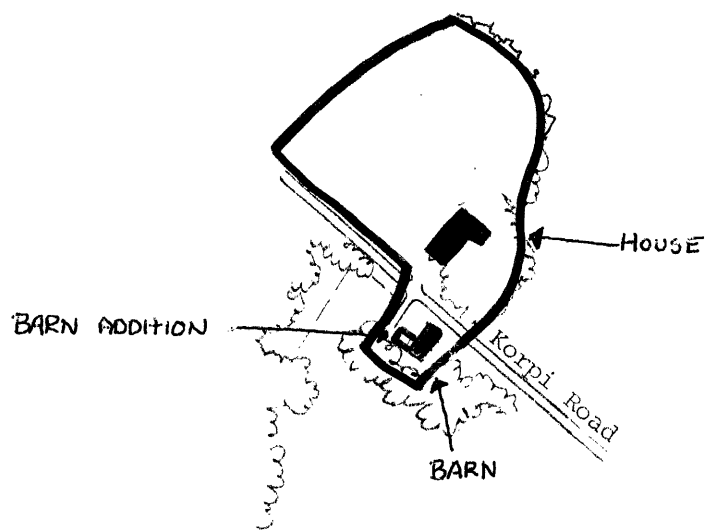

PROPERTY OWNER: Carl S. and Marsha W. Niemela
 SITE NUMBER: 9
 PROPERTY NAME: Frost Farm
 ADDRESS: Korpi Road

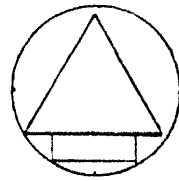

GENERAL DESCRIPTION: Scale: 1" = 200'

Bounded on the east by edge of trees and an arbitrary line extending from the edge of the road approximately 100' west.
 Bounded on the south by a line approximately 25' south of the barn driveway and then along Korpi Road, and on the north by an arbitrary line approximately 200' west of the house to the edge of trees. 1.30 acres.

HISTORIC RESOURCES OF DUBLIN, N.H.
 JUSTIFICATION:

Immediate visual surroundings incorporating the features contributing to the property's architectural and historical significance.

United States Department of the Interior
National Park Service

National Register of Historic Places
Inventory—Nomination Form

For NPS use only
received 11/9/83
date entered

Continuation sheet

Item number

Page 3 of 7

Multiple Resource Area
Thematic Group

Name Dublin Multiple Resource Area
State Cheshire County, NEW HAMPSHIRE

Nomination/Type of Review

Date/Signature

- | | | | | |
|-----|-------------------------------------|-------------------------------------|------------|---------------------------------|
| 21. | Frost Farm
(Korpi Rd.) | Substantive Review | for Keeper | accept Patrick Andrews 12/18/83 |
| | | | Attest | _____ |
| 22. | Frost Farm
(Old Marlborough Rd.) | Entered in the
National Register | for Keeper | Melvin Byers 12/15/83 |
| | | | Attest | _____ |
| 23. | Gowing, James, Farm | Substantive Review | for Keeper | accept Patrick Andrews 12/18/83 |
| | | | Attest | _____ |
| 24. | Gowing, Joseph, Farm | Entered in the
National Register | for Keeper | Melvin Byers 12/15/83 |
| | | | Attest | _____ |
| 25. | Greenwood, Isaac, House | Substantive Review | for Keeper | accept Patrick Andrews 12/18/83 |
| | | | Attest | _____ |
| 26. | Greenwood, Moses, House | Entered in the
National Register | for Keeper | Melvin Byers 12/15/83 |
| | | | Attest | _____ |
| 27. | Ivanov-Rinov House | Substantive Review | for Keeper | accept Patrick Andrews 12/18/83 |
| | | | Attest | _____ |
| 28. | Lattice Cottage | Entered in the
National Register | for Keeper | Melvin Byers 12/15/83 |
| | | | Attest | _____ |
| 29. | Learned, Benjamin, House | Substantive Review | for Keeper | accept Patrick Andrews 12/18/83 |
| | | | Attest | _____ |
| 30. | Learned Homestead | Entered in the
National Register | for Keeper | Melvin Byers 12/15/83 |
| | | | Attest | _____ |