

1494

AREA FORM NO.
114

FORM B - BUILDING

AUG 21 1989

MASSACHUSETTS HISTORICAL COMMISSION
80 BOYLSTON STREET
BOSTON, MA 02116

NATIONAL REGISTER

WALTHAM, MA MRA
Town Waltham, Massachusetts

Address 256 Charles Street

Historic Name U. S. Watch Co./
Howard Clock Products

Use Present industrial
Original industrial

DESCRIPTION

Date 1886. 1901

Source Sanderson

Style elements of Romanesque Revival

Architect builder = Robert C. Glancy

Exterior Wall Fabric brick

Outbuildings shed-NC
powerhouse-C

Major Alterations (with dates) none

Condition good

Moved no - Date -n/a

Acreage 95,689 sq.ft. 2.2A 59-28-1

Setting located on large lot in
densely settled residential area of
mid/late 19th c. dwellings.

Photo (3"x 3" or 3"x5", black and white) Indicate address of property on back of photo. Staple to left side of form.

Sketch Map: Draw map showing property's location in relation to nearest cross streets and/or geographical features. Indicate all buildings between inventoried property and nearest intersection(s). Indicate north - see attached sheet

UTM REFERENCE 19/314820/4693370

USGS QUADRANGLE NEWTON

SCALE 1:25,000

Recorded by Edward W. Gordon

Organization Waltham Hist. Comm.

Date June, 1986

NATIONAL REGISTER CRITERIA STATEMENT (if applicable)

The former plant of the United States Watch Company represents a "spinoff" enterprise of the American Waltham Watch Company. It was built in two stages in 1886 and 1901. Together with the American Waltham Watch Company, this factory building provides an unspoiled glimpse of late 19th/early 20th century Waltham's most profitable and politically influential industry - watch manufacturing. Exhibiting elements of the Romanesque Revival style, this plant perpetuates the watch manufacturing factory format pioneered by the American Waltham Watch Company - narrow wings with aisles of work areas (cont)

ARCHITECTURAL SIGNIFICANCE Describe important architectural features and evaluate in terms of other buildings within the community.

Architecturally, 256 Charles Street is significant as a medium-range, masonry, late 19th century Waltham manufacturing plant which provides an interesting contrast to its much more extensive "mother" factory - the American Waltham Watch Company on Crescent Street. Together, these factories tell the story of late 19th/early 20th century watch manufacturing in the United States and more specifically in Waltham. Essentially T-shaped in plan, 256 Charles Street's main facade features a four-story clock tower flanked by 3-story wings. Most of the architectural interest is focused on the clock tower with its round arch gauged brickwork outlined entrance, circular clock at the 4th level, deep corbelled cornice, and pyramidal roof-cap. This building's wings each exhibit 22 bays. Its regimental rows of tall windows contain 6/6 wood sash, rock-faced granite sills, and header brickwork lintels. The wings also display moulded metal cornices. (cont)

HISTORICAL SIGNIFICANCE Explain the role owners played in local or state history and how the building relates to the development of the community.

The American Waltham Watch Company spawned a number of watchmaking firms in Waltham, most of them short-lived. The former United States Watch Company has housed watch manufacturing or related enterprises from 1886 until the present day. It is the only timepiece-related industry still operating in Waltham.

In 1883, Charles Vander Woerd left his job as the mechanical superintendent of the American Watch Factory to join the recently formed Waltham Watch Tool Company. This firm manufactured small machinery and dyes until it moved to Charles Street and erected the first wing of a projected two-wing, central-towered factory. The company purchased a tract of land on Charles Street that had been part of the Town Farm's 17-lot parcel (see 1875 map). Measuring 160' x 25', the first wing of the factory was completed in 1886. The United States Watch Company's first president was T.B. Eaton and its first treasurer and general manager was C.V. Woerd. The company's first watch was described as "somewhat novel in design and competent judges state that it possesses considerable merit." The plant was closed in 1895 and remained vacant until it was purchased in 1901 by a new United States Watch Company (a New Jersey corporation headed by Theophilus Zebrugg). The Suffolk

(cont)

BIBLIOGRAPHY and/or REFERENCES

Maps/Atlases - 1874, 1881, 1886, 1898, 1911

Barry, Ephraim L. The City of Waltham, Massachusetts, Its Advantages to Manufacturers and as a Place to Live, 1884

Dinger, Paul- "Quality Clock Products", the New Tribune, Aug 8, 1980

Hurd, D. Hamilton History of Middlesex County, Vol III, 1890

Sanderson, Edmund L. Waltham Industries, 1957

NATIONAL REGISTER CRITERIA STATEMENT, US Watch Company, continued

adjacent to large windows provide ample illumination to facilitate the watchmaker's painstaking work. This property possesses integrity of location, design, setting, materials, workmanship, feeling and association, and meets criteria A and C of the National Register of Historic Places.

HISTORICAL SIGNIFICANCE, continued

Watch Company of Waltham was also purchased by Zebrugg, and its machinery and personnel transferred to the Charles Street plant, where the second wing was added according to the original plan. Having bought the rights to the "Howard" name from E. Howard and Company of Boston, the firm was known by 1910 as the E. Howard Watch Works. It was acquired by a new corporation which came to be called Howard Clock Products Inc.. Over time, this corporation has built up a successful business, making small parts, gear trains etc. It also manufactures repair parts for the many Howard clocks now in use, and has made complete clocks of the old Howard design. In 1977, Ronald A. Keeman sold the company to Richard Beckman. Keeman bought it back in 1978. Dana Blackwell, company historian and clockmaker, persuaded the Keemans to pursue the reproduction antique clock business, turning from mass production, toward the re-issue of seven of their most popular wright driven, 19th century wall clocks.

The U.S. Watch Company represents the work of the prolific late 19th/early 20th century Waltham building contractor Robert E. Glancy. In addition, he was a wholesale and retail dealer in "shingles, clapboards, laths, spruce frames and boards." He started his business in 1885. He was also an agent for the National Sheet Metal Roofing Company. By the early 1890's, his office was located at 53 Cushing Street, Waltham. School buildings were apparently Mr. Glancy's specialty. He built the Nurse's Training School Chauncy Newhall School, Stearns School and Waltham Senior High School. In addition he built the Moody Street fire station, the Orient Factory (bicycles), Emery Wheel Company's Factory, Dair's and Farnum's Foundry and many other Waltham buildings.

ARCHITECTURAL SIGNIFICANCE, continued

Two dependencies stand behind the factory. A contributing one-story, brick powerhouse with smokestack is located behind and connected to the west wing. A non-contributing one story brick shed is centered behind the factory.

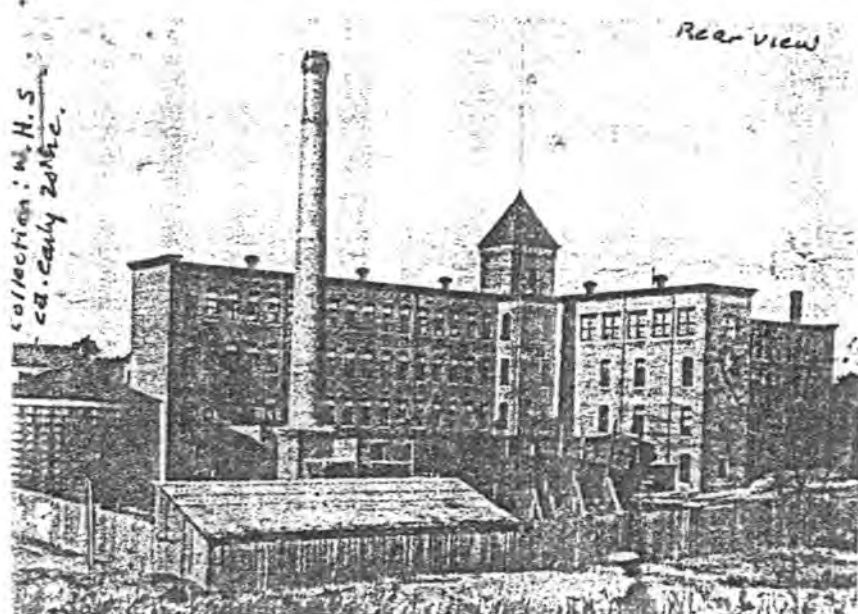

INVENTORY FORM CONTINUATION SHEET

MASSACHUSETTS HISTORICAL COMMISSION
Office of the Secretary, Boston

Community:

Waltham, Ma.

Form No:

114

Property Name: U.S. Watch Co.
256 Charles St

Indicate each item on inventory form which is being continued below.

ADVERTISEMENTS. 387



R. E. GLANCY,

CONTRACTOR AND BUILDER,

WHOLESALE AND RETAIL DEALER IN

Lumber, Shingles
... AND ...
Dimension Timber,
NAILS, BUILDERS' HARDWARE,
—AND—
MOULDINGS.

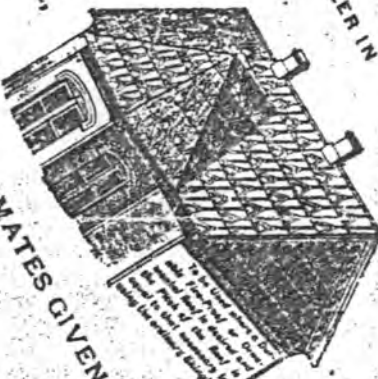

ESTIMATES GIVEN ON ALL CLASSES OF BUILDINGS.

OFFICE, 53 CUSHING STREET,
... WALTHAM, MASS.

Metal Roofing
Metallic Shingles.

Agent for
THE NATIONAL
SHEET
COMPANY'S



1899 WALTHAM/Watertown DIRECTORY

Staple to Inventory form at bottom

United States Department of the Interior
National Park Service

AUG 21 1989

National Register of Historic Places
Continuation Sheet

Section number _____ Page _____

Multiple Resource Area
Thematic Group

Name Waltham MRA
State Middlesex County, MASSACHUSETTS

Nomination/Type of Review

Date/Signature

Sub

- | | | |
|-----|--|---------------------------------------|
| 81. | St. Mary's Roman Catholic Church Complex
Substantive Review | Keeper <u>Betty L. Swaine</u> 9/28/89 |
| | | Attest _____ |
| 82. | Stanley, Leonard W., House
Entered in the
National Register | Keeper <u>Alvoret Byen</u> 9/28/89 |
| | | Attest _____ |
| 83. | Stark Building
Entered in the
National Register | Keeper <u>Alvoret Byen</u> 9/28/89 |
| | | Attest _____ |
| 84. | Stark, Robert M., House
Entered in the
National Register | Keeper <u>Alvoret Byen</u> 9/28/89 |
| | | Attest _____ |
| 85. | Stearns, Amos, House
Entered in the
National Register | Keeper <u>Alvoret Byen</u> 9/28/89 |
| | | Attest _____ |
| 86. | Stewart, Henry, House
Entered in the
National Register | Keeper <u>Alvoret Byen</u> 9/28/89 |
| | | Attest _____ |
| 87. | Swasey, James, House
Entered in the
National Register | Keeper <u>Alvoret Byen</u> 9/28/89 |
| | | Attest _____ |
| 88. | Tyler, Frank J., House
Entered in the
National Register | Keeper <u>Alvoret Byen</u> 9/28/89 |
| | | Attest _____ |
| 89. | United States Watch Company
Entered in the
National Register | Keeper <u>Alvoret Byen</u> 9/28/89 |
| | | Attest _____ |
| 90. | Waltham Gas Light Company
Entered in the
National Register | Keeper <u>Alvoret Byen</u> 9/28/89 |
| | | Attest _____ |

UNITED STATES DEPARTMENT OF THE INTERIOR
NATIONAL PARK SERVICE

NATIONAL REGISTER OF HISTORIC PLACES
EVALUATION/RETURN SHEET

REQUESTED ACTION: NOMINATION

PROPERTY NAME: United States Watch Company

MULTIPLE NAME: Waltham MRA

STATE & COUNTY: MASSACHUSETTS, Middlesex

DATE RECEIVED: 8/21/89 DATE OF PENDING LIST: 9/05/89
DATE OF 16TH DAY: 9/21/89 DATE OF 45TH DAY: 10/05/89
DATE OF WEEKLY LIST:

REFERENCE NUMBER: 89001494

NOMINATOR: STATE

REASONS FOR REVIEW:

APPEAL: N DATA PROBLEM: N LANDSCAPE: N LESS THAN 50 YEARS: N
OTHER: N PDIL: N PERIOD: N PROGRAM UNAPPROVED: N
REQUEST: N SAMPLE: N SLR DRAFT: N NATIONAL: N

COMMENT WAIVER: N

ACCEPT RETURN REJECT 9/28/89 DATE Entered in the
National Register

ABSTRACT/SUMMARY COMMENTS:

RECOM./CRITERIA _____
REVIEWER _____
DISCIPLINE _____
DATE _____

DOCUMENTATION see attached comments Y/N see attached SLR Y/N

CLASSIFICATION

count resource type

STATE/FEDERAL AGENCY CERTIFICATION

FUNCTION

historic current

DESCRIPTION

architectural classification
 materials
 descriptive text

SIGNIFICANCE

Period Areas of Significance--Check and justify below

Specific dates Builder/Architect
Statement of Significance (in one paragraph)

summary paragraph
 completeness
 clarity
 applicable criteria
 justification of areas checked
 relating significance to the resource
 context
 relationship of integrity to significance
 justification of exception
 other

BIBLIOGRAPHY

GEOGRAPHICAL DATA

acreage verbal boundary description
 UTM's boundary justification

ACCOMPANYING DOCUMENTATION/PRESENTATION

sketch maps USGS maps photographs presentation

OTHER COMMENTS

Questions concerning this nomination may be directed to

_____ Phone _____

Signed _____

Date _____



256 Charles St

© STEVEN GYURINA

United States Watch Company

Waltham, MA. MRA

256 Charles St



114

256 Charles St

STEVEN GYURINA ©

Waltham, MA. MRA

United States Watch Company

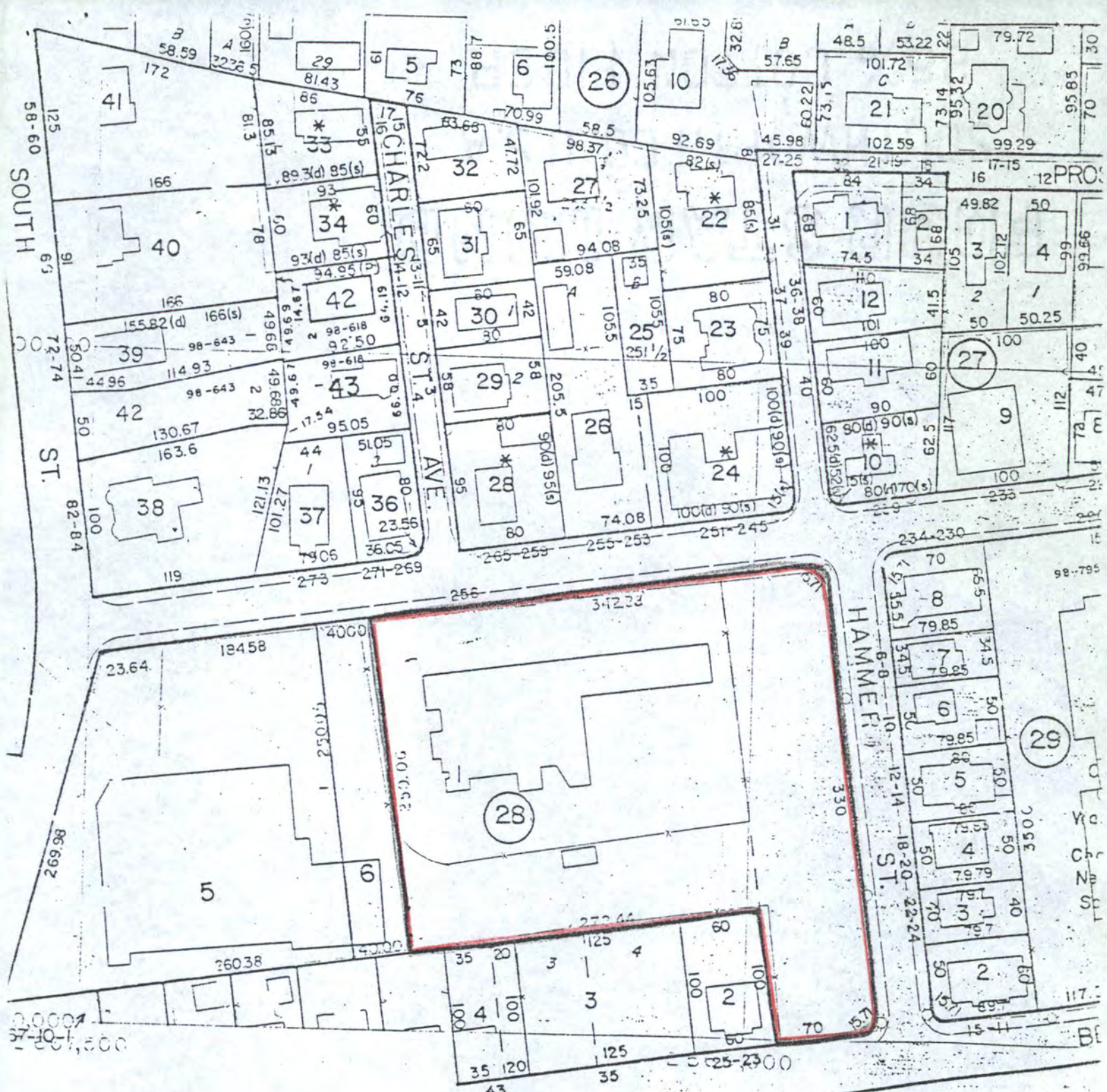

WALTHAM, MA MRA

U.S. Watch Co./Howard Clock #114
 256 Charles Street
 1" = 100'
 1975; updated to 1987
 Waltham Engineering Dept.

lot #59-28-1



CITY OF WALTHAM, MAS
 MAPPING PREPARED BY:

Please refer to the map in the
Multiple Property Cover Sheet
for this property

Multiple Property Cover Sheet Reference Number: 64000301