

United States Department of the Interior National Park Service

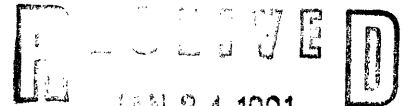

National Register of Historic Places Registration Form

NATIONAL REGISTER

This form is for use in nominating or requesting determinations of eligibility for individual properties or districts. See instructions in Guidelines for Completing National Register Forms (National Register Bulletin 16). Complete each item by marking "x" in the appropriate box or by entering the requested information. If an item does not apply to the property being documented, enter "N/A" for "not applicable." For functions, styles, materials, and areas of significance, enter only the categories and subcategories listed in the instructions. For additional space use continuation sheets (Form 10-900a). Type all entries.

1. Name of Property

historic name Steele, Drewsilla House

other names/site number FA 353

2. Location

street & number 3951 Old Frankfort Pike

not for publication

city, town Lexington

vicinity

state Kentucky

code KY

county Fayette

code 067

zip code 40510

3. Classification

Ownership of Property

- private, public-local, public-State, public-Federal

Category of Property

- building(s), district, site, structure, object

Number of Resources within Property

Table with 2 columns: Contributing, Noncontributing. Rows for buildings, sites, structures, objects, Total.

Name of related multiple property listing:

N/A

Number of contributing resources previously listed in the National Register 0

4. State/Federal Agency Certification

As the designated authority under the National Historic Preservation Act of 1966, as amended, I hereby certify that this nomination request for determination of eligibility meets the documentation standards for registering properties in the National Register of Historic Places and meets the procedural and professional requirements set forth in 36 CFR Part 60. In my opinion, the property meets does not meet the National Register criteria. See continuation sheet. Signature of certifying official David L. Morgan, State Historic Preservation Officer, Kentucky Heritage Council. Date 1-16-91.

In my opinion, the property meets does not meet the National Register criteria. See continuation sheet. Signature of commenting or other official. Date. State or Federal agency and bureau.

5. National Park Service Certification

I, hereby, certify that this property is:

- Entered in the National Register. See continuation sheet. determined eligible for the National Register. See continuation sheet. determined not eligible for the National Register. removed from the National Register. other, (explain:)

Entered in the National Register. Signature of the Keeper Helene Byer. Date of Action 2/22/91.

6. Function or Use

Historic Functions (enter categories from instructions)

DOMESTIC; single dwelling

Current Functions (enter categories from instructions)

DOMESTIC; single dwelling

7. Description

Architectural Classification
(enter categories from instructions)

OTHER; T-Plan

Materials (enter categories from instructions)

foundation limestone

walls WOOD; weatherboard, shingle

roof asphalt

other

Describe present and historic physical appearance.

8. Statement of Significance

Certifying official has considered the significance of this property in relation to other properties:

nationally statewide locally

Applicable National Register Criteria A B C D

Criteria Considerations (Exceptions) A B C D E F G

Areas of Significance (enter categories from instructions)

ARCHITECTURE

Period of Significance

circa 1885

Significant Dates

ca. 1885

Cultural Affiliation

n/a

Significant Person

n/a

Architect/Builder

unknown

State significance of property, and justify criteria, criteria considerations, and areas and periods of significance noted above.

9. Major Bibliographical References

Previous documentation on file (NPS):

- preliminary determination of individual listing (36 CFR 67) has been requested
- previously listed in the National Register
- previously determined eligible by the National Register
- designated a National Historic Landmark
- recorded by Historic American Buildings Survey # _____
- recorded by Historic American Engineering Record # _____

See continuation sheet

Primary location of additional data:

- State historic preservation office
- Other State agency
- Federal agency
- Local government
- University
- Other

Specify repository:

Kentucky Heritage Council

10. Geographical Data

Acreage of property less than one acre

UTM References

A

1	6
---	---

7	1	0	6	1	0
---	---	---	---	---	---

4	2	1	8	2	7	5
---	---	---	---	---	---	---

 Zone Easting Northing

C

--	--

--	--	--	--	--	--

--	--	--	--	--	--	--

B

--	--

--	--	--	--	--	--

--	--	--	--	--	--	--

 Zone Easting Northing

D

--	--

--	--	--	--	--	--

--	--	--	--	--	--	--

Lexington West Quadrangle

See continuation sheet

Verbal Boundary Description

See continuation sheet

Boundary Justification

See continuation sheet

11. Form Prepared By

name/title Christine Amos
 organization Lexington-Frankfort Scenic Corridor, Inc. date August 1, 1990
 street & number Route 5 Box 365 telephone (502) 633-5530
 city or town Shelbyville state Kentucky zip code 40065

United States Department of the Interior
National Park ServiceNational Register of Historic Places
Continuation SheetSteele, Drewsilla, House
Fayette County, KY.Section number 7 Page 1

The nominated property is a late-19th century, single family residence, located in the rural, west central area of Fayette County, Kentucky about 75' north of the Old Frankfort Pike, a two-lane state highway that connects Lexington with Frankfort. The rural area surrounding the property was historically devoted to diversified farming but much of this landscape has been altered within the past ten years to meet the needs of modern, Thoroughbred horse facilities. The nominated land includes only the yard area, less than one acre in size, delineated by a board fence from the remainder of the farm.

The building is a one-story, frame, T-plan residence, a traditional 19th century vernacular form and plan built in all counties of the Bluegrass region. The building features five front bays, two within the projecting front gable bay. This gable is decorated with Queen Anne-inspired, double brackets near the outer gables and single brackets toward the peak. Side gables are dressed with decoratively-cut bargeboards. A shed porch is located at the intersection of the front gables and is supported by plain, wood posts. Windows are tall, single light sash with mortise and tenon frames and simple trim. Walls are of clapboard with vertical corner posts. There are three, interior, brick chimneys. A long porch extends along the east side of the rear ell, supported by low posts with local interpretations of Eastlake brackets. Interior details include a front, west room mantle with raised curvilinear, beaded decoration, and a plain wood mantle with rounded shelf in the rear, east room.

United States Department of the Interior
National Park ServiceNational Register of Historic Places
Continuation SheetSteele, Drewsilla, House
Fayette County, KY.Section number 8 Page 1

The Drewsilla Steele House is individually eligible to the National Register under criteria C, with architectural significance as one of the best preserved and most elaborate examples of a late Victorian vernacular, one-story T-plan residence with elaborate design details in rural Fayette County, Kentucky.

The following statement of significance is based upon research and documentation concerning the frequency, integrity, and importance of 19th century vernacular domestic buildings within Fayette County as revealed in the comprehensively surveyed area of west central Fayette County documented in the "Old Frankfort Pike Survey Summary Report" (Amos;1990), and from the Fayette County survey data contained in Kentucky Heritage Council files. The "Old Frankfort Pike Corridor" project resulted in National Register nominations of two rural historic districts and four individual properties in the immediate area of the Drewsilla Steele house. Area specific research concerning the theme of architecture in the corridor area provides historic context for evaluating resources surveyed. Fayette County was surveyed in 1979 with 597 historic sites, primarily residential, recorded (outside the Lexington city limits). Of those, forty-eight are listed in the National Register and thirty-three have been determined eligible by the Keeper of the Register. Comprehensive National Register nomination efforts have not been undertaken in the county.

The Drewsilla Steele House is a well preserved and picturesque example of a popular vernacular house type that was built throughout the region from the late 19th through the early 20th centuries. The T-plan evolved from the center-passage plan following the antebellum era in Kentucky. The plan enlarges and modifies the basic center passage, wherein one of two rooms flanking the passage is pushed forward, giving access from the hallway to a third room placed to the rear.

Fourteen one-story, frame, T-plan residences are recorded in Fayette County. None are listed in the National Register. Of those properties identified, the majority displayed restrained late-Victorian Princess Anne and turn-of-the-century Classical Revival borrowings with turned porch posts and scrolled brackets on the former, and Tuscan porch columns and flat board trim on the latter. Rarely did any of these

United States Department of the Interior
National Park ServiceNational Register of Historic Places
Continuation SheetSteele, Drewsilla, House
Fayette County, KY.Section number 8 Page 2

examples exhibit roof, wall and porch decorations while maintaining good physical integrity as in this example, where decorative porch work, double bracketed eaves, and cut bargeboards augment the dwelling's originality. The Drewsilla Steele House is one of the most elaborate surviving examples of the one-story, T-plan with elaborate Victorian carpenter decoration in Fayette County and is significant as an outstanding example of a traditional vernacular plan embellished with popular stylistic decoration.

The residence was constructed by a member of the Andrew Steele family, A prominent Fayette County farming family that established holdings in this area during the 1780s. The property is assumed to have been built for Drewsilla Steele, a descent of Andrew Steele, early area surveyor and settler. County maps indicate the land on which this house is located was owned by Mrs. Downs in 1877 (see Lewis Ramsey, Jr. House NR nomination for information on the Downs family). A building first appears at this location on the 1891 Fayette County atlas as occupied by "D.Steele", formally Drewsilla Steele. Within the decade of its building, Drewsilla's brother, Piatt A. Steele acquired this property from the Downs family. A 1904 county map indicates Piatt here at that time. The property was retained by Steele heirs until the early 1980s, when it was sold to the present owner, a division of Three Chimneys Farm. All associated farm buildings were removed at that time.

United States Department of the Interior
National Park Service

National Register of Historic Places
Continuation Sheet

Steele, Drewsilla, House
Fayette County, KY.

Section number 9, 10 Page 1

9. Bibliographic References

Amos, Christine. "Lexington-Frankfort Scenic Corridor Survey Summary Report". Frankfort: Kentucky Heritage Council, 1988.

Perrin, William Henry, ed. History of Fayette County, Kentucky. Chicago: O.L. Baskin & Co., 1882, p. 862.

Kerr, Charles. History of Kentucky, Vol. III. Chicago: The American Historical Society, 1922, p. 62.

Fayette County maps: 1861, 1877, 1891, 1904.

Steele, John Williams. personal communication.

10. Geographical Data

Verbal Boundary Description

The boundary of the nominated property is indicated by a line drawn on the enclosed site map, taken from Fayette County Planning Department aerial maps.

Boundary Justification

The boundary is justified as including only that acreage that contains the architecturally significant property, and includes only the building and landscaped yard area that contribute to the property's architectural integrity. The acreage outside the property boundary has lost historic integrity through the loss of historic agricultural buildings, the introduction of modern equine-associated buildings and alteration of historic land use patterns.

United States Department of the Interior
National Park Service

National Register of Historic Places Continuation Sheet

Steele, Drewsilla, House
Fayette County, KY

Section number Site Map Page _____

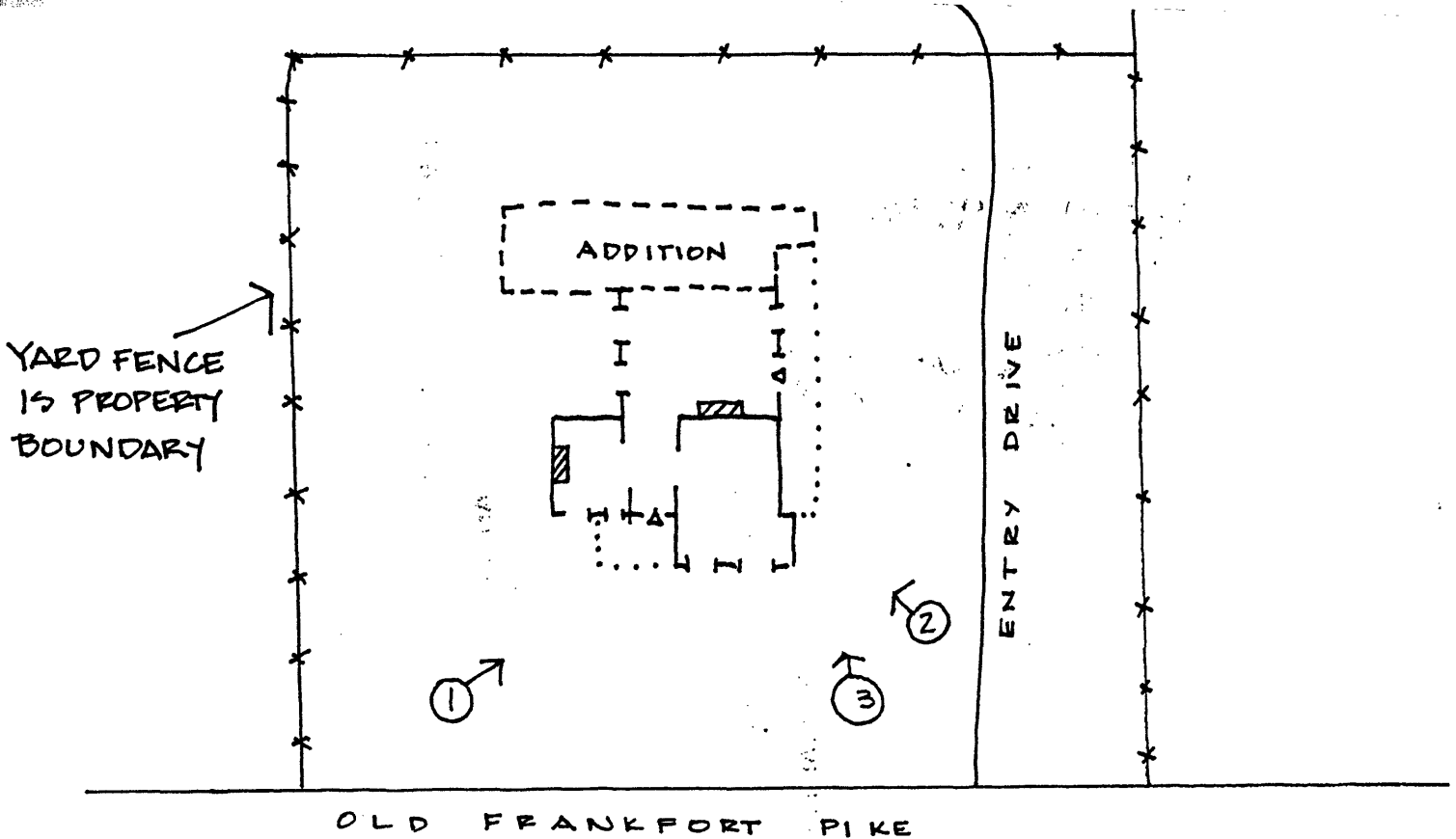

DREWSILLA STEELE HOUSE

NATIONAL REGISTER
SITE PLAN

(FA 353)



1" = 75'

SCALE APPROXIMATE

♂ PHOTO VIEWS