

3165

1. Historic Name(s) **First Baptist Church**
 Original Owner **First Baptist Church**

2. Present Name **Church of God**

3. Location **College St. Paintsville, Ky..**

4. Owner's Name **Vine Street Baptist Church**

5. Owner's Address **Paintsville, Ky.**

6. Open to Public Yes No
 7. Visible from road Yes No

8. Ownership Private
 Local
 State
 Federal

9. Local Contact/Organization
JOHNSON COUNTY HISTORIC SITES SURVEY COMMITTEE

22. ADD/County **BIG SANDY / JOHNSON** 058

23. U.S.G.S. Quadrant (15'/75') **Paintsville** G.I.S. Mod.

24. UTM Reference 17 340980 4186780
 Zone Easting Northing

25. Coordinate Accuracy

26. Prehistoric Site Object
 Historic Site Structure
 Building Other

27. National Register District Name:

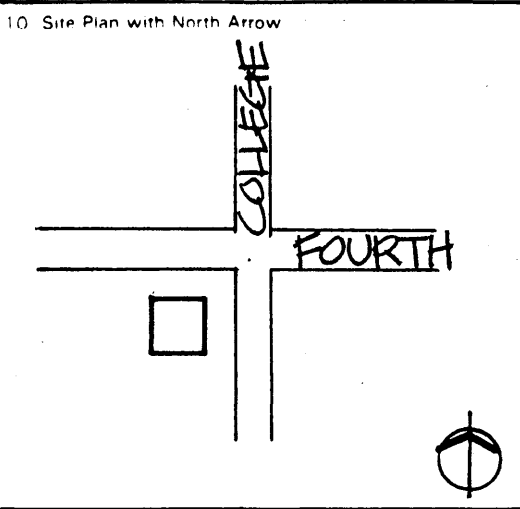

11. Architect **Unknown**

12. Builder **Walter Spradlin**

13. Date **1907** A. 6 B.

14. Style A. **Gothic Rev.** D
 B.

15. Original Use **Church** H

16. Present use **Same**

17. Condition **Good** B

28. Significance Evaluation **National Reg. Criteria** D

29. Status National Landmark National Register Landmark Certificate Kentucky Survey Local Landmark HABS/HAER

30. Historic Theme Primary Secondary Other

31. Endangered Yes No

32. Preservation Project Status

18. Description

One story concrete block sanctuary with three story tower; entry tower on right side; pyramidal roof on tower; gothic arched windows with stained glass

(Conti

No. Stories **2 + 3 st. tower** C

Single Pile NA

Double Pile

Floor Plan **NA**

Structural Fabric **Concrete** A. E B.

Decorative Fabric **Stained Glass** A. B.

Roof Form **Gable**

Actual Cost in \$1,000s

33. ATTACH PHOTO

Roll No. 12
 Picture No. 40
 Direction

19. History

Built in 1907 as the first Baptist Church. Churches are not usually eligible for the National Register unless they have architectural merit. The design of the First Baptist Church shows that the congregation was aware of architectural style.

34. Prepared by: **HELEN POWELL** *m n m*

20. Significance **The First Baptist Church is significant under Criterion C because of its demonstration of the Gothic style in its windows and entry tower. It is also notable**

21. Source of Information **because of the rusticated concrete block 1910 Sandborn Insurance Map material of which it is built.**

35. Organization **CARMAN AND POWELL, INC.**

36. Date **1983**

37. Revision Dates 38. Staff Review

KENTUCKY HISTORIC RESOURCE INVENTORY SUPPLEMENT
BOUNDARY AND LOCATION INFORMATION

Historic Property Name First Baptist Church Site # Jo-P-38

Multiple Resource/Thematic Nomination Title MULTIPLE RESOURCES OF JOHNSON COUNTY

U.T.M. Coordinates - List multiple UTMs if property is ten or more acres.

A. _____ D. _____

B. _____ E. _____

C. _____ F. _____

Verbal Boundary Description

Acreage .078

Beginning at a point in the southwest corner of the intersection of College Street and Fourth Street; then west 62 feet to a point; then south 70 feet to a point; then east 62 feet to a point, then north 70 feet to the point of beginning.

The boundary includes all of the space associated with the church and one contributing building.

Sketch of Site Plan (Showing outbuildings, structures, landscape features and the site boundary as described above.)

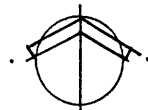
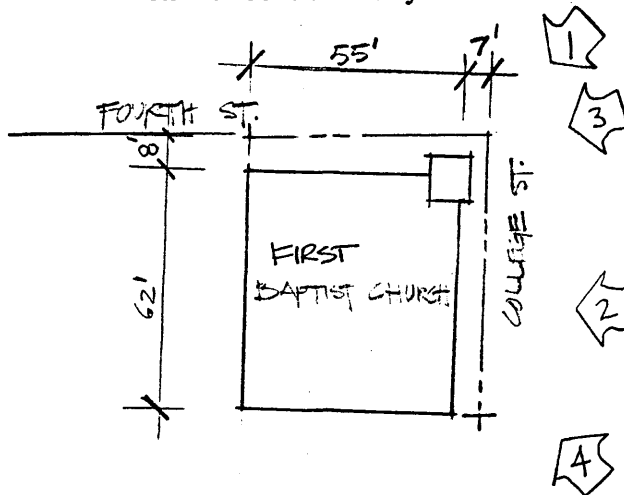

SCALE: 1" = 50'-0"

Official Courthouse Property Reference: