

UNITED STATES DEPARTMENT OF THE INTERIOR
NATIONAL PARK SERVICENATIONAL REGISTER OF HISTORIC PLACES
INVENTORY -- NOMINATION FORM

FOR NPS USE ONLY

RECEIVED

MAY 21 1975

DATE ENTERED

MAY 30 1975

SEE INSTRUCTIONS IN *HOW TO COMPLETE NATIONAL REGISTER FORMS*
TYPE ALL ENTRIES -- COMPLETE APPLICABLE SECTIONS**1 NAME**

HISTORIC Symphony and Horticultural Halls

AND/OR COMMON

2 LOCATION

STREET & NUMBER

Massachusetts and Huntington Avenues

__ NOT FOR PUBLICATION

CITY, TOWN

Boston

CONGRESSIONAL DISTRICT

4th and 9th

STATE

Massachusetts

VICINITY OF

CODE
025

COUNTY

Suffolk

CODE

025

3 CLASSIFICATION

CATEGORY

 DISTRICT BUILDING(S) STRUCTURE SITE OBJECT

OWNERSHIP

 PUBLIC PRIVATE BOTH

PUBLIC ACQUISITION

 IN PROCESS BEING CONSIDERED

STATUS

 OCCUPIED UNOCCUPIED WORK IN PROGRESS

ACCESSIBLE

 YES: RESTRICTED YES: UNRESTRICTED NO

PRESENT USE

 AGRICULTURE COMMERCIAL EDUCATIONAL ENTERTAINMENT GOVERNMENT INDUSTRIAL MILITARY MUSEUM PARK PRIVATE RESIDENCE RELIGIOUS SCIENTIFIC TRANSPORTATION OTHER:**4 OWNER OF PROPERTY**

NAME

#1) Boston Symphony Orchestra;
#2) Massachusetts Horticultural Society

STREET & NUMBER

Massachusetts Avenue

CITY, TOWN

Boston

VICINITY OF

STATE

Massachusetts

5 LOCATION OF LEGAL DESCRIPTION

COURTHOUSE,

REGISTRY OF DEEDS, ETC. Registry of Deeds

STREET & NUMBER

Suffolk County Courthouse, Pemberton Square

CITY, TOWN

Boston

STATE

Massachusetts

6 REPRESENTATION IN EXISTING SURVEYS

TITLE

Inventory of the Historic Assets of the Commonwealth

DATE

1974

 FEDERAL STATE COUNTY LOCAL

DEPOSITORY FOR

SURVEY RECORDS Massachusetts Historical Commission (617) 727-8470

CITY, TOWN

40 Beacon Street

Boston

STATE

Massachusetts

7 DESCRIPTION

CONDITION		CHECK ONE	CHECK ONE
<input type="checkbox"/> EXCELLENT	<input type="checkbox"/> DETERIORATED	<input checked="" type="checkbox"/> UNALTERED	<input checked="" type="checkbox"/> ORIGINAL SITE
<input checked="" type="checkbox"/> GOOD	<input type="checkbox"/> RUINS	<input type="checkbox"/> ALTERED	<input type="checkbox"/> MOVED DATE _____
<input type="checkbox"/> FAIR	<input type="checkbox"/> UNEXPOSED		

DESCRIBE THE PRESENT AND ORIGINAL (IF KNOWN) PHYSICAL APPEARANCE

The Symphony and Horticultural Halls are contained within a small oblong shaped area in Boston's Fenway which incorporates two buildings that date from 1889 to 1901. These structures reflect an era in which Boston's cultural and religious institutions were extending from the recently filled Back Bay towards Huntington Avenue along the more recently improved Fenway.

Symphony Hall (#1), occupies the corner block between St. Stephen Street and Huntington Avenue on the West side of Massachusetts Avenue. It was built in 1900 and designed by McKim, Mead, and White. The massive, sober, red-brick Renaissance Revival structure is free standing with a basilican plan. It is 9 bays wide on Huntington Avenue and 11 bays long on the Massachusetts Avenue side. The structure is two stories high with the central 5 bay portion rising to a 4th story along the longitudinal axis. The flanking side aisles have flat roofs, while the main hall has a pitched roof.

The major architectural entrance is on Huntington Avenue. Here, a short flight of steps leads to a limestone entrance portico of columns with Ionic capitals that support a grand entablature. The portico emphasizes the width of the main hall, whose two upper stories on this gable end have no fenestration but do have decorative rectilinear stone and marble panels beneath a triangular pediment. At the opposite gable end, along St. Stephen's Street, the same horizontal decorative elements are present, but the fenestration is restrained, and no entrances exist.

Along the Massachusetts Avenue side, which serves as the common entrance to Symphony Hall, are seven round-headed wall arches containing lunettes above paired oblong windows. The central archway is trimmed elaborately with limestone, whereas the flanking arches are brick; the central arch originally served as the side entrance, but additional entrance have been made in those archways on the St. Stephen's Street side. A flat metal marquee has been suspended to protect Symphony-goers. This arcaded pattern is repeated in the upper stories of the central hall's longitudinal wall. Statues, inscriptions and other decorative elements were planned but never completed.

The interior space clearly follows the exterior shape. The concert hall proper occupies the dominant central portion; the lobbies, lounges, and offices occupy the side wings. For acoustical reasons, the rectangular auditorium is encased on all sides in two layers of construction to exclude traffic noises. Besides the outer wall layer, an inner layer has corridors surrounding the rectangular auditorium on three sides on all three balcony levels. The ceiling is designed in the Italian Renaissance manner with coffers of crosses and rectangles. The upper walls are relieved by plain pilasters, forming niches in which - for decorative and acoustical reasons - statues representing figures from Greek and Roman mythology are placed. The latter came from the studio of Pietro Caproni of Boston. The square gilded proscenium arch frames the orchestra platform.

Horticultural Hall (#2), located between Falmouth Street and Huntington Avenue on the East side of Massachusetts Avenue was built in 1901, one year after Symphony Hall. The architects, Wheelwright and Haven, designed the building with special reference to the mutual relations between it and its neighbor; in height, scale, style, and material, it harmonizes with Symphony Hall.

The Renaissance Revival building, laid in Flemish bond with Bedford limestone trim, is designed in a simple rectangular shape. It is 13 bays long on Massachusetts Avenue by 5 bays wide on the sides. The structure stands two stories high with an attic decorated by a carved stone entablature. A balustrade conceals the flat roof. The principle

UNITED STATES DEPARTMENT OF THE INTERIOR
NATIONAL PARK SERVICE

**NATIONAL REGISTER OF HISTORIC PLACES
INVENTORY -- NOMINATION FORM**

FOR NPS USE ONLY	
RECEIVED	MAY 21 1975
DATE ENTERED	MAY 30 1975

CONTINUATION SHEET

ITEM NUMBER 7 PAGE 1

features of the building are the four massive corner piers and the colonnade of Giant brick pilasters with Ionic stone capitals supporting the entablature that contains an ornamental frieze, richly decorated with Renaissance motifs of swags of fruit and flowers alternating with marble medallions. The brick pilasters are separated by round arched windows framed in limestone on the first story and smaller rectangular, limestone framed windows in the second story. Each second story window is emphasized by a delicate iron balcony supported by a bracketed limestone shelf. The base course of the building, made from Deer Island granite, is the same height as the entrance openings. Three round windows with wreathed stone frames mark the three stone pedimented classical doorways on the Massachusetts Avenue facade. The proportion and harmony of horizontal and verticals the style, size and frequency of windows, the lace-like iron balconies lend this Renaissance structure a Georgian Revival lightness.

The first floor of the building contains the large exhibition hall, a smaller exhibition hall, and a lecture hall. From Falmouth Street a wide and high doorway gives access on the street level to the floor of the large exhibition hall. This was installed to facilitate the safe and easy handling of large plants in the flower shows.

8 SIGNIFICANCE

PERIOD	AREAS OF SIGNIFICANCE -- CHECK AND JUSTIFY BELOW			
<input type="checkbox"/> PREHISTORIC	<input type="checkbox"/> ARCHEOLOGY-PREHISTORIC	<input type="checkbox"/> COMMUNITY PLANNING	<input checked="" type="checkbox"/> LANDSCAPE ARCHITECTURE	<input type="checkbox"/> RELIGION
<input type="checkbox"/> 1400-1499	<input type="checkbox"/> ARCHEOLOGY-HISTORIC	<input type="checkbox"/> CONSERVATION	<input type="checkbox"/> LAW	<input type="checkbox"/> SCIENCE
<input type="checkbox"/> 1500-1599	<input type="checkbox"/> AGRICULTURE	<input type="checkbox"/> ECONOMICS	<input type="checkbox"/> LITERATURE	<input type="checkbox"/> SCULPTURE
<input type="checkbox"/> 1600-1699	<input checked="" type="checkbox"/> ARCHITECTURE	<input type="checkbox"/> EDUCATION	<input type="checkbox"/> MILITARY	<input type="checkbox"/> SOCIAL/HUMANITARIAN
<input type="checkbox"/> 1700-1799	<input type="checkbox"/> ART	<input checked="" type="checkbox"/> ENGINEERING	<input checked="" type="checkbox"/> MUSIC	<input type="checkbox"/> THEATER
<input type="checkbox"/> 1800-1899	<input type="checkbox"/> COMMERCE	<input type="checkbox"/> EXPLORATION/SETTLEMENT	<input type="checkbox"/> PHILOSOPHY	<input type="checkbox"/> TRANSPORTATION
<input checked="" type="checkbox"/> 1900-	<input type="checkbox"/> COMMUNICATIONS	<input type="checkbox"/> INDUSTRY	<input type="checkbox"/> POLITICS/GOVERNMENT	<input checked="" type="checkbox"/> OTHER (SPECIFY) Urban Planning
		<input type="checkbox"/> INVENTION		

SPECIFIC DATES 1900, 1901 BUILDER/ARCHITECT McKim, Mead & White; Wheelwright & Haven

STATEMENT OF SIGNIFICANCE

These buildings contain the headquarters of two major Boston institutions built between 1900-1901, each of architectural, social, and cultural importance. Topographically the Symphony and Horticultural Halls are located in the southeast corner of Boston's Back Bay, an area of former tide-lands and mudflats. By 1857, because of unsanitary conditions and odoriferous mud created by the receding tides, the Back Bay was filled, an operation which continued until 1882. The streets, Commonwealth Avenue, Marlborough Beacon, Boylston, and Newbury Streets, and the alphabetical cross streets from Arlington to Hereford, all came into existence at this time, and by 1882, the whole area was filled although not necessarily built upon.

The particular area encompassing these buildings was a virtual no-man's land in the development of the Back Bay, hemmed in between railroad yards and cut off from Boylston Street by tracks of the Boston and Worcester (later Boston-Albany) Railroad. Growth along Huntington Avenue beyond Exeter Street was delayed until 1881 when Mechanics Hall (razed in 1956) was built on the corner of West Newton Street, to become the forerunner of many cultural institutions which were to follow. The First Church of Christ, Scientist located its headquarters and Mother Church in 1894 along Massachusetts and Falmouth Streets. By 1909, the environs of Huntington Avenue contained the Boston Opera House, Harvard Medical School, the Symphony and Horticultural Halls, the Museum of Fine Arts, Simmons College, and Mother Church with its major extension.

The New York firm of McKim, Mead and White, designers of Symphony Hall (#1), built in 1900, were the leading exponents in this country of a style based on classical precedents, and later adapted the Italian Renaissance for both residential and public buildings. Plans for Symphony Hall were ripening during the construction of the Boston Public Library by the same firm. An earlier model of Symphony Hall calling for a Greek theater was exhibited in the Public Library, January 1894. Because of unknown acoustical properties of a hall of that shape, these plans were abandoned. Charles Follen McKim (1847-1909) while working on several Harvard buildings was approached by Henry Lee Higginson, founder of the Boston Symphony in 1881, to design a new home for the orchestra, because the Old Music Hall was no longer suitable. At the same time President Eliot of Harvard was urging Wallace Clement Sabine, Hollis Professor of Mathematics and Natural Philosophy at Harvard University, to accept the invitation of Major Higginson to give acoustical advice in the planning of a new Boston Music Hall. This cooperative effort between architect and scientist for the first time produced a music hall with rationally pre-planned acoustics, and which remains a monument to its designers. Sabine is responsible for the quantitative solution of reverberation phenomena, which is the basis of the acoustics in Symphony Hall. The Leipzig Gewandhaus served as a model for Boston, and as a result an exceptionally fine auditorium was designed. Additional acoustical advice was given by Charles Robert Cross, Thayer Professor of Physics at M.I.T., who collaborated with Sabine on some phases of research and at whose instigation the first electrical engineering curriculum in the United States leading to a degree was established at M.I.T.

UNITED STATES DEPARTMENT OF THE INTERIOR
NATIONAL PARK SERVICE

**NATIONAL REGISTER OF HISTORIC PLACES
INVENTORY -- NOMINATION FORM**

FOR NPS USE ONLY

RECEIVED

MAY 21 1975

DATE ENTERED

MAY 30 1975

CONTINUATION SHEET

ITEM NUMBER 8 & 9 PAGE 2

8) in 1882.

Horticultural Hall (#2), was designed and constructed by Wheelwright and Haven in 1901. The firm built numerous hospitals, schools, the New England Conservatory of Music Jordan Hall in 1901-3, Opera House, 1908 (demolished), the Massachusetts Historical Society, the Park Street Subway headhouses, and the amusing Lampoon Building in Cambridge, 1909. Edmund M. Wheelwright (1854-1912), a graduate of Harvard and M.I.T., also studied at the Ecole des Beaux Arts in Paris before working for Peabody and Stearns, and later for McKim, Mead, and White. His partnership with Parkman B. Haven was formed in 1890.

The Massachusetts Horticultural Society was chartered in 1829, but its aim and practices go back to colonial times when Gov. Winthrop in Charlestown and Gov. Endicott at Salem were extensive growers of fruit trees. The Society was founded "..... for the purpose of encouraging and improving the science and practice of horticulture, and promoting the amelioration of the various species of trees, fruits, plants, and vegetables, and the introduction of new species and varieties". One of the founding members of the Society, General H.A.S. Dearborn, who owned an 80 acre estate in Roxbury and was an avid exhibitor of rare fruits and flowers, was also the instigator of the rural cemetery movement in this country. In cooperation with Dr. Jacob Bigelow, Professor of the Application of Science to the Arts of Life at Harvard College, he became interested in the increasingly embarrassing conditions of the burial of the dead. Taking as an example Pere La Chaise cemetery in Paris, they persuaded the Society in 1831 to purchase the Brimmer land in Cambridge called "Sweet Auburn" and turned it into Mt. Auburn Cemetery.

The Society gradually had outgrown its earlier halls, the last one a French Renaissance palace (demolished) on Tremont Street near the Old Music Hall, which they sold at a handsome profit and subsequently bought the land on Huntington Avenue across from the new Symphony Hall. The new Horticultural Hall was dedicated on November 9, 1901 with the Chrysanthemum Exhibition.

The architects skillfully adapted Renaissance elements to local requirements of materials and scale in order to harmonize with Symphony Hall. Rather than being a competitor for attention with the Temple of Music across the street, this building reflects a more delicate and light approach featuring horticultural ornament - flowers, plants and fruit - in a happy combination of interior purpose and outward appearance.

9) -

3. Howe, M.A. DeWolfe. The Boston Symphony Orchestra. Houghton Mifflin Co., 1914.
4. Johnson, H.Earle. Symphony Hall, Boston. Little, Brown & Co. 1950.
5. Moore, Charles. The Life and Times of Charles Follen McKim. Houghton Mifflin Co., 1929.
6. Sabine, Wallace Clement. Collected Papers on Acoustics. Dover Publications, 1964.
7. Whitehill, Walter Muir. Boston, A Topographical History, Harvard Univ. Press, 1959.
8. Transactions of the Massachusetts Horticultural Society. Part II, 1901.

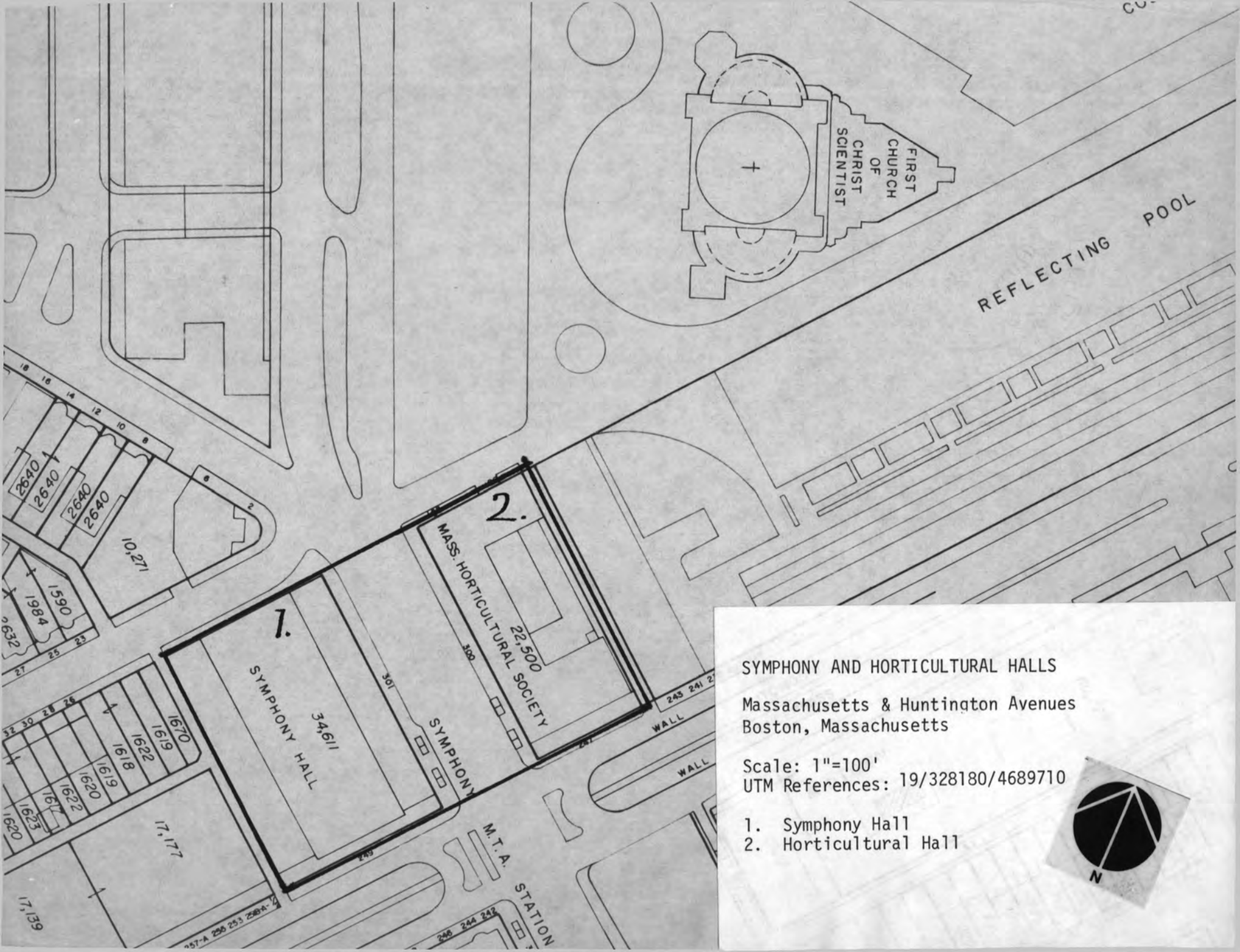

FIRST
CHURCH
OF
CHRIST
SCIENTIST

REFLECTING POOL

2.
MASS. HORTICULTURAL SOCIETY
22,500
368

1.
SYMPHONY HALL
34,611
361

SYMPHONY AND HORTICULTURAL HALLS

Massachusetts & Huntington Avenues
Boston, Massachusetts

Scale: 1"=100'
UTM References: 19/328180/4689710

- 1. Symphony Hall
- 2. Horticultural Hall



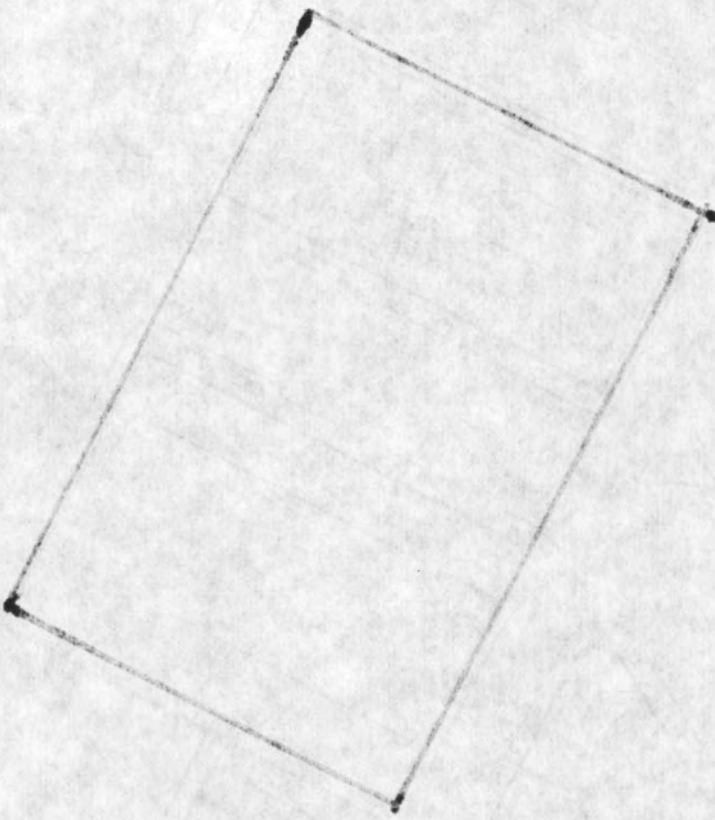
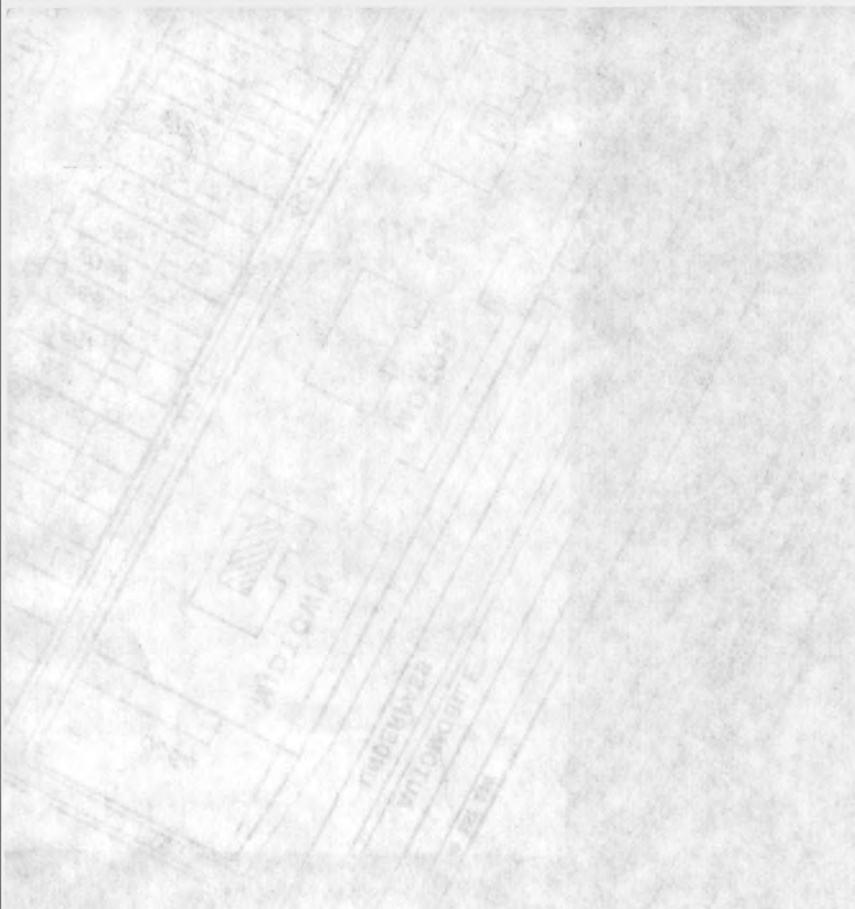

Property Symphony District

State Massachusetts Working Number 3,31,75,497

TECHNICAL

Photos 3
Maps 2

Could use recent photo #12 level of significance not checked.

otherwise OK 4.1.75

CONTROL

HISTORIAN

Should be 3 separate nominations.
This is not a district.

ARCHITECTURAL HISTORIAN

CONF. RETURN
H. J. Paul
4/3/75

ONCE THESE STRUCTURES WOULD HAVE BEEN PART OF LARGER CULTURAL DISTRICT. BUT, NOW PROBABLY BETTER REPRESENTED BY THREE NOMINATIONS.

ARCHEOLOGIST
CONF RETURN
LEBOVICH
4-3-75

OTHER

HAER

Inventory _____

Review _____

As per phone call to Betty Amador

REVIEW UNIT CHIEF

Return
Cole
4-8-74

BRANCH CHIEF

KEEPER

National Register Write-up _____

Send-back 4.8.75

Entered MAY 30 1975

Federal Register Entry _____

Re-submit 5.21.75

INT:2106-74

NAME OF PROPERTY Symphony District STATE 7-8-75

The attached National Register Inventory-Nomination form is being returned to your office for clarification of the information indicated below. PLEASE RETURN THIS FORM WHEN THE NOMINATION IS RESUBMITTED.

7 Description: _____

RECEIVED

APR 14 1975

MASS. HIST. COMM.

8 Statement of Significance: _____

9 Bibliography: _____

10 Geographical Data -- Acreage: _____

UTM Reference(s): _____

Verbal Boundary Description: _____

12 Certification: _____

Photographic Coverage: _____

Map Coverage: _____

x Other: As per phone call to Betty Amador 4-8 we are returning this for 3 separate nominations rather than a district nomination. Thank you.

Questions concerning this nomination may be directed to Kate Cole

on the National Register staff, telephone 523-5483

Thank you for your attention to the above items.

Charles A. [Signature]
Chief, Branch of Registration

Date: 4.9.75

INT:2105-74

Property Symphony and Horticultural Halls

2nd Control Sheet

State Mass.

Working Number 5.21.75.962

Suffolk

TECHNICAL

Photos 2

Maps 2

CONTROL

OK ^{cm} 5.23.75

HISTORIAN

Not significant for urban planning as stated. These 2 bldgs are architecturally related; I don't see any problem in nominating them together. Visually the 2 form a distinct complex.

ARCHITECTURAL HISTORIAN

ACCEPT HW and S/27/75

Explicit statement of architectural relationship. Unfortunately ~~no~~ no explicit statement of urban relationship.

ARCHEOLOGIST

Accept
Lebowich
5-28-75

OTHER

HAER

Inventory _____
Review _____

REVIEW UNIT CHIEF

Accept
Cole
5.29.75

BRANCH CHIEF

KEEPER

Hunt
for Mutt
5-26-75

National Register Write-up _____ Send-back _____
Federal Register Entry 7-1-75 Re-submit _____

Entered MAY 30 1975

INT:2106-74



UNITED STATES DEPARTMENT OF THE INTERIOR
NATIONAL PARK SERVICE

**NATIONAL REGISTER OF HISTORIC PLACES
PROPERTY PHOTOGRAPH FORM**

FOR NPS USE ONLY

RECEIVED MAY 21 1975

DATE ENTERED MAY 30 1975

SEE INSTRUCTIONS IN *HOW TO COMPLETE NATIONAL REGISTER FORMS*
TYPE ALL ENTRIES ENCLOSE WITH PHOTOGRAPH

1 NAME

HISTORIC Symphony and Horticultural Halls

AND/OR COMMON

2 LOCATION

CITY, TOWN Boston

VICINITY OF

COUNTY Suffolk

STATE MA

3 PHOTO REFERENCE

PHOTO CREDIT Boston Redevelopment Authority

DATE OF PHOTO 1969

NEGATIVE FILED AT Boston Redevelopment Authority

4 IDENTIFICATION

DESCRIBE VIEW, DIRECTION, ETC. IF DISTRICT, GIVE BUILDING NAME & STREET

PHOTO NO

Symphony Hall (#1) view looking west towards shorter Huntington Avenue facade and
lengthy Massachusetts Avenue (photo #1)

#1 of 2

PROPERTY OF THE NATIONAL REGISTER



UNITED STATES DEPARTMENT OF THE INTERIOR
NATIONAL PARK SERVICE

NATIONAL REGISTER OF HISTORIC PLACES
PROPERTY PHOTOGRAPH FORM

#3

FOR NPS USE ONLY	
RECEIVED	MAY 21 1975
DATE ENTERED	MAY 30 1975

SEE INSTRUCTIONS IN *HOW TO COMPLETE NATIONAL REGISTER FORMS*
TYPE ALL ENTRIES ENCLOSE WITH PHOTOGRAPH

1 NAME

HISTORIC Symphony and Horticultural Halls

AND/OR COMMON

2 LOCATION

CITY, TOWN Boston

____ VICINITY OF

COUNTY Suffolk

STATE MA

3 PHOTO REFERENCE

PHOTO CREDIT Boston Redevelopment Authority

DATE OF PHOTO 1969

NEGATIVE FILED AT Boston Redevelopment Authority, Boston MA

4 IDENTIFICATION

DESCRIBE VIEW, DIRECTION, ETC. IF DISTRICT, GIVE BUILDING NAME & STREET

PHOTO NO

View looking northerly at Horticultural Hall (#2) towards Massachusetts Avenue
entrance facade and Huntington Avenue side facade (photo #2)

2 of 2

PROPERTY OF THE NATIONAL REGISTER

UNITED STATES DEPARTMENT OF THE INTERIOR
NATIONAL PARK SERVICE

FOR NPS USE ONLY
RECEIVED MAY 21 1975
DATE ENTERED MAY 30 1975

**NATIONAL REGISTER OF HISTORIC PLACES
PROPERTY MAP FORM**

SEE INSTRUCTIONS IN *HOW TO COMPLETE NATIONAL REGISTER FORMS*
TYPE ALL ENTRIES -- ENCLOSE WITH MAP

1 NAME

HISTORIC Symphony and Horticultural Halls

AND/OR COMMON

2 LOCATION

CITY, TOWN Boston

___ VICINITY OF

COUNTY Suffolk

STATE MA

3 MAP REFERENCE

SOURCE U.S. Geological Survey

SCALE 1:24000

DATE 1970

4 REQUIREMENTS

TO BE INCLUDED ON ALL MAPS

1. PROPERTY BOUNDARIES
2. NORTH ARROW
3. UTM REFERENCES



Mapped, edited, and published by the Geological Survey
Control by USGS, USC&GS, and Massachusetts Geodetic Survey
Topography by plane-table surveys 1943. Revised from aerial photographs taken 1969. Field checked 1970
Selected topographic data compiled from USC&GS Charts 246 and 248 (1971). This information is not intended for navigational purposes
Polyconic projection. 1927 North American datum 10,000-foot grid based on Massachusetts coordinate system, mainland zone
1,000-meter Universal Transverse Mercator grid ticks, zone 19, shown in blue
Boundaries in tidewater areas from information supplied by Massachusetts Department of Public Works
Red tint indicates areas in which only landmark buildings are shown

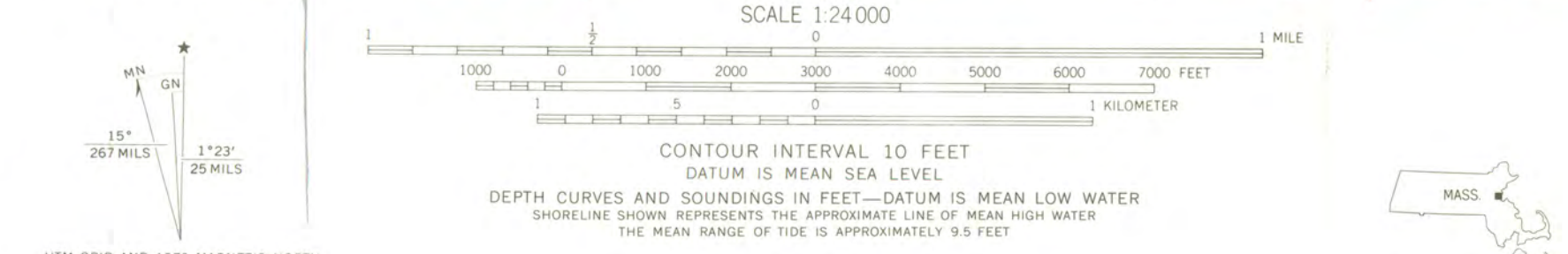

ROAD CLASSIFICATION

Primary highway, hard surface	Light-duty road, hard or improved surface
Secondary highway, hard surface	Unimproved road
Interstate Route	U. S. Route
	State Route

THIS MAP COMPLIES WITH NATIONAL MAP ACCURACY STANDARDS
FOR SALE BY U. S. GEOLOGICAL SURVEY, WASHINGTON, D. C. 20242
A FOLDER DESCRIBING TOPOGRAPHIC MAPS AND SYMBOLS IS AVAILABLE ON REQUEST

BOSTON SOUTH, MASS.
N4215—W7100/7.5
1970
AMS 6768 1 SE—SERIES V814



The Commonwealth of Massachusetts

Office of the Secretary

Massachusetts Historical Commission

Paul Guzzi

Secretary of the Commonwealth

40 Beacon Street Boston, Massachusetts 02108

727-8470



14 May 1975

Mr. Charles Harrington, Chief
Registration
National Register of Historic Places
National Park Service
US Department of the Interior
18th and C Streets, NW
Washington, DC 20240

CERTIFIED MAIL
APPORTIONMENT WARRANT
NOMINATION

Dear Charles:

Enclosed please find three National Register resubmissions for the following properties:

1. Boston, Symphony and Horticultural Halls
2. Worcester, Salisbury Mansion and Salisbury Store
3. Worcester, Salisbury House

These properties have been voted eligible for submission by the Massachusetts Historical Commission (the State Review Board) and have been signed by the State Historic Preservation Officer, Elizabeth R. Amadon.

Please note that the properties covered by these submissions plan to apply for FY '76 grants-in-aid. If you have any questions, please don't hesitate to call us.

Sincerely yours,

Patricia L. Weslowski
Survey Director
Massachusetts Historical Commission

PLW:jdd
Encl.

ENTRIES IN THE NATIONAL REGISTER

STATE **MASSACHUSETTS**

Date Entered **MAY 30 1975**

<u>Name</u>	<u>Location</u>
Symphony and Horticultural Halls	Boston Suffolk County
Salisbury Mansion and Salisbury Store	Worcester Worcester County

Also Notified

Hon. Edward M. Kennedy
Hon. Edward W. Brooke
Hon. John J. Moakley
Hon. Joseph D. Early
Regional Director, North-Atlantic
Region.

State Historic Preservation Officer
Mrs. Elizabeth R. Anadon
Executive Director
Massachusetts Historical Commission
40 Beacon Street
Boston, Massachusetts 02108

✓ PR

MMott/bsh

6/3/75

NOTIFICATION OF GRANT-IN-AID ACTION

Do Not
Use
This
Space

1. STATE APPLICATION IDENTIFIER

75050496

2. (Reserved for use by State central information reception agency)

3. GRANTOR: a. Federal agency

Department of the Interior

b. Organizational unit

National Park Service

c. Administering office - (1) Name

Division of Grants

(2) Address - Street or P.O. Box

18th and C Streets, NW.

City

Washington

State

D.C.

Zip Code

20240

4. FEDERAL AGENCY GRANT IDENTIFIER: a. Code

25-76-00317-00

b. Title

Symphony and Horticultural Halls:
Horticultural Hall Development

c. Purpose Project work will involve repairs and painting of windows, balcony rails, main hall door and fire doors.

5. GRANTEE: a. Name

Massachusetts Mrs. Elizabeth R. Amadon, Exec. Dir., MA Historical Commission

b. Address - Street or P.O. Box

294 Washington Street

City

Boston

State

MA

Zip Code

02108

6. GRANTEE TYPE (Check only the single most applicable box)

a. State b. Inter-state c. County d. City e. School district f. Special unit g. Community action h. Sponsored organization i. Other

7. APPLICATION RECEIPT DATE

Year Month Day
76 04 26

B. ACTION DATE

Year Month Day
76 5 24

9. EFFECTIVE STARTING DATE

Year Month Day
76 5 24

10. ENDING DATE

Year Month Day
79 5 23

11. TYPE OF ACTION (Check as many boxes as apply to this action)

a. New grant b. Continuation grant c. Supplemental grant (identify agency in item 16) d. Change in existing grant (1) Increase in duration (2) Decrease in duration (3) Cancellation (4) Increase(\$)
(5) Decrease(\$)

12. AMOUNT OF CONTRIBUTION

a. Federal - (1) basic

\$ 4,965

(2) Supplemental

\$

b. State

\$ 4,966*

c. Local

\$

d. Other

\$

13. CATALOG OF FEDERAL DOMESTIC ASSISTANCE PROGRAM (if none, clarify in item 16)

a. Program Number

15.904

b. Supplemental Program Number

14. AUTHORIZATION

a. Federal Budget Accounts

10-58-1040-0-1-405

b. Public Laws

PL Title Sec.
89 665

c. U.S. Code

16 U.S.C. 470

15. FACILITY LOCATION: (For facility grant actions only)

a. City 300 Massachusetts Ave., Boston

b. County

Suffolk

CD 9

16. REMARKS

*Massachusetts Horticultural Society

NR Data Sheet

DATE: 3/21/77
Reviewer INITIALS: *goff*
NR DOE May 30, 1975

NAME AS IT APPEARS IN FEDERAL REGISTER: ¹⁰ Symphony and Horticultural Halls

OTHER NAMES:

LOCATION:

STREET & NUMBER Massachusetts and Huntington Avenues
CITY/TOWN Boston CONGRESSIONAL DISTRICT 4th and 9th
STATE Massachusetts VICINITY OF COUNTY Suffolk code 025

OWNER OF PROPERTY: (Circle) PRIVATE STATE LOCAL GOV'T MUNICIPAL COUNTY OTHER

ADMINISTRATOR (underline) FEDERAL (AGENCY NAME):
NPS REGION: (CIRCLE) N. ATLANTIC MID ATLANTIC SOUTHEAST MIDWEST
SOUTHWEST ROCKY MOUNTAIN WEST PACIFIC NORTHWEST

FEATURES:

INTERIOR Substantially intact-1
- unknown - 4
- not applicable - 7
EXTERIOR Substantially intact-2
- unknown - 5
- not applicable - 8
ENVIRONS Substantially intact-3
- unknown - 6
- Not applicable-9

CONDITION - EXCELLENT DETERIORATED UNALTERED ORIGINAL SITE
 GOOD RUINS ALTERED MOVED
 FAIR UNEXPOSED Reconstructed Unknown
 Unexcavated Excavated

ACCESS - Yes-restricted Yes-unrestricted No access Unknown

historic district? YES NO

WITHIN NATIONAL REGISTER HISTORIC DISTRICT? YES NO
IF YES, NAME:

WITHIN NATIONAL HISTORIC LANDMARK? YES NO
IF YES, NAME:

ADAPTIVE USE: YES Saved? YES NO

FUNCTION(S): (use vocabulary words)

then- *entertainment, educational*
now- *same*

SIGNIFICANCE:

ARCHEOLOGY-PREHISTORIC CONSERVATION LAW/Gov't/politics RELIGION entertainment
 ARCHEOLOGY-HISTORIC ECONOMICS LITERATURE SCIENCE health
 AGRICULTURE EDUCATION MILITARY SOCIAL/HUMANITARIAN recreation
 ARCHITECTURE -4 ENGINEERING -11 MUSIC -19 TRANSPORTATION settlement
 ART EXPLORATION PHILOSOPHY OTHER (SPECIFY) socio/cultural
 COMMERCE INDUSTRY POLITICS/GOVERNMENT urban & commun
 COMMUNICATIONS INVENTION planning

Claims

"first" YES NO "oldest" YES NO "only" YES NO

Neo-Classical Revival and 2nd Renaissance Revival

ARCHITECTURAL STYLE:

architect/m.builder: McKim, Mead & White (auditorium)
landscape/garden designer: WHEELWRIGHT & HAVEN (Horticultural Hall) engineer: Charles Robert Cross -
interior decorator: artist/artisan: ^{acoustical Engineer - gave} advised on design of
builder/contractor: Symphony Hall

ETHNIC GROUP:

NAMES: personal
(label role & appropriate date)
events

institutional

DATES: DATE OF CONSTRUCTION (Specific date or 1/4 of century): 1900, 1901 (Horticultural Hall)
DATE(S) OF "MAJOR" ALTERATIONS:
HISTORICALLY SIGNIFICANT DATE(S):

SOURCE: (OF NOMINATION) PRIVATE STATE LOCAL GOV'T MUNICIPAL COUNTY
OTHER FEDERAL AGENCY:

ACREAGE: (to nearest tenth of an acre) 2

COMMENTS: (include architectural information here) BRICK, marble ornamentation, 2--5 STORIES, BASILICAL PLAN, GABLED ROOF, ~~FRONT CENTER 2-STORY TOWER~~ FRONT CENTER 2-STORY TOWER with faced double-doors entrances each with transom set, between columns, side opening articulated by round-arched recesses, 4th-story blind clerestory lunettes, blind gable-end roundel, corbeled cornice.

SIGNIFICANCE: (maximum two sentences)

NR Data Sheet
3-21-72

Continuation of Comments

✓ Horticultural Hall: Brick, granite and limestone trim; 2 story, rectangular, flat roof with ornate parapet, 3 pedimented entrances surmounted by wreaths, 1st-story round-arched windows, small balconies at ~~each~~ 2nd-story windows, bays articulated by 2-story Ionic pilasters, decorative frieze with festoons and blind panels, quoins. ~~Beau~~ Beau-Arts Classical elements. Excellent complement to

✓ Symphony Hall: brick, limestone, marble; 4-story main hall with 2-story flanking wings, gabled roof with pedimented ends, engaged front 2-story Ionic entrance portico, ~~the large~~ round-arched windows, clerestory lunettes, ~~corbeled~~ ^{cornice.} ~~cornish~~ ~~cornice~~ Interesting emblematic of ~~the~~ Romanesque Revival ~~and~~ Second Renaissance Revival elements. Features scientifically designed auditorium acoustics.