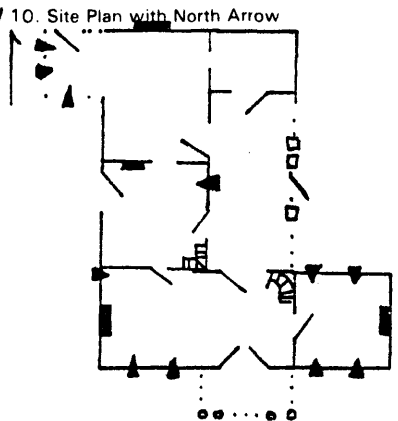

KENTUCKY HISTORIC RESOURCES INVENTORY

Site No. WS-16

1. Historic Name(s) Thomas H. Hamilton House		22. ADD/County Lincoln Trail/Wash. 1115	
Original Owner Thomas H. Hamilton		23. U.S.G.S. Quadrant (15'/75') St. Catherine G.I.S. Mgd. 098	
2. Present Name As above		24. UTM Reference 116 652520 4175470 Zone Easting Northing	
3. Location 3 mi. W. of Springfield on Hwy. 150		25. Coordinate Accuracy	
4. Owner's Name Mr & Mrs Ollie Barber, Jr.		26. Prehistoric Site Historic Site <u>Building</u>	
5. Owner's Address Rt. 2, Springfield, Ky. 40069		27. National Register District Name: N/A	
6. Open to Public Yes ___ No <u>X</u>		7. Visible from road Yes <u>X</u> No ___	
9. Local Contact/Organization Mrs. E. O. Kelly		8. Ownership Private <u>XX</u> Local ___ State ___ Federal ___	
10. Site Plan with North Arrow 		11. Architect unknown	
		12. Builder unknown	
		13. Date C. 1845 A. <u>3</u> B. ___	
		14. Style A. Grk. Rev. <u>C</u> B. ___	
		15. Original Use Sing. fam. res. <u>A</u>	
		16. Present use Sing. fam. res.	
		17. Condition Good <u>B</u>	
18. Description 5 bay, 2 story, brick, w/central pedimented 2 story portico; central entrance has transom, side lights, and corner lights on both stories; jack arches; limestone foundation; wooden window frames and sills; intern. end chimneys; transoms over doors on E. and W. in ell; 1 story brick (Continue on Back) (over)		No. Stories Two <u>C</u>	
		Single Pile <u>X</u> NA ___	
		Double Pile ___	
		Floor Plan Sing. pile/cent. <u>I</u>	
		Structural Fabric Brick <u>pass.</u> A. <u>C</u> B. ___	
		Decorative Fabric Common bond A. <u>E</u> B. ___	
		Roof Form Hip	
19. History House was built by the son of early Catholic settler Alexander Hamilton in ca. 1845.		28. Significance Evaluation NR <u>N</u>	
		29. Status National Landmark ___ Date ___ National Register ___ Landmark Certificate ___ Kentucky Survey ___ Local Landmark ___ HABS/HAER ___	
		30. Historic Theme Primary <u>Architecture</u> <u>C</u> Secondary ___ Other ___	
		31. Endangered Yes ___ No <u>X</u>	
		32. Preservation Project Status N/A Actual Cost in \$1,000s	
		33. ATTACH PHOTO Roll No. <u>12</u> Picture No. <u>32A-36A</u> Direction ___	
		34. Prepared by: Joe DeSpain	
20. Significance This property is significant under criterion C. It is a well-preserved example of the popular I-house form with particularly fine detailing.		35. Organization Green Co. Hist. Soc., Inc.	
		36. Date Jan., 1983	
21. Source of Information Imprints: <u>Hamilton and Allied Families</u>		37. Revision Dates 1/87	
		38. Staff Review	

DESCRIPTION: (cont.) outbuilding w/5 courses stretchers, 1 header;
segmental arches on openings;

INTERIOR: Simple mantels; paneled window aprons; transomed
doors; simple brackets on open string spiral stair in central
hall; shouldered architrave; decorative graining on upstairs
doors.



NOISSINWOOD
COMMISSION
EDWINER 175

1985

RECEIVED

KENTUCKY HISTORIC RESOURCE INVENTORY SUPPLEMENT
BOUNDARY AND LOCATION INFORMATION

Historic Property Name Thomas H. Hamilton Home Site # WS-16
Multiple Resource/Thematic Nomination Title Washington County Multiple Resource Area

U.T.M. Coordinates - List multiple UTMs if property is ten or more acres.

A. 16 _____ D. _____
B. _____ E. _____
C. _____ F. _____

Verbal Boundary Description _____ Acreage 1 acre

Point A is located on the north side of the U.S. 150 right of way, 100 feet west of the point where the Thomas Hamilton house driveway enters U.S. 150. Beginning at Point A, proceeding north 350 feet to northwest corner of brick outbuilding at Point B on a line corresponding to the west wall of the outbuilding, thence 100 feet east on a line corresponding to the north wall of the outbuilding to Point C, thence 350 feet south along a line corresponding to the east side of a drive to Point D, thence west 350 feet to the point of origin, along the north side of U.S. 150. The boundaries were drawn to include the house, lawn, and domestic-related space defined by the location of outbuildings, drive and highway. One non-contributing frame outbuilding and one contributing brick outbuilding of unidentified original function are included. The nominated area contains two contributing buildings and one non-contributing building.

Sketch of Site Plan (Showing outbuildings, structures, landscape features and the site boundary as described above.)

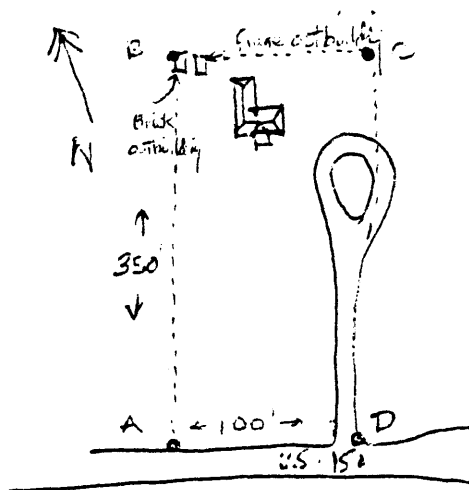

Official Courthouse Property Reference:

Washington County Courthouse, Springfield, Kentucky