

121  
1/3

C. NUMBER 82-196-0131

B. COUNTY Vanderburgh

A. NAME YWCA

F. QUAD SHEET Evansville South

D. ADDRESS 118 Vine Street

E. TOWN/CITY Evansville

G. SITE X STRUCTURE

H. NH

I. UTM Reference

J. HAER

K. HABS

L. NR

M. NHL

N. H

STATE OF INDIANA  
DEPARTMENT OF NATURAL RESOURCES  
INDIANA HISTORIC SITES AND STRUCTURES INVENTORY

1. HISTORIC NAME YWCA

2. OWNERSHIP: PUBLIC  PRIVATE

NAME Y.W.C.A. (EASEMENTS TO S.W. 90° E CITY)

ADDRESS \_\_\_\_\_

3. LOCATION NOTES \_\_\_\_\_

4. VISIBLE FROM PUBLIC RIGHT OF WAY: 20-11-10  YES  NO

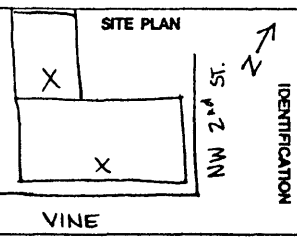

5. USE PRESENT PAST

Residential (sing.)	<input type="checkbox"/>	<input type="checkbox"/>
Residential (mult.)	<input type="checkbox"/>	<input type="checkbox"/>
Commerce	<input type="checkbox"/>	<input type="checkbox"/>
Industrial	<input type="checkbox"/>	<input type="checkbox"/>
Agriculture	<input type="checkbox"/>	<input type="checkbox"/>
Transportation	<input type="checkbox"/>	<input type="checkbox"/>
Organization	<input type="checkbox"/>	<input type="checkbox"/>
Military	<input type="checkbox"/>	<input type="checkbox"/>
Political	<input type="checkbox"/>	<input type="checkbox"/>
Unknown	<input type="checkbox"/>	<input type="checkbox"/>
Vacant	<input type="checkbox"/>	<input type="checkbox"/>
Other	<input type="checkbox"/>	<input type="checkbox"/>

6. CATEGORY  BUILDING(S) \_\_\_\_\_

7. ACCESSIBLE  YES/RESTRICTED \_\_\_\_\_

8. ENDANGERED  NO \_\_\_\_\_

9. DATE 1924 (CORNERSTONE)

10. ARCHITECT/BUILDER \_\_\_\_\_

11. PERIODS:  PREHISTORIC  17TH/18TH GEN.  1800-1880  1881-1899  1900-PRESENT

12. AREAS OF SIGNIFICANCE

<input type="checkbox"/> Archeology-Prehistoric	<input type="checkbox"/> Conservation	<input type="checkbox"/> Law	<input type="checkbox"/> Sculpture
<input type="checkbox"/> Archeology-Historic	<input type="checkbox"/> Economics	<input type="checkbox"/> Literature	<input checked="" type="checkbox"/> Social/Humanitarian
<input type="checkbox"/> Agriculture	<input type="checkbox"/> Education	<input type="checkbox"/> Military	<input type="checkbox"/> Theater
<input checked="" type="checkbox"/> Architecture	<input type="checkbox"/> Engineering	<input type="checkbox"/> Music	<input type="checkbox"/> Transportation
<input type="checkbox"/> Art	<input type="checkbox"/> Exploration/Settlement	<input type="checkbox"/> Philosophy	<input type="checkbox"/> Other (Specify) _____
<input type="checkbox"/> Commerce	<input type="checkbox"/> Industry	<input type="checkbox"/> Politics/Government	
<input type="checkbox"/> Communications	<input type="checkbox"/> Invention	<input type="checkbox"/> Religion	
<input type="checkbox"/> Community Planning	<input type="checkbox"/> Landscape Architecture	<input type="checkbox"/> Science	

13. STYLE  Federal  Greek Revival  Gothic Revival  Italianate  Second Empire  Stick Style/Eastlake  Queen Anne  Romanesque Revival  Colonial Revival  Neo-Classical  Bungalow  Vernacular  Other (Specify) \_\_\_\_\_

14. CONDITION  EXCELLENT  GOOD  FAIR  DETERIORATED  RUINS  UNEXPOSED

15. ALTERATIONS  UNALTERED  MINOR  MAJOR

16. SITE INTEGRITY  ORIGINAL SITE  MOVED DATE \_\_\_\_\_

17. OUTBUILDINGS/SECONDARY STRUCTURES  NO  YES

18. IN ESTABLISHED HISTORIC DISTRICT  NO  YES/NAME \_\_\_\_\_

19. DESCRIPTION OF ENVIRONMENT (NATURAL AND MAN-MADE) ACROSS FROM OLD U.S. POST OFFICE.

20. INFORMATION SOURCES TOWNSHIP ASSESSOR

21. PREPARED BY NANCY J. LONG 22. DATE 10/13/77

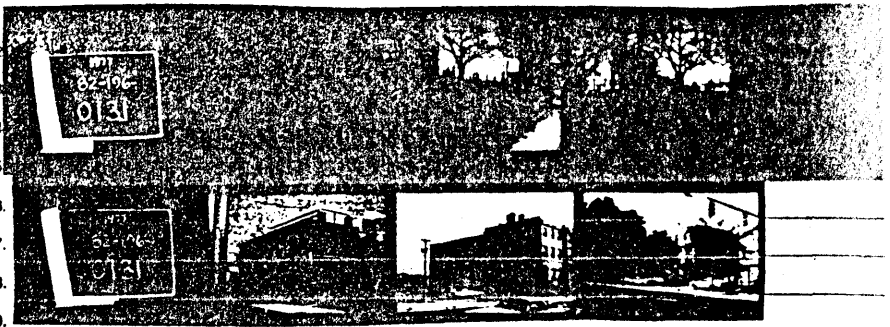

Architectural Information

17. THREE STORIES, ABOVE GRADE BASEMENT STORY. CENTRAL ENTRANCE.

18. ENGLISH BOND, DARK RED BRICK. STONE ENTABLATURE. STONE

19. BELT COURSE BETWEEN MAIN AND SECOND FLOOR. VERTICAL BRICKS

20. FORM BELT COURSE AT WATER TABLE LEVEL. WINDOW HEADS ARE

21. VERTICAL BRICKS. WINDOWS ARE DOUBLEHUNG, SIX OVER SIX

22. ARCHED ENTRANCE HAS BEEN MODERNIZED.

**STATE OF INDIANA  
DEPARTMENT OF NATURAL RESOURCES  
INDIANA HISTORIC SITES AND STRUCTURES INVENTORY**

Additional Architectural Information

**A. NAME** YWCA Building **C. NUMBER** 82-196-0131  
**B. ADDRESS** 118 Vine Street  
**D. UTM References** [1,6] [4,4,9,4,6,0] [4,2,0,2,6,7,0]

**E.**

This Tudor Revival edifice was constructed in 1924-25 according to the designs drawn up by W. F. Thompson and Miss B. G. Geary of New York. The Evansville newspapers boasted that the brick specified for the building (manufactured by the Standard Brick Company of Evansville) was made using wooden molds much in the same way as in 15th century Tudor England. The cost of the structure was announced to be \$200,000. The contractors were the respected local firm of Anderson and Veatch. Aside from any architectural significance, the association with the YWCA, an important benevolent institution, adds standing to this particular building.

**F. INFORMATION SOURCES** Evansville Courier, 20 Sept. 1925.

**G. PREPARED BY** Douglas L. Stern **H. DATE** 29 Jan 82