

KENTUCKY HISTORIC RESOURCES INVENTORY

79003508

Wa-11

1. Historic Name (s) **Andrew James Wardlaw House**

Original Owner **Andrew J Wardlaw\*\***

Present Name

3. Owner's Name **Frank Emit Strode**

4. Owner's Address **Rt. 1, Bekland Box 283**

5. Location **1/2 m S. of Rt. 31W; E. side Sunnyside-31W Rd.**

6. Open to Public Yes  No

7. Visible from road Yes  No

8. Ownership Private  Local  State  Federal

9. Local Contact/Organization

22. ADD/County **BARTON/WB**

23. Zoning Classification **Magisterial District**

24. U.S.G. S. Quadrant (15'/75') **Bristow**

25. UTM Reference  
Zone **116** Easting **561940** Northing **4099980**

26. Prehistoric Site  Object   
Historic Site  Structure

27. District Name: Yes  No

28. Significance Evaluation **National Register**

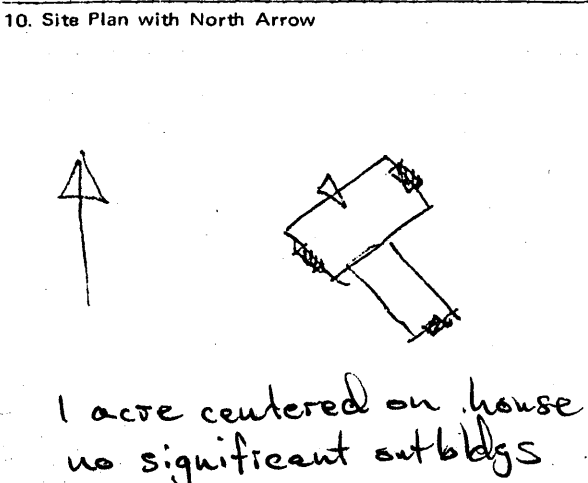

11. Architect

12. Builder **Andrew James Wardlaw\*\***

13. Date **1869\***

14. Style **Greek Revival**

15. Original Use **dwelling**

16. Present Use **dwelling**

17. Condition Interior **good** Exterior **fair-good**

29. Status National Landmark   
National Register   
Landmark Certificate   
Kentucky Survey   
Local Landmark   
HABS/HAER

30. Theme Primary **arch.** Secondary  Other

31. Endangered Yes  No

18. Description **2 story - 5 bay - brick - unbonded front - common bond sides - brick end chimneys - original 2 story ell - stone lintels and sills - transom and sidelights - partially exterior chimney at end of ell - central passage plan**



19. History **\*\* Built in 1869 by Andrew James Wardlaw after the original home burned in 1868 - His grandfather Andrew Wardlaw came to Warren from Ia. in 1818. - They purchased this property from Robert Lucas and it remained in the family until 1956. The Elder Andrew Wardlaw Sr. was one of the organizers of the First Presbyterian Church in Bowling Green - Later his son John Wardlaw (in 1853) built the Mission School and school on his farm in 1865.**



20. Significance **Both Andrew Wardlaw Sr and his son John Wardlaw were elders in the First Presbyterian Church of Bowling Green. Particularly clear illustration of a common style.**

34. Prepared by: **KTG-JCH**

35. Organization **KHC**

36. Date **Spring 1978**

21. Source of Information **\* Stone lintel above door**

**\* Sumpter, An Album of Early Warren County Landmarks**

37. Revision Dates  38. Staff Review

(over)

## Architecture

11. The most popular form in Greek Revival houses in this area--the I-house with a two-storied ell--is clearly evident in this well-proportioned houses because of the lack of later additions. It is one of the few houses in the county that carries its own date of construction, in the main entry lintel. The almost formulaic flat lintels of local Greek Revival houses are here rendered in stone.

