

KENTUCKY HISTORIC RESOURCES INVENTORY

Js-165

1. Historic Name (s) <b>Burrier house</b>		22. ADD/County <b>Bluegrass/Jessamine</b> <span style="float:right">□□□</span>	
Original Owner <b>Jacob Burrier</b>		23. Zoning Classification <b>Magisterial District</b>	
Present Name <b>The Maples</b>		24. U.S.G. S. Quadrant (15'/75') <b>Nicholasville</b>	
3. Owner's Name <b>First Security Trust</b>		25. UTM Reference <b>116 709300 4204520</b> <small>Zone Easting Northing</small>	
4. Owner's Address <b>One Security Plaza, Lexington, Ky. 40507</b>		26. Prehistoric Site <b>Historic Site</b> Object <b>Building</b> Structure	
5. Location <b>East side Keene-Troy Road; north of Keene</b>		27. District Yes <input type="radio"/> No <input checked="" type="radio"/>	
6. Open to Public Yes <input checked="" type="radio"/> No <input type="radio"/>	7. Visible from road Yes <input checked="" type="radio"/> No <input type="radio"/>	8. Ownership Private <input checked="" type="checkbox"/> Local <input type="checkbox"/> State <input type="checkbox"/> Federal <input type="checkbox"/>	
9. Local Contact/Organization		28. Significance Evaluation <b>National Register</b>	
10. Site Plan with North Arrow		29. Status National Landmark <input type="checkbox"/> National Register <input type="checkbox"/> Landmark Certificate <input type="checkbox"/> Kentucky Survey <input checked="" type="checkbox"/> <b>11/18/71</b> Local Landmark <input type="checkbox"/> HABS/HAER <input type="checkbox"/>	
11. Architect		30. Theme Primary <b>architecture</b> Secondary _____ Other _____	
12. Builder		31. Endangered Yes <input type="radio"/> No <input checked="" type="radio"/>	
13. Date <b>1861 *</b>		32. <span style="float:right">ATTACH PHOTO</span>	
14. Style <b>Gothic-Greek Revival</b> <span style="float:right">□□</span>		Roll No. <u>32</u>	
15. Original Use <b>house</b>		Picture No. _____	
16. Present Use <b>house</b>		Direction _____	
17. Condition <span style="float:right">□□</span> Interior excellent Exterior excellent		33. Tape No. _____ Negative No. _____	
18. Description <b>2-story, 3-bay, L-shaped house. Clapboarded frame construction. Main section has hipped roof. Double portico of square columns. Greek-Revival frontispieces with fluted pilasters. Double windows on front and sides - 4/4 panes. First floor retains 1 chaste Greek Revival mantle. Castellated (w/crenelation) moldings and mantel in west parlor. Dog-leg staircase with delicate cherry handrail and balusters. Hand-grained woodwork. Scalloped woodwork in pediment and on front and sides. Int. woodwork like of Js-157, -148, -151, -181; also see -24, -N-12, -N-20.</b>		34. Prepared by: <b>NCP - KTG</b>	
19. History		35. Organization <b>KHC</b>	
20. Significance <b>Architecture: the house is a particularly clear example of the blend of Greek and Gothic Revival popular locally in the mid-nineteenth century; the Greek is found in the form, exterior door surrounds and portico; and the Gothic is found in the central ridgeline chimneys, bargeboards and interior woodwork.</b>		36. Date <b>summer 1977</b>	
21. Source of Information <b>*1971 survey form</b>		37. Revision Dates _____ 38. Staff Review _____	

1877 atlas - J. Burrier

KENTUCKY HISTORIC RESOURCE INVENTORY SUPPLEMENT  
BOUNDARY AND LOCATION INFORMATION

Historic Property Name Jacob Burrier house Site # JK165  
Multiple Resource/Thematic Nomination Title Jessamine Co

U.T.M. Coordinates - List multiple UTMs if property is ten or more acres.

A. 16 709 470 4204 580 D. 16 709 120 4204 720  
B. 16 709 420 4204 290 E. \_\_\_\_\_  
C. 16 709 030 4204 460 F. \_\_\_\_\_

Verbal Boundary Description \_\_\_\_\_ Acreage 26 acres

*House within a.B.C.D as shown. B.C is with a fence, C.D is on the road.*

Sketch of Site Plan (Showing outbuildings, structures, landscape features and the site boundary as described above.)

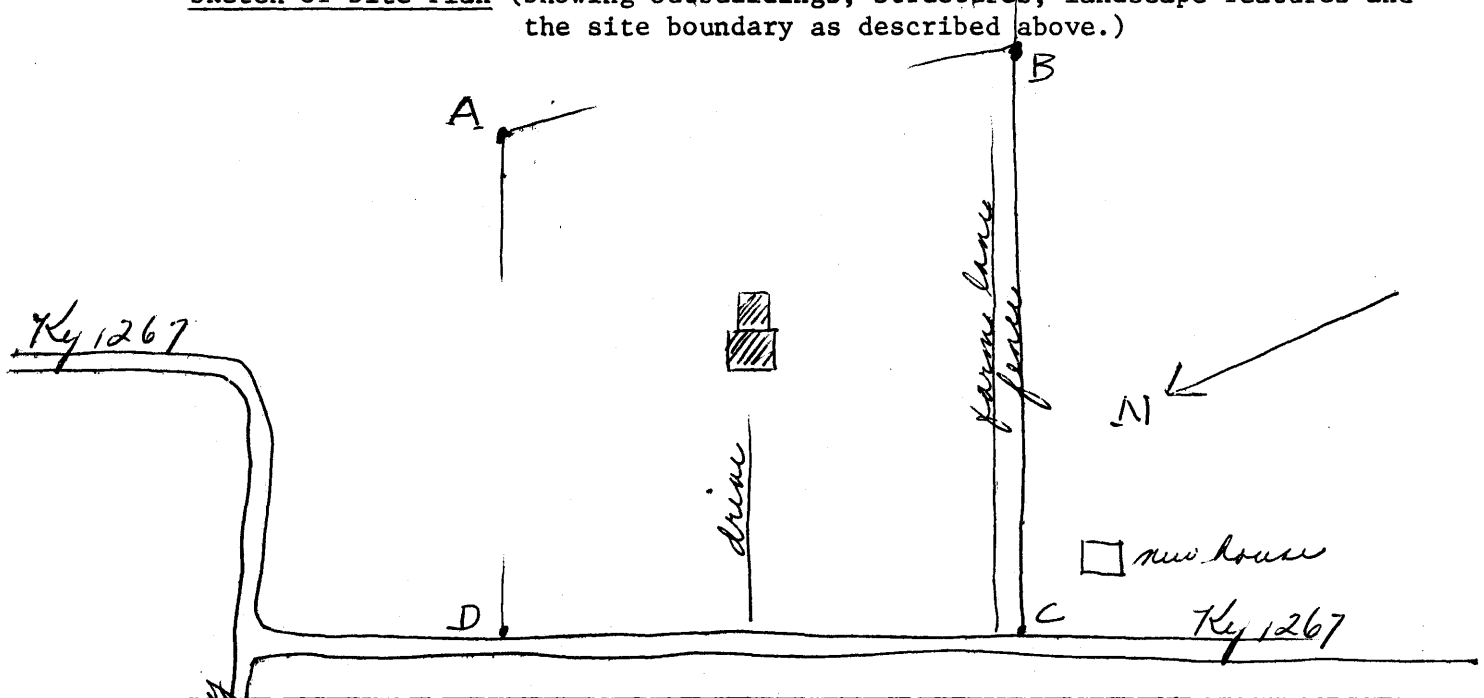

Official Courthouse Property Reference:

*Salmon Run Road*