

**United States Department of the Interior  
Heritage Conservation and Recreation Service**

**National Register of Historic Places  
Inventory—Nomination Form**

See instructions in *How to Complete National Register Forms*  
Type all entries—complete applicable sections

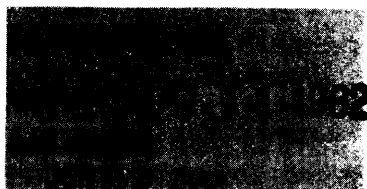

**1. Name**

historic Garfield Intermediate School  
and/or common Berkeley Unified School District Administration Building

**2. Location**

street & number 1414 Walnut Street \_\_\_ not for publication  
city, town Berkeley \_\_\_ vicinity of congressional district 8  
state California code 06 county Alameda code 001

**3. Classification**

| Category  | Ownership                                  | Status  | Present Use   |
|---|--|---|---|
| <input type="checkbox"/> district               | <input checked="" type="checkbox"/> public | <input checked="" type="checkbox"/> occupied          | <input type="checkbox"/> agriculture <span style="margin-left: 100px;"><input type="checkbox"/> museum</span>                       |
| <input checked="" type="checkbox"/> building(s) | <input type="checkbox"/> private           | <input type="checkbox"/> unoccupied                   | <input type="checkbox"/> commercial <span style="margin-left: 100px;"><input type="checkbox"/> park</span>                          |
| <input type="checkbox"/> structure              | <input type="checkbox"/> both              | <input type="checkbox"/> work in progress             | <input checked="" type="checkbox"/> educational <span style="margin-left: 100px;"><input type="checkbox"/> private residence</span> |
| <input type="checkbox"/> site                   | <b>Public Acquisition</b>                  | <b>Accessible</b>                                     | <input type="checkbox"/> entertainment <span style="margin-left: 100px;"><input type="checkbox"/> religious</span>                  |
| <input type="checkbox"/> object                 | <input type="checkbox"/> in process        | <input type="checkbox"/> yes: restricted              | <input type="checkbox"/> government <span style="margin-left: 100px;"><input type="checkbox"/> scientific</span>                    |
|   | <input type="checkbox"/> being considered  | <input checked="" type="checkbox"/> yes: unrestricted | <input type="checkbox"/> industrial <span style="margin-left: 100px;"><input type="checkbox"/> transportation</span>                |
|   | <u>N/A</u>                                 | <input type="checkbox"/> no                           | <input type="checkbox"/> military <span style="margin-left: 100px;"><input type="checkbox"/> other:</span>                          |

**4. Owner of Property**

name Berkeley Unified School District  
street & number 2134 Grove Street  
city, town Berkeley \_\_\_ vicinity of state California 94704

**5. Location of Legal Description**

courthouse, registry of deeds, etc. Alameda County Courthouse  
street & number 1225 Fallon Street  
city, town Oakland state California

**6. Representation in Existing Surveys**

1. State Historical Resources Inventory  
title 2. Berkeley Landmark Status has this property been determined eligible? \_\_\_ yes  no  
1. March 24, 1978  
date 2. April 4, 1980 \_\_\_ federal 1. state \_\_\_ county 2. local  
1. State Office of Historic Preservation  
depository for survey records 2. Department of Housing and Development  
1. Sacramento  
city, town 2. Berkeley state California



# 8. Significance

| Period                                    | Areas of Significance—Check and justify below    |   |   |  |
|---|--|---|---|--|
| <input type="checkbox"/> prehistoric      | <input type="checkbox"/> archeology-prehistoric  | <input type="checkbox"/> community planning     | <input type="checkbox"/> landscape architecture | <input type="checkbox"/> religion        |
| <input type="checkbox"/> 1400-1499        | <input type="checkbox"/> archeology-historic     | <input type="checkbox"/> conservation           | <input type="checkbox"/> law                    | <input type="checkbox"/> science         |
| <input type="checkbox"/> 1500-1599        | <input type="checkbox"/> agriculture             | <input type="checkbox"/> economics              | <input type="checkbox"/> literature             | <input type="checkbox"/> sculpture       |
| <input type="checkbox"/> 1600-1699        | <input checked="" type="checkbox"/> architecture | <input checked="" type="checkbox"/> education   | <input type="checkbox"/> military               | <input type="checkbox"/> social/         |
| <input type="checkbox"/> 1700-1799        | <input type="checkbox"/> art                     | <input type="checkbox"/> engineering            | <input type="checkbox"/> music                  | <input type="checkbox"/> humanitarian    |
| <input type="checkbox"/> 1800-1899        | <input type="checkbox"/> commerce                | <input type="checkbox"/> exploration/settlement | <input type="checkbox"/> philosophy             | <input type="checkbox"/> theater         |
| <input checked="" type="checkbox"/> 1900- | <input type="checkbox"/> communications          | <input type="checkbox"/> industry               | <input type="checkbox"/> politics/government    | <input type="checkbox"/> transportation  |
|   |  | <input type="checkbox"/> invention              |   | <input type="checkbox"/> other (specify) |

**Specific dates** 1915 **Builder/Architect** Ernest Coxhead

**Statement of Significance (In one paragraph)**

The Garfield Intermediate School is one of the last examples of the institutional work of recognized architect Ernest Coxhead. The building of Spanish Colonial Revival design is a fine early example of the California "outdoor" school. The Garfield is part of a 1915 building program initiated by the City of Berkeley. Five prominent bay area architects designed five schools, to be built on a limited budget.

Ernest Coxhead, along with Julia Morgan, Bernard Maybeck and others, designed buildings defined as the First Phase of the Bay Area Tradition. Born in England and educated at the Royal Institute of British Architects, Coxhead immigrated to Los Angeles in 1886 and to the Bay Area in 1890. The West greatly impressed Coxhead with its spaciousness, lack of tradition in the willingness of its people to try new things. Many of his early works for the Episcopal Diocese have been described by John Beach, a noted local architectural historian, as "one of the most fascinating series of buildings of the period; a group of powerful, original (and occasionally unsettling) church designs". After the mid-1890's Coxhead concentrated on residential design, where as with his churches, he played with space and scale. Of the four schools that Coxhead designed in his career, Garfield Intermediate is the only one remaining. It is one of the few Coxhead buildings remaining in the East Bay.

Garfield School is a fine and early example of the "outdoor" school: Many Californians felt that the state's benevolent climate called for a more open school plan than was traditionally accepted. The sunny sheltered courtyards and cool arched walkways of Garfield School provide a tranquil atmosphere conducive to thought and study, to California weather, openness and pleasant sun protection. The light and airy auditorium opens onto the courtyards through large French windows and the classroom windows can be opened wide to let the outdoors in. Garfield School has been called the most sophisticated version of the outdoor school in Northern California at the time of its construction.

The building's arcades and courtyards show a quiet delight in the play of light and shadow as well as a sensitivity to the use of materials. There is a timeless, almost poetical, quality here, likened by B. J. S. Cahill to a quality found in the original California missions. A quality he describes as "a largeness, seriousness, austerity and restraint coupled with a mellow decor that can best be paralleled in the monastic solemnity of the Gregorian chant or the plains song of Palestrina".

# 9. Major Bibliographical References

See Continuation Sheet

# 10. Geographical Data

Acreeage of nominated property Approximately 1 Acre

Quadrangle name Richmond, CA

Quadrangle scale 1:24000

UMT References

A 

|      |   |   |         |   |   |   |   |   |          |   |   |   |   |   |   |   |   |   |   |   |
|------|---|---|---------|---|---|---|---|---|----------|---|---|---|---|---|---|---|---|---|---|---|
| 1    | 1 | 0 | 5       | 6 | 4 | 4 | 3 | 1 | 0        | 4 | 1 | 7 | 9 | 1 | 2 | 7 | 1 | 8 | 1 | 0 |
| Zone |   |   | Easting |   |   |   |   |   | Northing |   |   |   |   |   |   |   |   |   |   |   |

B 

|      |  |  |         |  |  |  |  |  |          |  |  |  |  |  |  |  |  |  |  |  |
|------|--|--|---------|--|--|--|--|--|----------|--|--|--|--|--|--|--|--|--|--|--|
|      |  |  |         |  |  |  |  |  |          |  |  |  |  |  |  |  |  |  |  |  |
| Zone |  |  | Easting |  |  |  |  |  | Northing |  |  |  |  |  |  |  |  |  |  |  |

C 

|      |  |  |         |  |  |  |  |  |          |  |  |  |  |  |  |  |  |  |  |  |
|------|--|--|---------|--|--|--|--|--|----------|--|--|--|--|--|--|--|--|--|--|--|
|      |  |  |         |  |  |  |  |  |          |  |  |  |  |  |  |  |  |  |  |  |
| Zone |  |  | Easting |  |  |  |  |  | Northing |  |  |  |  |  |  |  |  |  |  |  |

D 

|      |  |  |         |  |  |  |  |  |          |  |  |  |  |  |  |  |  |  |  |  |
|------|--|--|---------|--|--|--|--|--|----------|--|--|--|--|--|--|--|--|--|--|--|
|      |  |  |         |  |  |  |  |  |          |  |  |  |  |  |  |  |  |  |  |  |
| Zone |  |  | Easting |  |  |  |  |  | Northing |  |  |  |  |  |  |  |  |  |  |  |

E 

|      |  |  |         |  |  |  |  |  |          |  |  |  |  |  |  |  |  |  |  |  |
|------|--|--|---------|--|--|--|--|--|----------|--|--|--|--|--|--|--|--|--|--|--|
|      |  |  |         |  |  |  |  |  |          |  |  |  |  |  |  |  |  |  |  |  |
| Zone |  |  | Easting |  |  |  |  |  | Northing |  |  |  |  |  |  |  |  |  |  |  |

F 

|      |  |  |         |  |  |  |  |  |          |  |  |  |  |  |  |  |  |  |  |  |
|------|--|--|---------|--|--|--|--|--|----------|--|--|--|--|--|--|--|--|--|--|--|
|      |  |  |         |  |  |  |  |  |          |  |  |  |  |  |  |  |  |  |  |  |
| Zone |  |  | Easting |  |  |  |  |  | Northing |  |  |  |  |  |  |  |  |  |  |  |

G 

|      |  |  |         |  |  |  |  |  |          |  |  |  |  |  |  |  |  |  |  |  |
|------|--|--|---------|--|--|--|--|--|----------|--|--|--|--|--|--|--|--|--|--|--|
|      |  |  |         |  |  |  |  |  |          |  |  |  |  |  |  |  |  |  |  |  |
| Zone |  |  | Easting |  |  |  |  |  | Northing |  |  |  |  |  |  |  |  |  |  |  |

H 

|      |  |  |         |  |  |  |  |  |          |  |  |  |  |  |  |  |  |  |  |  |
|------|--|--|---------|--|--|--|--|--|----------|--|--|--|--|--|--|--|--|--|--|--|
|      |  |  |         |  |  |  |  |  |          |  |  |  |  |  |  |  |  |  |  |  |
| Zone |  |  | Easting |  |  |  |  |  | Northing |  |  |  |  |  |  |  |  |  |  |  |

Verbal boundary description and justification : Block Number: 2261 Lot Number : 00101 located on the northeast corner of the block bounded by Walnut Street on the east, Vine Street on the south, Shattuck Avenue on the west, and Rose Street on the north.

List all states and counties for properties overlapping state or county boundaries

state N/A code county code

state N/A code county code

# 11. Form Prepared By

name/title Anthony Bruce and Kathleen Johnson

organization Berkeley Architectural Heritage date December 15, 1980

street & number P.O. Box 1137 telephone (415) 845-6591

city or town Berkeley state California 94701

# 12. State Historic Preservation Officer Certification

The evaluated significance of this property within the state is:

national  state  local

As the designated State Historic Preservation Officer for the National Historic Preservation Act of 1966 (Public Law 89-665), I hereby nominate this property for inclusion in the National Register and certify that it has been evaluated according to the criteria and procedures set forth by the Heritage Conservation and Recreation Service.

State Historic Preservation Officer signature [Signature]

title \_\_\_\_\_ date APR 20 1982

For HCRS use only  
I hereby certify that  
Keeper of the Records  
Attent:  
Clerk of

[Signature]

**NATIONAL REGISTER OF HISTORIC PLACES  
INVENTORY -- NOMINATION FORM**

FOR HCRS USE ONLY  
RECEIVED  
DATE ENTERED

CONTINUATION SHEET

ITEM NUMBER 9 PAGE 1

Architect and Engineer. "The City of Berkeley's New Public School Buildings",  
May 1916.

Beach, John. "Ernest Coxhead and the Regional Scene", San Francisco Heritage, 1974.

Beach, John. oral interview, December 1 and 10, 1980 in Atlanta, GA.

Beach, John. "Coxhead Tour Announcement" Berkeley Architectural Heritage Assn.,  
1978.

Berkeley Gazette. "Berkeley's Architectural Heritage", February 24, 1978.

California State Historical Inventory Form - March 23, 1978.

City of Berkeley Landmarks Commission Report - September 1980.

City of Berkeley Request for Designation as a Landmark - April 1980.

Waterman, S.D. History of the Berkeley Schools. Berkeley: The Professional  
Press, 1918.

# NATIONAL REGISTER OF HISTORIC PLACES INVENTORY -- NOMINATION FORM

|                   |
|-------------------|
| FOR HCRS USE ONLY |
| RECEIVED          |
| DATE ENTERED      |

CONTINUATION SHEET

ITEM NUMBER 10 PAGE (Sketch map)

ROSE ST.

SHATTUCK AVE.

WALNUT ST.

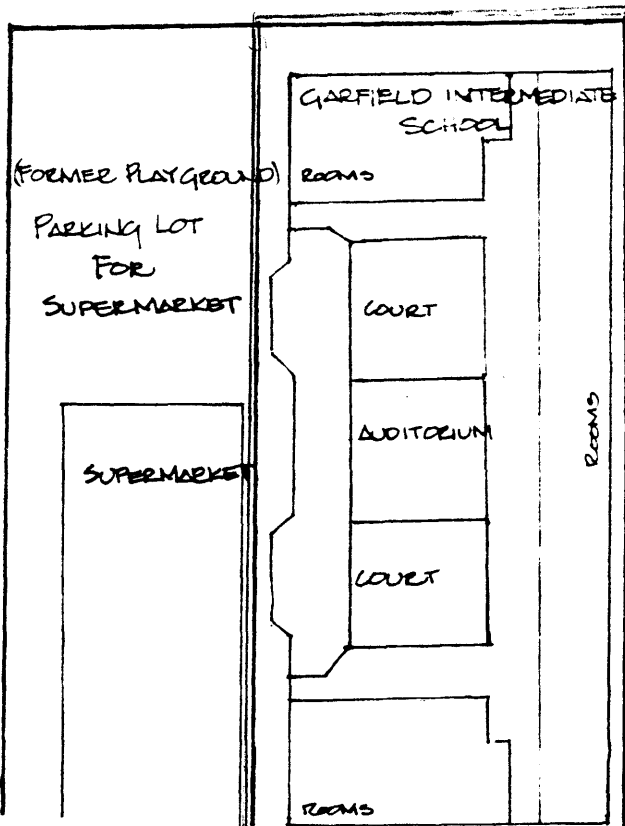

AREA MAP  
O COMMERCIAL  
O RESIDENTIAL

