

United States Department of the Interior  
National Park Service

RECEIVED

AUG 23 1993

NATIONAL  
REGISTER

# National Register of Historic Places Registration Form

This form is for use in nominating or requesting determinations for individual properties and districts. See instructions in *How to Complete the National Register of Historic Places Registration Form* (National Register Bulletin 16A). Complete each item by marking "x" in the appropriate box or by entering the information requested. If any item does not apply to the property being documented, enter "N/A" for "not applicable." For functions, architectural classification, materials, and areas of significance, enter only categories and subcategories from the instructions. Place additional entries and narrative items on continuation sheets (NPS Form 10-900a). Use a typewriter, word processor, or computer, to complete all items.

### 1. Name of Property

historic name Priebe, Walter, House

other names/site number \_\_\_\_\_

### 2. Location

street & number 155 7th Avenue East

n/a not for publication

city or town Twin Falls

n/a vicinity

state Idaho

code ID

county Twin Falls

code 083

zip code 83301

### 3. State/Federal Agency Certification

As the designated authority under the National Historic Preservation Act of 1986, as amended, I hereby certify that this  nomination  request for determination of eligibility meets the documentation standards for registering properties in the National Register of Historic Places and meets the procedural and professional requirements set forth in 36 CFR Part 60. In my opinion, the property  meets  does not meet the National Register criteria. I recommend that this property be considered significant  nationally  statewide  locally. (  See continuation sheet for additional comments.)

Signature of certifying official

Date

John R. Hill, State Historic Preservation Officer  
State or Federal agency and bureau

In my opinion, the property  meets  does not meet the National Register criteria. (  See continuation sheet for additional comments.)

Signature of commenting or other official

Date

State or Federal agency and bureau

### 4. National Park Service Certification

I, hereby, certify that this property is:

entered in the National Register.

See continuation sheet

determined eligible for the National Register.  See continuation sheet

determined not eligible for the National Register.

removed from the National Register.

other, (explain:) \_\_\_\_\_

Autumn with Alice

9/23/93

Signature of Keeper

Date of Action

Property Name Priebe, Walter, House

County and State Twin Falls County, Idaho

Page 2

**5. Classification**

Ownership of Property	Category of Property	No. of Resources within Property	
		contributing	noncontributing
<input checked="" type="checkbox"/> private	<input checked="" type="checkbox"/> building(s)	<u>1</u>	<u>    </u> buildings
<input type="checkbox"/> public-local	<input type="checkbox"/> district	<u>    </u>	<u>    </u> sites
<input type="checkbox"/> public-State	<input type="checkbox"/> site	<u>    </u>	<u>    </u> structures
<input type="checkbox"/> public-Federal	<input type="checkbox"/> structure	<u>    </u>	<u>    </u> objects
	<input type="checkbox"/> object	<u>1</u>	<u>0</u> Total

Name of related multiple property listing: n/a

No. of contributing resources previously listed in the National Register: 0

**6. Functions or Use**

Historic Functions (Enter categories from instructions.)

Cat: DOMESTIC  
\_\_\_\_\_  
\_\_\_\_\_  
\_\_\_\_\_

Sub: Single Dwelling/Residence  
\_\_\_\_\_  
\_\_\_\_\_  
\_\_\_\_\_

Current Functions (Enter categories from instructions.)

Cat: DOMESTIC  
\_\_\_\_\_  
\_\_\_\_\_  
\_\_\_\_\_

Sub: Single Dwelling/Residence  
\_\_\_\_\_  
\_\_\_\_\_  
\_\_\_\_\_

**7. Description**

Architectural Classification  
(Enter categories from instructions.)

Bungalow/Craftsman  
\_\_\_\_\_  
\_\_\_\_\_

Materials  
(Enter categories from instructions.)

foundation Stone: (lava rock)  
walls Weatherboard  
roof Wood: (shingles)  
other Concrete (steps)  
\_\_\_\_\_

Narrative Description (Describe the historic and current condition of the property on one or more continuation sheets.)

Property Name Priebe, Walter, House

County and State Twin Falls County, Idaho

**B. Statement of Significance**

Applicable National Register Criteria (Mark "x" in one or more boxes for the criteria qualifying the property for National Register listing.)

- A Property is associated with events that have made a significant contribution to the broad patterns of our history.
- B Property is associated with the lives of persons significant in our past.
- C Property embodies the distinctive characteristics of a type, period, or method of construction or represents the work of a master, or possesses high artistic values, or represents a significant and distinguishable entity whose components lack individual distinction.
- D Property has yielded, or is likely to yield, information important in prehistory or history.

Criteria Considerations (Mark "x" in all the boxes that apply.)

- A owned by a religious institution or used for religious purposes.
- B removed from its original location.
- C a birthplace or a grave.
- D a cemetery.
- E a reconstructed building, object, or structure.
- F a commemorative property.
- G less than 50 years of age or achieved significance within the past 50 years.

Areas of Significance  
(Enter categories from instructions.)

Architecture

---



---



---



---



---



---

Period of Significance

1912- 1920

---



---



---

Significant Dates

1912

1920

---



---

Cultural Affiliation

n/a

---



---

Significant Person

n/a

Architect/Builder

Unknown

Narrative Statement of Significance (Explain the significance of the property on one or more continuation sheets.)

Property Name Priebe, Walter, House

County and State Twin Falls County, Idaho

Page 4

**9. Major Bibliographical References**

(Cite the books, articles, and other sources used in preparing this form on one or more continuation sheets.)

Previous documentation on file (NPS):

- preliminary determination of individual listing (36 CFR 67) has been requested
- previously listed in the National Register
- previously determined eligible by the National Register
- designated a National Historic Landmark
- recorded by Historic American Buildings Survey # \_\_\_\_\_
- recorded by Historic American Engineering Record # \_\_\_\_\_

Primary location of additional data:

- State Historic Preservation Office
  - Other State agency
  - Federal agency
  - Local government
  - University
  - Other
- Specify repository: \_\_\_\_\_

**10. Geographical Data**

Acreeage of property Less than 1 acre

UTM References

1	<u>1/1</u>	<u>7/0/8/3/3/0</u>	<u>4/7/1/4/8/0/0</u>	3	<u>/</u>	<u>/</u>	<u>/</u>	<u>/</u>	<u>/</u>	<u>/</u>
	Zone	Easting	Northing		Zone	Easting	Northing			
2	<u>/</u>	<u>/</u>	<u>/</u>	4	<u>/</u>	<u>/</u>	<u>/</u>	<u>/</u>	<u>/</u>	<u>/</u>

     See continuation sheet

Verbal Boundary Description (Describe the boundaries of the property on a continuation sheet.)

Boundary Justification (Explain why the boundaries were selected on a continuation sheet.)

**11. Form Prepared By**

name/title Carolyn Burke/Ed Bourget, Architectural Interns

organization Twin Falls Historic Preservation Commission date May 3, 1993

street & number 168 Park Avenue telephone (208) 233-3616

city or town Pocatello state Idaho zip code 83201

**Additional Documentation**

Submit the following items with the completed form:

Continuation Sheets

Maps

- A USGS map (7.5 or 15 minute series) indicating the property's location.
- A sketch map for historic districts and properties having large acreage or numerous resources.

Photographs

Representative black and white photographs of the property.

Additional items (Check with the SHPO or FPO for any additional items.)

**Property Owner**

(Complete this item at the request of the SHPO or FPO.)

name \_\_\_\_\_

street & number \_\_\_\_\_ telephone \_\_\_\_\_

city or town \_\_\_\_\_ state \_\_\_\_\_ zip code \_\_\_\_\_

## National Register of Historic Places Continuation Sheet

Section number 7 Page 1 Name of Property Priebe, Walter, House  
County and State Twin Falls County, Idaho

---

The Walter Priebe house, built in 1912, is a Craftsman-style, one-and-one-half story, wood structure with a foundation and basement constructed of local lava rock. The house is located at 155 Seventh Avenue East, just outside of downtown Twin Falls. The home's major feature is a porch which extends across the front facade, wraps around and runs the full length of the southeast facade. The porch is capped on the front by a shallow, gabled roof and supported by battered, square, wood columns resting on battered piers composed of lava rock. Between piers, large wood casement windows, featuring three panes in the transoms, are divided by wide mullions. The porch, presently enclosed, remained an open feature until 1920-at which time the windows were installed.

A front-facing gable, containing three double-hung sash with upper sash divided by four muntins, dominates the massing and extends to the rear of the home's rectangular plan. The dominant gable is intersected at the southeast elevation by another gable containing three grouped double-hung sash identical to those found on the front gable. At the rear of the house is an enclosed porch with overlying, shed-roofed porch.

Both the front and rear gables are treated with stucco and applied "sticks" simulating half timbering--a treatment original to the home's first period of construction. The steepness of these gables, which allows for a second story in the attic, contrasts with the shallow, Craftsman-style pitch of the wrap-around porch. The porch, a 1920 modification, provides a true Craftsman counterpoint to the original core building which exhibits roofs and massing typical of turn-of-the-century architecture. Other design features which resulted from the 1920 remodeling was the integration of a garage at the rear of the east elevation; an enlarged, gabled dormer on the east roof; and the installation of windows between the lava rock piers. Exposed rafters and knee-brace brackets beneath soffits enhance the Craftsman theme.

A tall, slender brick chimney rises from the northwest side of the roof. The roof itself is clad with green, rolled asphalt which covers the original wood shingle roof. All siding is weatherboard which is badly deteriorated in many places. Lava rock used in the foundation and in piers was originally laid up with dark mortar featuring beaded joints. Many areas on both the south and east facades have been poorly repointed using a light colored, cement mortar which obscures much of the original beading.

The interior plan of the house is typical of the period, offering a main entry that leads directly into the living room--which in turn is open to the dining rooms. Bedrooms and the enclosed sun porch created by the porch enclosure open off of these principal social spaces. All of these rooms exhibit a high degree of wood craftsmanship that provides continuity of detailing throughout the house. The interior of the house retains its original period character, featuring dark woodwork, oak flooring, Mission Revival furniture and original Craftsman-style light fixtures. Most ornate is the living room which sports high mahogany wainscots and a trussed ceiling.

United States Department of the Interior  
National Park Service

## National Register of Historic Places Continuation Sheet

Section number 8 Page 1 Name of Property Priebe, Walter, House  
County and State Twin Falls County, Idaho

---

The Walter Priebe house is an important benchmark of the Arts and Crafts movement in Twin Falls. The home is significant under Criterion C as a well-preserved, local example of Craftsman style remodeling applied to an earlier, cross-gabled design and, therefore, denotes the growing popularity of this style in Twin Falls during this period.

The community's major growth period during the first two decades of the century coincided with the national trend toward Craftsman and Bungalow residential designs--many of the town's neighborhoods present a veritable catalog of Bungalow style houses featuring imaginative gable and porch treatments. The original core of the Priebe house, a 1912 plan more typical of preceding decades, blends an earlier design with Craftsman embellishments applied in the 1920s. The home is situated in a context of bungalows which exemplify the broad impact of the Craftsman style's first appearance on homes such as the Priebe house.

The original occupant of the house, Walter Priebe, is remembered for business and civic endeavors. Born May 23, 1881 near Rochester, Minnesota, Priebe attended the St. Louis School of Watchmaking. In 1905 he went to Waterville, Washington where he was employed by Antoine Guibert. The following year Guibert and Priebe came to Twin Falls and by May of 1908 had opened the city's first jewelry store. In 1909 Priebe bought out Guibert and became sole proprietor of the business, which he moved from Main Avenue to the Shoshone Street side of the current Twin Falls Bank and Trust Building. His jewelry store was located in several downtown business blocks and he later maintained a watch repair business in his residence for many years.

Mr. Priebe belonged to the Commercial Club, an early-day businessmen's organization, and was a charter member of both the Elks Lodge and Rotary Club of Twin Falls. He helped form the first local sportsmen's group and was instrumental in construction of the fish hatchery in Rock Creek, now operated by the College of Southern Idaho. His most important role as a civic leader was as the organizer of the first Twin Falls Public Library.

Though somewhat deteriorated from neglect, the Priebe house presents a high level of integrity of both interior and exterior design elements. The home is a significant commentary on the manner in which residents of Twin Falls adapted existing architecture to the growing force of Craftsman-style residential design--a style which characterizes many of the community's neighborhoods today.

## National Register of Historic Places Continuation Sheet

Section number 9 Page 1 Name of Property Priebe, Walter, House

County and State Twin Falls County, Idaho

---

*Evening Times.* Twin Falls, Idaho, October 30, 1987.

Photographs in personal collection of James Priebe.

*Polk's Twin Falls City and County Directory, 1908-09.* Salt Lake City, Utah, 1909.

Priebe, James. Personal communication. 9 May 1992, 6 June 1992.

Reconnaissance Site Survey of Architectural Properties. Twin Falls Historic Preservation Commission, 1989.

Sanborn 1922 plot map of Twin Falls.

Scott, Donna. *Tribute to the Past; Legacy of the Future.* Caldwell, Idaho: Caxton Press, 1990.

Wright, Patricia. *Twin Falls County; A Look at Idaho Architecture.* Boise, Idaho: Idaho State Historic Preservation Office, 1979.

United States Department of the Interior  
National Park Service

# National Register of Historic Places Continuation Sheet

Section number 10 Page 1 Name of Property Priebe, Walter, House  
County and State Twin Falls County, Idaho

---

## VERBAL BOUNDARY DESCRIPTION

The nomination includes the Walter Priebe House and the property on which it is located: Twin Falls Town Site SE half of Lot 15; Lot 16 Block 7, which is 75' x 125' in size.



United States Department of the Interior  
National Park Service

# National Register of Historic Places Continuation Sheet

Section number 10 Page 2 Name of Property Priebe, Walter, House  
County and State Twin Falls County, Idaho

---

## BOUNDARY JUSTIFICATION

Boundaries for the nomination include the entire city lot that has historically been associated with the property of the Walter Priebe residence.

WALTER PRIEBE HOUSE • not to scale

ALLEYWAY

APPROXIMATE  
PROPERTY LINES

2

PARKING  
LOT

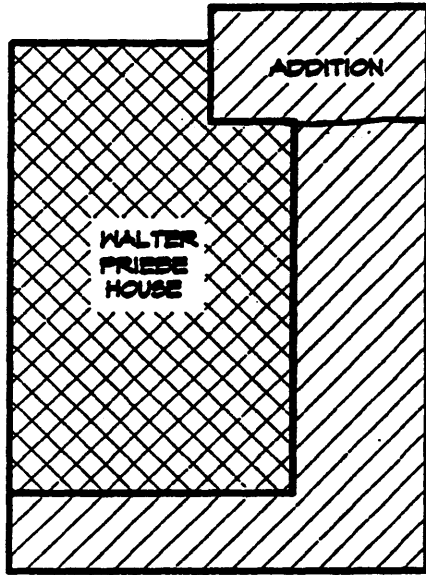

2 ND. ST. S.

3

4

1

SIDEWALK

PARKING

7 TH. AVE. E.

