

**United States Department of the Interior
National Park Service**

**National Register of Historic Places
Continuation Sheet**

Section number _____ Page _____

SUPPLEMENTARY LISTING RECORD

NRIS Reference Number: 93000600

Date Listed:

Cedar Haven
Property Name

Marengo
County

AL
State

Plantation Houses of the Alabama Canebrake and
Their Associated Outbuildings (1818-1942)
Multiple Name

This property is listed in the National Register of Historic Places in accordance with the attached nomination documentation subject to the following exceptions, exclusions, or amendments, notwithstanding the National Park Service certification included in the nomination documentation.

for Patricia W. Andrews
Signature of the Keeper

7/13/93
Date of Action

=====
Amended Items in Nomination:

U.T.M./USGS Map: The correct U.T.M. coordinates for the southern boundary of the property are:
C 16 444240 3585650
D 16 445080 3585660

The USGS Quad has been changed to reflect these boundaries, which correspond to the entire 319-acre parcel being nominated.

This information was confirmed with Melanie Betz of the AL SHPO.

DISTRIBUTION:

- National Register property file
- Nominating Authority (without nomination attachment)

United States Department of the Interior
National Park Service

RECEIVED

FEB 12 1993

National Register of Historic Places
Registration Form

JUN 2 1993

NATIONAL
REGISTER

Ala. Historical Commission

This form is for use in nominating or requesting determinations for individual properties and districts. See instructions in *How to Complete the National Register of Historic Places Registration Form* (National Register Bulletin 16A). Complete each item by marking "x" in the appropriate box or by entering the information requested. If an item does not apply to the property being documented, enter "N/A" for "not applicable." For functions, architectural classification, materials, and areas of significance, enter only categories and subcategories from the instructions. Place additional entries and narrative items on continuation sheets (NPS Form 10-900a). Use a typewriter, word processor, or computer, to complete all items.

1. Name of Property

historic name Cedar Haven
other names/site number Houston Alexander Place

2. Location

street & number Marengo County Road 61 N/A not for publication
city or town Faunsdale vicinity
state Alabama code AL county Marengo code 091 zip code 36738

3. State/Federal Agency Certification

As the designated authority under the National Historic Preservation Act, as amended, I hereby certify that this nomination request for determination of eligibility meets the documentation standards for registering properties in the National Register of Historic Places and meets the procedural and professional requirements set forth in 36 CFR Part 60. In my opinion, the property meets does not meet the National Register criteria. I recommend that this property be considered significant nationally statewide locally. (See continuation sheet for additional comments.)

[Signature] 5-25-93
Signature of certifying official/Title Date
Alabama Historical Commission (State Historic Preservation Office)
State of Federal agency and bureau

In my opinion, the property meets does not meet the National Register criteria. (See continuation sheet for additional comments.)

[Signature]
Signature of certifying official/Title Date
State or Federal agency and bureau

4. National Park Service Certification

I hereby certify that the property is:

<input checked="" type="checkbox"/> entered in the National Register. <input type="checkbox"/> See continuation sheet.	Signature of the Keeper <u>Patrick Ardus</u>	Date of Action <u>7/13/93</u>
<input type="checkbox"/> determined eligible for the National Register. <input type="checkbox"/> See continuation sheet.		
<input type="checkbox"/> determined not eligible for the National Register.		
<input type="checkbox"/> removed from the National Register.		
<input type="checkbox"/> other. (explain) _____		

Cedar Haven
Name of Property

Marengo County, Alabama
County and State

5. Classification

Ownership of Property
(Check as many boxes as apply)

- private
- public-local
- public-State
- public-Federal

Category of Property
(Check only one box)

- building(s)
- district
- site
- structure
- object

Number of Resources within Property
(Do not include previously listed resources in the count.)

Contributing	Noncontributing	
3	0	buildings
		sites
		structures
		objects
3	0	Total

Name of related multiple property listing
(Enter "N/A" if property is not part of a multiple property listing.)

Plantations of the Alabama Canebrake and their associated outbuildings 1818-1942

Number of contributing resources previously listed in the National Register

0

6. Function or Use

Historic Functions

(Enter categories from instructions)

Domestic/single dwelling
Domestic/secondary structure
Domestic/secondary structure

Current Functions

(Enter categories from instructions)

Domestic/single dwelling/vacant
Domestic/secondary structure/vacant
Domestic/secondary structure/vacant

7. Description

Architectural Classification

(Enter categories from instructions)

Mid-19th Century:Greek Revival

Materials

(Enter categories from instructions)

foundation Brick
walls Walls
Weatherboard
roof Asphalt
other _____

Narrative Description

(Describe the historic and current condition of the property on one or more continuation sheets.)

8. Statement of Significance

Applicable National Register Criteria
(Mark "x" in one or more boxes for the criteria qualifying the property for National Register listing.)

Areas of Significance
(Enter categories from instructions)

Architecture

Period of Significance

c. 1850

Significant Dates

c. 1850

Significant Person

(Complete if Criterion B is marked above)

N/A

Cultural Affiliation

N/A

Architect/Builder

N/A

Criteria Considerations
(Mark "x" in all the boxes that apply.)

Property is:

- A owned by a religious institution or used for religious purposes.
- B removed from its original location.
- C a birthplace or grave.
- D a cemetery.
- E a reconstructed building, object, or structure.
- F a commemorative property.
- G less than 50 years of age or achieved significance within the past 50 years.

Narrative Statement of Significance
(Explain the significance of the property on one or more continuation sheets.)

9. Major Bibliographical References

Bibliography

(Cite the books, articles, and other sources used in preparing this form on one or more continuation sheets.)

Previous documentation on file (NPS): N/A

Primary location of additional data:

- preliminary determination of individual listing (36 CFR 67) has been requested
- previously listed in the National Register
- previously determined eligible by the National Register
- designated a National Historic Landmark
- recorded by Historic American Buildings Survey # _____
- recorded by Historic American Engineering Record # _____

- State Historic Preservation Office
- Other State agency
- Federal agency
- Local government
- University
- Other

Name of repository:

Cedar Haven
Name of Property

Marengo County, Alabama
County and State

10. Geographical Data

Acreage of Property 319 acres

UTM References

(Place additional UTM references on a continuation sheet.)

1 1 6 4 4 4 2 0 0 3 5 8 7 2 6 0
Zone Easting Northing

3 1 6 4 4 4 2 4 0 3 5 8 6 3 6 0
Zone Easting Northing

2 1 6 4 4 5 0 2 0 3 5 8 7 2 8 0

4 1 6 4 4 5 0 6 0 3 5 8 6 3 8 0

See continuation sheet

Verbal Boundary Description

(Describe the boundaries of the property on a continuation sheet.)

Boundary Justification

(Explain why the boundaries were selected on a continuation sheet.)

11. Form Prepared By

name/title Jeff Mansell; Melanie Betz/AHC Reviewer - 205/242-3184

organization Cahaba Trace Commission date February 9, 1993

street & number Route 1, Box 147 telephone (205) 665-7982

city or town Brierfield state Alabama zip code 35035

Additional Documentation

Submit the following items with the completed form:

Continuation Sheets

Maps

A USGS map (7.5 or 15 minute series) indicating the property's location.

A Sketch map for historic districts and properties having large acreage or numerous resources.

Photographs

Representative black and white photographs of the property.

Additional items

(Check with the SHPO or FPO for any additional items)

Property Owner

(Complete this item at the request of SHPO or FPO.)

name Joseph Gandy

street & number 2216 Gay Way telephone (205) 823-6210

city or town Vestavia state Alabama zip code 35216

Paperwork Reduction Act Statement: This information is being collected for applications to the National Register of Historic Places to nominate properties for listing or determine eligibility for listing, to list properties, and to amend existing listings. Response to this request is required to obtain a benefit in accordance with the National Historic Preservation Act, as amended (16 U.S.C. 470 et seq.).

Estimated Burden Statement: Public reporting burden for this form is estimated to average 18.1 hours per response including time for reviewing instructions, gathering and maintaining data, and completing and reviewing the form. Direct comments regarding this burden estimate or any aspect of this form to the Chief, Administrative Services Division, National Park Service, P.O. Box 37127, Washington, DC 20013-7127; and the Office of Management and Budget, Paperwork Reduction Projects (1024-0018), Washington, DC 20503.

United States Department of the Interior
National Park ServiceNational Register of Historic Places
Continuation SheetSection number 7 Page 1Cedar Haven Plantation
Marengo County, AL

Presently undergoing a complete restoration, Cedar Haven plantation, also known as the Houston Alexander place, is located approximately three miles south of Faunsdale on Marengo County Road 61, east of state highway 25. Constructed circa 1850, the plantation complex rests on a cedar covered rise set back the road. The main house is a significant example of Greek Revival architecture while the two contributing outbuildings are good representations of vernacular agricultural structures.

The main house is a frame, two story rectangular block with a side gable roof and two interior brick chimneys. The house was constructed using mortise and tenon construction. The roof material is asphalt shingles. Dominating the front facade is a full height pedimented portico supported by four tall Doric columns. The portico spans three of the five bays of the facade. In an arrangement unique among Canebrake plantation houses, the main house at Cedar Haven features three front entrances, a central double leaf entrance with transom flanked by single leaf entrances with transoms. The three entrances on the first floor of the facade reinforce the theory that porches were often used as outdoor living areas. The unusual number of entrance doors allowed easy egress to the front portico. Windows on the facade of the house have a 9/9 pane configuration while the remainder, those on the side and rear, are 6/9 pane configuration. The upper floor of the front facade features a central double leaf entrance with transom which opens onto a partial width balcony. The side elevations are identical with two upper bays and four lower bays. The two interior bays of the first floor are single leaf entrances with transoms. A shed roof porch is positioned in front of the two doors. The shed porch on the northern elevation had been enclosed as a bath room but the addition has recently been removed and the porch appears as it did upon construction. The rear facade features an original shed roofed extension with end rooms connected by an open porch. A later shed roof carport with concrete posts has been attached to the rear.

The main house features a common floorplan, a central hall with flanking double rooms. Each room features simple wooden mantles with subtle Greek Revival detailing. The central hall contains a straight run staircase which rises along the left wall. The rear entrance of the central hall features double folding doors and a full width transom. The interior of the house has been covered in particle board. Access to the rear rooms at the opposite ends of the rear extension is from the porch. The rear porch features decorative lattice work screens.

United States Department of the Interior
National Park Service

National Register of Historic Places Continuation Sheet

Section number 7 Page 2

Cedar Haven Plantation
Marengo County, AL

Located immediately behind the main house are two contributing outbuildings, a storehouse and a smokehouse. A plantation office building, located immediately to the south of the main house, was destroyed. The storehouse is a simple rectangular building with a gable roof. The smokehouse is a square building with a pyramidal roof and a shed addition.

Cedar Haven retains much of its integrity in regard to design, construction, material, and retains a high degree of integrity in regard to feeling, location, setting, and sense of place. The main house is a significant example of a Greek Revival plantation dwelling while the outbuildings are good examples of vernacular plantation outbuildings. The Cedar Haven plantation complex contains three contributing buildings.

United States Department of the Interior
National Park Service

National Register of Historic Places Continuation Sheet

Section number 8 Page 3

Cedar Haven Plantation
Marengo County, AL

Significance Statement

Criterion C: Architecture

Cedar Haven plantation is significant under National Register Criterion C as a good example of a Canebrake plantation complex. Constructed around 1850, the main house of the plantation is a significant example of a Greek Revival plantation house while the two remaining outbuildings are good examples of plantation outbuildings. The complex retains a high degree of integrity in regard to craftsmanship, materials, and design, as well as conveying a sense of time and place.

Historical Summary

In 1816, Philip Weaver moved to the Mississippi Territory as an agent for a Baltimore mercantile firm which was conducting a profitable trade with the Indians. Weaver became a prosperous planter and owned considerable lands in present day Bibb, Perry, Dallas, and Marengo counties as well as a number of mercantile establishments in Selma. Weaver was a member of a team of United States surveyors who were exploring and charting the lands of the interior of Alabama, including the area known as the Canebrake. While the land was considered fertile, the survey team was concerned about the apparent lack of water in the region during the long, dry summer months. According to John Witherspoon Dubose, Philip Weaver happened upon a cabin in the Canebrake at which the inhabitants caught rainwater in large barrels. Weaver then realized that the answer to the problem of water shortage was through the creation of elaborate cistern systems. Weaver then began to purchase large tracts of land in and around Uniontown, Alabama. Indeed, Weaver, from Uniontown, Maryland, suggested the name of his hometown to replace the name of the community of Woodville.

Philip Weaver's principal residence was in Selma and therefore, Cedar Haven was strictly used as a plantation house, occupied by the Weaver family upon residence at the plantation. Construction of the main house began around 1850. Weaver died in Selma after receiving a blow to the head from the stock of a carbine rifle wielded by Federal troops. After Philip Weaver's death, the plantation passed to his two brothers but was soon purchased by the Alexander family. The Alexanders retained possession of Cedar Haven until the 1980s when it was purchased by Courtney Judd. In 1991, Joseph Gandy purchased a tract of land comprising 319 acres of the original Cedar Haven plantation. Mr. Gandy has undertaken the restoration of Cedar Haven plantation. ¹

Archeological potential

Although no formal archeological survey has been made at the Cedar Haven plantation, the potential for subsurface remains may be high. Properties of this type were sited within a constellation of dependencies such as kitchens and other outbuildings. Buried portions may contain significant information that may be useful in interpreting the entire property.

¹John Witherspoon Dubose, "Chronicles of the Canebrake," Alabama Historical Quarterly, Winter, 1947, pp. 679-680. Map of Marengo County, Alabama. Rockford Map Publications, Inc., 1983, p. 49.

United States Department of the Interior
National Park Service

National Register of Historic Places Continuation Sheet

Section number 10 Page 4

Cedar Haven Plantation
Marengo County, AL

Verbal Boundary Description

The western half of Section 28, Township 17, Range 4 East, comprising approximately 319 acres, being the said tract of land conveyed from the estate of Houston Alexander to Courtney Judd and being the same said tract of land conveyed by the Farmers Home Administration to Joseph Gandy. For exact boundaries, please see tax map.

Boundary Justification

The boundaries were drawn to include the remaining acreage of the original tract of land comprising the Cedar Haven plantation and to include all historic resources contained within the tract of land associated with the creation and development of the Cedar Haven plantation.

United States Department of the Interior
National Park Service

**National Register of Historic Places
Continuation Sheet**

Section number Photograph Page 5

Cedar Haven Plantation
Marengo County, AL

Photographs

The information contained within sections #1-5 is the same for photographs 1-9.

1. Cedar Haven plantation
2. Faunsdale vicinity, Marengo County, Alabama
3. Christine Rottmeir, photographer
4. Negatives on file, Alabama Historical Commission
5. Fall, 1989: There has been no change to the property since a site visit on October 24, 1992.
6. Front facade, camera facing west
7. #1

6. Front facade and south elevation, camera facing northwest
7. #2

6. Rear elevation, camera facing east
7. #3

6. Interior, staircase, camera facing west
7. #4

6. Storage building, camera facing northwest
7. #5

6. Storage building, camera facing south
7. #6

6. Office (destroyed), camera facing southwest
7. #7

6. Office (destroyed), camera facing east
7. #8

6. Office (destroyed), camera facing northwest
7. #9

United States Department of the Interior
National Park Service

**National Register of Historic Places
Continuation Sheet**

Section number _____ Photographs 6
Page _____

Cedar Haven Plantation
Marengo County, AL

The information in sections #1-5 is the same for photographs 10-15

1. Cedar Haven
2. Faunsdale vicinity, Marengo County, Alabama
3. Jeff Mansell, photographer
4. Negatives on file Alabama Historical Commission
5. August 8, 1991: There has been no change to the property since a site visit on October 24, 1992.
6. Front facade and north elevation, camera facing southwest
7. #10

6. North elevation
7. #11

6. Front facade, camera facing west
7. #12

6. Detail of central entrance, camera facing west
7. #13

6. Detail of secondary entrance, camera facing west
7. #14

6. Smokehouse, camera facing north
7. #15

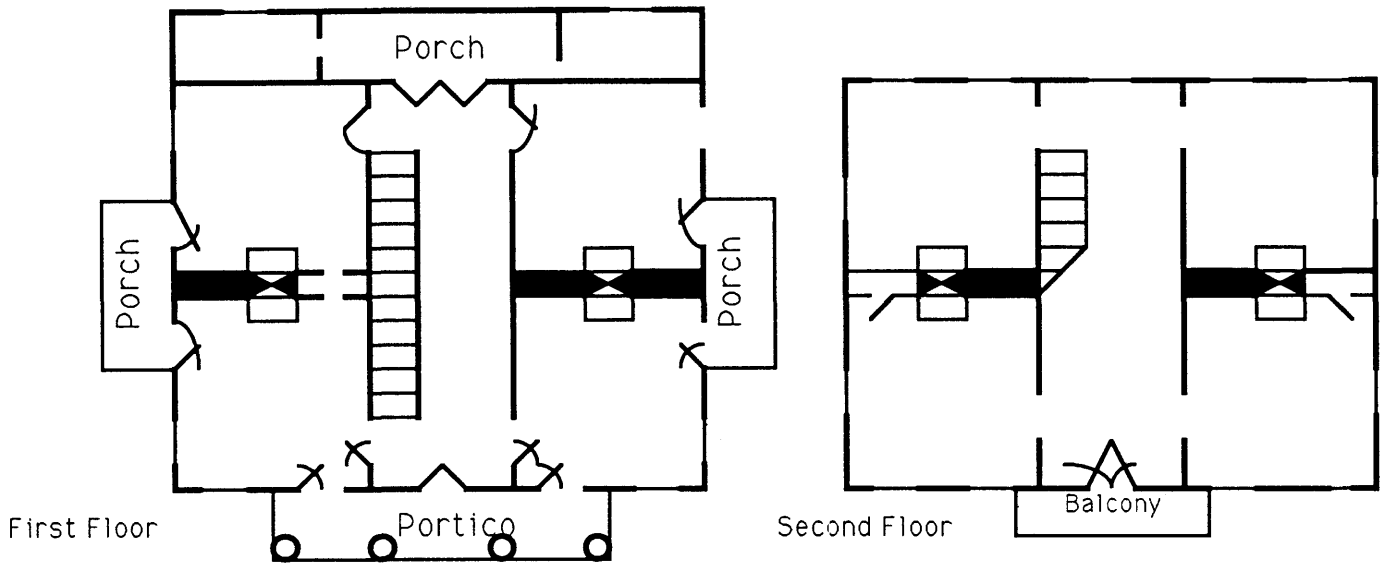

Floorplan of Main House

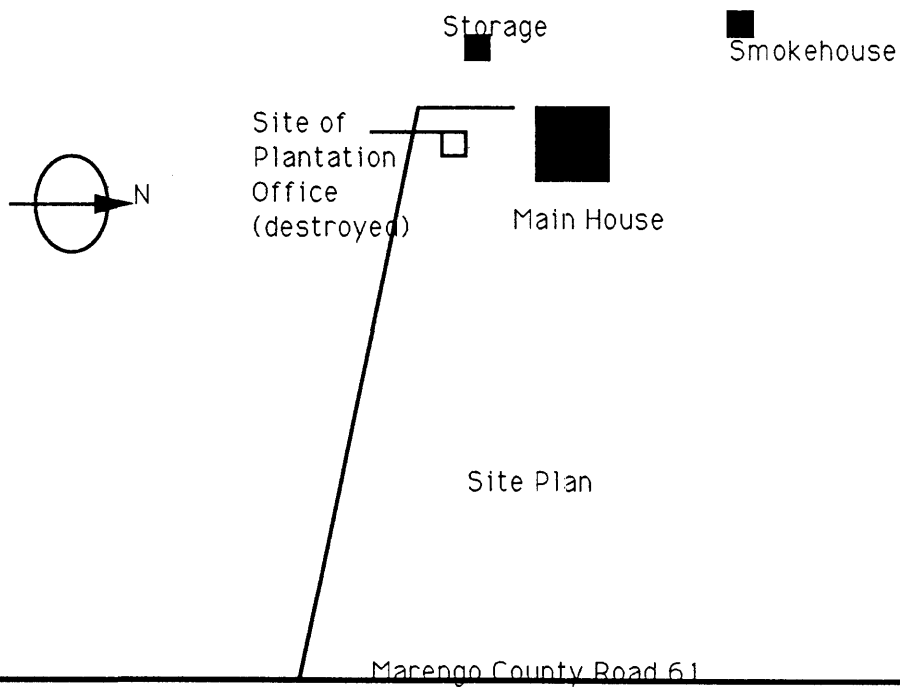

Cedar Haven - The Houston Alexander Place
 Faunsdale Vicinity, Marengo County, Alabama

T 17 N - R 4 E 1/4" = 1 mile
CEDAR HAVEN
MARENGO COUNTY, ALABAMA
T 17 N - R 5 E

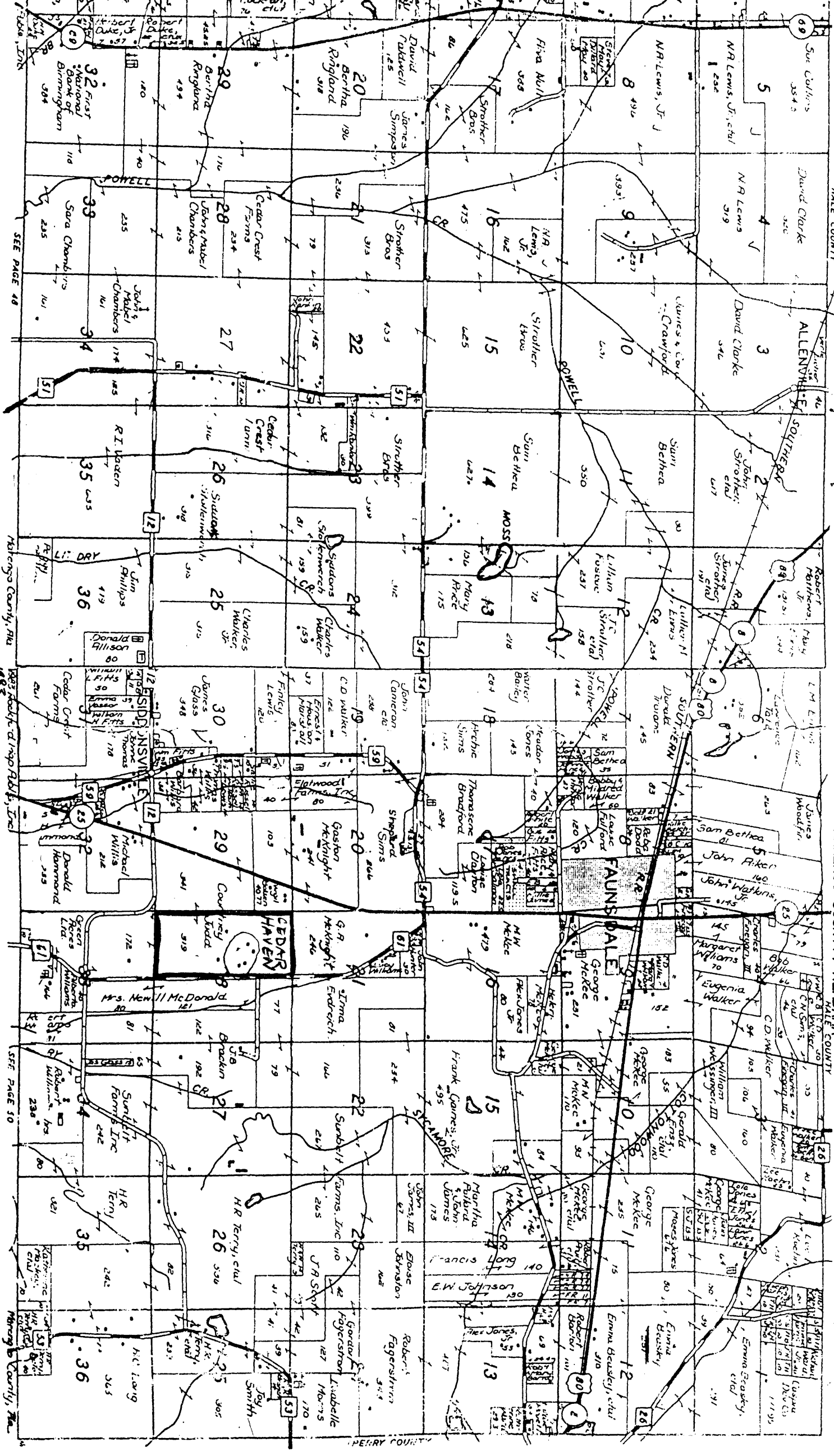

SEE PAGE 48
SEE PAGE 49
SEE PAGE 50
SEE PAGE 51
SEE PAGE 52
SEE PAGE 53
SEE PAGE 54
SEE PAGE 55
SEE PAGE 56
SEE PAGE 57
SEE PAGE 58
SEE PAGE 59
SEE PAGE 60
SEE PAGE 61
SEE PAGE 62
SEE PAGE 63
SEE PAGE 64
SEE PAGE 65
SEE PAGE 66
SEE PAGE 67
SEE PAGE 68
SEE PAGE 69
SEE PAGE 70
SEE PAGE 71
SEE PAGE 72
SEE PAGE 73
SEE PAGE 74
SEE PAGE 75
SEE PAGE 76
SEE PAGE 77
SEE PAGE 78
SEE PAGE 79
SEE PAGE 80
SEE PAGE 81
SEE PAGE 82
SEE PAGE 83
SEE PAGE 84
SEE PAGE 85
SEE PAGE 86
SEE PAGE 87
SEE PAGE 88
SEE PAGE 89
SEE PAGE 90
SEE PAGE 91
SEE PAGE 92
SEE PAGE 93
SEE PAGE 94
SEE PAGE 95
SEE PAGE 96
SEE PAGE 97
SEE PAGE 98
SEE PAGE 99
SEE PAGE 100