



Historic Sites Survey

ARCHITECTURAL DESCRIPTION:

The building at 1410 Bowen Avenue is a one story, wood frame, L-shaped "shotgun" house which is set on low brick piers and is covered by a cross gable roof. The body of the house consists of a north-to-south file of rooms across the southern end of which is a rear wing. A wrap-around gallery extends across the two-bay north facade of the rear wing and main block and along the western elevation of the latter. The gallery, which is undercut along the side and rear sections, projects from the main facade and is covered by a hip roof. This creates a gable on hip roof arrangement, the gable of which is pierced by a lozenge-shaped, louvered ventilator and clad in imbricated shingles. The porch is supported by chamfered posts with sawn brackets. One of the three entrances from the gallery has a transom. The windows have six-over-six double-hung sash.

ALTERATIONS:

Rear porch enclosure

OUTBUILDINGS:

garage (moved), prefabricated aluminum storage shed, attached carport

LANDSCAPE FEATURES:

Open lawn with some foundation plantings and pecan trees

STATEMENT OF SIGNIFICANCE:

The house at 1410 Bowen Avenue is architecturally significant in the history of Ocean Springs as an example of an architecturally-developed "shotgun" house which possesses a very high level of integrity. Although other examples of the "shotgun" form have survived in Ocean Springs, this house is noteworthy because its particularly extensive gallery which occupies approximately one fourth of the total area of the house. The building is also unique in the restraint of its simplified Queen Anne Style ornamentation.

NAME:

STREET NO: 1410 Bowen Avenue

TOWN/VIC: Ocean Springs

COUNTY: Jackson

BLOCK/LOT:

PRESENT OWNER: Alice Davidson Hire
 ADDRESS 1410 Bowen Ave., Ocean Springs, MS

PRESENT USE: residence

FORMER USE: residence

DATE: ca. 1900

STYLE: Queen Anne

ARCH/BUILDER: unknown

SOURCE OF DATE: style

ENVIRONMENT: residential

LEVEL OF SIGNIFICANCE

NEIGHBORHOOD

LOCAL X

STATE

NATIONAL

PHOTOS

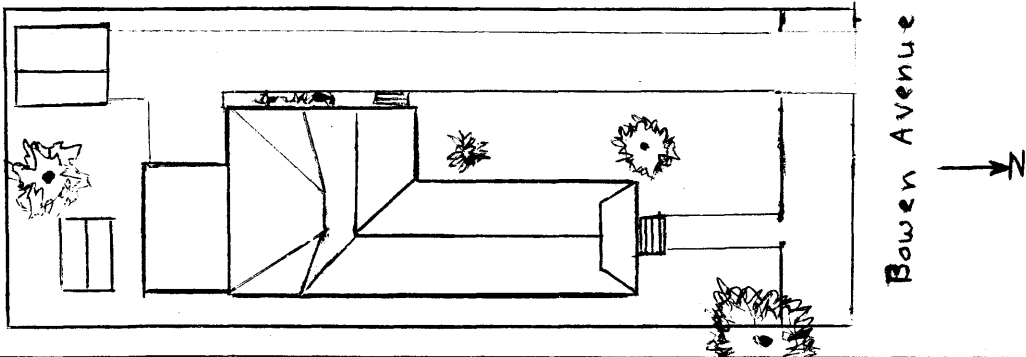

Bowen Avenue



PHYSICAL CONDITION:

Good

THREATS:

None

VERBAL BOUNDARY DESCRIPTION:

Parcel # 60137130

ACREAGE: Less than one acre

UTM REF:

A	<table border="1"><tr><td>1</td><td>6</td></tr></table>	1	6	<table border="1"><tr><td>3</td><td>2</td><td>4</td><td>9</td><td>1</td><td>1</td><td>0</td></tr></table>	3	2	4	9	1	1	0	<table border="1"><tr><td>3</td><td>3</td><td>6</td><td>4</td><td>5</td><td>7</td><td>0</td></tr></table>	3	3	6	4	5	7	0						
1	6																								
3	2	4	9	1	1	0																			
3	3	6	4	5	7	0																			
	ZONE EASTING		NORTHING																						
C	<table border="1"><tr><td>1</td></tr></table>	1	<table border="1"><tr><td> </td><td> </td><td> </td><td> </td><td> </td><td> </td><td> </td><td> </td><td> </td><td> </td></tr></table>											<table border="1"><tr><td> </td><td> </td><td> </td><td> </td><td> </td><td> </td><td> </td><td> </td><td> </td><td> </td></tr></table>											
1																									
B	<table border="1"><tr><td> </td><td> </td></tr></table>			<table border="1"><tr><td> </td><td> </td><td> </td><td> </td><td> </td><td> </td><td> </td><td> </td><td> </td><td> </td></tr></table>											<table border="1"><tr><td> </td><td> </td><td> </td><td> </td><td> </td><td> </td><td> </td><td> </td><td> </td><td> </td></tr></table>										
	ZONE EASTING		NORTHING																						
D	<table border="1"><tr><td> </td><td> </td></tr></table>			<table border="1"><tr><td> </td><td> </td><td> </td><td> </td><td> </td><td> </td><td> </td><td> </td><td> </td><td> </td></tr></table>											<table border="1"><tr><td> </td><td> </td><td> </td><td> </td><td> </td><td> </td><td> </td><td> </td><td> </td><td> </td></tr></table>										

FORM PREPARED BY:

Brian Berggren

DATE

May 15, 1986