

2733

owner objection
OMB No. 1024-0018

United States Department of the Interior
National Park Service

RECEIVED

National Register of Historic Places
Registration Form

NOV 1 1988

NATIONAL REGISTER

This form is for use in nominating or requesting determinations of eligibility for individual properties or districts. See instructions in *Guidelines for Completing National Register Forms* (National Register Bulletin 16). Complete each item by marking "x" in the appropriate box or by entering the requested information. If an item does not apply to the property being documented, enter "N/A" for "not applicable." For functions, styles, materials, and areas of significance, enter only the categories and subcategories listed in the instructions. For additional space use continuation sheets (Form 10-900a). Type all entries.

1. Name of Property

historic name Jackson, Beckley, House
other names/site number The Stagecoach Inn (HK-4)

2. Location

street & number On west side of county route # 1069 2/10 mile south NA not for publication
city, town Hanson of Jones Road. vicinity
state Kentucky code KY county Hopkins code 107 zip code 42413

3. Classification

Ownership of Property	Category of Property	Number of Resources within Property	
<input checked="" type="checkbox"/> private	<input checked="" type="checkbox"/> building(s)	Contributing	Noncontributing
<input type="checkbox"/> public-local	<input type="checkbox"/> district	<u>1</u>	<u>0</u> buildings
<input type="checkbox"/> public-State	<input type="checkbox"/> site	<u>0</u>	<u>0</u> sites
<input type="checkbox"/> public-Federal	<input type="checkbox"/> structure	<u>0</u>	<u>0</u> structures
	<input type="checkbox"/> object	<u>0</u>	<u>0</u> objects
		<u>1</u>	<u>0</u> Total

Name of related multiple property listing: Hopkins County Multiple Properties Listing
Number of contributing resources previously listed in the National Register 0

4. State/Federal Agency Certification

As the designated authority under the National Historic Preservation Act of 1966, as amended, I hereby certify that this nomination request for determination of eligibility meets the documentation standards for registering properties in the National Register of Historic Places and meets the procedural and professional requirements set forth in 36 CFR Part 60. In my opinion, the property meets does not meet the National Register criteria. See continuation sheet.
David C. Morgan 10-26-88
Signature of certifying official David C. Morgan Date
State Historic Preservation Officer, Commonwealth of Kentucky
State or Federal agency and bureau

In my opinion, the property meets does not meet the National Register criteria. See continuation sheet.
NA
Signature of commenting or other official NA Date
State or Federal agency and bureau

5. National Park Service Certification

I, hereby, certify that this property is:
 entered in the National Register.
 See continuation sheet.
 determined eligible for the National Register. See continuation sheet.
 determined not eligible for the National Register.
 removed from the National Register.
 other, (explain:)

Entered in the National Register 3/23/89
Determined Eligible 12/12/88
Shelores Byers
Katiech Andrus
(owner objection withdrawn)

fu Signature of the Keeper Date of Action

6. Function or Use

Historic Functions (enter categories from instructions)

DOMESTIC/hotel/single dwelling

Current Functions (enter categories from instructions)

DOMESTIC/single dwelling

7. Description

Architectural Classification
(enter categories from instructions)

Other: Single cell, central passage plan.

Materials (enter categories from instructions)

foundation Brick
walls Brick
Wood/weatherboard
roof Other: Composition shingles
other _____

Describe present and historic physical appearance.

The Beckley Jackson House is a one and a half story, Flemish bond brick, single cell, central passage plan residence. The house may have been built with an original rear frame ell but this ell appears to have been replaced ca. 1900 with the present ell. The house is sited on a slight rise facing Hwy 1069 which was known in the 19th century as the Jackson-Providence Road. To the south and west of the house are early to mid-20th century outbuildings which are not associated with period of significance for the property.

The house has a gable roof with exterior end brick chimneys and windows are modern six-over-six sash. Windows on the north and south facades are ca. 1900 four-over-four sash. In the half-story on the north facade are ca. 1900 four light casement windows. At the roofline of the original building is a triple row of corbelled brick with one row displaying cavetto molding. At the rear of the original brick section is a ca. 1900 one-story frame ell addition with six-over-six sash windows and an interior brick chimney. Later frame additions were also added to this section. On the main (east) facade is an added ca. 1920 gable roof enclosed porch with exposed rafters and sliding single light windows. The main entrance has a ca. 1940 multi-light glass and frame door. The interior of the house has been remodeled and no original detailing is extant. At the rear of the residence are four non-contributing frame outbuildings constructed in the early to mid-20th century.

8. Statement of Significance

Certifying official has considered the significance of this property in relation to other properties:

nationally statewide locally

Applicable National Register Criteria A B C D

Criteria Considerations (Exceptions) A B C D E F G NA

Areas of Significance (enter categories from instructions)

Settlement

Period of Significance

1830 - ca. 1860

Significant Dates

1830

Cultural Affiliation

N/A

Significant Person

N/A

Architect/Builder

Unknown

State significance of property, and justify criteria, criteria considerations, and areas and periods of significance noted above.

The Beckley Jackson House is significant for its association as an early stage coach stop and post office in ante-bellum Hopkins County. It is the only building from this period associated with early inns along historic road routes in the county. The house is also the only remaining ante-bellum brick building in the rural area of the county. However, because of alterations and additions to the original brick section it is not eligible under criterion C.

Beckley Jackson was born in 1788 and moved to Hopkins County in 1815. In the early minute books of the county Jackson is mentioned as a road surveyor and as an inspector of tobacco at Ashbyburg. Jackson became a prosperous farmer and in 1830 he built this brick residence on his farm. The house was originally one room deep and built in a central passage plan. It presumably had a rear brick or frame ell at the rear but this original ell was replaced ca. 1900. In addition to the construction of his house, Jackson also built a large log building across the road which served as an inn and stable for travelers on the Madisonville-Jackson Road.

For several decades the house was a well known stagecoach stop. Tradition states that most travelers stayed in the log building across the road except for more important guests who were invited to share Jackson's home. A post office for the area was also operated out of the Jackson House for many years. Jackson died in 1859 and it appears that his family closed the inn soon afterwards. The log building across the road stood until recent years when it became deteriorated and was razed. Around 1900 the preent rear ell was added and further remodelings have occurred to the property. The building remains the only property associated with ante-bellum inns and stage coach stops in the county.

See continuation sheet

9. Major Bibliographical References

Previous documentation on file (NPS): NA
 preliminary determination of individual listing (36 CFR 67) has been requested
 previously listed in the National Register
 previously determined eligible by the National Register
 designated a National Historic Landmark
 recorded by Historic American Buildings Survey # _____
 recorded by Historic American Engineering Record # _____

See continuation sheet

Primary location of additional data:
 State historic preservation office
 Other State agency
 Federal agency
 Local government
 University
 Other
Specify repository: _____

10. Geographical Data

Acreeage of property Less than 1 acre

UTM References

A

1	16	4	5	13	0	8	10	4	1	4	4	1	1	0	10
Zone		Easting						Northing							

C

Zone		Easting						Northing							

B

Zone		Easting						Northing							

D

Zone		Easting						Northing							

Slaughtersville

See continuation sheet

Verbal Boundary Description

See continuation sheet

Boundary Justification

See continuation sheet

11. Form Prepared By

name/title Thomason and Assoc. date 7/28/88
organization _____ telephone 615-383-0227
street & number P.O. Box 121225 state TN zip code 37212
city or town Nashville

United States Department of the Interior
National Park Service

National Register of Historic Places
Continuation Sheet

Section number 10 Page 1

Hopkins County Multiple Properties Listing

Verbal Boundary Description: The location of the Beckley Jackson is illustrated on accompanying Hopkins County tax map # 75, lot 21 which is drawn at a scale of 1" = 400' and a sketch map of the property. The boundary is a rectangular parcel measuring approximately 50' by 100' with the house located at the western edge of the rectangle. The eastern boundary runs along the western edge of Hwy 1069 and the north and south boundaries run within ten feet of the house. The boundary at the southwest corner makes a slight jog to exclude a modern garage. The western boundary runs within ten feet from the rear of the house to exclude 20th century outbuildings.

Verbal Boundary Justification: The boundary for the Beckley Jackson House is drawn to include the house and adjacent lot that has historically been associated with the property. No outbuilding or other adjacent site feature is associated with the property's period of significance.

HK-4. BECKLEY JACKSON HOUSE

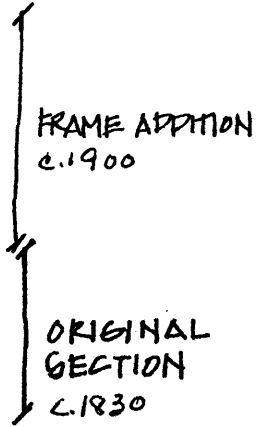
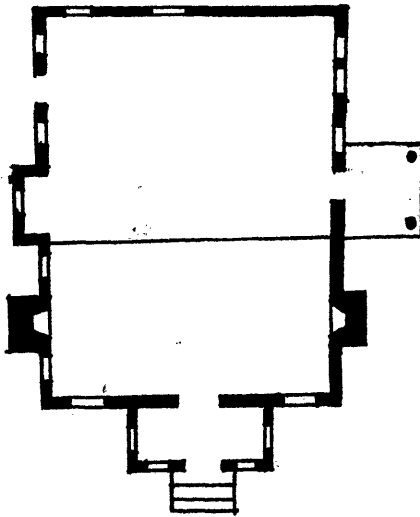
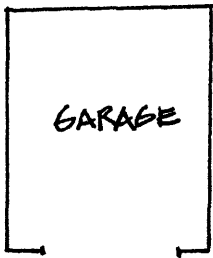

NOT TO SCALE

Beckley Jackson House(HK-4)
Route 1069
1"= 400'



20

41

31

32

33

Road

39

tech

**United States Department of the Interior
National Park Service**

**National Register of Historic Places
Continuation Sheet**

Section number Photo Key Page 1

Hopkins County Multiple Listing Properties

Photo Key

1. Jackson, Beckley, House (HK-4)
Location: KY 1069, vicinity of Slaughters.
Photos: Thomason and Associates.
Neg: KY Heritage Council
Date: February 1988
View: West, of main (east) facade.
Photo #: 1 of 4.

2. Jackson, Beckley, House (HK-4)
View: South, of north facade.
Photo #: 2 of 4

3. Jackson, Beckley, House (HK-4)
View: East, of north and west facades.
Photo #: 3 of 4

4. Jackson, Beckley, House (HK-4)
View: North, of south facade.
Photo #: 4 of 4