

3/1/93

United States Department of the Interior
National Park Service

National Register of Historic Places
Registration Form

This form is for use in nominating or requesting determinations for individual properties and districts. See instructions in *How to Complete the National Register of Historic Places Registration Form* (National Register Bulletin 16A). Complete each item by marking "x" in the appropriate box or by entering the information requested. If an item does not apply to the property being documented, enter "N/A" for "not applicable." For functions, architectural classification, materials, and areas of significance, enter only categories and subcategories from the instructions. Place additional entries and narrative items on continuation sheets (NPS Form 10-900a). Use a typewriter, word processor, or computer, to complete all items.

1. Name of Property

historic name KRUMDIACK HOMESTEAD
other names/site number Cook Property

2. Location

street & number No street address not for publication
city or town Waldron Island vicinity
state Washington code WA county San Juan code 055 zip code 9829

3. State/Federal Agency Certification

As the designated authority under the National Historic Preservation Act, as amended, I hereby certify that this nomination request for determination of eligibility meets the documentation standards for registering properties in the National Register of Historic Places and meets the procedural and professional requirements set forth in 36 CFR Part 60. In my opinion, the property meets does not meet the National Register criteria. I recommend that this property be considered significant nationally statewide locally. (See continuation sheet for additional comments.)
Mary Thompson 3/1/93
Signature of certifying official/Title Date
Washington State Office of Archaeology and Historic Preservation
State of Federal agency and bureau

In my opinion, the property meets does not meet the National Register criteria. (See continuation sheet for additional comments.)

Signature of certifying official/Title Date

State or Federal agency and bureau

4. National Park Service Certification

I hereby certify that the property is:
 entered in the National Register. See continuation sheet.
 determined eligible for the National Register See continuation sheet.
 determined not eligible for the National Register.
 removed from the National Register.
 other, (explain:)

Signature of the Keeper Robert Byers Entered in ~~NPS~~ National Register Date of Action 4/29/93

Krumdiack Homestead

San Juan Co., WA

Name of Property

County and State

5. Classification

Ownership of Property

(Check as many boxes as apply)

- private
- public-local
- public-State
- public-Federal

Category of Property

(Check only one box)

- building(s)
- district
- site
- structure
- object

Number of Resources within Property

(Do not include previously listed resources in the count.)

Contributing	Noncontributing	
4	1	buildings
		sites
	1	structures
		objects
4	2	Total

Name of related multiple property listing

(Enter "N/A" if property is not part of a multiple property listing.)

N/A

Number of contributing resources previously listed in the National Register

0

6. Function or Use

Historic Functions

(Enter categories from instructions)

Domestic: single dwelling

Agriculture: agricultural outbuilding

Current Functions

(Enter categories from instructions)

Domestic: single dwelling

Agriculture: agricultural outbuilding

7. Description

Architectural Classification

(Enter categories from instructions)

Other: log vernacular

Materials

(Enter categories from instructions)

foundation log

walls log, weatherboard

roof wood shingle, shake

other

Narrative Description

(Describe the historic and current condition of the property on one or more continuation sheets.)

Krumdiack Homestead

Name of Property

San Juan Co., WA

County and State

8. Statement of Significance

Applicable National Register Criteria

(Mark "x" in one or more boxes for the criteria qualifying the property for National Register listing.)

- A Property is associated with events that have made a significant contribution to the broad patterns of our history.
B Property is associated with the lives of persons significant in our past.
C Property embodies the distinctive characteristics of a type, period, or method of construction or represents the work of a master, or possesses high artistic values, or represents a significant and distinguishable entity whose components lack individual distinction.
D Property has yielded, or is likely to yield, information important in prehistory or history.

Criteria Considerations

(Mark "x" in all the boxes that apply.)

Property is:

- A owned by a religious institution or used for religious purposes.
B removed from its original location.
C a birthplace or grave.
D a cemetery.
E a reconstructed building, object, or structure.
F a commemorative property.
G less than 50 years of age or achieved significance within the past 50 years.

Areas of Significance

(Enter categories from instructions)

Exploration/Settlement

Architecture

Period of Significance

1890-1907

Significant Dates

1890; 1898; 1907

Significant Person

(Complete if Criterion B is marked above)

N/A

Cultural Affiliation

N/A

Architect/Builder

Krumdiack, Friedrich

Narrative Statement of Significance

(Explain the significance of the property on one or more continuation sheets.)

9. Major Bibliographical References

Bibliography

(Cite the books, articles, and other sources used in preparing this form on one or more continuation sheets.)

Previous documentation on file (NPS):

- preliminary determination of individual listing (36 CFR 67) has been requested
previously listed in the National Register
previously determined eligible by the National Register
designated a National Historic Landmark
recorded by Historic American Buildings Survey
recorded by Historic American Engineering Record

Primary location of additional data:

- State Historic Preservation Office
Other State agency
Federal agency
Local government
University
Other

Name of repository:

Krumdiack Homestead
Name of Property

San Juan Co., WA
County and State

10. Geographical Data

Acreage of Property 11.6

UTM References

(Place additional UTM references on a continuation sheet.)

1	10	498260	5395920
	Zone	Easting	Northing
2	10	498380	5396000

3	10	498460	5395680
	Zone	Easting	Northing
4	10	498340	5395660

See continuation sheet

Verbal Boundary Description

(Describe the boundaries of the property on a continuation sheet.)

Boundary Justification

(Explain why the boundaries were selected on a continuation sheet.)

11. Form Prepared By

name/title Leonard Garfield from information by Dr. William Cook
organization (Cook) property owner date January 1, 1993
street & number 3434 Evergreen Point Road telephone (206)455-4336
city or town Bellevue state WA zip code 98004

Additional Documentation

Submit the following items with the completed form:

Continuation Sheets

Maps

- A **USGS map** (7.5 or 15 minute series) indicating the property's location.
- A **Sketch map** for historic districts and properties having large acreage or numerous resources.

Photographs

Representative **black and white photographs** of the property.

Additional items

(Check with the SHPO or FPO for any additional items)

Property Owner

(Complete this item at the request of SHPO or FPO.)

name W. B. Cook
street & number 3434 Evergreen Point Road telephone (206) 455-4336
city or town Bellevue state WA zip code 98004

Paperwork Reduction Act Statement: This information is being collected for applications to the National Register of Historic Places to nominate properties for listing or determine eligibility for listing, to list properties, and to amend existing listings. Response to this request is required to obtain a benefit in accordance with the National Historic Preservation Act, as amended (16 U.S.C. 470 et seq.).

Estimated Burden Statement: Public reporting burden for this form is estimated to average 18.1 hours per response including time for reviewing instructions, gathering and maintaining data, and completing and reviewing the form. Direct comments regarding this burden estimate or any aspect of this form to the Chief, Administrative Services Division, National Park Service, P.O. Box 37127, Washington, DC 20013-7127; and the Office of Management and Budget, Paperwork Reductions Projects (1024-0018), Washington, DC 20503.

United States Department of the Interior
National Park Service

National Register of Historic Places Registration Form

Section number 7 Page 1

Krumdiack Homestead, Waldron Island, San Juan Co., WA

Description

General Setting: The Krumdiack Homestead is a 19th century farm on the north shore of Waldron Island in San Juan County. Located in the Strait of Georgia, Waldron Island has an area of 4.6 square miles and lies one and one-half miles northwest of Orcas Island across the deep waters of President Channel. Although the southeastern portion of the island is elevated and rocky, elsewhere the island is covered with glacial drifts and elevations rarely rise above 100 feet. Sparsely settled and covered with dense second-growth woods, the island's north half is characterized by beachfront, gentle bluffs, wooded uplands, and small farms, some of which date from the island's initial period of Euroamerican settlement in the late 19th century. Today, the island is accessible principally by private boat or plane.

The Krumdiack farm is the original homestead of a German settler who like other 19th century island pioneers cut cordwood and maintained a subsistence farm. The nominated parcel includes 11.6 acres of a 77 acre property. The rectangular parcel, which measures roughly 600 feet wide by 900 feet deep, is bounded on the north by Severson's Bay. The property includes a wooded bluff south of the waterfront, and clearings and fields on the uplands. Structures on the property include a log cabin built between 1890 and 1898, a log chicken house, log smoke house, and a wood frame barn (substantially re-built) dating from the same period, and a wood frame water tower built in the 1960s. Located on the original sites, the structures form a loose building cluster in the middle of the farmstead.

The cabin: The Krumdiack cabin is a rectangular single pen, one and one-half story structure built of closely-fitted split cedar logs, each measuring 18 feet wide, laid horizontally and joined at the corners by overlapping square notches. The cabin is believed to have replaced a more temporary log structure a few years after the Krumdiack family settled on the land in 1890 but before they received their homestead patent in 1898. About eleven logs rise from the sill to a gable roof. The outer face of the logs are roughly hewn but the interior faces are carefully smoothed with a broadax. The interstices between the logs are filled with bits of wood, dry moss, unravelled rope, ship caulking cotton, and lime mortar. The original sill logs, which rested directly on the sandy earth, suffered extensive rot and in 1962 were jacked up and placed on creosote piers.

United States Department of the Interior
National Park Service

National Register of Historic Places Continuation Sheet

Section number 7 Page 2

Krumdiack Homestead, Waldron Island, San Juan Co., WA

The main pen of the cabin measures 26 feet across the west facade and east elevation and 18 feet along the sides. The upper gable ends are faced in coursed cedar shingles, and the entire south wall, exposed to the strongest winds, was faced in cedar shingles nailed to the logs. The south wall shingles had become rotted by the 1960s and were replaced with cedar shakes by the present owner. The gabled roof of the cabin is sheathed in wood shingles, added sometime in the mid-20th century.

The cabin is entered on the west facade through a single leaf central door flanked by double-hung one-over-one wood sash windows. The windows and door are framed with simple wood architraves. The rear (east elevation) is lighted by a one-over-one double-hung window located on the north half which, like the windows on the front, is framed by a plain wood surround. The south side gabled end features centrally placed double-hung windows on both the first story and the upper gable end. The north elevation is lighted by paired multi-light casement windows in the upper gable end.

A one-story kitchen wing, with gable roof, projects about 15 feet from the north gable end of the main cabin and is set back from it a few feet. Probably built at the turn of the century (as evidenced by German language newspapers, dated 1898, which insulated the interior walls), the wing is constructed of milled vertical planks with battens and features a single leaf door in both the east and west elevations. The entry on the west side is sheltered by a pent roof overhang. The wing is lighted on both elevations by double-hung one-over-one wood sash windows; a small skylight has been placed in the rear of the kitchen roof. A brick chimney rises against the north wall of the original cabin where it joins with the kitchen wing. The kitchen was extended an additional two feet on the rear in recent years to enclose a small anteroom before entering the kitchen proper.

The interior of the original cabin features an open living space on the north (measuring 14 feet by 18 feet) with two small bedrooms (each measuring nine feet by 12 feet) along the south side. A half-story upper level features sleeping areas. The interior of the cabin features exposed log walls rising the full height to the nine-foot ceiling. The logs are now covered with whitewash. The lower walls have been finished

United States Department of the Interior
National Park Service

National Register of Historic Places Registration Form

Section number 7 Page 3

Krumdiack Homestead, Waldron Island, San Juan Co., WA

with vertical four-inch wide tongue and groove wainscoting capped with a chair rail molding. The floor is composed of four-inch wide tongue and groove fir boards. Simple wood surrounds trim the window and door openings. Windows on the east and west light the living area, while a west window lights the west bedroom and a south window lights the east bedroom. In the center of the space is a narrow set of stairs leading to the upper level. The upper half-story features two bedroom spaces, the northern one measuring about 14 feet by 18 feet, and the southern one measuring eight and one-half feet by 13 feet. The upper level is finished with tongue and groove boards.

The kitchen wing features horizontal planed fir wall boards and linoleum over the floor. The kitchen is lighted by windows on the west, south, and east walls, and is accessed by front and rear doors. Doors throughout the cabin are original cedar, many with original side-locks.

Outbuildings: Several small ancillary structures were built at about the same time as the house. About 40 feet north of the cabin, the chicken house is a rectangular cedar log structure with a gable roof covered with wood shakes. The structure measures 13 feet by 18 feet. Although no changes have been made in the exterior dimensions of the chicken house, a small partition was added inside to create a storage room. The structure was re-roofed about 25 years ago.

A few feet south of the chicken house, the smokehouse is a one story square structure, with gable roof, built of square hewn cedar logs joined by square notching. The structure measures eight feet by eight feet. The shake roof was added by the current owner. Inside are smoke blackened timbers used for hanging meat or fish. A small window was added to the north side of the smokehouse in the 1940s but otherwise the structure is unaltered. It is currently used for storage.

A nonhistoric water tower, built about 1970, is located just a few feet north of the house. The structure is timber frame, measures nine feet by nine feet, and rises about 25 feet. It is sided with wood shingles. The historic root cellar, listed in the 1898 homestead patent, was torn down recently by the present owners. It is the only historic structure not standing.

United States Department of the Interior
National Park Service

National Register of Historic Places Registration Form

Section number 7 Page 4

Krumdiack Homestead, Waldron Island, San Juan Co., WA

To the south of the house is the original barn, a large rectangular structure measuring 42 feet by 57 feet overall and sheltered by a gable roof. The structure is built on a pass-through plan, with two one-story sheds on either side of a drive-through aisle, all unified by the gable roof. The barn is built of milled vertical planks and is lighted by small wood sash windows featuring a variety of pane configurations. Most of the structural timbers are original, including the ridge pole which rests on two tree trucks cut about 20 feet above ground. The original cedar board and batten siding was recently replaced in kind using lumber milled from timber harvested on the farm. Although the exterior dimensions of the barn remain the same, the western stables were enclosed to create two rooms used for as a shop and for storage.

The buildings of the Krumdiack Homestead are located on a typical 19th century vernacular homestead, cleared of its virgin timber to provide fields and orchards (about half of whose original trees remain). The property also includes 617 feet of beachfront along its northern boundary, once the location of a house and barn used by Hawaiian laborers who were employed cutting cordwood. The beach also includes shell middens associated with the native Lummi and Saanich Indians. A nonhistoric boat house has been built on the site of a cabin used by the Hawaiian workers.

United States Department of the Interior
National Park Service

National Register of Historic Places Registration Form

Section number 8 Page 5

Krumdiack Homestead, Waldron Island, San Juan Co., WA

Statement of Significance:

First settled in 1890 and "proved up" over the following decade by a family of German immigrants, the Krumdiack Homestead is a well preserved reflection of pioneer life on Waldron Island. The nominated parcel includes the original 12 acres of cleared land on which Friedrich Krumdiack raised crops, planted an orchard, and built a substantial log house as well as a variety of log outbuildings. The complex retains good integrity with nearly all the original structures intact and the original setting unaltered. According to the standard history of Waldron (1959), the Krumdiack property is considered the finest example of a 19th century homestead on the island.

Historical Background: Waldron Island is a part of the San Juan Archipelago, located in the Strait of Georgia on the border between northwestern Washington and British Columbia. Before the arrival of white settlers in the 19th century, the island was frequented by the Lummi Indians (and to a lesser extent the Saanich, Songich, Semihamoos, and Samish) who had seasonal camps on the island for fishing, hunting and gathering. Although European "discovery" of the San Juans dates to the 1790 visit of Vancouver, it was not until the 1841 Wilkes Expedition that Waldron Island was actually given that name. And as late as 1870, the United States census noted only four farmers who had settled on Waldron Island. Indeed, American settlement did not begin in earnest until after 1872 when international arbitration placed Waldron Island (and the rest of the San Juans) firmly under the jurisdiction of the United States.

A federal land survey of Waldron Island was completed in 1874; four years later regular mail service was initiated and the local economy received an additional boost in the 1880s when the Roche Harbor Lime Company was established on nearby San Juan Island. By the late 19th century, the company was a thriving industry that supported hundreds of employees and created a booming market for cordwood, which became a primary cash product for residents of Waldron Island.

Used in the burning of lime, cordwood was shipped in large quantities from the island, and many Waldron families spent most of their time in the woods with axes and saws. Typically, cordwood was stacked at the top of a bluff, then sent down a chute to waiting barges at the beachfront. Among

United States Department of the Interior
National Park Service

National Register of Historic Places Registration Form

Section number 8 Page 6

Krumdiack Homestead, Waldron Island, San Juan Co., WA

the chief suppliers of cordwood was the family of Friedrich Krumdiack.

Friedrich Wilhelm Heinrich Krumdiack was born in Hanover Province, Germany, in 1854 and served in the Kaiser's army before seeking better fortunes in the New World. To pay for their passage west, Krumdiack and his wife Louise agreed to work in the sugar fields of the Sandwich Islands (Hawaii). The Krumdiack family set sail from Germany on June 2, 1882, and arrived in Honolulu in October. For the next few years, the Krumdiacks lived on Kauai where they served as household employees on a large plantation.

In late 1885, the Krumdiacks left Hawaii for Port Townsend in the Washington Territory. There Krumdiack found employment as a brewer for the Washington Brewery. But in 1890 the family moved again--first to San Juan Island where they joined Fred's sister Maria and her husband Ferdinand Baatz, and then (with the Baatz family) to Waldron Island.

On August 7, 1890, Krumdiack filed homestead papers for a 80-acre claim which includes the nominated parcel. Krumdiack immediately built a small cabin at the site, then set about clearing twelve acres and planting 70 fruit trees. By 1898, when he received the patent to his land, Krumdiack had also built a barn, root cellar, chicken house, and smokehouse, and dug two wells. He also replaced the first cabin with a larger, more substantial house. Constructed of carefully hewn and notched cedar logs, the one-and one-half story structure still stands and was noted in a 1959 island history as the "most substantial of the old pioneer homes left."

Although it has outlasted most other examples, the Krumdiack cabin reflects the pioneer traditions of the island. Most early housing on the island consisted of structures built of massive hewn cedar logs. Cedar was a favorite material because of its availability, durability, and lightness. Spilt in half, the logs typically were hewn flat on each edge, neatly joined at the corners with notches, and chinked with moss and lime and sand mortar. The building tradition proved surprisingly long-lasting; it is believed that the first frame house on the island was not built until after 1900. Other features, too, of the Krumdiack homestead were once typical of pioneer settlements on the island, including the small log smokehouse (suitable for smoking a few salmon) and the log chicken house.

United States Department of the Interior
National Park ServiceNational Register of Historic Places
Continuation SheetSection number 8,9,10 Page 7

Krumdiack Homestead, Waldron Island, San Juan Co., WA

Although Krumdiack established a subsistence farm and orchard, he raised income by cutting timber on his 80-acre claim and selling it as cordwood, piling, and mine shaft supports to the Roche Harbor Lime Company. In addition to his work, Krumdiack served the local community in his role as a director of the island school system. Indeed, the Krumdiack family (which included seven children and various relatives) formed a small nucleus of settlers on the island. In addition to his own family, the Krumdiack clan included Fred's sister Maria and brother-in-law Ferdinand Baatz and their family as well as Fred's half-brother Ernest Rahorst and his' family (who arrived from Wisconsin in the 1890s).

In 1907, Krumdiack sold the farm for \$1,000 and moved his family to Orcas Island where his children could attend school. Louise Krumdiack died by 1914; Fred died in 1936. Between 1907 and 1945, the property changed hands at least four times until it was sold to the Cook family, who continue to own the property as a vacation residence.

Bibliography:

Charles Ludwig, A Brief History of Waldron Island (Waldron Island: privately published, 1959, revised 1972).

Maxine Krumdiack Flaherty, Krumdiack Family Facts and Fables (Concrete, WA: privately published, 1988).

Boundary Justification:

The nominated property includes the 11.6 acres originally cleared and improved by Friedrich Krumdiack in the 1890s, and excludes the remaining 60 plus acres that were left in timber. The nominated parcel includes the historic building cluster, cultivated fields, orchard, garden, and beachfront, and retains excellent integrity from the historic period. By contrast, no historic structures or landscape elements are located on the remainder of the Krumdiack property.

Verbal Boundary Description: From intersection of Waldron Island county road and Krumdiack Drive (at cemetery), proceed north on drive approx. 2, 500 feet; from this point of beginning, proceed west approx. 500 feet; proceed north to shoreline; proceed east along shoreline 612 feet; proceed south approximately 1, 300 feet; proceed west to p.o.b. See sketch map drawn to scale of 1"=100'.

United States Department of the Interior
National Park Service

**National Register of Historic Places
Continuation Sheet**

Section number _____ Photos _____ Page 8

Krumdiack Homestead, Waldron Island, San Juan Co., WA

Photographs

Photographer: Leonard Garfield
Date: August, 1992
Negatives: Office of Archaeology and Historic Preservation

1. Cabin, facade, looking east
- 2.. Cabin, facade, looking east
3. Cabin, facade and south elevation, looking northeast
4. Cabin, facade and north side, looking southeast
5. Cabin, rear elevation, looking west
6. Cabin, detail, southwest corner notching
7. Cabin detail, west window
8. Barn, looking east
9. Smokehouse, looking east
10. Chicken house, smokehouse, tower, looking northeast
11. Tower, smokehouse, chicken house, looking northeast

Scale 1" = 100' (approx.)

Krumdiack Homestead
Waldron Island, San Juan Co., WA
Solid line = boundaries

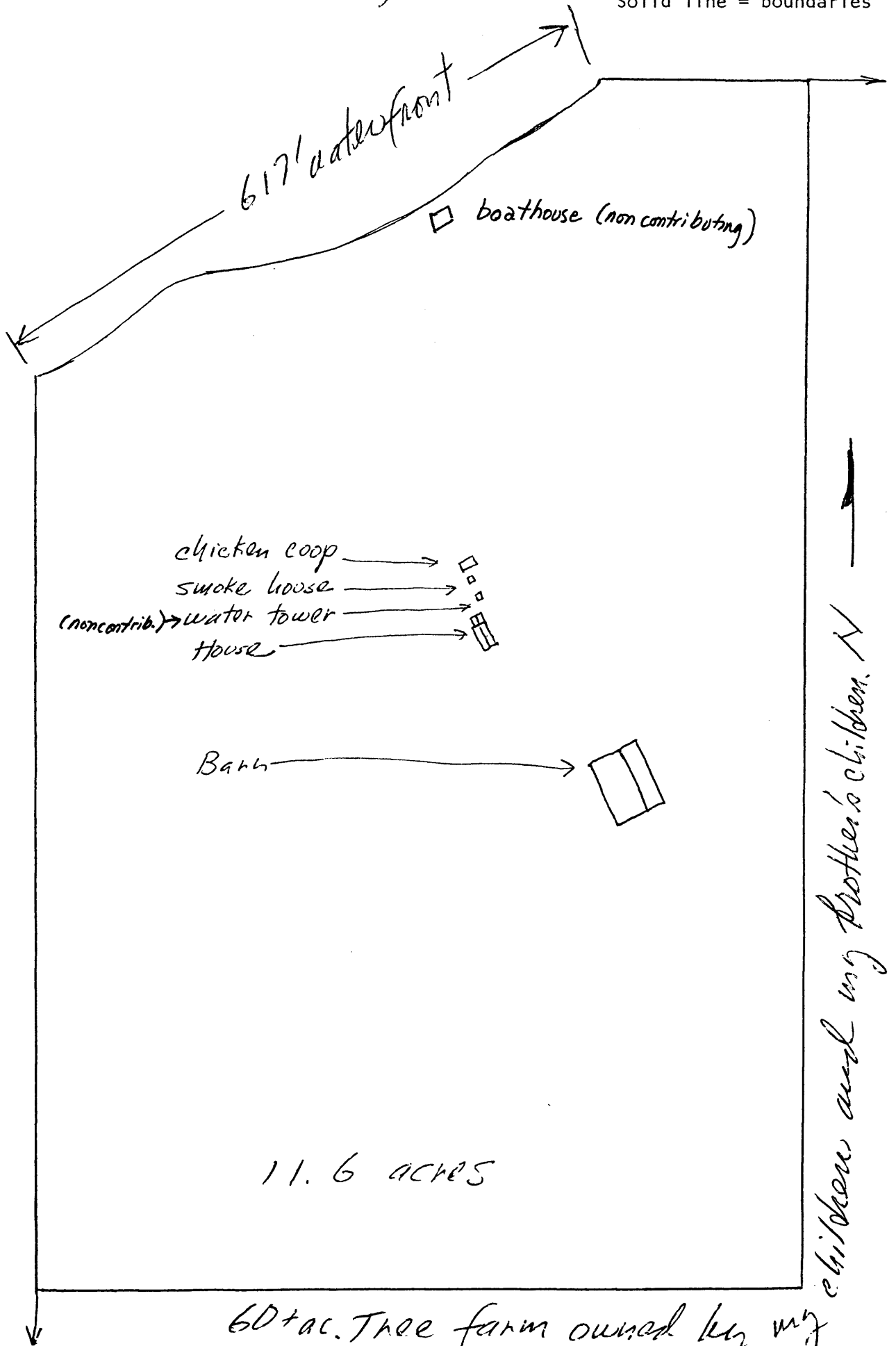

chicken coop → □
 smoke house → □
 (non contrib.) → water tower → □
 House → □

Bath → □

11.6 acres

60+ ac. Tree farm owned by my children and my brother's children. →

Scale 1" = 100' (approx.)

Krumdiack Homestead
Waldron Island, San Juan Co., WA
Solid line = boundaries

Photos Ⓟ

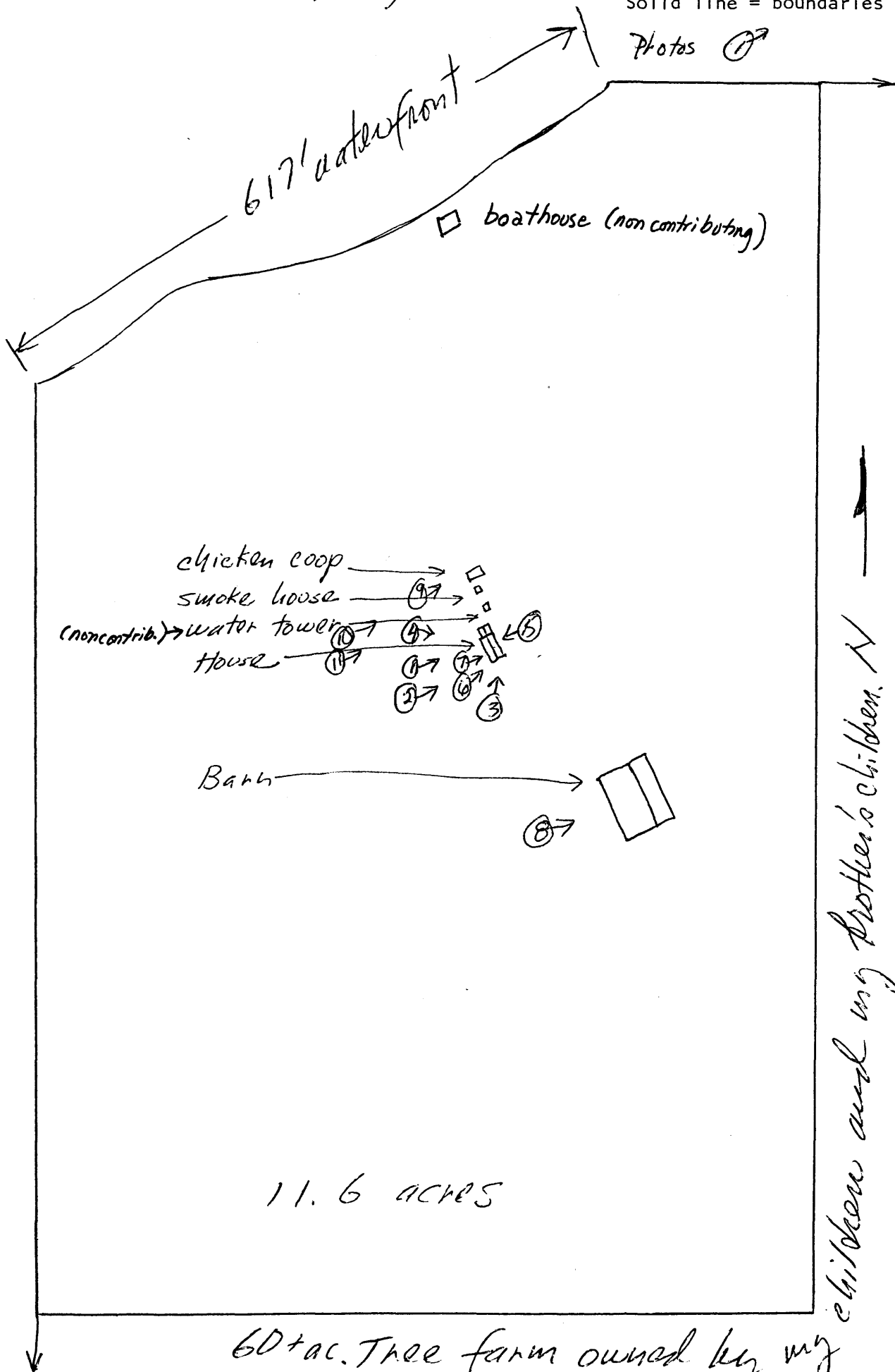

chicken coop

smoke house

(noncontrib.) water tower

house

Bath

boathouse (non contributing)

11.6 acres

60+ ac. Tree farm owned by my children and my brother's children

children and my brother's children