

UNITED STATES DEPARTMENT OF THE INTERIOR
NATIONAL PARK SERVICE

**NATIONAL REGISTER OF HISTORIC PLACES
INVENTORY -- NOMINATION FORM**

FOR NPS USE ONLY
RECEIVED **NOV 27 1979**
DATE ENTERED **JAN 3**

SEE INSTRUCTIONS IN *HOW TO COMPLETE NATIONAL REGISTER FORMS*
TYPE ALL ENTRIES -- COMPLETE APPLICABLE SECTIONS

1 NAME

HISTORIC **Fleming House**
AND/OR COMMON

2 LOCATION

NE of Smyrna on RR 9

STREET & NUMBER

Route 9

NOT FOR PUBLICATION
CONGRESSIONAL DISTRICT

CITY, TOWN

Smyrna *vicinity*

VICINITY OF

One

STATE

CODE

COUNTY

CODE

Delaware

10

New Castle

002

3 CLASSIFICATION

CATEGORY	OWNERSHIP	STATUS	PRESENT USE	
<input type="checkbox"/> DISTRICT	<input type="checkbox"/> PUBLIC	<input checked="" type="checkbox"/> OCCUPIED	<input type="checkbox"/> AGRICULTURE	<input type="checkbox"/> MUSEUM
<input checked="" type="checkbox"/> BUILDING(S)	<input checked="" type="checkbox"/> PRIVATE	<input type="checkbox"/> UNOCCUPIED	<input type="checkbox"/> COMMERCIAL	<input type="checkbox"/> PARK
<input type="checkbox"/> STRUCTURE	<input type="checkbox"/> BOTH	<input type="checkbox"/> WORK IN PROGRESS	<input type="checkbox"/> EDUCATIONAL	<input checked="" type="checkbox"/> PRIVATE RESIDENCE
<input type="checkbox"/> SITE	PUBLIC ACQUISITION	ACCESSIBLE	<input type="checkbox"/> ENTERTAINMENT	<input type="checkbox"/> RELIGIOUS
<input type="checkbox"/> OBJECT	<input type="checkbox"/> IN PROCESS	<input type="checkbox"/> YES: RESTRICTED	<input type="checkbox"/> GOVERNMENT	<input type="checkbox"/> SCIENTIFIC
	<input type="checkbox"/> BEING CONSIDERED	<input type="checkbox"/> YES: UNRESTRICTED	<input type="checkbox"/> INDUSTRIAL	<input type="checkbox"/> TRANSPORTATION
		<input type="checkbox"/> NO	<input type="checkbox"/> MILITARY	<input type="checkbox"/> OTHER:

4 OWNER OF PROPERTY

NAME

David R. Rowland

STREET & NUMBER

97 Essex Avenue

CITY, TOWN

STATE

Montclair

VICINITY OF

New Jersey

5 LOCATION OF LEGAL DESCRIPTION

COURTHOUSE,
REGISTRY OF DEEDS, ETC.

Public Building

STREET & NUMBER

Rodney Square

CITY, TOWN

STATE

Wilmington

Delaware

6 REPRESENTATION IN EXISTING SURVEYS

TITLE

Cultural Resource Survey N-153

DATE

FEDERAL STATE COUNTY LOCAL

DEPOSITORY FOR
SURVEY RECORDS

Hall of Records

CITY, TOWN

STATE
Delaware

Dover

7 DESCRIPTION

CONDITION

- EXCELLENT
- GOOD
- FAIR
- DETERIORATED
- RUINS
- UNEXPOSED

CHECK ONE

- UNALTERED
- ALTERED

CHECK ONE

- ORIGINAL SITE
- MOVED DATE _____

DESCRIBE THE PRESENT AND ORIGINAL (IF KNOWN) PHYSICAL APPEARANCE

The Fleming House is located on the north side of the Smyrna River in Appoquinimink Hundred, southern New Castle County, Delaware. The property retains its mid-nineteenth-century setting, with cultivated fields on three sites, and a view of the river from the front. Associated with the house on the nominated property are six frame outbuildings dating from the late-nineteenth and early-twentieth centuries, and relating to the former use of the property as a farm. The boundaries of the property are marked by the edge of the lawn surrounding the house and outbuildings and separating the house lot from the cultivated fields on the west and north sides, a hedgerow and the farm land on the east, and the Smyrna River on the south.

The house itself is a five-bay, single-pile, two-and-a-half story center hall plan frame structure with a two-story frame wing, both sheathed with clapboard. The foundation is stone and brick, with a full basement under the main section. The gable roof of the main section has two interior end chimneys, a box cornice with bed moulding, and dormers on the facade. These Greek revival gable dormers are notable for their ornate pilasters. The facade features symmetrically spaced windows with 1/1 double hung sashes and plain surrounds. The shutters are panelled on the first floor level and louvered on the second. The central entrance has an etched glass door with a four paneled base, and a leaded glass transom. The frame facade porch has trabeated Greek revival posts with recessed panels. Plain porches are located on the west side of the wing and at the rear. There is an open string staircase in the center hall, and the doorways opening off of the hall have glass transoms. Interior details include trabeated door and window surrounds, Greek revival interior doors, and plain Greek revival mantels. The kitchen, located in the wing, features narrow Victorian wainscotting and an enclosed staircase. In general, the structure appears to have been little altered since its construction in the first half of the nineteenth century.

The arrangement of the outbuildings associated with the main structure appears to consist of remnants of a court plan with more modern structures being built closer to the house rather than replacing earlier buildings on or near their sites. These outbuildings are as follows:

GARAGE - late-19th century shed with factory sawn vertical board siding; gable roof with asphalt shingles; cast iron strap hinges.

SHED - early 20th century machine shed with uneven gable roof having exposed rafter ends and covered with corrugated metal; board and batten siding; 4 large entry bays of 2 doors each with very late strap hinges.

SMALL OUTBUILDING - early 20th century shed with large entry bay and smaller door; corrugated tin on gable roof with exposed rafter ends; 1 six-pane casement window.

LONG SHED - late 19th century board and batten barn probably for horses; gable roof with exposed rafter ends and corrugated metal covering; pulley at gable end serving loft door; 2 primary levels with vertical board doors and strap hinges; 1st floor doors are divided into upper and lower sections.

SMALL BARN - late Victorian 2-story barn of frame with board and batten siding; gable roof with exposed rafter ends, corrugated metal covering; doors to upper level(s) at gable end;

FHR-8-300A
(11/78)

UNITED STATES DEPARTMENT OF THE INTERIOR
HERITAGE CONSERVATION AND RECREATION SERVICE

**NATIONAL REGISTER OF HISTORIC PLACES
INVENTORY -- NOMINATION FORM**

FOR HCRS USE ONLY

RECEIVED NOV 27 1979

DATE ENTERED

JAN 3 1980

Fleming House

CONTINUATION SHEET

ITEM NUMBER 7 PAGE 1

section of lower floor of corn crib construction, with narrow vertical boards spaced so as to allow for ventilation. A 20th century frame CHICKEN HOUSE connects this building with the larger barn.

LARGER BARN - also of frame construction, 2 stories in height; gable roof with exposed rafter ends and corrugated metal covering; similar in dimension to #5, but of wide vertical board siding; shed roofed, 1 story addition to rear.

8 SIGNIFICANCE

PERIOD	AREAS OF SIGNIFICANCE -- CHECK AND JUSTIFY BELOW			
<input type="checkbox"/> PREHISTORIC	<input type="checkbox"/> ARCHEOLOGY-PREHISTORIC	<input type="checkbox"/> COMMUNITY PLANNING	<input type="checkbox"/> LANDSCAPE ARCHITECTURE	<input type="checkbox"/> RELIGION
<input type="checkbox"/> 1400-1499	<input type="checkbox"/> ARCHEOLOGY-HISTORIC	<input type="checkbox"/> CONSERVATION	<input type="checkbox"/> LAW	<input type="checkbox"/> SCIENCE
<input type="checkbox"/> 1500-1599	<input checked="" type="checkbox"/> AGRICULTURE	<input type="checkbox"/> ECONOMICS	<input type="checkbox"/> LITERATURE	<input type="checkbox"/> SCULPTURE
<input type="checkbox"/> 1600-1699	<input checked="" type="checkbox"/> ARCHITECTURE	<input type="checkbox"/> EDUCATION	<input type="checkbox"/> MILITARY	<input type="checkbox"/> SOCIAL/HUMANITARIAN
<input type="checkbox"/> 1700-1799	<input type="checkbox"/> ART	<input type="checkbox"/> ENGINEERING	<input type="checkbox"/> MUSIC	<input type="checkbox"/> THEATER
<input checked="" type="checkbox"/> 1800-1899	<input checked="" type="checkbox"/> COMMERCE	<input type="checkbox"/> EXPLORATION/SETTLEMENT	<input type="checkbox"/> PHILOSOPHY	<input type="checkbox"/> TRANSPORTATION
<input type="checkbox"/> 1900-	<input type="checkbox"/> COMMUNICATIONS	<input type="checkbox"/> INDUSTRY	<input type="checkbox"/> POLITICS/GOVERNMENT	<input type="checkbox"/> OTHER (SPECIFY)
		<input type="checkbox"/> INVENTION		

SPECIFIC DATES

BUILDER/ARCHITECT

STATEMENT OF SIGNIFICANCE

The Fleming House is an excellent example of the application of Greek revival architectural features to the standard five-bay, two-and-a-half story, single pile, center hall plan Delaware farm house. The trabeated interior window and door surrounds and porch pillars are characteristic of this style, as is the simplicity of other architectural features.

This property is part of a 200 acre tract occupied at least during the latter part of the eighteenth century as a moderate sized farm. Before its purchase by Joseph Fleming in 1822, the property passed through a series of complicated estate divisions and consolidations, in one of which the presence of "buildings on the river" is specified. No visible evidence of this occupation remains, nor have any archaeological traces been noted. The house itself appears to have been constructed by Fleming, a merchant in the nearby town of Smyrna, about 1830, at which time he changed his place of residence from Duck Creek Hundred to Appoquinimink Hundred. The location of the property and the name Flemings Landing suggests that it may have been the center of his mercantile activities. The association of this function with the house appears to have ceased with the death of Fleming's son, Enoch, before 1861, when the estate was sold to cover Enoch's debt's, although the nearby landing continued to be used. In Enoch's estate division, this property is referred to as "Mansion Farm", and it appears to have been operated as a farm into the twentieth century. At present the house is only intermittently occupied, although well-maintained, by out-of-state owners. The unaltered character of the property indicates that the potential exists for archaeological investigation, although no such work has yet been undertaken.

9 MAJOR BIBLIOGRAPHICAL REFERENCES

New Castle County Deed Books Z-2, pg. 456; L-3; p. 65; Z-3, p. 396; N-7, p. 453

New Castle County Orphans Court Records, I-1, p. 545, p. 582; K-1, p. 179.

UTM NOT VERIFIED
ACREAGE NOT VERIFIED

10 GEOGRAPHICAL DATA

ACREAGE OF NOMINATED PROPERTY 3.25

QUADRANGLE NAME Smyrna

QUADRANGLE SCALE _____

UTM REFERENCES

A 1 8 4 5 2 4 8 0 4 3 5 6 0 8 0

B [] [] [] [] [] [] [] [] [] [] [] [] [] [] [] []

ZONE EASTING NORTHING

ZONE EASTING NORTHING

ZONE EASTING NORTHING

C [] [] [] [] [] [] [] [] [] [] [] [] [] [] [] []

D [] [] [] [] [] [] [] [] [] [] [] [] [] [] [] []

E [] [] [] [] [] [] [] [] [] [] [] [] [] [] [] []

F [] [] [] [] [] [] [] [] [] [] [] [] [] [] [] []

G [] [] [] [] [] [] [] [] [] [] [] [] [] [] [] []

H [] [] [] [] [] [] [] [] [] [] [] [] [] [] [] []

VERBAL BOUNDARY DESCRIPTION Beginning at a hedgerow on the north bank of the Smyrna River approximately 250 feet west of the Fleming's Landing bridge, NNW with the line of the hedgerow approximately 325 feet to a farm lane, thence NNE with the farm lane approximately 75 feet, thence WNW along a line parallel to two farm buildings, 175 feet thence SW 375 feet to the

LIST ALL STATES AND COUNTIES FOR PROPERTIES OVERLAPPING STATE OR COUNTY BOUNDARIES

STATE	CODE	COUNTY	CODE

11 FORM PREPARED BY

NAME / TITLE

Cara L. Wise, Historical Archaeologist

ORGANIZATION

Division of Historical & Cultural Affairs

DATE

April 16, 1979

STREET & NUMBER

Hall of Records

TELEPHONE

302-678-5314

CITY OR TOWN

Dover

STATE

Delaware

12 STATE HISTORIC PRESERVATION OFFICER CERTIFICATION

THE EVALUATED SIGNIFICANCE OF THIS PROPERTY WITHIN THE STATE IS:

NATIONAL

STATE

LOCAL

As the designated State Historic Preservation Officer for the National Historic Preservation Act of 1966 (Public Law 89-665), I hereby nominate this property for inclusion in the National Register and certify that it has been evaluated according to the criteria and procedures set forth by the National Park Service.

Deputy

STATE HISTORIC PRESERVATION OFFICER SIGNATURE

Daniel R. Griffith

TITLE Chief; Bureau of Archaeology & Historic Preservation

DATE

11/20/79

FOR NPS USE ONLY

I HEREBY CERTIFY THAT THIS PROPERTY IS INCLUDED IN THE NATIONAL REGISTER

KEEPER OF THE NATIONAL REGISTER

DATE

1-31-80

ATTEST:

CHIEF OF REGISTRATION

DATE

1/29/80

Regional Coordinator

FHR-8-300A
(11/78)

UNITED STATES DEPARTMENT OF THE INTERIOR
HERITAGE CONSERVATION AND RECREATION SERVICE

**NATIONAL REGISTER OF HISTORIC PLACES
INVENTORY -- NOMINATION FORM**

FOR HCRS USE ONLY
RECEIVED NOV 27 1979
DATE ENTERED JAN 3 1980

Fleming House

CONTINUATION SHEET

ITEM NUMBER 10 PAGE 1

VERBAL BOUNDARY DESCRIPTION CONTINUED

marsh, south with the marsh 200 feet to the Smyrna River, thence along the north bank of the Smyrna River 450 feet to the place of the beginning.

NOV 27 1979



- 1. House
- 2. Garage
- 3. Shed
- 4. Small outbuilding
- 5. Long shed
- 6. Small barn
- 7. Larger barn

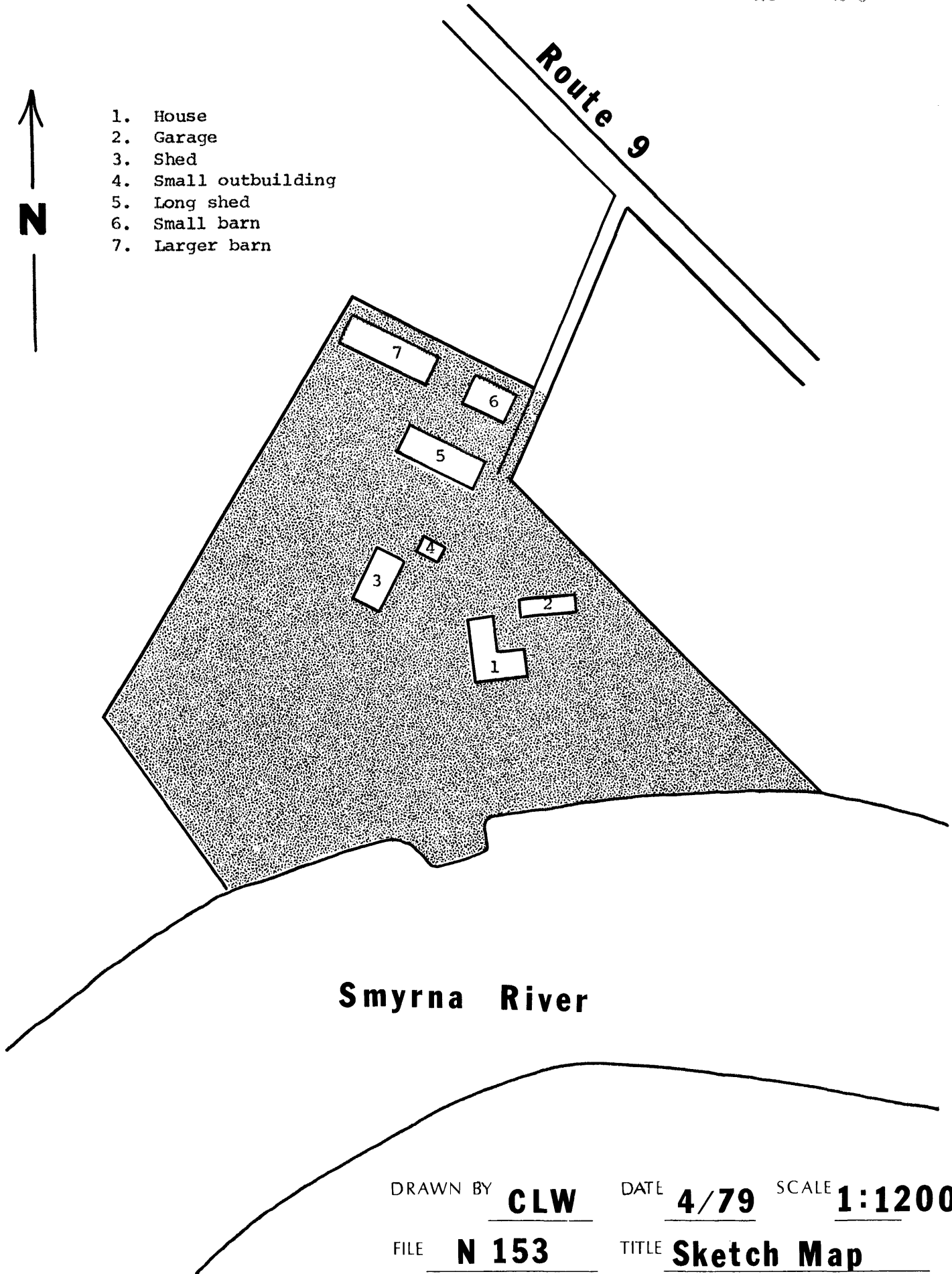

Smyrna River

DRAWN BY CLW DATE 4/79 SCALE 1:1200
FILE N 153 TITLE Sketch Map