

LIGHTHOUSES OF MASSACHUSETTS
THEMATIC GROUP NOMINATION

LIGHTHOUSE INFORMATION FORM

NUMBER 13

MASSACHUSETTS HISTORICAL COMMISSION
80 Boylston Street, Boston, MA 02116

PHOTOGRAPH KEY

United States Coast Guard, Boston,
1, date unknown.

HISTORIC NAME: Cleveland Ledge Light Station

TOWN: Bourne

LOCATION: 21' of water on a ledge 2 mi.
offshore in

COUNTY: Barnstable CODE: 001

CONGRESSIONAL DISTRICT: 10th

LOCATION OF LEGAL DESCRIPTION:

Barnstable County Courthouse

VERBAL BOUNDARY DESCRIPTION:

The nomination is confined to the light
and its man-made foundation.

SKETCH MAP

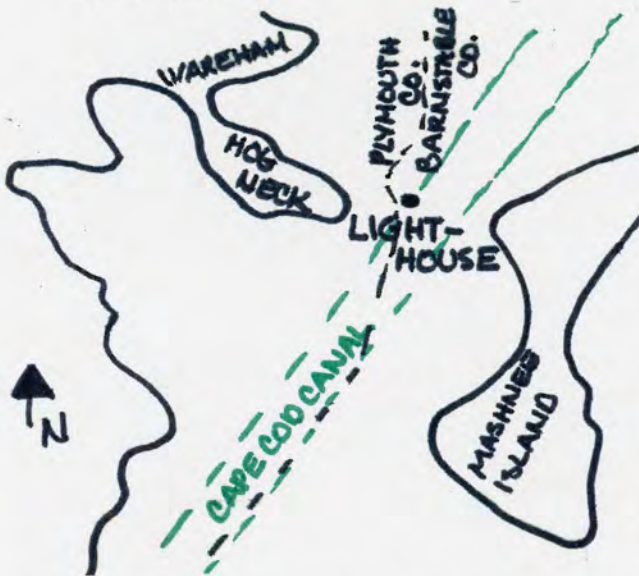

LAT./LONG.: 41 31'57"N/70 41'40"W

UTM COORDINATE: 19/358/500/4609/900

USGS QUADRANGLE: Prov.RI., Mass., Conn.

SCALE: 1:250,000

ACREAGE: Marine Site - less than one acre

OWNER(S): United States Coast Guard

First Coast Guard District

408 Atlantic Ave.

Boston, Massachusetts 02110

STATUS: _____

Active/Unmanned

RECORDED BY: N. Salzman

ORGANIZATION: MHC

DATE: July, 1981

Cleveland Ledge Light Station, Bourne

SITE DESCRIPTION: The Cleveland Ledge Light Station is located in Buzzard's Bay at the east side of the southern entrance to the channel approaching Cape Cod Canal. It sits in 21' of water on a caisson foundation on a ledge two miles from shore.

LIGHTHOUSES OF MASSACHUSETTS
THEMATIC GROUP NOMINATION

MAJOR ELEMENTS: The structure is a 1940 caisson from which rises a two story dwelling surmounted by a tall tower and a traditional lantern. It is Art Moderne in style and is 74' tall and painted white.

Covering 1200 square feet of floor area, the Light Station was built at a cost of \$250,000.

Foundation - concrete 52' high, filled with rock.

Main Deck - of steel surrounded by simple railing of post and 3 horizontal rails, reminiscent of the bridge of a luxury liner of the 1930s.

Level one - L1 is round with 8 faces; wide windows alternate with narrow windows in the lower section of the 2 story square rooms.

Level two - L2 consists of a square cross superimposed on the round first level. Windows at each of the four faces are directly above those at level one. Roof decks are of quadrant shape and top the level one sections between the second level rooms.

Tower - The lighthouse tower rises 50' from the center of the square cross.

Lamp room - The lamp room level has 4 portholes.

Lantern - The lantern, which is surrounded by an iron railing with a shallow balcony walkway, is a typical 19th century cast iron lantern with cast iron panels and a scuttle door in the lower level.

Diagonal astragals (as are also found at Bird Island, #4) connect to posts in the lens room. A ladder leads to the roof which supports an antenna.

There is no ventilator ball or lightning rod (as the building is recent in technology).

LIGHT CHARACTERISTICS - Flw/10 sec., 6PL lampchanger/Lamp 3.05A/250mm plastic lens/CC8TH lamp rot optic 3 rpm 120v/11vDC/omni-directional L2EFL 2 foghorns. 1b1/15 secs (2s blast).

CHRONOLOGICAL HISTORY:

- 1940 - Construction begins; last lighthouse built in Massachusetts.
- 9/18/1941 - Transferred to government in partially completed condition because of war threat with temporary light installed; survived a violent storm.
- 1958 - Fixed light, white kerosene installed.
- 1961 - 3 AC generator converted from DC, \$4000.
- 1978 - Automated; at that time, Coast Guard personnel were removed.
- 1982 - Coast Guard plans to install glass block windows for security and maintenance purposes.

LEVEL OF SIGNIFICANCE

The Cleveland Ledge Light Station possesses integrity of location, design, setting, materials, and workmanship as well as important associations with the development of aids to navigation in Massachusetts. Erected in 1940, it is a well maintained example of caisson construction and the last lighthouse of traditional form to be erected in the state. Because of its late date, this light exhibits unique Art Moderne design features. The Cleveland Ledge Light Station meets criteria A and C of the National Register of Historic Places on the state level, as well as survey criteria 1a, 1e.

United States Department of the Interior
National Park Service

National Register of Historic Places
Continuation Sheet

MAY 4 1987

Section number Page 174

Multiple Resource Area
Thematic Group

Name Lighthouses of Massachusetts TR
State MASSACHUSETTS

Nomination/Type of Review

Date/Signature

Cover Substantive Review

Keeper

[Handwritten signature] 6/15/87

< 50 1. Cleveland LEDGE Light Station
Substantive Review

Keeper

[Handwritten signature] 6/15/87

2. Highland Light Station (Cape Cod Light)
Entered in the National Register

for Keeper

[Handwritten signature] 6/15/87

Attest

3. Gay Head Light
Entered in the National Register

for Keeper

[Handwritten signature] 6/15/87

Attest

4. Edgartown Harbor Light
Entered in the National Register

for Keeper

[Handwritten signature] 6/15/87

Attest

5. Derby Wharf Light Station
Entered in the National Register

for Keeper

[Handwritten signature] 6/15/87

Attest

6. East Chop Light
Entered in the National Register

for Keeper

[Handwritten signature] 6/15/87

Attest

7. Eastern Point Light Station
Entered in the National Register

for Keeper

[Handwritten signature] 9/30/87

Attest

8. Long Island Head Light
Entered in the National Register

for Keeper

[Handwritten signature] 6/15/87

Attest

9. Long Point Light Station
Entered in the National Register

for Keeper

[Handwritten signature] 9/28/87

Attest

10. Marblehead Light
Entered in the National Register

for Keeper

[Handwritten signature] 6/15/87

Attest

- 50 yrs
87001462

NATIONAL REGISTER OF HISTORIC PLACES
EVALUATION/RETURN SHEET

Cleveland Ledge Light Station (Lighthouses of Massachusetts TR)
Barnstable County
MASSACHUSETTS

Substantive Review

Working No. 4/28/87
Fed. Reg. Date: 2/2/88
Date Due: 6/15/87
Action: ACCEPT 6-15-87
 RETURN
 REJECT
Federal Agency: USCG

- resubmission
- nomination by person or local government
- owner objection
- appeal

Substantive Review: sample request appeal NR decision

Reviewer's comments:

See comment sheet.

Recom./Criteria: Accept A+C
Reviewer: Swartz
Discipline: Archaeology, General History
Date: 6/12/87
see continuation sheet

Nomination returned for: technical corrections cited below
 substantive reasons discussed below

1. Name

2. Location

3. Classification

Category Ownership Status Present Use
Public Acquisition Accessible

4. Owner of Property

5. Location of Legal Description

6. Representation in Existing Surveys

Has this property been determined eligible? yes no

7. Description

Condition Check one Check one
 excellent deteriorated unaltered original site
 good ruins altered moved date _____
 fair unexposed

Describe the present and original (if known) physical appearance

- summary paragraph
- completeness
- clarity
- alterations/integrity
- dates
- boundary selection

8. Significance

Period _____ Areas of Significance—Check and justify below

Specific dates _____ Builder/Architect _____

Statement of Significance (*in one paragraph*)

- summary paragraph
- completeness
- clarity
- applicable criteria
- justification of areas checked
- relating significance to the resource
- context
- relationship of integrity to significance
- justification of exception
- other

9. Major Bibliographical References

10. Geographical Data

Acreage of nominated property _____

Quadrangle name _____

UTM References _____

Verbal boundary description and justification _____

11. Form Prepared By

12. State Historic Preservation Officer Certification

The evaluated significance of this property within the state is:

____ national ____ state ____ local

State Historic Preservation Officer signature _____

title _____

date _____

13. Other

- Maps
- Photographs
- Other

Questions concerning this nomination may be directed to _____

Signed _____ Date _____ Phone: _____



CLEVELAND LEDGE LIGHT
STATION
BOURNE, MA #13

PHOTO #1 OF 1

*Cleveland
Ledge*

*Bunhards
Bay*

LIGHTHOUSES OF MASSACHUSETTS
THEMATIC GROUP NOMINATION

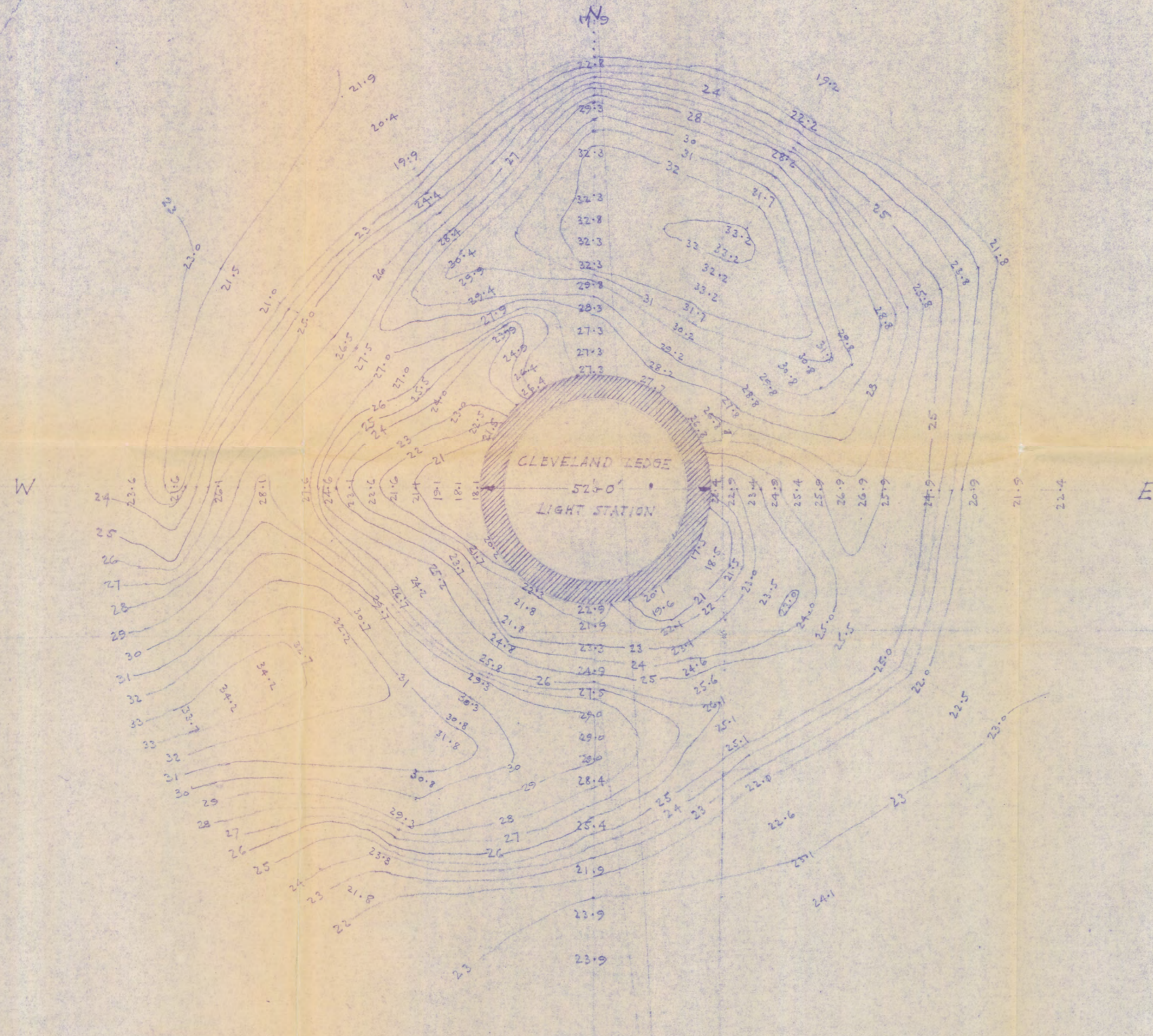

LIGHTHOUSES OF MASSACHUSETTS
THEMATIC GROUP NOMINATION

13

CLEVELAND LEDGE LIGHT STA., BOURNE MASS.

SOUNDING AROUND
FOUNDATION CYLINDER

Scale 1" = 20'
5 February 1941.

UNITED STATES COAST GUARD
Hydrographic Survey made by
J.E. Macaulay - Plotted by: J.E.M.

FIELD
SKETCH
NO. 1

LIGHTHOUSES OF MASSACHUSETTS
THEMATIC GROUP NOMINATION

Please refer to the map in the
Multiple Property Cover Sheet
for this property

Multiple Property Cover Sheet Reference Number: 64000282