

**NATIONAL REGISTER OF HISTORIC PLACES  
INVENTORY - NOMINATION FORM**

(Type all entries - complete applicable sections)

STATE: California	
COUNTY: San Francisco	
FOR NPS USE ONLY	
ENTRY NUMBER	DATE
	MAR 8 1973

1. NAME

COMMON: House at 770 Turk Street Western Addition Project Area

AND/OR HISTORIC: 1249-1251 Scott St.  
770 Turk Street

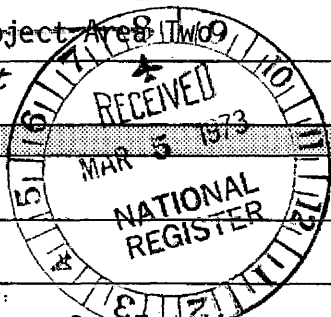

2. LOCATION

STREET AND NUMBER: 770 Turk Street

CITY OR TOWN: San Francisco

STATE: California CODE: 06 COUNTY: San Francisco CODE: 075

3. CLASSIFICATION

CATEGORY (Check One)	OWNERSHIP	PUBLIC ACQUISITION	STATUS	ACCESSIBLE TO THE PUBLIC
<input type="checkbox"/> District <input type="checkbox"/> Site <input type="checkbox"/> Object <input checked="" type="checkbox"/> Building <input type="checkbox"/> Structure	<input type="checkbox"/> Public <input checked="" type="checkbox"/> Private <input type="checkbox"/> Both	<input type="checkbox"/> In Process <input type="checkbox"/> Being Considered	<input type="checkbox"/> Occupied <input checked="" type="checkbox"/> Unoccupied <input type="checkbox"/> Preservation work in progress	Yes: <input checked="" type="checkbox"/> Restricted <input type="checkbox"/> Unrestricted <input type="checkbox"/> No

PRESENT USE (Check One or More as Appropriate)

<input type="checkbox"/> Agricultural	<input type="checkbox"/> Government	<input type="checkbox"/> Park	<input type="checkbox"/> Transportation	<input type="checkbox"/> Comments
<input type="checkbox"/> Commercial	<input type="checkbox"/> Industrial	<input checked="" type="checkbox"/> Private Residence	<input type="checkbox"/> Other (Specify)	
<input type="checkbox"/> Educational	<input type="checkbox"/> Military	<input type="checkbox"/> Religious		
<input type="checkbox"/> Entertainment	<input type="checkbox"/> Museum	<input type="checkbox"/> Scientific		

Visual access only

4. OWNER OF PROPERTY

OWNER'S NAME: San Francisco Redevelopment Agency

STREET AND NUMBER: 762 Fulton Street

CITY OR TOWN: San Francisco STATE: California CODE: 06

5. LOCATION OF LEGAL DESCRIPTION

COURTHOUSE, REGISTRY OF DEEDS, ETC.: San Francisco Assessor's Office

STREET AND NUMBER: City Hall

CITY OR TOWN: San Francisco STATE: California CODE: 06

6. REPRESENTATION IN EXISTING SURVEYS

TITLE OF SURVEY: San Francisco Conservation Committee Survey \*  
(Under the auspices of San Francisco Redevelopment Agency)

DATE OF SURVEY: 1962  Federal  State  County  Local

DEPOSITORY FOR SURVEY RECORDS: San Francisco Redevelopment Agency

STREET AND NUMBER: 762 Fulton Street

CITY OR TOWN: San Francisco STATE: California CODE: 06

STATE: California

COUNTY: San Francisco

ENTRY NUMBER

DATE

FOR NPS USE ONLY

SEE INSTRUCTIONS

\*Also: Junior League of San Francisco Survey  
(Both surveys were adopted by the Landmarks Preservation Advisory Board of the City and County of San Francisco.)

7. DESCRIPTION

CONDITION	(Check One)					
	<input type="checkbox"/> Excellent	<input type="checkbox"/> Good	<input checked="" type="checkbox"/> Fair	<input type="checkbox"/> Deteriorated	<input type="checkbox"/> Ruins	<input type="checkbox"/> Unexposed
	(Check One)			In process (Check One)		
	<input type="checkbox"/> Altered	<input checked="" type="checkbox"/> Unaltered		<input checked="" type="checkbox"/> Moved	<input type="checkbox"/> Original Site	

DESCRIBE THE PRESENT AND ORIGINAL (if known) PHYSICAL APPEARANCE

A two-story, wood frame, single-family dwelling, set back from the street. This building retains an air of spaciousness which belies its modest dimensions. Italianate, with Doric columns and ornamentation, this house demonstrates the possibility of gracious exterior spatial planning in architecture upon a rather narrow San Francisco lot. The lines are simple and strong with some emphasis on the curvilinear pattern of the windows.

A two-story angle bay window accentuates the right side of the facade as seen by an observer facing the structure and is balanced by the tall porch and columns flanking the entrance on the left side.

The fenestration provides the most distinctive feature of the house and gives an elegant restrained character and unity to the building. Medium width round-arched windows, without any pairing, stand on each face of the bay at each floor level. Double-hung, they are surrounded by striated mouldings reminiscent of the Medieval Gothic doorways of French cathedrals. The upper story windows have ornaments centered above the windows, breaking the lines of striation. These ornaments are composed of a dominant fleur de lis with a triple scroll below, centered on the way and offset striation lines of the mouldings. Oblong inset panels face the lower parts of the bays below the windows.

The porch and entrance are deep and imposing. Pairs of columns of the Doric order--the inner ones engaged-- are fluted with simple caps and support a porch roof composed of an architrave with triglyphs, in turn surmounted by a strong projecting dentillated wood cornice. The entrance doorway of a single leaf door with a large single pane, is surmounted by a semicircular (lunette) window which echoes the semi-circular arch design of the entranceway.

The shallow-pitched roof projects over the facade, forming a cornice, which is also dentillated by brackets similar to the porch roof.

The facade is formed of flat boards, rusticated with incised joints. The corners are marked with wide, flat pilasters extending the full height of the house and decorated with simple lines and geometric designs and with a spherical piece of trim at the center.

The wide porch stairs of concrete flow down from the doorway to the street, widening as they proceed. The low concrete garden wall is rough-cast to simulate stone and has a coping, smooth-finished. A wood lath screen fence with door of the same woodscreen, protects the side yard to the left of the entrance.

Although many absentee landlords owned this Victorian structure, it has remained in fair condition both inside and outside. This lovely Victorian is to be moved to become one of a row of Victorians on Scott Street at Ellis Street.

SEE INSTRUCTIONS

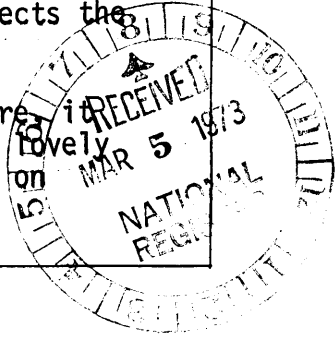

**SIGNIFICANCE**

PERIOD (Check One or More as Appropriate)

- |  |                                       |  |                                       |
|--|---------------------------------------|--|---------------------------------------|
| <input type="checkbox"/> Pre-Columbian | <input type="checkbox"/> 16th Century | <input type="checkbox"/> 18th Century            | <input type="checkbox"/> 20th Century |
| <input type="checkbox"/> 15th Century  | <input type="checkbox"/> 17th Century | <input checked="" type="checkbox"/> 19th Century |                                       |

SPECIFIC DATE(S) (If Applicable and Known) **1868**

AREAS OF SIGNIFICANCE (Check One or More as Appropriate)

- |  |   |  |  |
|--|---|--|--|
| <input type="checkbox"/> Aboriginal              | <input type="checkbox"/> Education              | <input type="checkbox"/> Political           | <input type="checkbox"/> Urban Planning  |
| <input type="checkbox"/> Prehistoric             | <input type="checkbox"/> Engineering            | <input type="checkbox"/> Religion/Philosophy | <input type="checkbox"/> Other (Specify) |
| <input type="checkbox"/> Historic                | <input type="checkbox"/> Industry               | <input type="checkbox"/> Science             | _____                                    |
| <input type="checkbox"/> Agriculture             | <input type="checkbox"/> Invention              | <input type="checkbox"/> Sculpture           | _____                                    |
| <input checked="" type="checkbox"/> Architecture | <input type="checkbox"/> Landscape Architecture | <input type="checkbox"/> Social/Humanitarian | _____                                    |
| <input type="checkbox"/> Art                     | <input type="checkbox"/> Literature             | <input type="checkbox"/> Theater             | _____                                    |
| <input type="checkbox"/> Commerce                | <input type="checkbox"/> Military               | <input type="checkbox"/> Transportation      | _____                                    |
| <input type="checkbox"/> Communications          | <input type="checkbox"/> Music                  |  |  |
| <input type="checkbox"/> Conservation            |   |  |  |

STATEMENT OF SIGNIFICANCE

The San Francisco Water Department records show this building as being connected to the water system in 1868. The Junior League of San Francisco's book Here Today concurs with this date and goes on to say, "This example of Italianate Style commands respect. It has especially fine window framing on the second floor."

The original owner was John K. Wood, an accountant for the P. M. Steamship Company, who lived there. This property passed through six parties before purchase by the San Francisco Redevelopment Agency in 1967. Many of the previous owners were absentee landlords and used this property as rental property.

This Victorian structure survived the 1906 earthquake and fire. Originally, this building was a large single-family residence, but recently it was used as a rooming house with each room being rented separately.

Because of the zoning within the project area, this building has to be either demolished or moved to a more suitable location where it can be rehabilitated and preserved. This will be one of eight buildings to be moved onto a two-block development within the Western Addition Area 2. These two city blocks will be intensively developed with projects including scattered public housing, moderately priced private housing, private rehabilitation and rehabilitation for public bidding and resale by the San Francisco Redevelopment Agency. A few rehabilitation projects have already been completed within these two blocks.

770 Turk will be moved to Block 1127, Lot 1, to become one of a handsome row of newly moved Victorians on Scott Street at Ellis Street. 770 Turk is one of the six most important Victorian structures chosen by the San Francisco Landmarks Preservation Advisory Board as having exceptional merit.

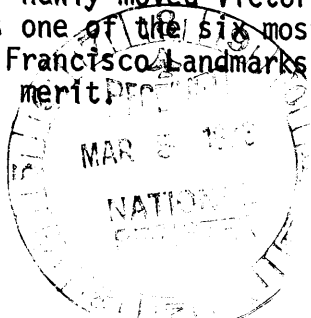

SEE INSTRUCTIONS

**9 MAJOR BIBLIOGRAPHICAL REFERENCES**

Junior League of San Francisco, Inc. Here Today- San Francisco's Architectural Heritage, (Chronicle Books, San Francisco, 1968)

**10. GEOGRAPHICAL DATA**

LATITUDE AND LONGITUDE COORDINATES DEFINING A RECTANGLE LOCATING THE PROPERTY				OR	LATITUDE AND LONGITUDE COORDINATES DEFINING THE CENTER POINT OF A PROPERTY OF LESS THAN TEN ACRES							
CORNER	LATITUDE				LONGITUDE							
	Degrees	Minutes	Seconds	Degrees	Minutes	Seconds	Degrees	Minutes	Seconds			
NW	°	'	"	°	'	"	N37°	46'	56"	W122°	25'	14"
NE	°	'	"	°	'	"						
SE	°	'	"	°	'	"						
SW	°	'	"	°	'	"						

APPROXIMATE ACREAGE OF NOMINATED PROPERTY: **2,973 sq. ft.**

LIST ALL STATES AND COUNTIES FOR PROPERTIES OVERLAPPING STATE OR COUNTY BOUNDARIES

STATE:	CODE	COUNTY:	CODE

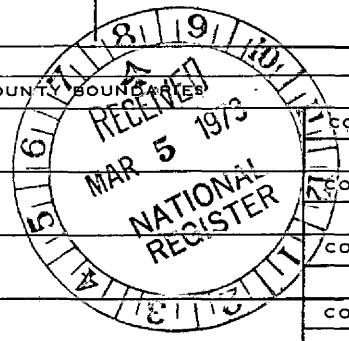

10/551030  
4181570  
CD

SEE INSTRUCTIONS

**11. FORM PREPARED BY**

NAME AND TITLE: **Enid T. Sales, Rehabilitation Supervisor; Susan Bragstad, Architect**

ORGANIZATION: **San Francisco Redevelopment Agency \*** DATE: **January 9, 1973**

STREET AND NUMBER: **762 Fulton Street**

CITY OR TOWN: **San Francisco** STATE: **California** CODE: **06**

**12. STATE LIAISON OFFICER CERTIFICATION NATIONAL REGISTER VERIFICATION**

<p>As the designated State Liaison Officer for the National Historic Preservation Act of 1966 (Public Law 89-665), I hereby nominate this property for inclusion in the National Register and certify that it has been evaluated according to the criteria and procedures set forth by the National Park Service. The recommended level of significance of this nomination is:</p> <p>National <input type="checkbox"/> State <input type="checkbox"/> Local <input checked="" type="checkbox"/></p> <p>Name <u><i>[Signature]</i></u></p> <p>Title <u>State Liaison Officer</u></p> <p>Date <u>FEB 12 1972</u></p>	<p>I hereby certify that this property is included in the National Register.</p> <p><u><i>[Signature]</i></u> Chief, Office of Archeology and Historic Preservation</p> <p>Date <u>3/8/73</u></p> <p>ATTEST</p> <p><u><i>[Signature]</i></u> Keeper of The National Register</p> <p>Date <u>3-7-73</u></p>
---	--

Also \*San Francisco Landmarks Preservation Advisory Board  
100 Larkin Street  
San Francisco, California 06

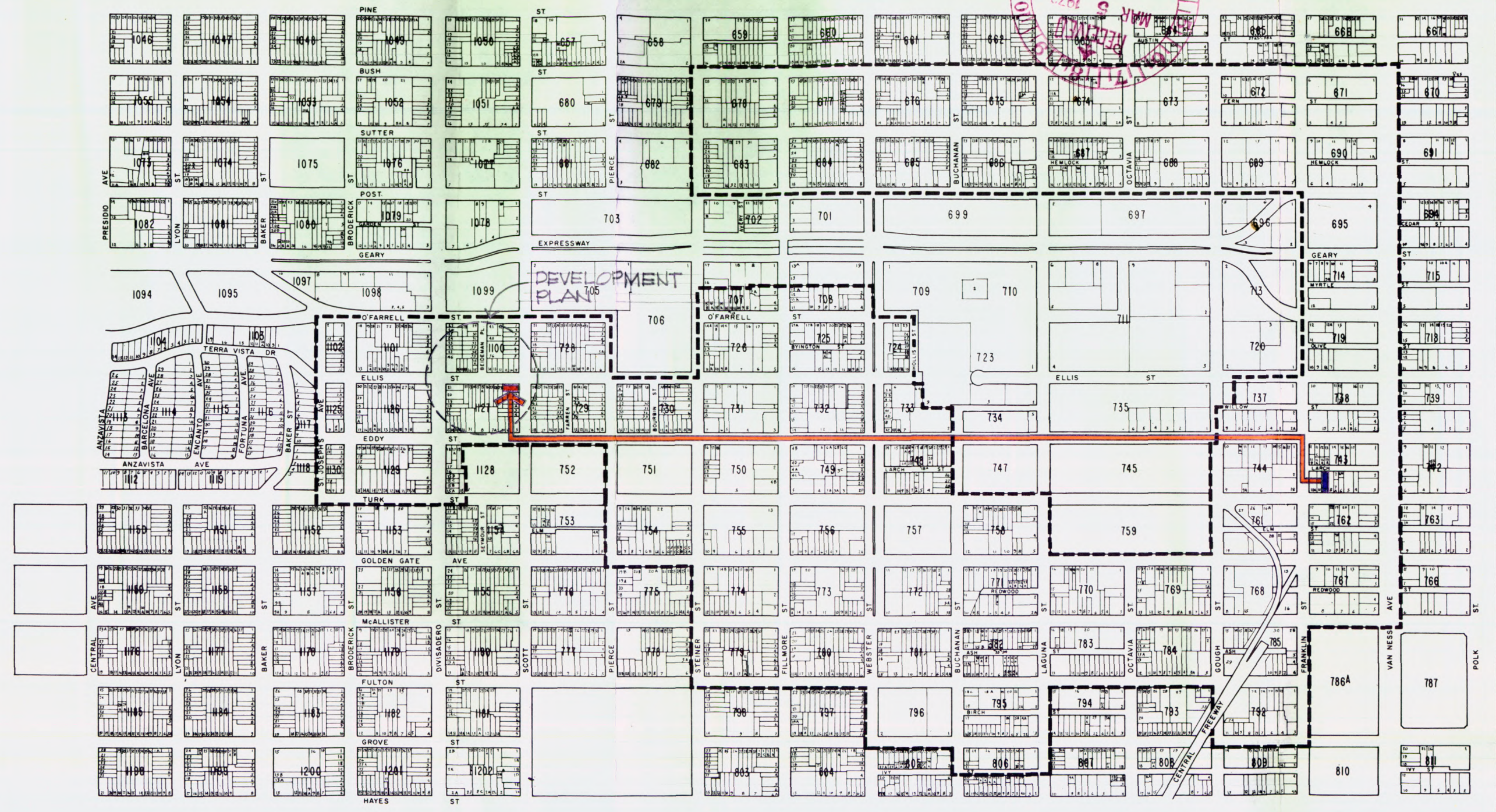
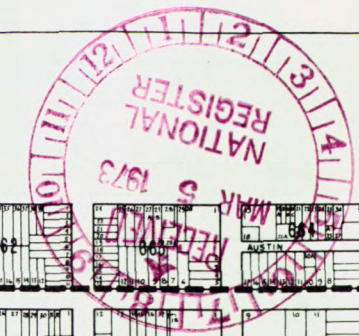

LEGEND - - - - - PROJECT BOUNDARY

### WESTERN ADDITION AREA TWO

## RELOCATION OF 770 TURK (REFER TO MAP "C" FOR DEVELOPMENT PLAN)

- EXIST. LOCATION
- NEW LOCATION



MAP B

Form 10-301  
(Dec. 1968)

UNITED STATES DEPARTMENT OF THE INTERIOR  
NATIONAL PARK SERVICE

**NATIONAL REGISTER OF HISTORIC PLACES  
PROPERTY MAP FORM**

*(Type all entries - attach to or enclose with map)*

STATE	
California	
COUNTY	
San Francisco	
FOR NPS USE ONLY	
ENTRY NUMBER	DATE
770	MAR 7 1973

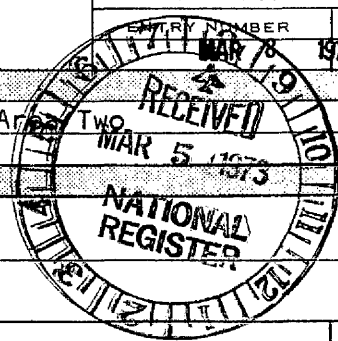

SEE INSTRUCTIONS

<b>1. NAME</b>			
COMMON: 770 Turk Street, Western Addition Project Area Two			
AND/OR HISTORIC: 770 Turk Street			
<b>2. LOCATION</b>			
STREET AND NUMBER:			
770 Turk Street			
CITY OR TOWN:			
San Francisco			
STATE:	CODE	COUNTY:	CODE
California	006	San Francisco	075
<b>3. MAP REFERENCE</b>			
SOURCE:			
San Francisco Redevelopment Agency			
SCALE: 1:7200			
DATE: 1972			
<b>4. REQUIREMENTS</b>			
TO BE INCLUDED ON ALL MAPS			
1. Property boundaries where required.			
2. North arrow.			
3. Latitude and longitude reference.			

O'FARRELL STREET  
BLK. 1100

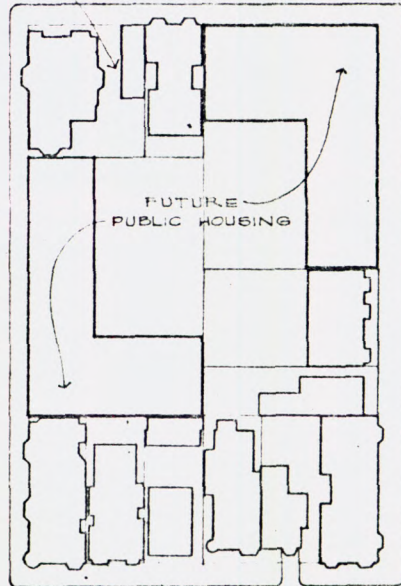
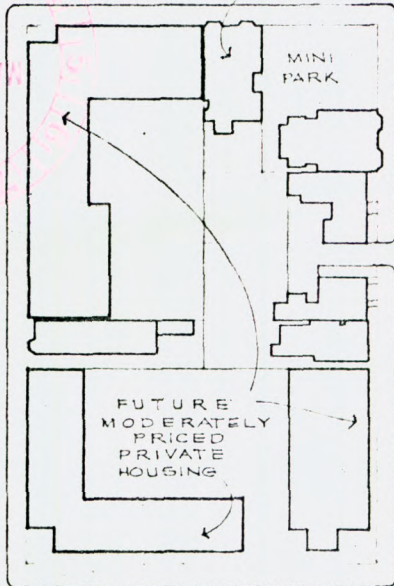

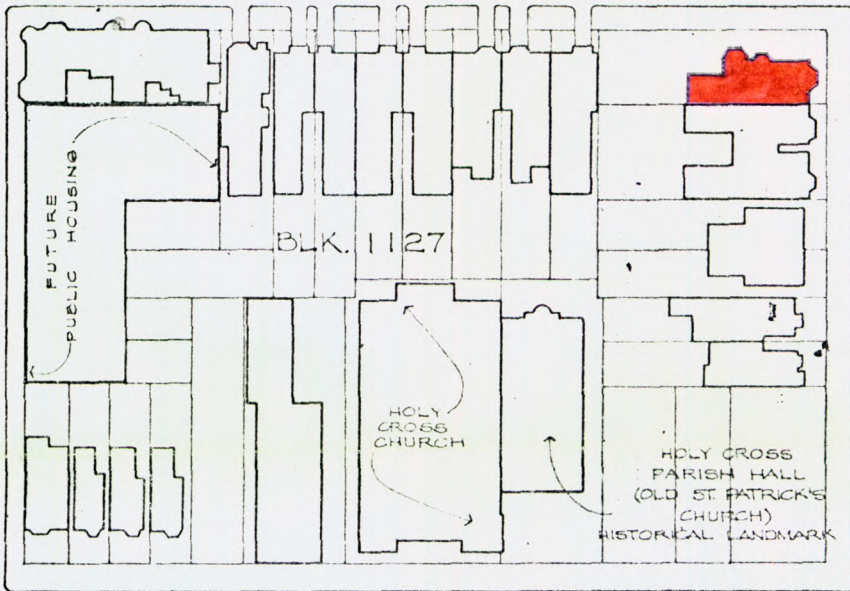

J  
O  
Z  
A  
N  
E  
D  
S  
T  
R  
E  
E  
T

ELLIS STREET



EDDY STREET

LEGEND

-  NEW LOCATION OF 770 TURK
  -  BLDGS. TO BE REHABILITATED
- SCALE 1" = 100'-0"



RECEIVED  
MAR 5 1973  
NATIONAL REGISTER

Form 10-301  
(Dec. 1968)

UNITED STATES DEPARTMENT OF THE INTERIOR  
NATIONAL PARK SERVICE

**NATIONAL REGISTER OF HISTORIC PLACES**  
**PROPERTY MAP FORM**

*(Type all entries - attach to or enclose with map)*

STATE	
California	
COUNTY	
San Francisco	
FOR NPS USE ONLY	
ENTRY NUMBER	DATE
1	MAR 5 1973

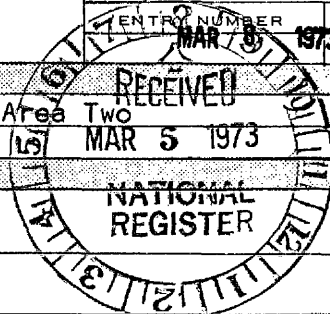

SEE INSTRUCTIONS

<b>1. NAME</b>			
COMMON: 770 Turk Street, Western Addition Project Area Two			
AND/OR HISTORIC: 770 Turk Street			
<b>2. LOCATION</b>			
STREET AND NUMBER:			
770 Turk Street			
CITY OR TOWN:			
San Francisco			
STATE:	CODE	COUNTY:	CODE
California	006	San Francisco	075
<b>3. MAP REFERENCE</b>			
SOURCE:			
San Francisco Redevelopment Agency			
SCALE: 1:1200			
DATE: 1973			
<b>4. REQUIREMENTS</b>			
TO BE INCLUDED ON ALL MAPS			
1. Property boundaries where required.			
2. North arrow.			
3. Latitude and longitude reference.			