

United States Department of the Interior
National Park Service

RECEIVED

FEB 26 1988

National Register of Historic Places
Registration Form

NATIONAL
REGISTER

This form is for use in nominating or requesting determinations of eligibility for individual properties or districts. See instructions in *Guidelines for Completing National Register Forms* (National Register Bulletin 16). Complete each item by marking "x" in the appropriate box or by entering the requested information. If an item does not apply to the property being documented, enter "N/A" for "not applicable." For functions, styles, materials, and areas of significance, enter only the categories and subcategories listed in the instructions. For additional space use continuation sheets (Form 10-900a). Type all entries.

1. Name of Property

historic name Stacker, Samuel, House
other names/site number N/A

2. Location

street & number Long Branch Road N/A not for publication
city, town Dover vicinity
state Tennessee code TN county Stewart code TN161 zip code 37058

3. Classification

Ownership of Property	Category of Property	Number of Resources within Property	
<input checked="" type="checkbox"/> private	<input checked="" type="checkbox"/> building(s)	Contributing	Noncontributing
<input type="checkbox"/> public-local	<input type="checkbox"/> district	<u>5</u>	<u>11</u> buildings
<input type="checkbox"/> public-State	<input type="checkbox"/> site	<u>1</u>	<u>11</u> sites
<input type="checkbox"/> public-Federal	<input type="checkbox"/> structure	<u>6</u>	<u>11</u> structures
	<input type="checkbox"/> object		<u>11</u> objects
			<u>11</u> Total

Name of related multiple property listing:
Iron Industry on the Western Highland
Rim 1790s-1920s

Number of contributing resources previously listed in the National Register 0

4. State/Federal Agency Certification

As the designated authority under the National Historic Preservation Act of 1966, as amended, I hereby certify that this nomination request for determination of eligibility meets the documentation standards for registering properties in the National Register of Historic Places and meets the procedural and professional requirements set forth in 36 CFR Part 60. In my opinion, the property meets does not meet the National Register criteria. See continuation sheet.

Herbert E. Bayer 2/19/88
Signature of certifying official Date
Deputy State Historic Preservation Officer, Tennessee Historical Commission
State or Federal agency and bureau

In my opinion, the property meets does not meet the National Register criteria. See continuation sheet.

Signature of commenting or other official Date

State or Federal agency and bureau

5. National Park Service Certification

I, hereby, certify that this property is:

entered in the National Register.
 See continuation sheet.

determined eligible for the National Register. See continuation sheet.

determined not eligible for the National Register.

removed from the National Register.

other, (explain:)

John J. Knoesh 2/11/88
Signature of the Keeper Date of Action

United States Department of the Interior
National Park Service

**National Register of Historic Places
Continuation Sheet**

Section number 7 Page 2

Stacker, Samuel, House

1. Fountain. Goose and floral motif, crafted in France. (C)
2. Spring house. Limestone, hip roof, strap hinges on door, pegged door frame. (C)
3. Barn. Shed roof extension, tin gable roof, transverse crib.(C)
4. Bath House. Limestone pier foundation now filled in with concrete, tin gable roof, two paneled wood doors. (C)
5. Workshop. Limestone and weatherboard, tin gable roof, new windows. (C)
6. Log slave quarters. Gable roof, recently moved, deteriorated condition. (NC)

Another spring house, two log barns, three farm outbuildings, two concrete block buildings. a garage. and numerous small sheds were built during the latter part of the nineteenth century or the twentieth century and do not contribute to the overall significance of the property.

8. Statement of Significance

Certifying official has considered the significance of this property in relation to other properties:

nationally statewide locally

Applicable National Register Criteria A B C D

Criteria Considerations (Exceptions) A B C D E F G N/A

Areas of Significance (enter categories from instructions)

INDUSTRY
ARCHITECTURE

Period of Significance

circa 1856-1859

Significant Dates

N/A

Cultural Affiliation

N/A

Significant Person

Stacker, Samuel

Architect/Builder

Unknown

State significance of property, and justify criteria, criteria considerations, and areas and periods of significance noted above.

The Samuel Stacker House is significant under criterion B because of its association with Stacker, a prominent ironmaster. Although he only lived here for a short period of time, this is the only known extant building in Tennessee associated with him. Unlike individuals who merely invested in an iron works and lived outside the region, Samuel Stacker was actively involved in the operations of various furnaces. Architecturally, the house is an excellent example of vernacular Greek Revival design in Stewart County. Paired chimneys, transoms and sidelights, and interior woodwork are some of the distinguishing features of the house.

Stacker was born in Radnor Township, Pennsylvania in 1788. He arrived in Nashville in 1819 to work as a contractor on the first bridge to be built across the Cumberland River. He and his brother John had purchased a furnace in Montgomery County by the late 1820s. They eventually owned furnaces and ore lands in both Kentucky and Tennessee.

Samuel and John Stacker signed an 1827 petition that requested special treatment for iron manufacturers with regards to military service. (See section E of the multiple property nomination.) Several other prominent ironmasters in Tennessee also signed this petition. The Stacker brothers had interests in many furnaces including the Cumberland Iron Works, one of the larger operations in Stewart County. This company was begun by Samuel and John Stacker, Joseph and Robert Woods, and Thomas Yeatman during the 1820s. It operated furnaces under the name of Woods, Yeatman, and Company and owned over 60,000 acres of land on both sides of the Cumberland River, west of Dover, Tennessee (Killebrew 1881:100). Bear Spring(40SW207) and Bellwood(40SW210) were operated by this company. The Stackers also had interests in the LaGrange(40SW214) and Lafayette(40MT372) furnaces. Some of the iron works were operated by the partnership of Woods, Stacker, and Company.

From 1837 until his death in 1859, Samuel resided in Stewart County. He built this imposing Greek Revival style house around 1856. Stewart County contains few residences that are as detailed as this one. One other house

See continuation sheet

United States Department of the Interior
National Park Service

National Register of Historic Places Continuation Sheet

Section number 8 Page 2

Stacker, Samuel, House

built for an ironmaster is in Stewart County. It is similar in scale but not in materials or design. (See Henry Hollister House.)

When Stacker died in 1859 his estate was valued at \$60,000.00, a sizable amount for this time. He is buried near the Lafayette Furnace (49MT372) in Montgomery County.

United States Department of the Interior
National Park Service

National Register of Historic Places Continuation Sheet

Section number 10 Page 2

Stacker, Samuel, House

Verbal Boundary Description

Beginning at a point approximately 250 feet south of the intersection of Long Creek Road and the creek, the boundary moves east approximately 1100 feet; the boundary moves north approximately 1100 feet; the boundary then moves west approximately 950 feet to the east side of the road and finally moves south approximately 1100 feet to the point of the beginning.

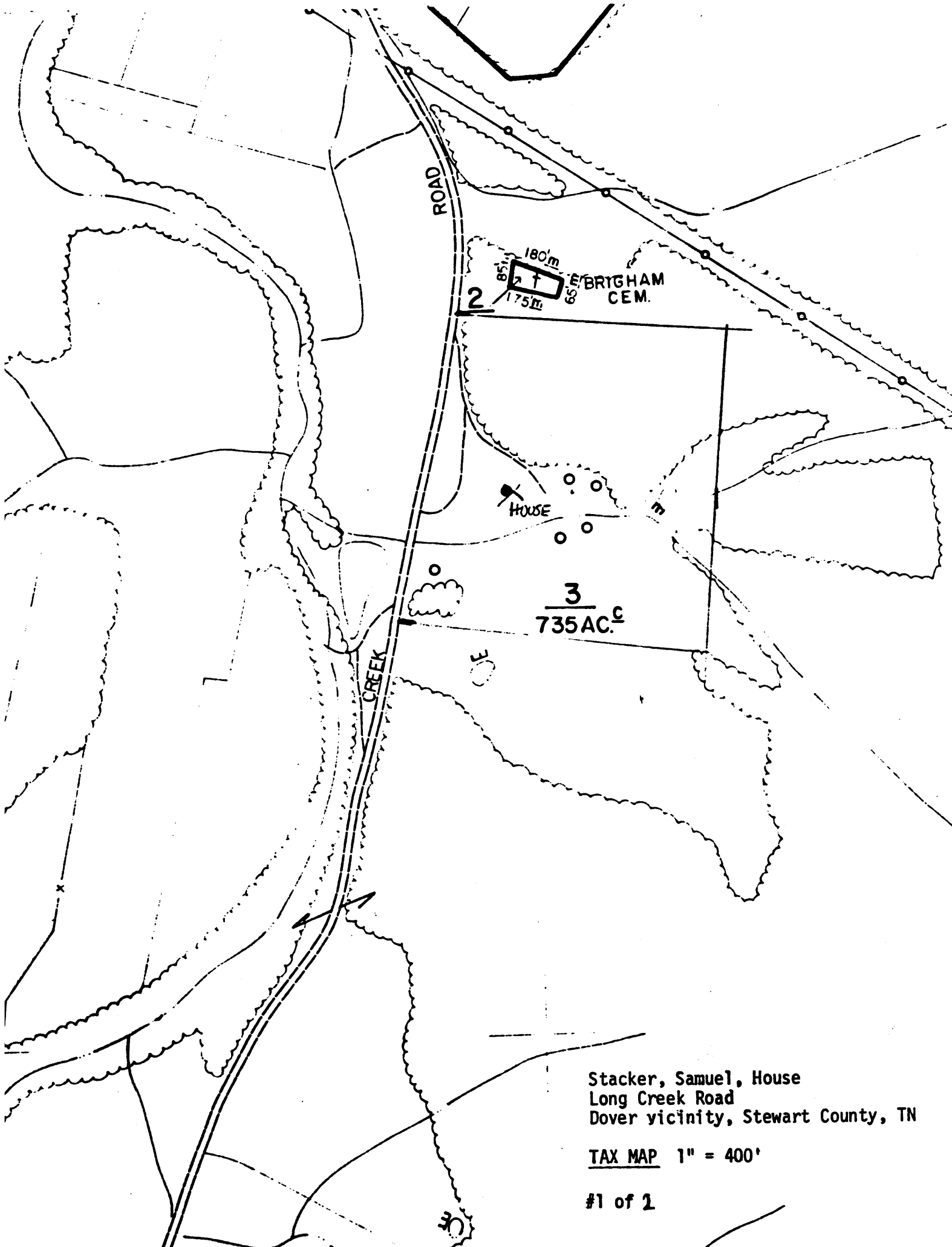

Stacker, Samuel, House
Long Creek Road
Dover vicinity, Stewart County, TN

TAX MAP 1" = 400'

#1 of 2

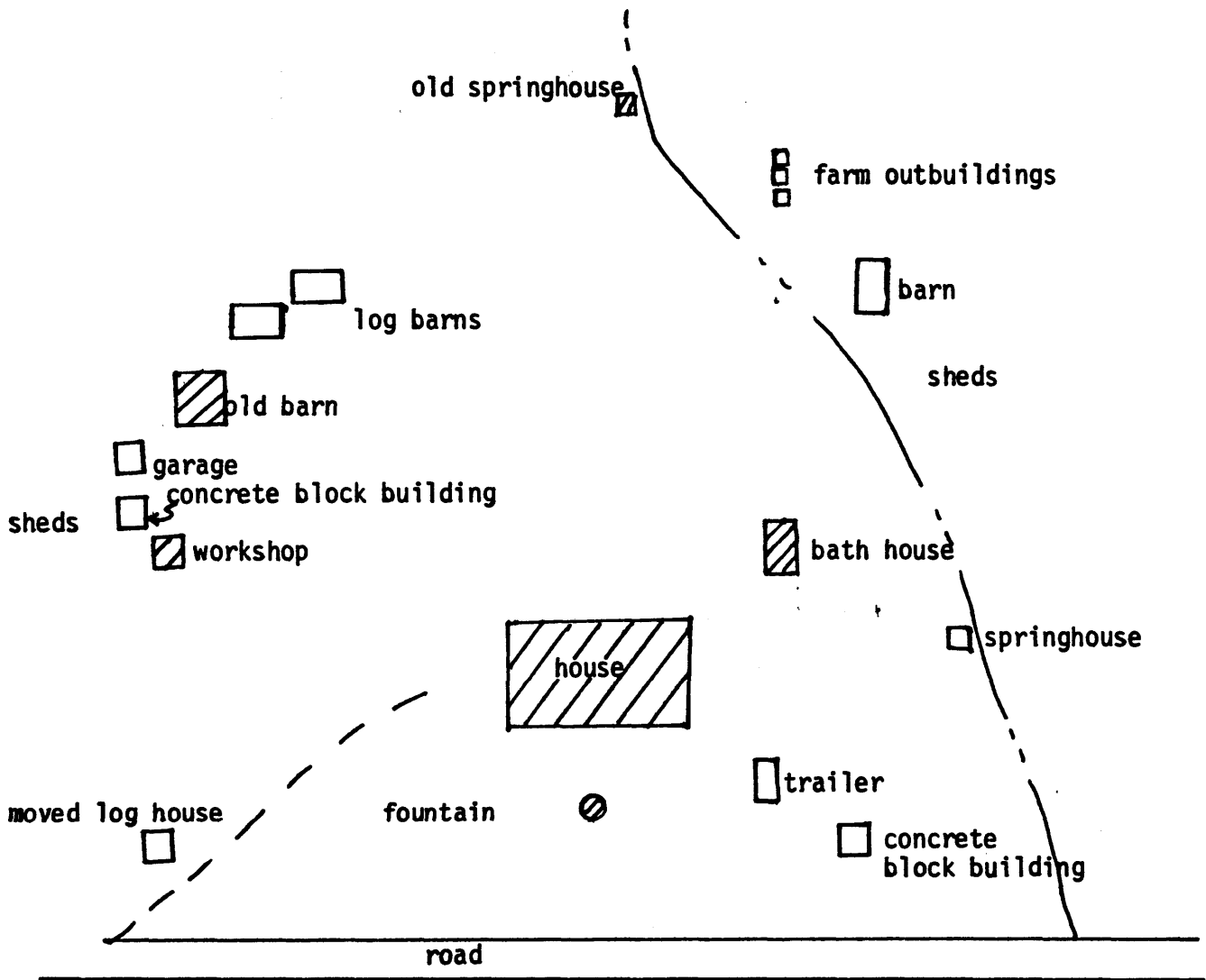

Stacker, Samuel, House
 Long Creek Road
 Dover vicinity, Stewart County, TN

Sketch map not to scale

 contributing

 non-contributing

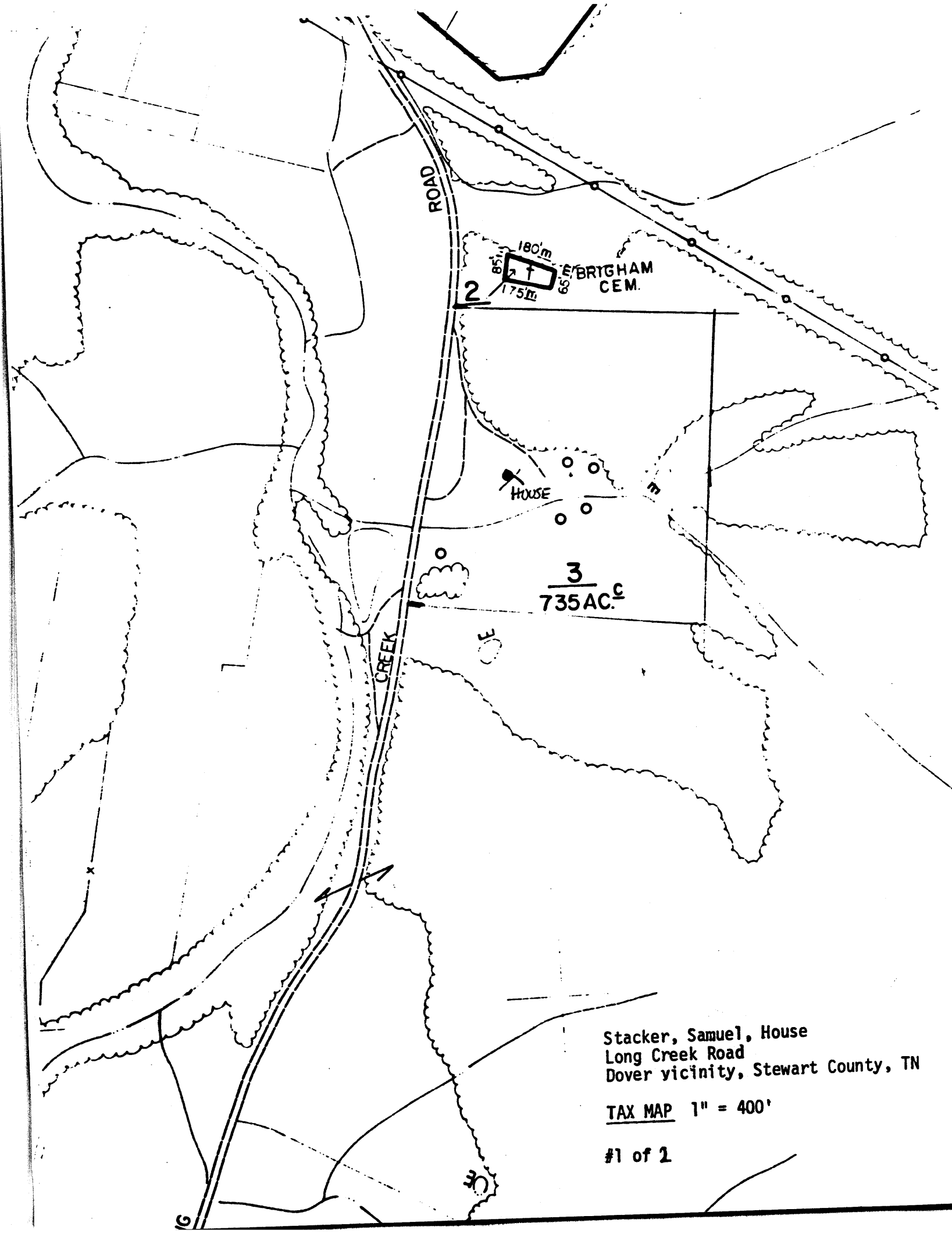

Stacker, Samuel, House
Long Creek Road
Dover vicinity, Stewart County, TN

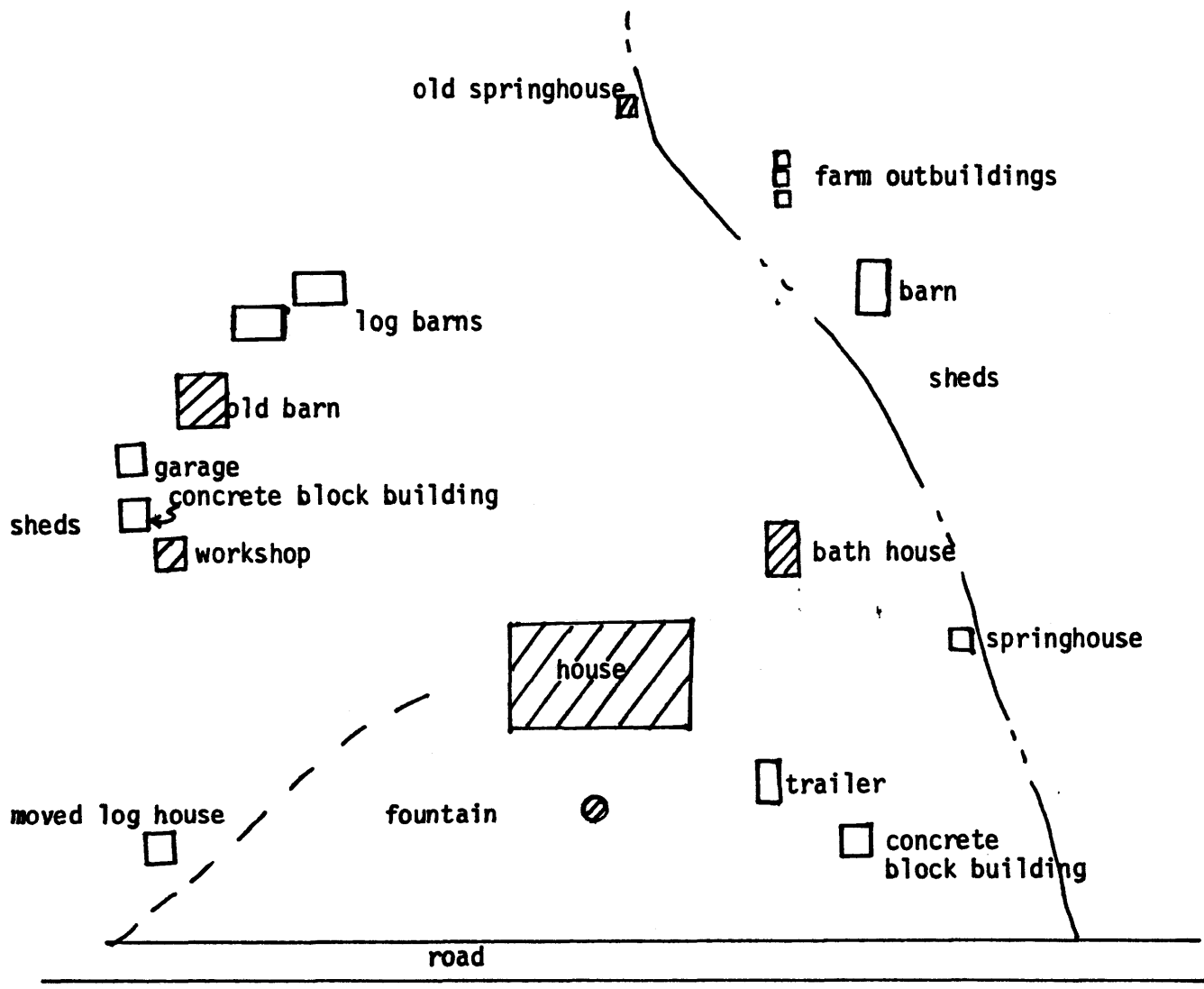

TAX MAP 1" = 400'

#1 of 2



Stacker, Samuel, House
 Long Creek Road
 Dover vicinity, Stewart County, TN

Sketch map not to scale

-  contributing
 -  non-contributing
- 2 of 2