

KENTUCKY HISTORIC RESOURCES INVENTORY

Site No. Tm-B-29

1. Historic Name(s) Original Owner		22. ADD County No. Ky. /Trimble <input type="text" value="1"/> <input type="text" value="1"/> <input type="text" value="2"/>	
2. Present Name <i>Coleman House</i>		23. U.S.G.S. Quadrant (15' / 75') Bedford <input type="text" value=""/> <input type="text" value=""/> <input type="text" value=""/>	
3. Location Main Street <i>Bedford</i>		24. UTM Reference <input type="text" value="1"/> <input type="text" value="6"/> <input type="text" value="6"/> <input type="text" value="4"/> <input type="text" value="6"/> <input type="text" value="4"/> <input type="text" value="2"/> <input type="text" value="0"/> <input type="text" value="4"/> <input type="text" value="2"/> <input type="text" value="7"/> <input type="text" value="2"/> <input type="text" value="5"/> <input type="text" value="0"/> <input type="text" value="0"/> <input type="text" value="0"/>	
4. Owner's Name Mrs. Helen M. Moore		25. Coordinate Accuracy <input type="checkbox"/>	
5. Owner's Address Route 3, Bedford, Kentucky		26. Prehistoric Site Object Historic Site Structure (Building) Other	
6. Open to Public Yes <input type="checkbox"/> No <input checked="" type="checkbox"/>	7. Visible from road Yes <input checked="" type="checkbox"/> No <input type="checkbox"/>	8. Ownership Private <input checked="" type="checkbox"/> Local <input type="checkbox"/> State <input type="checkbox"/> Federal <input type="checkbox"/>	
9. Local Contact/Organization		27. National Register District Name: Historic Resources of Trimble County <input type="text" value=""/> <input type="text" value=""/>	
10. Site Plan with North Arrow		28. Significance Evaluation National Register <input type="checkbox"/>	
11. Architect		29. Status <input type="checkbox"/> Date	
12. Builder		National Landmark <input type="checkbox"/>	
13. Date ca. 1810-1825 A. <input checked="" type="checkbox"/> B. <input type="checkbox"/>		National Register <input type="checkbox"/>	
14. Style A. Federal <input checked="" type="checkbox"/> B. <input type="checkbox"/>		Landmark Certificate <input type="checkbox"/>	
15. Original Use Dwelling <input checked="" type="checkbox"/>		Kentucky Survey <input type="checkbox"/>	
16. Present use Dwelling		Local Landmark <input type="checkbox"/>	
17. Condition Excellent <input checked="" type="checkbox"/>		HABS HAER <input type="checkbox"/>	
18. Description Situating on the outskirts of Bedford is a significant Federal style dwelling. The brick building consists of a one-and-one-half story recessed central block with one-story twin projecting pavilions and a one-story brick ell on the central block. A one-story brick addition on the rear of the central block and connecting with the ell completes the structure. <i>Flemish bond</i> <small>(Continue on Back)</small>		30. Historic Theme Primary Architecture <input checked="" type="checkbox"/> Secondary <input type="checkbox"/> Other <input type="checkbox"/>	
19. History		31. Endangered Yes <input type="checkbox"/> No <input checked="" type="checkbox"/>	
20. Significance The most outstanding example of a Federal style dwelling in Bedford, as well as the county.		32. Preservation Project Status <input type="checkbox"/> Actual Cost in \$1,000s <input type="text" value=""/>	
21. Source of Information		33. ATTACH PHOTO 	
		Roll No. <u>56</u> Picture No. <u>1 - 28</u> Direction _____	
		34. Prepared by: William Gus Johnson Sr. Historian & Photographer	
		35. Organization Kentucky Heritage Council	
		36. Date <u>Fall 1982</u>	
		37. Revision Dates 38. Staff Review	

18. brickwork enhances the facade, while the remainder is done in common bond with a row of headers every seven or nine rows. Fenestration consists of seven bays with a central entrance with a transom now enclosed. A one-story, three-bay pedimented portico embellished with shingling and pierced by a single 2/2 pane window, which replaced the original fanlight window, accentuates the facade. Six Doric Order columns support the portico. Facade windows are 9/6 pane with jackarches and wooden sills. A corbeled cornice accents the facade and rear of the central block, while each wing has a boxed cornice. The central block has interior gable-end chimneys with two 2/2 pane gable windows at each end, and the twin projecting pavilions and the ell also have interior gable-end chimneys. Square windows of 6/6 pane with wooden sills pierce the ell. Each side of the central block is punctured by two bays consisting of a door with a transom now enclosed and a 9/9 pane window with wooden sills and enhanced by one-story, two-bay open porches.

A corbeled cornice accents the ell. Each wing is accentuated by a brick pilaster. A limestone foundation supports the building. A one-story frame coal shed and a one and one-half story frame barn with log joists are dependencies of the dwelling.

KENTUCKY HISTORIC RESOURCE INVENTORY SUPPLEMENT
BOUNDARY AND LOCATION INFORMATION

Historic Property Name Coleman House Site # Tm-B-29

Multiple Resource/Thematic Nomination Title Historic Resources of Trimble County

U.T.M. Coordinates - List multiple UTM's if property is ten or more acres.

A. 16 646420 4272500 D. _____

B. _____ E. _____

C. _____ F. _____

Verbal Boundary Description Acres two

Beginning at the intersection of Ball Lane and U.S. 42 proceed 400' in a westward direction; thence 200' in a southward direction; thence 400' in an eastward direction; thence 200' in a northward direction to the point of origin. The boundary is drawn to include the house and outbuildings.

Sketch of Site Plan (Showing outbuildings, structures, landscape features and the site boundary as described above.)

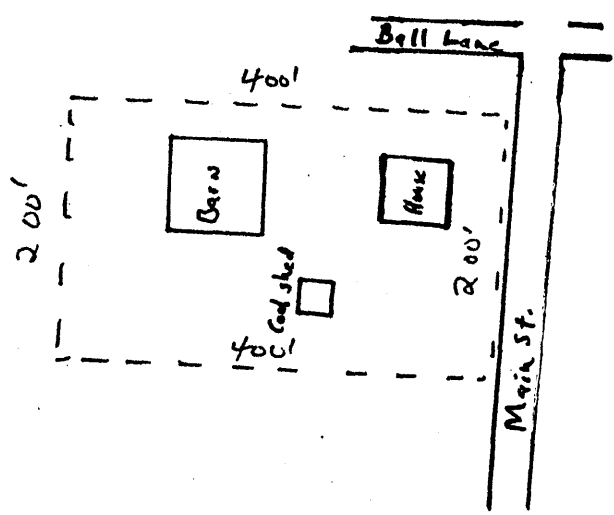

Not to Scale

Official Courthouse Property Reference: