

THEMATIC NATIONAL REGISTER NOMINATION - GEORGIA COURTHOUSES

ARCHITECTURAL SURVEY FORM

TWIGGS COUNTY COURTHOUSE

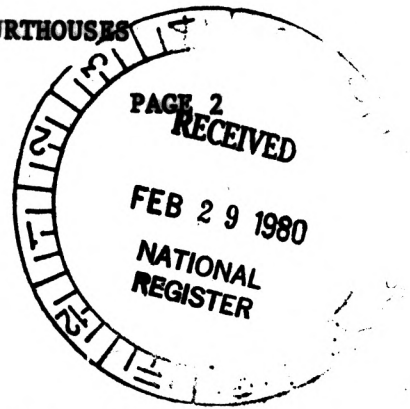

SIGNIFICANCE:

See general statement of significance about the architect, J. W. Golucke.

This plan is similar to those used by Golucke in Clayton and Madison counties.



SEP 18 1980

TWIGGS COUNTY COURTHOUSE

MAILING ADDRESS:

Chairman  
Board of County Commissioners  
Twiggs County Courthouse  
Courthouse Square  
Jeffersonville, Georgia 31044

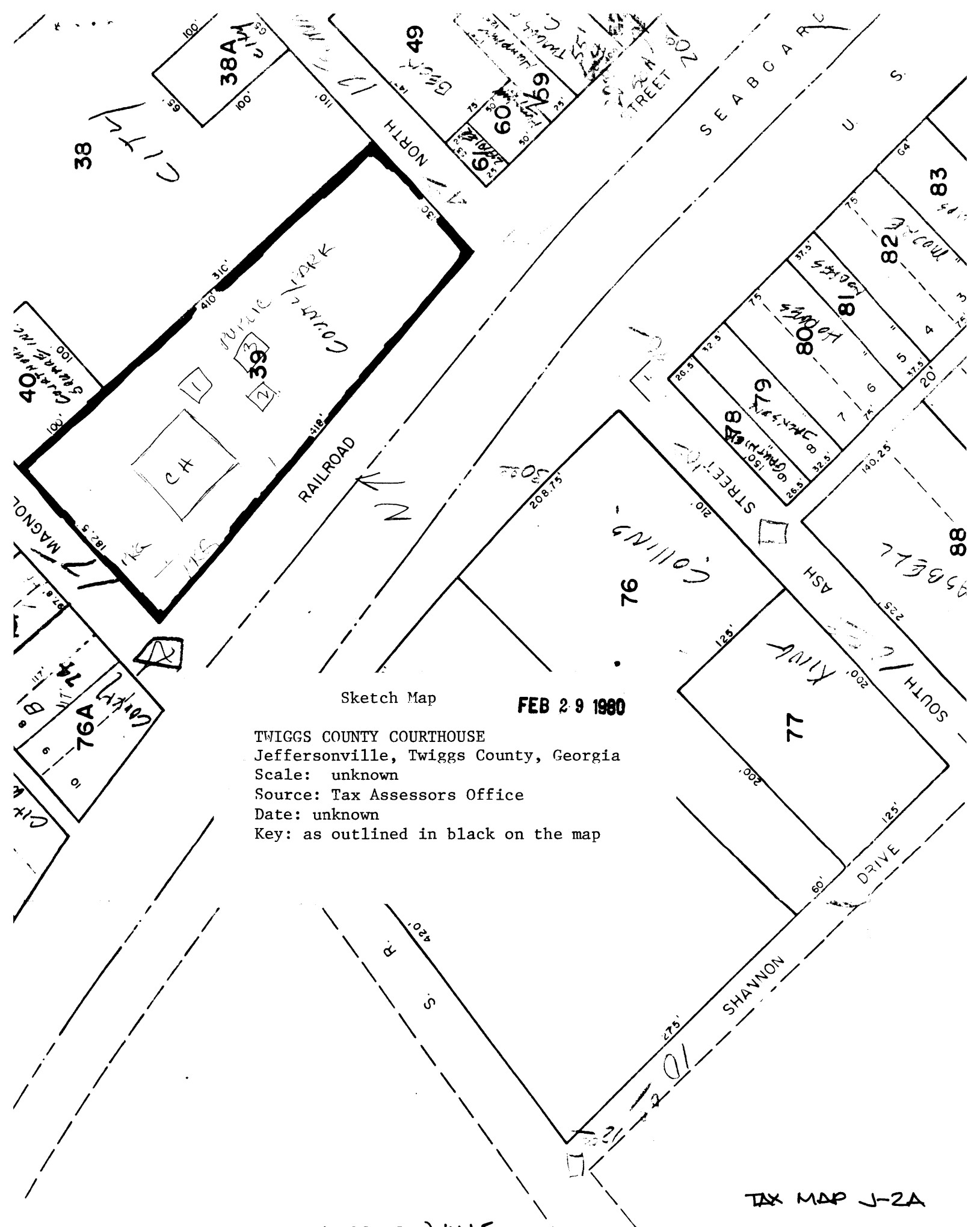

Sketch Map

FEB 29 1980

TWIGGS COUNTY COURTHOUSE  
 Jeffersonville, Twigg County, Georgia  
 Scale: unknown  
 Source: Tax Assessors Office  
 Date: unknown  
 Key: as outlined in black on the map

TAX MAP J-2A

JEFFERSONVILLE  
 TWIGGS CO.