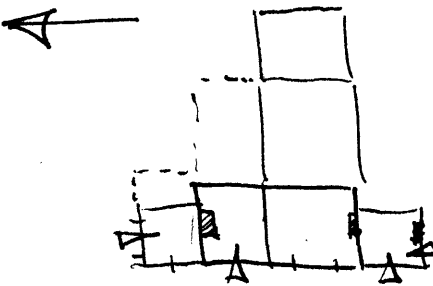

1. Historic Name (s) Young house		22. ADD/County Bluegrass/Jessamine	
Original Owner Dr. Brown Young		23. Zoning Classification Magisterial District	
Present Name (Blank)		24. U.S.G. S. Quadrant (15'/75') Keene	
3. Owner's Name Dr. Glenn Dorroh		25. UTM Reference Zone: 16 Easting: 707400 Northing: 4195360	
4. Owner's Address 301 Clinton Road, Lexington		26. Prehistoric Site Historic Site: Building	
5. Location E. side KY 29; 1/4 mi. S. of US 68 intersection		27. District Name: (Blank)	
6. Open to Public Yes <input type="checkbox"/> No <input checked="" type="checkbox"/>	7. Visible from road Yes <input checked="" type="checkbox"/> No <input type="checkbox"/>	8. Ownership Private <input checked="" type="checkbox"/> Local <input type="checkbox"/> State <input type="checkbox"/> Federal <input type="checkbox"/>	
9. Local Contact/Organization (Blank)		28. Significance Evaluation National Register	
10. Site Plan with North Arrow 		11. Architect (Blank)	
		12. Builder (Blank)	
		13. Date mid- 19th century	
		14. Style Italianate	
		15. Original Use house	
		16. Present Use house	
		17. Condition Interior good Exterior good	
Smoke House See Attached Sheet		29. Status National Landmark <input type="checkbox"/> National Register <input type="checkbox"/> Landmark Certificate <input type="checkbox"/> Kentucky Survey <input type="checkbox"/> Local Landmark <input type="checkbox"/> HABS/HAER <input type="checkbox"/>	
18. Description 3-bay, 2-story brick; asymmetrical facade with one story wings off each side; round-arched windows; brackets decorate the cornice; the 2-story porch across front replaces original 1-story porch; the wing on right was used as a doctor's office originally. The Brown house is the only illustration in the county of picturesque (Italianate) styling applied to classical three-part massing. For related 3-part compositions, see Js-19, -38, -71, -109, -111, -175, -N-12.		30. Theme Primary: <u>architecture</u> Secondary: _____ Other: _____	
19. History Brown Young's father John was a Revolutionary War soldier and his son was the historian Col. Bennett H. Young.		31. Endangered Yes <input type="checkbox"/> No <input checked="" type="checkbox"/>	
20. Significance With the exception of the replacement of the entrance porch, the house is especially well preserved. The Brown house is one of the best examples in the county of Italianate style.		32. ATTACH PHOTO	
21. Source of Information 1877 atlas - Dr. B. Young		Roll No. 25 and 54 Picture No. _____ Direction _____	
		33. Tape No. _____ Negative No. _____	
		34. Prepared by: NCP-KTG	
		35. Organization KHC	
		36. Date summer 1977	
		37. Revision Dates _____ 38. Staff Review _____	

NOV 5 1980

KENTUCKY HISTORIC RESOURCE INVENTORY SUPPLEMENT
BOUNDARY AND LOCATION INFORMATION

Historic Property Name Young house Site # JK108
Multiple Resource/Thematic Nomination Title Jessamine Co.

U.T.M. Coordinates - List multiple UTM's if property is ten or more acres.

A. 16 707 500 4194 900 D. 16 707 670 4195 330
B. 16 706 980 4194 950 E. _____
C. 16 707 470 4195 740 F. _____

Verbal Boundary Description _____ Acreage ca 70 acres

House included within A-B-C-D as shown.
B-C is on Straker Lane; C-D is on Ky 69; D-A
partially borders a woods.

Sketch of Site Plan (Showing outbuildings, structures, landscape features and the site boundary as described above.)

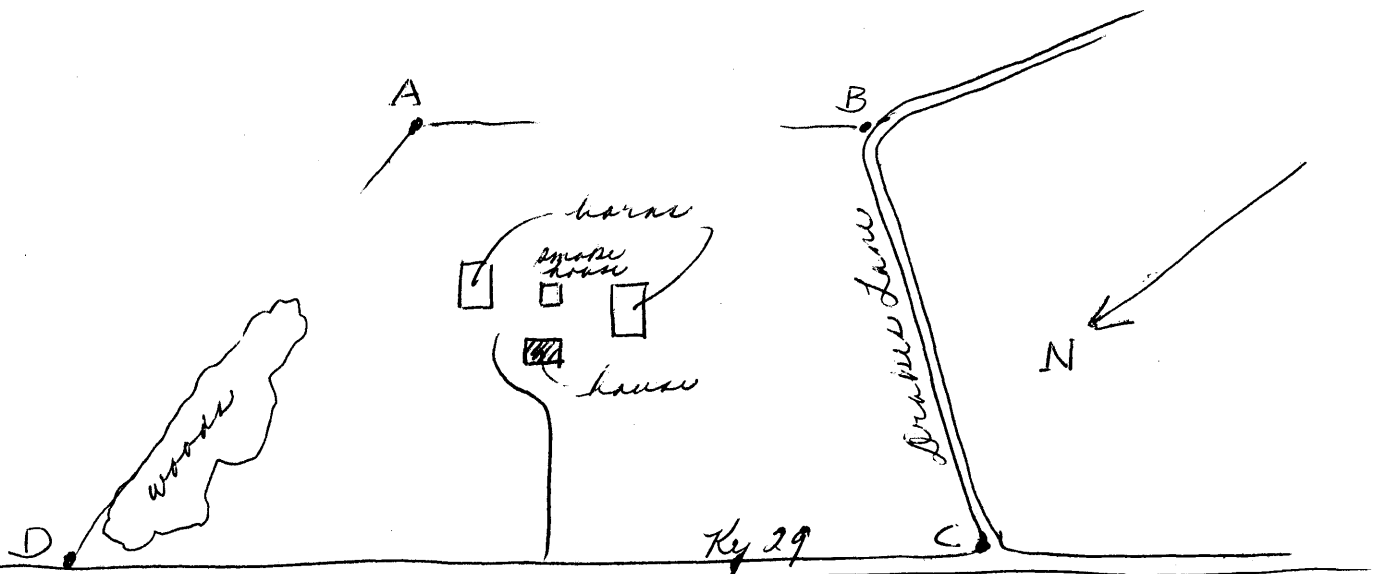

Official Courthouse Property Reference:

76568