

420210

449610

116

I. UTM References

HAER

HABS

NR

NHL

H.

STRUCTURE

SITE

STATE OF INDIANA  
DEPARTMENT OF NATURAL RESOURCES  
INDIANA HISTORIC SITES AND STRUCTURES INVENTORY

RIVERSIDE DR.

1. HISTORIC NAME McCurdy Hotel  
 2. OWNERSHIP: PUBLIC  PRIVATE   
 NAME MEDCO INC.  
Green Construction, Inc.  
 ADDRESS 405 CARPENTER ST  
 3. LOCATION NOTES OP. 41-42, 7-8  
 4. VISIBLE FROM PUBLIC RIGHT OF WAY:  YES  NO (20-5-3)

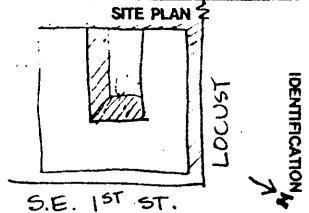

5. USE PRESENT PAST 6. CATEGORY 8. ENDANGERED  
 Residential (sing.)   DISTRICT  NO  
 Residential (mult.)    BUILDING(S) YES/BY WHAT  
 Commerce   STRUCTURE  
 Industrial   SITE  
 Agriculture   OBJECT  
 Transportation    
 Organization    
 Military    
 Political    
 Unknown   7. ACCESSIBLE 9. DATE 1916-  
 Vacant    YES/RESTRICTED 10. ARCHITECT/BUILDER  
 Other HOTEL  YES/UNRESTRICTED  NO 1917

11. PERIODS: PREHISTORIC 17TH/18TH CEN. 1800-1860 1861-1899  1900-PRESENT

12. AREAS OF SIGNIFICANCE  
 Archaeology-Prehistoric Conservation Law Sculpture  
 Archaeology-Historic Economics Literature Social/Humanitarian  
 Agriculture Education Military Theater  
 Architecture Engineering Music Transportation  
 Art Exploration/Settlement Philosophy  Other (Specify)  
 Commerce Industry Politics/Government HOTEL  
 Communications Invention Religion  
 Community Planning Landscape Architecture Science

12. STYLE 14. CONDITION 16. SITE INTEGRITY  
 Federal EXCELLENT  ORIGINAL SITE  
 Greek Revival  GOOD MOVED DATE  
 Gothic Revival FAIR  
 Italianate DETERIORATED  
 Second Empire RUINS  
 Stick Style/Eastlake UNEXPOSED  
 Queen Anne  
 Romanesque Revival  
 Colonial Revival  
 Neo-Classical  
 Bungalow  
 Vernacular  
 Other (Specify)  
 15. ALTERATIONS 18. IN ESTABLISHED HISTORIC DISTRICT  
 UNALTERED  NO  
 MINOR YES/NAME  
 MAJOR

17. OUTBUILDINGS/SECONDARY STRUCTURES  
 NO  
 YES  
 19. DESCRIPTION OF ENVIRONMENT (NATURAL AND MAN-MADE) ADJACENT TO RIVERSIDE HISTORIC DISTRICT AND DOWNTOWN. OCCUPIES PROMINENT SPOT NEAR RIVERFRONT. NOW A SENIOR CITIZENS RESIDENTIAL CENTER RUN BY MEDCO.

20. INFORMATION SOURCES TOWNSHIP ASSESSOR, CITY DIRECTORIES

1916-17 Newspapers  
 21. PREPARED BY N. LONG/W.M. GUMBERTS 22. DATE 10/27/77



6.  
7.  
8.  
9.  
10.  
11.  
12. HISTORIC SIGNIFICANCE: USED TO BE A PROMINENT HOTEL.  
13.  
14. ARCHITECTURAL SIGNIFICANCE: FIRST FLOOR ALTERED + HAS LARGE MARQUEES, BUT ENGAGED STONE PIERS REMAIN. EIGHT STORIES U-SHAPED HIGH AND BASICALLY SQUARE IN PLAN, IT IS OF TEXTURED RED BRICK IN STRETCHER BOND WITH PINK MORTAR, AND LIMESTONE TRIM. STONE BELT COURSE ABOVE 1<sup>ST</sup>, 2<sup>ND</sup>, 7<sup>TH</sup> AND 8<sup>TH</sup> FLOORS. MASSIVE BRACKETED CORNICE. SECOND FLOOR WINDOWS FRAMED IN STONE W/ KEYSTONE FORMS. STONE BALUSTRADED FALSE BALCONY OVER ENTRANCE AT 2<sup>ND</sup> + 3<sup>RD</sup> FLOOR LEVELS. SOME WINDOWS HAVE STONE TABS ON SIDE FACING RIVER, PLAN IS U-SHAPED ABOVE 1<sup>ST</sup> TWO FLOORS. ONE-STORY STONE MASSIVE PORCH, PART OF IT ENCLOSED, FORMS ENTRANCE. HAS GREEN CANVAS ANNING AND BALUSTRADED ROOF LINE. BALCONY FORMS APPEAR ON ONE SIDE, FIRE STAIRS ON THE OTHER. OVAL FORMS APPEAR ABOVE STONE BRACKETS OF CORNICE, APPARENTLY METAL. PARKING LOT BETWEEN HOTEL AND RIVERSIDE DRIVE.  
29.  
30. The former McCurdy Hotel was designed by H. Ziegler Dietz. It is now a residential hotel run by Medco, Inc., a health nursing concern. The Caldwell-Marshall Company of (Indianapolis? or St. Louis?) erected the building for the Van Orman Hotel Company, a corporation controlled by Fred Van Orman, George Caldwell, Clinton Marshall and F. Harold Van Orman. (See also Downtown Evansville guide book.)

1

**STATE OF INDIANA  
DEPARTMENT OF NATURAL RESOURCES  
INDIANA HISTORIC SITES AND STRUCTURES INVENTORY**

---

Additional Architectural Information

A. NAME McCurdy Hotel C. NUMBER 82-196-0179

B. ADDRESS 101-111 SE First Street

D. UTM References 16 449610 4202310

E. Construction of this Colonial Revival landmark was an event linked to the completion of the Soldiers and Sailors Memorial Coliseum. Both buildings were ready for occupancy in 1917; the Coliseum as the city's first major public gathering place and the McCurdy as "convention headquarters in Evansville." St. Louis architect H. Ziegler Dietz drew up the plans for the hotel, and the building soon became part of the system of hotels managed by the Van Orman family. The McCurdy was one of three large pre-Depression hotels erected in the Downtown; the Hotel Sonntag remains, and the Hotel Vendome is long-gone. The McCurdy replaced another hotel on the site, the St. George, which was not more than a generation old when razed.

---

F. INFORMATION SOURCES Evansville Courier, 4 October 1915 - 26 June 1917.  
Wesley Index of Architectural Plans. Evansville City Directories.

---

---

G. PREPARED BY Douglas L. Stern H. DATE 23 November 1981

---