

UNITED STATES DEPARTMENT OF THE INTERIOR
NATIONAL PARK SERVICE

FOR NPS USE ONLY
RECEIVED MAR 30 1982
DATE ENTERED MAY 13 1982

NATIONAL REGISTER OF HISTORIC PLACES
INVENTORY -- NOMINATION FORM

SEE INSTRUCTIONS IN HOW TO COMPLETE NATIONAL REGISTER FORMS
TYPE ALL ENTRIES -- COMPLETE APPLICABLE SECTIONS

1 NAME

HISTORIC

Thomas I. Agnew House

AND/OR COMMON

Agnew Mansion

2 LOCATION

STREET & NUMBER Pkwy.
Memorial Parkway

N/A NOT FOR PUBLICATION

CITY, TOWN

New Brunswick

N/A VICINITY OF

CONGRESSIONAL DISTRICT

15th

STATE

New Jersey

CODE

034

COUNTY

Middlesex

CODE

023

3 CLASSIFICATION

CATEGORY

- DISTRICT
- BUILDING(S)
- STRUCTURE
- SITE
- OBJECT

OWNERSHIP

- PUBLIC
- PRIVATE
- BOTH
- PUBLIC ACQUISITION**
- IN PROCESS
- BEING CONSIDERED

N/A

STATUS

- OCCUPIED
- UNOCCUPIED
- WORK IN PROGRESS
- ACCESSIBLE**
- YES: RESTRICTED
- YES: UNRESTRICTED
- NO

PRESENT USE

- AGRICULTURE
- MUSEUM
- COMMERCIAL
- PARK
- EDUCATIONAL
- PRIVATE RESIDENCE
- ENTERTAINMENT
- RELIGIOUS
- GOVERNMENT
- SCIENTIFIC
- INDUSTRIAL
- TRANSPORTATION
- MILITARY
- OTHER:

4 OWNER OF PROPERTY

NAME

L. Babiak

STREET & NUMBER

2 Crest Road

CITY, TOWN

New Brunswick

N/A VICINITY OF

STATE

New Jersey

5 LOCATION OF LEGAL DESCRIPTION

COURTHOUSE,
REGISTRY OF DEEDS, ETC.

Office of the County Clerk

STREET & NUMBER

Kennedy Square, Box 1110

CITY, TOWN

New Brunswick

STATE

New Jersey

6 REPRESENTATION IN EXISTING SURVEYS

TITLE

New Jersey Historic Sites Inventory - New Brunswick, 1980

DATE

1979-80

FEDERAL STATE COUNTY LOCAL

DEPOSITORY FOR
SURVEY RECORDS

New Jersey Office of Cultural & Environmental Services

CITY, TOWN

Trenton

STATE

New Jersey

7 DESCRIPTION

CONDITION

EXCELLENT
 GOOD
 FAIR

DETERIORATED
 RUINS
 UNEXPOSED

CHECK ONE

UNALTERED
 ALTERED

CHECK ONE

ORIGINAL SITE
 MOVED DATE _____

DESCRIBE THE PRESENT AND ORIGINAL (IF KNOWN) PHYSICAL APPEARANCE

The Agnew Mansion, located on Memorial Parkway east of the downtown area of New Brunswick, is one of two surviving examples of Greek Revival residences in the city.

Constructed in a classic Greek Revival mode, the house is rectangular in plan with a projecting pedimented tetrastyle Doric portico across the full width of the main (north) facade. The main block is three bays wide, three bays deep, and two stories high. The roof is broadly gabled, as befits the style, with the gable end toward the street.

Windows on the first floor of the main facade are 6/6 and are flanked by 2/2 sidelights, separated from the central window by heavy mullions. A full entablature controls the entire window unit. Knee-high second floor windows are 3/3 and are devoid of ornament.

The walls are finished in stucco, resulting in planar, two-dimensional surfaces in imitation of Greek antecedents. The entry, in the center of the main facade, is the focal point of the facade. It is taller than its flanking windows and contains 3/4-length sidelights and a finely leaded rectangular transom. The transom bar is ornamented in a Greek key motif and the door itself is 8-panelled. Surmounting this assemblage is a full entablature, plain except for a dentil course at the top of the architrave.

The portico is the most distinctive feature of the house. Fluted columns with entasis support a full entablature that repeats the detailing seen over the door: plain elements broken only by a row of dentils above the architrave. Where the portico meets the house it rests on unfluted pilasters; the architrave and frieze terminate at this point but the cornice continues around the house. The pediment is infilled with a broad expanse of flush boards. The portico covers a full width porch without railings which is reached by a flight of seven wooden steps.

Boundary Justification

The house stands on a lot on the edge of a housing development that extends southerly to Clifton Avenue. Outbuildings clearly associated with the property during its use as a farm have survived, either on the nominated property or on intrusional adjoining properties. For convenience, the current lot lines of the Agnew House property are used in this nomination.

8 SIGNIFICANCE

PERIOD	AREAS OF SIGNIFICANCE -- CHECK AND JUSTIFY BELOW			
<input type="checkbox"/> PREHISTORIC	<input type="checkbox"/> ARCHEOLOGY-PREHISTORIC	<input type="checkbox"/> COMMUNITY PLANNING	<input type="checkbox"/> LANDSCAPE ARCHITECTURE	<input type="checkbox"/> RELIGION
<input type="checkbox"/> 1400-1499	<input type="checkbox"/> ARCHEOLOGY-HISTORIC	<input type="checkbox"/> CONSERVATION	<input type="checkbox"/> LAW	<input type="checkbox"/> SCIENCE
<input type="checkbox"/> 1500-1599	<input type="checkbox"/> AGRICULTURE	<input type="checkbox"/> ECONOMICS	<input type="checkbox"/> LITERATURE	<input type="checkbox"/> SCULPTURE
<input type="checkbox"/> 1600-1699	<input checked="" type="checkbox"/> ARCHITECTURE	<input type="checkbox"/> EDUCATION	<input type="checkbox"/> MILITARY	<input type="checkbox"/> SOCIAL/HUMANITARIAN
<input type="checkbox"/> 1700-1799	<input type="checkbox"/> ART	<input type="checkbox"/> ENGINEERING	<input type="checkbox"/> MUSIC	<input type="checkbox"/> THEATER
<input checked="" type="checkbox"/> 1800-1899	<input type="checkbox"/> COMMERCE	<input type="checkbox"/> EXPLORATION/SETTLEMENT	<input type="checkbox"/> PHILOSOPHY	<input type="checkbox"/> TRANSPORTATION
<input type="checkbox"/> 1900-	<input type="checkbox"/> COMMUNICATIONS	<input type="checkbox"/> INDUSTRY	<input type="checkbox"/> POLITICS/GOVERNMENT	<input type="checkbox"/> OTHER (SPECIFY)
		<input type="checkbox"/> INVENTION		

SPECIFIC DATES

1844

BUILDER/ARCHITECT

UNKNOWN

STATEMENT OF SIGNIFICANCE

The "Agnew mansion", as this house is known, is a fine example, rare in New Jersey, of a house in the Greek Revival temple form. Although the names of the builder and/or architect are unknown, its design and handling of details suggest a practiced hand, either on site or through a pattern book. In 1835, Thomas I. Agnew, a farmer, bought, for \$750., a 2-acre lot of land situated (until 1860) within North Brunswick Township, on the southwesterly side of the "New Road to Cool Spring" (Memorial Parkway, formerly Burnet Street).¹ In 1844, he mortgaged this small lot for \$6,000, and this mortgage, together with the high Grecian style of the present house, strongly suggest 1844 as a plausible construction date for it. Agnew, however, became a California "Forty-Niner," and died in San Francisco in 1851, after which his son and administrator, Andrew Agnew, inherited the property.² This 2-acre lot on which the house stands was called lot #7; it was one of seven similar, adjoining 2-acre lots on the southerly side of the road. Thomas also owned lots 2,3, and 4, and these seem to have descended to Andrew as well. The title history is somewhat confused, however, by the fact that another Andrew Agnew, perhaps Thomas' brother, owned lots 5 and 6, between Thomas' holdings, and a 7-acre lot behind them. The latter Andrew died during the 1860's, and in 1871 the surviving Andrew Thomas, thereby assembled a 19-acre tract of land with the house standing near the easterly corner. Andrew died in 1888, whereupon the house descended to his nephew Agnew Randolph.³ Randolph held the property until 1899, and it was sold out of the family in 1903.⁴

1. Middlesex County Deeds, Lib. 39, p. 558ff.
2. New Jersey State Library, Middlesex County Wills, 12751L; also Deeds, Lib. 76, pp. 307ff.
3. Deeds, Lib. 311, pp. 585ff.
4. Ibid., Lib. 344, pp. 580ff.

9 MAJOR BIBLIOGRAPHICAL REFERENCES

Listokin, Barbara Cyviner, The Architectural History of New Brunswick, New Jersey, 1681-1900. New Brunswick: Rutgers University Art Gallery, 1976.

10 GEOGRAPHICAL DATA 1 **UTM NOT VERIFIED** **ACREAGE NOT VERIFIED**

ACREAGE OF NOMINATED PROPERTY _____
 QUADRANGLE NAME New Brunswick, NJ QUADRANGLE SCALE 1:24,000

UTM REFERENCES

A	<u>1, 8</u>	<u>5, 4, 9, 1, 3, 0</u>	<u>4, 4, 8, 1, 4, 5, 0</u>	B			
	ZONE	EASTING	NORTHING		ZONE	EASTING	NORTHING
C				D			
E				F			
G				H			

VERBAL BOUNDARY DESCRIPTION

Block 723, Lot 23-1, New Brunswick Tax Map

LIST ALL STATES AND COUNTIES FOR PROPERTIES OVERLAPPING STATE OR COUNTY BOUNDARIES

STATE	CODE	COUNTY	CODE
<u>N/A</u>			
STATE	CODE	COUNTY	CODE

11 FORM PREPARED BY

NAME / TITLE

Robert Craig, Historian

ORGANIZATION

Heritage Studies, Inc.

DATE

May 7, 1980

STREET & NUMBER

R.D. 4, Box 864, Mapleton Road

TELEPHONE

(609) 452-1754

CITY OR TOWN

Princeton

STATE

New Jersey

12 STATE HISTORIC PRESERVATION OFFICER CERTIFICATION

THE EVALUATED SIGNIFICANCE OF THIS PROPERTY WITHIN THE STATE IS:

NATIONAL STATE LOCAL

As the designated State Historic Preservation Officer for the National Historic Preservation Act of 1966 (Public Law 89-665), I hereby nominate this property for inclusion in the National Register and certify that it has been evaluated according to the criteria and procedures set forth by the National Park Service.

Deputy

STATE HISTORIC PRESERVATION OFFICER SIGNATURE

Laura Schmidt

4/21/81

TITLE

DATE

FOR NPS USE ONLY

I HEREBY CERTIFY THAT THIS PROPERTY IS INCLUDED IN THE NATIONAL REGISTER

DATE

5/13/82

KEEPER OF THE NATIONAL REGISTER

ATTEST:

DATE

CHIEF OF REGISTRATION

THOMAS I AGNEW HOUSE

site plan sketch

B. Craig 10/21/80

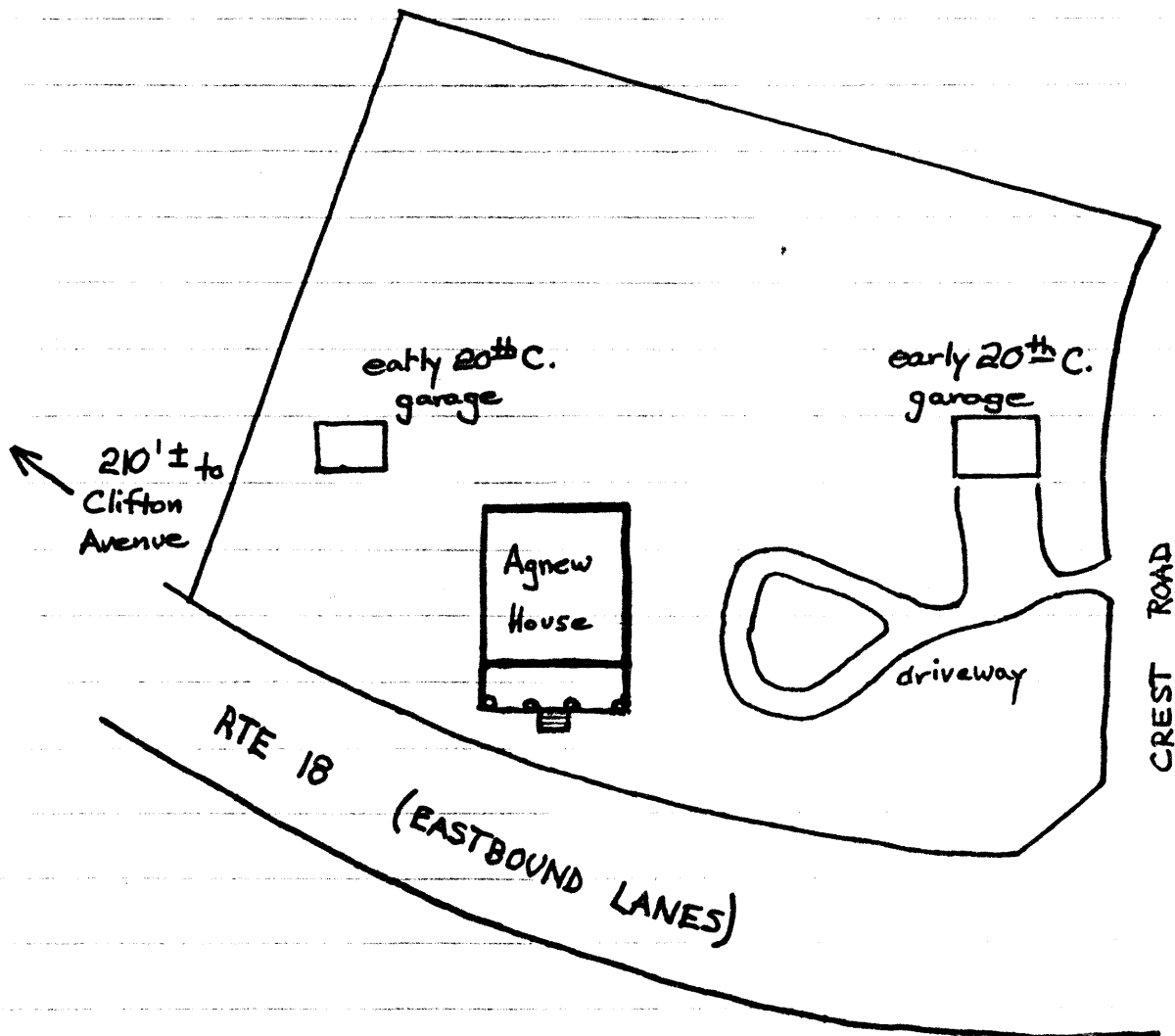

(the site is characterized by numerous trees & shrubs of varied species, but no landscape plan is apparent.)