

KENTUCKY HISTORIC RESOURCES INVENTORY

GN-41

Site No. _____

1. Historic Name(s) <u>David Edwards House (Green Co. M.R.A.)</u>		22. ADD/County <u>Lake Cumberland/Green</u> 044	
Original Owner <u>David Edwards*</u>		23. U.S.G.S. Quadrant (15/75) <u>East Fork</u> 	
2. Present Name <u>Edwards House</u>		24. UTM Reference 	
3. Location <u>Ex: Vic. S. side Caney Fork Cr.; 1 m. W of Maple Hill Ch</u>		Zone Easting Northing	
4. Owner's Name <u>Nelson Murrell</u>		25. Coordinate Accuracy 	
5. Owner's Address <u>Route #4, Greensburg, Ky 42743</u>		26. Prehistoric Site Object Historic Site Structure <u>(Building)</u> Other	
6. Open to Public Yes <input type="checkbox"/> No <input checked="" type="checkbox"/>	7. Visible from road Yes <input checked="" type="checkbox"/> No <input type="checkbox"/>	8. Ownership X Private <input type="checkbox"/> Local <input type="checkbox"/> State <input type="checkbox"/> Federal <input type="checkbox"/>	
9. Local Contact/Organization		27. National Register District Name: 	
10. Site Plan with North Arrow <u>See Attached</u>		28. Significance Evaluation <u>Eligible for National Reg.</u> B	
		29. Status Date National Landmark <input type="checkbox"/> National Register <input type="checkbox"/> Landmark Certificate <input type="checkbox"/> Kentucky Survey <input checked="" type="checkbox"/> <u>8/15/80</u> Local Landmark <input type="checkbox"/> HABS/HAER <input type="checkbox"/>	
		30. Historic Theme Primary <u>Architecture</u> C Secondary <input type="checkbox"/> Other <input type="checkbox"/>	
		31. Endangered Yes <input type="checkbox"/> No <input checked="" type="checkbox"/>	
		32. Preservation Project Status <input type="checkbox"/>	
		Actual Cost in \$1,000s 	
18. Description <u>One-story, four-bay brick; Flemish bond with jack arches, and put holes left unfilled; hall-parlor plan; original ell; recent porch on north and addition in angle of ell; unusual mantel designs-transitional, charrails, enclosed corner staircase in ell; unusual stepped chimney log smokehouse is half-dovetailed.</u>		33. ATTACH PHOTO	
(Continue on Back)		Roll No. <u>8</u>	
19. History <u>David E. brother of George W.E., (GN-27); Kelly (GN-27) was from Columbia, died at Shiloh in 1862 at age 32; built this house at age 15*, George L. Edwards, a later owner was one of Green County's famous outlaws, a murderer.</u>		Picture No. _____	
20. Significance <u>Architecture:</u> <u>The house is one of the best examples in the county of Federal domestic architecture; the interior is especially significant.</u>		Direction _____	
21. Source of Information <u>*owner</u>		34. Prepared by: <u>Joe DeSpain</u>	
		35. Organization <u>Green Co. Historical Society, Inc.</u>	
		36. Date <u>March 1984</u>	
		37. Revision Dates _____ 38. Staff Review _____	

**KENTUCKY HISTORIC RESOURCE INVENTORY SUPPLEMENT
BOUNDARY AND LOCATION INFORMATION**

Historic Property Name DAVID EDWARDS HOUSE Site # GN-41
 Multiple Resource/~~Thematic~~ Nomination Title GREEN COUNTY

U.T.M. Coordinates - List multiple UTMs if property is ten or more acres.

A. 16 628300 4108400 D. _____
 B. _____ E. _____
 C. _____ F. _____

Verbal Boundary Description

Acreage .3 ACRES

Beginning at point A on a fence line S of Caney Fork Creek Road and approximately 40' NW of the NW corner of the house; thence S along said fence line approximately 115' to point B, the intersection of a fence line forming the southern boundary; thence E along said fence line approximately 120' to point C, an intersection with an imaginary line which runs 30' each of the eastern edge of the house and forms the eastern boundary; thence N along said imaginary line approximately 105' to point D on the southern edge of the Casey Fork Creek Road, said point approximately 35' NE of the NE corner of the house; thence along the southern right-of-way of the Casey Fork Creek Road as it meanders to the beginning.

Sketch of Site Plan (Showing outbuildings, structures, landscape features and the site boundary as described above.)

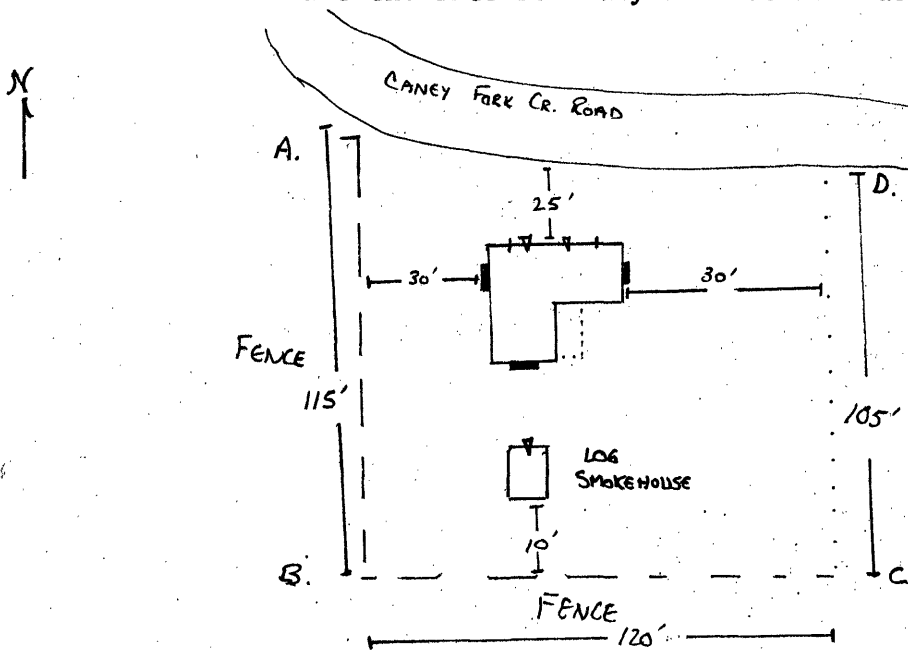

Official Courthouse Property Reference: