

1600

**NATIONAL REGISTER OF HISTORIC PLACES  
REGISTRATION FORM**

**1. Name of Property**

historic name:  
other names/site number: Friars Point Historic District

**2. Location**

street & number: roughly along Second Street not for publication \_\_\_  
city or town: Friars Point vicinity \_\_\_  
state: Mississippi code MS county Coahoma code 027 zip code 38631

**3. State/Federal Agency Certification**

As the designated authority under the National Historic Preservation Act of 1966, as amended, I hereby certify that this  nomination \_\_\_ request for determination of eligibility meets the documentation standards for registering properties in the National Register of Historic Places and meets the procedural and professional requirements set forth in 36 CFR Part 60. In my opinion, the property  meets \_\_\_ does not meet the National Register Criteria. I recommend that this property be considered significant \_\_\_ nationally \_\_\_ statewide  locally. (\_\_\_ See continuation sheet for additional comments.)

Kenneth H. P. Paul Dec. 7, 1998  
Signature of certifying official Date

Deputy State Historic Preservation Officer  
State or Federal agency and bureau

In my opinion, the property \_\_\_ meets \_\_\_ does not meet the National Register criteria. (\_\_\_ See continuation sheet for additional comments.)

\_\_\_\_\_  
Signature of commenting or other official Date

\_\_\_\_\_  
State or Federal agency and bureau

**4. National Park Service Certification**

I, hereby certify that this property is:  
 entered in the National Register,  
\_\_\_ See continuation sheet.  
\_\_\_ determined eligible for the  
National Register  
\_\_\_ See continuation sheet.  
\_\_\_ determined not eligible for the  
National Register  
\_\_\_ removed from the National Register  
\_\_\_ other (explain): \_\_\_\_\_

for Signature of the Keeper Date of Action  
Ma J M Way 1/28/99

Friars Point Historic District

Coahoma County, Mississippi

Name of Property

County and State

**5. Classification**

**Ownership of Property:**

- Private
- Public-local
- Public-Federal

**Number of Resources within Property:**

(Do not include previously listed resources in the count)

**Category of Property:**

District

**Contributing**

35

**Noncontributing**

- 14 buildings
- 1 sites
- 1 structures
- 1 objects
- 15 Total

35

**Name of related multiple property listing**

(Enter "N/A" if property is not part of a multiple property listing.)

N/A

**Number of contributing resources previously listed**

**in the National Register**

**6. Function or Use**

**Historic Functions:** DOMESTIC/single dwelling  
 COMMERCE/TRADE/financial institution  
 COMMERCE/TRADE/warehouse  
 GOVERNMENT/city hall

RELIGION/religious facility  
 SOCIAL/meeting hall

**Current Functions:** DOMESTIC/single dwelling  
 COMMERCE/TRADE/financial institution  
 COMMERCE/TRADE/warehouse  
 GOVERNMENT/city hall  
 GOVERNMENT/post office  
 RELIGION/religious facility  
 RECREATION AND CULTURE/museum

**7. Description**

**Architectural Classification(s):**

Gothic Revival, Queen Anne, Colonial Revival, Tudor, Bungalow/Craftsman,

**Materials:**

- foundation: brick, concrete block, concrete
- roof: composition shingles
- walls: weatherboard
- other:

**Narrative Description:**

See Continuation Sheets

**8. Statement of Significance**

**Applicable National Register Criteria**

- A** Property is associated with events that have made a significant contribution to the broad patterns of our history.
- B** Property is associated with the lives of persons significant in our past.
- C** Property embodies the distinctive characteristics of a type, period, or method of construction or represents the work of a master, or possesses high artistic values, or represents a significant and distinguishable entity whose components lack individual distinction.
- D** Property has yielded, or is likely to yield information important in prehistory or history.

**Areas of Significance**

Architetcure

**Period of Significance**

1870-1940

**Significant Dates**

1870

1915

1927

**Criteria Considerations:**

Property is:

- A** owned by a religious institution or used for religious purposes.
- B** removed from its original location.
- C** a birthplace or a grave.
- D** a cemetery.
- E** a reconstructed building, object, or structure.
- F** a commemorative property.
- G** less than 50 years of age or achieved significance within the past 50 years.

**Significant Person(s)**

**Cultural Affiliation(s)**

N/A

Architect/Builder

**Narrative Statement of Significance:**

See continuation sheets.

**9. Major Bibliographical References**

**Bibliography**

See continuation sheet.

**Previous documentation on file (NPS)**

- preliminary determination of individual listing (36 CFR 67) has been requested.
- previously listed in the National Register
- previously determined eligible by the National Register
- designated a National Historic Landmark
- recorded by Historic American Buildings Survey  
# \_\_\_\_\_
- recorded by Historic American Engineering Record  
# \_\_\_\_\_

**Primary Location of Additional Data**

- State Historic Preservation Office
- Other State agency
- Federal agency
- Local government
- University
- Other

Name of repository:

MS Department of Archives and History

**10. Geographical Data**

Acreage of Property: approximately 35 acres

UTM References:	Zone	Easting	Northing	Zone	Easting	Northing
A	15	717420	3806170	D	15	717170
B	15	717530	3806130	E	15	717130
C	15	717120	3805520	F	15	716830

\_\_\_ See continuation sheet.

**Verbal Boundary Description** See continuation sheet.

**Boundary Justification:** See continuation sheet.

**11. Form Prepared By**

name/title:	Deborah Wise Oakley	date:	June 5, 1998
organization:	Mississippi Department of Archives & History	telephone:	(601)359-6940
street & number:	P.O. Box 571	zip code:	39205
city or town:	Jackson	state:	MS

**Additional Documentation**

Submit the following items with the completed form:

Continuation Sheets

Maps

A USGS map (7.5 or 15 minute series) indicating the property's location.

A sketch map for historic districts and properties having large acreage or numerous resources.

Photographs

Representative black and white photographs of the property.

Additional items (Check with the SHPO or FPO for any additional items)

**Property Owner(s)**

name:	Multiple	telephone:
street & number:		zip code:
city or town:	state:	

**Paperwork Reduction Act Statement:** This information is being collected for applications to the National Register of Historic Places to nominate properties for listing or determine eligibility for listing, to list properties, and to amend existing listings. Response to this request is required to obtain a benefit in accordance with the National Historic Preservation Act, as amended (16 U.S.C. 470 et seq.).

**Estimated Burden Statement:** Public reporting burden for this form is estimated to average 18.1 hours per response including the time for reviewing instructions, gathering and maintaining data, and completing and reviewing the form. Direct comments regarding this burden estimate or any aspect of this form to the Chief, Administrative Services Division, National Park Service, P.O. Box 37127, Washington, DC 20013-7127; and the Office of Management and Budget, Paperwork Reductions Projects (1024-0018), Washington, DC 20503.

**United States Department of the Interior  
National Park Service**

**NATIONAL REGISTER OF HISTORIC PLACES  
CONTINUATION SHEET**

Section: 7

Page: 1

Friars Point Historic District  
Coahoma County, Mississippi

---

**Narrative Description**

**C=Contributing element; NC=Non-contributing element**

The Friars Point Historic District is composed of 49 buildings and one structure which compose the commercial and residential section of Friars Point, Coahoma County, Mississippi. The district is located primarily along Second Street. The district contains commercial and residential architecture, as well as governmental, ecclesiastical and some warehouses.

Friars Point was once a prosperous river town and the county seat of Coahoma County. When the railroads, and later highways changed the commercial transit system, Clarksdale, a railroad town, became the County seat and Friars Point began to decline. The Great Flood of 1927, would further that demise. After that flood, the levee was constructed, taking out Friars Point's Main Street and many of its historic resources. The area is in the flood plain of the Mississippi River and is therefore, flat and low lying.

The commercial area is located at the southern end of Second Street. Some of the most notable commercial buildings in the district are located along the 600 block (Inventory #27-31), as well as the commercial building at 501 Second Street (Inventory #23).

The residential area of the district is on the north end of Second Street. There are many examples of various architectural styles including Queen Anne, Gothic Revival, Colonial Revival and Bungalow/Craftsman. The houses at 213 Second Street (Inventory # 8), 349 Second Street (Inventory #13), 384 Second Street (Inventory #15) and 390 Second Street (Inventory # 16a) are some of the most impressive buildings in the district. For the most part, non-contributing structures are new construction in the Ranch style of the 1970's and 1980's.

The Old Catholic Church (Inventory #2) and the Friars Point Methodist Church (Inventory #7a) are the only religious building in the district, and they are both contributing.

There are 35 contributing buildings in the district. They are noted by the letter "C" in the inventory. There are 14 non-contributing buildings and 1 non-contributing structure in the district. They are noted by the letters "NC" in the inventory. The inventory is arranged alphabetically by street number in ascending order.

**United States Department of the Interior  
National Park Service**

**NATIONAL REGISTER OF HISTORIC PLACES  
CONTINUATION SHEET**

Section: 7

Page: 2

Friars Point Historic District  
Coahoma County, Mississippi

---

**District Inventory**

C=CONTRIBUTING ELEMENT; NC=NON-CONTRIBUTING ELEMENT

The inventory is arranged alphabetically by street number in ascending numerical order. Buildings are classified as "contributing" (C) or "non-contributing" (NC).

1. **(C) 100 Second Street c.1935**  
One-and-a-half-story, wood frame, bungalow with cross-gabled roof with composition shingles. Hipped roof porch supported by tri-box columns on brick bases with concrete caps. Porch has a brick balustrade. Front-facing gable has brackets under the eaves and a pair of 6-light casement windows. The windows under the porch are 12/1 and most of the others are 9/1. All windows have wood frames. The entrance is a single-leaf, multi-light door. There are 2 brick chimneys at the ridge line. Shed roof carport added to the south elevation.
2. **(C) 101 Second Street c.1870**  
**Catholic Church**  
One-story, wood frame, multi-gabled building with simple Gothic features and asbestos shingle siding. The entrance has double, six-panel doors, topped with a Gothic transom that has been enclosed. Above that is a steeple topped with a wooden cross. The windows are 1/1 Gothic with casement windows on bottom and bumpy glass, framed in wood.
3. **(NC) 103 Second Street c.1970**  
Modern trailer with aluminum siding sheltered under a side-gabled structure. There is a frame addition on the front of the trailer, under the gable.
4. **(C) 201 Second Street c.1890**  
2-story, wood frame with weatherboard siding and a cross-gabled roof covered in composition shingles with a brick foundation and a 1-story addition on the north elevation. 3/4 width porch under a shed roof, supported by Doric columns. The entrance is a centrally located, single-leaf door with a 1-light transom above. The windows are 2/2 double-hung-sash with wood frames. The gable front has decorative diamond siding.

**United States Department of the Interior  
National Park Service**

**NATIONAL REGISTER OF HISTORIC PLACES  
CONTINUATION SHEET**

Section: 7 Page: 3 Friars Point Historic District  
Coahoma County, Mississippi

---

5. (C) **202 Second Street c.1935**  
One-and-a-half story, wood frame bungalow with cross-gabled roof with composition shingles. Double, front-gabled porch, with decorative half-timbering in the gable, supported by box columns on stuccoed bases with concrete caps. Brackets under the eaves of the gables. The entrance is a single-leaf, multi-light door with tripartite 12/1 windows to the left (S). There are two 8-light casement windows in the main gable. All windows have wood frames.
6. (C) **204 Second Street c.1880**  
One-story, wood frame, T-shaped building with a cross-gabled roof covered in composition shingles on a brick foundation. The gable front has bargeboard under the eaves and diamond and scalloped siding in the gable. The gable front has bargeboard under the eaves and diamond and scalloped siding in the gable. The entrance, on the wing, is a modern aluminum door and all the windows have been replaced with aluminum framed windows. The windows on the gable-front, however, are 4/4 double-hung-sash in wooden frames, topped with a pedimented lintel.
- 7a. (C) **208 Second Street c.1915**  
**Friars Point Methodist Church**  
One-story, brick building with a cross-gabled roof covered in composition shingles on a brick foundation. The church is a Greek cross plan, with a front-gabled vestibule. A concrete water-table circles the building. Entrance is a centrally located in the vestibule and is a pair of double, six-panel doors surmounted by a stained glass, Gothic arched transom. Windows are 1/1, double-hung sash, stained glass windows with a Gothic arch. All windows have a soldier course lintel, concrete sill and have wood frames.
- b. (NC) One-story, brick building with a side-gabled roof covered in composition shingles, all on a concrete slab foundation. The windows are 6/6. An undercut porch surrounds the building. c.1960
8. (C) **213 Second Street c.1880**  
One-and-a-half-story, wood frame, Queen Anne with a multi-gabled roof covered in composition shingles on a brick foundation. Entrance is a single-leaf, 1-light door with 1-light sidelights and a 3-light transom. 1/4 round porch supported by columns under a half-hipped roof. The turret and gable end are covered with decorative diamond siding. The gable ends are decorated with scroll work.
9. (C) **248 Second Street c.1940**  
**Old Friars Point Depot**  
One-story, wood-frame building with a multi-hipped roof covered in composition shingles on a brick foundation. Building is sided in asbestos shingles with a brick wainscoting around the entire building. Exposed rafters under the eaves. The windows are 6/6 double-hung sash in wood frames. Entrance is a single-leaf, multi-light door.

**United States Department of the Interior  
National Park Service**

**NATIONAL REGISTER OF HISTORIC PLACES  
CONTINUATION SHEET**

Section: 7

Page: 4

Friars Point Historic District  
Coahoma County, Mississippi

---

10. **(NC) 300 Second Street c.1980**  
One-story, brick house with a side-gabled roof covered in composition shingles on a concrete slab foundation. The entrance is a single-leaf, modern, 6-panel door. The windows are modern aluminum. A recessed porch, supported by three columns, spans three-quarters of the facade (E).
11. **(NC) 321 Second Street c.1920, extensive alterations c.1980**  
One-story, wood-frame house with a side-gabled roof covered in composition shingles on a concrete foundation. The entrance is a single-leaf, multi-light door. The windows are replacement, 1/1 with aluminum frames. The double windows in the gable end are original, 4/1, Craftsman windows. Half of the shed-roof porch has been enclosed. There is a shed roof dormer in the center of the roof, as well as an interior brick chimney. The house is sided with aluminum siding.
12. **(C) 324 Second Street c.1880**  
Two-story, wood frame, L-shaped house with a cross-gabled roof covered in composition shingles on a brick foundation. The house is sided with weatherboard. The entrance is a single-leaf, multi-light door. The windows are 9/6, double-hung-sash with wooden frames. A porch, supported by round posts, is located in the L, and wraps around the north end. A modern brick wainscoting is located under the porch. There is decorative bargeboard under all the eaves.
13. **(C) 349 Second Street c.1910**  
Two-and-a-half-story, wood frame house with a hipped roof covered in composition shingles, on a concrete foundation. There is a wrap-around hipped roof porch supported by paired and tri-box columns on top of a brick balustrade. The entrance is centrally located under a hipped-roof projection, and is single-leaf, 1-light-and-panel door, topped by a three-light transom and surrounded by 1-light-and-panel sidelights. Above the entrance is a 3-sided bay. The windows under the porch are 4/1, double-hung sash, while all others are 6/1, double-hung-sash. All are set in wood frames. The first floor windows have a constant, running concrete sill. The third floor has hipped-roof dormers on all four sides. There are paired brackets under the eaves, and a hipped-roof, porte cochere on the south elevation.
14. **(C) 360 Second Street c.1940**  
One-story, wood frame house with a hip-on-gable roof, covered with composition shingles, all on a brick foundation. The entrance is located under a front-gabled portico, supported by two, round posts, and consists of a single-leaf, three-tier-light door. It is covered by an iron burglar door. The entrance is flanked on either side by paired, 6/6, double-hung sash windows. The north elevation has an exterior, brick chimney.



**United States Department of the Interior  
National Park Service**

**NATIONAL REGISTER OF HISTORIC PLACES  
CONTINUATION SHEET**

Section: 7 Page: 5 Friars Point Historic District  
Coahoma County, Mississippi

---

15. (C) **384 Second Street c.1935**  
One-story, brick house with a cross-gabled roof covered in composition shingles, all on a brick foundation. The entrance is located under the in set, corner porch. The front-facing gable, has an exterior chimney, with double 9/1, double-hung sash windows in wood frames, and decorative, louvered vents on either side. There is a side-gabled, porte cochere on the south side, supported by paired, squared posts. The rafters are exposed under the eaves.
- 16a. (C) **390 Second Street c.1900**  
One-and-a-half-story, wood frame house with a multi-hipped roof, covered in composition shingles, all on a brick foundation. The house is sided in weatherboard. The porch, at one time, wrapped around the north elevation, but that portion has been enclosed. The entrance is located under a front-gabled projection, off of the hipped porch, and consists of a single-leaf door with multi-light transom and sidelights. There are two, interior brick chimneys piercing the roof. The windows are 1/1, double-hung sash in wood frames with working shutters. The north elevation has a hipped-roof dormer with paired windows.
- b. (C) One-story, wood frame, outbuilding with a side-gabled roof covered in composition shingles, all on a brick foundation. The building is sided in board-and-batten siding.
17. (C) **401 Second Street c.1910**  
One-and-a-half-story, wood frame house with a multi-hipped roof covered with composition shingles, all on a stone foundation. The hipped-roof porch formerly wrapped around the north side, but has since been enclosed. The entrance is centrally located, with a single-light transom above, and 2/1, double-hung sash windows on either side. All the windows are set in wood frames. There is a hipped-roof dormer on the facade, with a 1/1, double-hung-sash window. The house is sided in weatherboard.
18. (NC) **403 Second Street c.1970**  
**Friars Point Community Health Center**  
One-story, brick building with a gabled roof covered in composition shingles on a concrete slab foundation. There are two, single-leaf, metal doors on either side of the facade (W) with six transoms that cover the facade.
19. (NC) **405 Second Street c.1975**  
One-story, L-shaped, brick house with a shallow, cross-gabled roof, covered in composition shingles, all on a concrete, slab foundation. The windows are modern, aluminum and flanked by fixed, modern shutters. The entrance is located in the angle of the L, with windows to the right.

**United States Department of the Interior  
National Park Service**

**NATIONAL REGISTER OF HISTORIC PLACES  
CONTINUATION SHEET**

Section: 7

Page: 6

Friars Point Historic District  
Coahoma County, Mississippi

---

20. **(NC) 460 Second Street c.1980**  
One-story, brick house with a multi, side-gabled roof covered in composition shingles, all on a concrete, slab foundation. The entrance is centrally located, sheltered by the under-cut porch, and consists of a single-leaf, modern door. It is covered by an iron, burglar door.
21. **(C) 497 Second Street c.1935**  
One-story, brick and stucco house, with a multi-gabled roof, covered in composition shingles, all on a brick foundation. The entrance is located under a small, front-facing gable, under an arch, and consists of a 9-light-and-panel door, with an iron burglar door over it. There are paired, 6/1, double-hung-sash windows on either side. All windows are set in wood frames. The south elevation has an exterior-end, brick chimney.
22. **(NC) 500 Second Street c.1980**  
One-and-a-half-story, brick house with an irregular roof, covered in composition shingles, all on a concrete, slab foundation. The east facade has an exterior, brick chimney. The windows are irregular, and set in aluminum frames.
23. **(C) 501 Second Street c.1895**  
One-story, brick commercial building with a flat roof and two store-fronts. A flat metal awning, supported by turned posts and metal chains suspended from iron rosettes in the upper portion of the building, spans the facade. The entrances to both storefronts are double, single-leaf, one-light-and-panel doors recessed from the storefront with windows on either side. Transoms above the awning have been enclosed with wood. The upper portion of the building is divided into six signplates, each with a decorative brick, herringbone pattern. The cornice has 5-course, brick corbelling with a concrete cap.
24. **(NC) 574 Second Street c.1915, altered c.1980**  
One-story, brick commercial building, severely altered from its original 2-story form. Entrance is on a chamfered corner and is a glazed aluminum door with transom, sheltered by a pent metal awning. A paired storefront window in a metal frame is on the primary facade (east) with a concrete sill. A masonry cap tops the parapet and the brick bond is 6th course headers.
25. **(C) 574 1/2 Second Street c.1925**  
One-story, gable-roofed telephone exchange building to the rear of 574 Second Street. The building was originally detached, but has been connected to 574 Second Street with a short brick wall. The centrally located entrance is a single-leaf door, sheltered by a small gable roof on triangular knee braces. A soldier course watertable surrounds the building. Two small windows with soldier course lintels flanking the entrance have been infilled with brick.

**United States Department of the Interior  
National Park Service**

**NATIONAL REGISTER OF HISTORIC PLACES  
CONTINUATION SHEET**

Section: 7 Page: 7 Friars Point Historic District  
Coahoma County, Mississippi

---

26. **(NC) 600 Second Street c.1960**  
One-story, painted brick and corrugate-metal commercial building with a front gabled, corrugated-metal roof. The entrance is located under the gable, and consists of double, glazed doors, that are boarded up. One either side, are plate-glass windows. There is a shed roof addition on the north elevation.
27. **(C) 601 Second Street c.1900**  
One-story, painted brick, commercial building with flat roof. A flat metal awning spans the facade. Storefront has been rebricked and windows replaced with all aluminum frame windows. The transoms are covered with an aluminum slipcover. A single-leaf, one-light door, with a wooden frame is recessed with a storefront window to the left and right. Above the awning, the upper wall is divided into three sign plates. Each has a decorative, metal vent with segmental arches and 2-course, brick corbelling above. The cornice has 5-course, brick corbelling.
28. **(C) 603 Second Street c.1900**  
One-story, painted brick, commercial building with flat roof. A flat metal awning spans the facade. Storefront has replacement widows with all aluminum frames. The transoms are covered with an aluminum slipcover. A single-leaf, one-light door, with a wooden frame is recessed with a storefront window to the left and right. Above the awning, the upper wall is divided into three sign plates. Each has a decorative, metal vent with 2-course, brick corbelling above. The cornice has 5-course, brick corbelling.
29. **(C) 605 Second Street c.1900**  
One-story, painted brick, commercial building with flat roof. A flat metal awning spans the facade. Storefront has modern clapboard and windows replaced with new wooden frame windows. The transoms are covered with an aluminum slipcover. A pair of single-leaf, one-light-and-panel doors, with wooden frames are centrally located with a storefront window to the left and right. Above the awning, the upper wall is divided into three sign plates. Each has a decorative, metal vent with 8-course, brick corbelling above. The cornice has 5-course, brick corbelling with brick, saw-tooth dentils in the middle.
30. **(C) 607 Second Street c.1900**  
One-story, painted brick, commercial building with flat roof. A flat metal awning spans the facade. Storefront has been rebricked and windows replaced with all aluminum frame windows. The transoms are covered with an aluminum slipcover. The entrance is a centrally located, double-leaf, glazed, metal door with a storefront window to the left and right. Above the awning, the upper wall is divided into three sign plates. Each has a decorative, metal vent with 6-course, brick corbelling above. The cornice has 5-course, brick corbelling with brick, saw-tooth dentils in the middle.

**United States Department of the Interior  
National Park Service**

**NATIONAL REGISTER OF HISTORIC PLACES  
CONTINUATION SHEET**

Section: 7 Page: 8 Friars Point Historic District  
Coahoma County, Mississippi

---

31. (C) **649 Second Street** c.1900  
One-story, painted brick, commercial building with flat roof. A flat metal awning spans the facade. Storefront has been rebricked and windows replaced with all aluminum frame windows. The transoms are covered with an aluminum slipcover. A double-leaf, glazed, metal door is recessed with a storefront window to the left and right. Above the awning, the upper wall is divided into three sign plates. Each has a decorative, metal vent with 6-course, brick corbelling above. The cornice has 5-course, brick corbelling with brick, saw-tooth dentils in the middle.
- 32a. (NC) **650 Second Street** c.1960  
One-story, standing-seam metal gas station with a low-pitched, standing-seam metal, gable roof. The roof projects out from the building to protect the gas pumps. The entrance is a pair of single-leaf, hollow-core, aluminum doors.
- b. (C) One-story, corrugated-metal warehouse building with a side-gabled roof of corrugated-metal on a poured concrete foundation. It was probably the service bays for the gas station. c.1940
33. (C) **652 Second Street** c. 1940  
**Warehouse**  
One-story, corrugated-metal warehouse building with a front-gabled roof of corrugated-metal on a poured concrete foundation.
34. (C) **654 Second Street** c.1940  
**Warehouse**  
One-story, corrugated-metal warehouse building with a front-gabled roof of corrugated-metal on a poured concrete foundation.
35. (C) **700 Second Street** c.1940  
One-story, brick building with four bays on the facade (east). The facade reads window, window, door, window. The windows are large, 9-light, plate glass windows. The lintels are soldier course, segmental arches. The entrance is a single-leaf door with plate glass side-lights and transoms. It also has a segmental arch. There is a modern brick portico built out over the entrance. The parapet has 12 course brick dentils.

**United States Department of the Interior  
National Park Service**

**NATIONAL REGISTER OF HISTORIC PLACES  
CONTINUATION SHEET**

Section: 7 Page: 9 Friars Point Historic District  
Coahoma County, Mississippi

---

- 36a. **(C) 702 Second Street c.1935**  
Old VFW Hall  
One-story, concrete block building with a front-gabled roof covered with composition shingles on a concrete foundation. The facade has three bays (w/d/w). A hipped-roof porch, supported by paired, squared posts on brick bases, spans three-quarters of the facade. The entrance consists of double, vertical plank doors with paired 6/6 windows in wood frames on either side. The gable end is sided with board-and-batten siding, with a metal vent in the center of the gable.
- b. **(NC)** Rectangular, log, hay barn, moved to the site from an old plantation, to be used as part of the museum.
37. **(NC) 774 Second Street c.1980**  
**U.S. Post Office**  
One-story, brick building with cross-gabled roof and asphalt shingles on a concrete foundation. The entrance is a 9-light-and-panel door sheltered under a front gable portico supported by two columns. Directly south of the entrance are three casement windows.
38. **(NC) 818 Second Street c.1985**  
One-and-a-half story, brick house with a side-gabled roof covered in composition shingles on a concrete foundation. The entrance is a single-leaf, six-panel modern door. There are two, 6/6 windows with aluminum frames on either side. Three gable-roofed dormers, with 6/6 windows in aluminum frames, pierce the roof. There is dentil molding under the eaves.
39. **(C) 846 Second Street c.1870**  
Two-story, wood frame, house with a side-gabled roof and composition shingles on a brick foundation. The entrance is a centrally located, single-leaf, four-panel door with a 5-light transom above and 3-light-and-panel sidelights on either side. There is a two-story, front-gabled portico, supported by chamfered posts. The windows are 6/6, double-hung-sash, set in wooden frames. There are exterior, brick chimneys on the north and south elevation of the house. There is a one-story addition on the north end of the house.
40. **(C) 203 Third Street c.1890**  
Two-and-a-half-story, wood frame house with a steeply pitched hipped-roof covered in composition shingles, all on a brick foundation. The house is sided with weatherboard. The entrance is a centrally located, single-leaf, glazed door topped with a 3-light transom with 1-light sidelights on either side, all protected by the gabled portico. The windows are 1/1, double-hung sash, all in wooden frames. There are hipped-roof dormers on three sides of the house, all with 1-light windows. There is a historic, shed roof addition on the east elevation.

**United States Department of the Interior  
National Park Service**

**NATIONAL REGISTER OF HISTORIC PLACES  
CONTINUATION SHEET**

Section: 7 Page: 10 Friars Point Historic District  
Coahoma County, Mississippi

---

41. (C) 100 Robinson Street c.1940  
One-story, wood frame, telephone exchange with a front-gabled roof covered in composition shingles all on a concrete foundation. The building is sided with weatherboard. The entrance is a centrally located, single-leaf hollow-core door, sheltered by a front-gabled portico, supported by triangular brackets. Louvered vent at the peak of the gable end.
42. (NC) 201 Washington Street c.1980  
One-story, wood frame building with a mansard roof covered with composition shingles all on a concrete foundation. There are two gable wings on either side. The building is sided in board-and-batten. The widows are long, narrow, glazed stationary windows.
43. (C) 248 Washington Street c.1940  
One-story, wood frame house with a front-gabled roof covered with composition shingles all on a brick foundation. The entrance is modern, hollow-core door. The front-gabled, screened-in porch has a pressed-wood balustrade and covers three-quarters of the facade.. The widows have been replaced with 2.2, aluminum frame windows.
44. (C) 304 Washington Street c.1910  
One-story, brick commercial building with a flat roof and a stepped parapet and two storefronts. A suspended, metal awning spans the facade. The left storefront consists of a recessed pair of glazed, double door, in wood frames, with windows on the left and right. The right storefront has been altered, with the doors and windows replaced with modern, aluminum frames. The transoms above the awning have been enclosed with plywood. There is a brick addition on the east elevation.
45. (C) 305 Washington Street c.1940  
One-story, concrete block commercial building with a gabled roof, and a false-front, stepped parapet. A suspended, metal awning covers the entrance, which consists of double, metal doors. On either side of the entrance are boarded-up windows.
46. (C) 307 Washington Street c.1935  
One-story, brick commercial building with a gabled roof and a stepped parapet covered with stamped metal. A shed-roof porch, supported by round, metal posts, spans the entire facade. The entrance is a centrally located, modern, metal door. It is flanked on either side by windows with metal mesh over them.

**United States Department of the Interior  
National Park Service**

**NATIONAL REGISTER OF HISTORIC PLACES  
CONTINUATION SHEET**

Section: 8

Page: 11

Friars Point Historic District  
Coahoma County, Mississippi

---

**Statement of Significance**

The Friars Point Historic District is being nominated under Criterion C for its significance as a collection of several architectural styles. The period of significance is from 1870 to 1940, reflecting the dates of earliest surviving building and the most recent building that adds to the architectural significance of the district. The district possesses significance under Criterion C in the area of architecture for its locally significant collection of late-nineteenth and early twentieth century commercial, residential and ecclesiastical buildings. The architectural styles found in the town include Queen Anne, Colonial Revival, and Craftsman Style residential architecture, as well as vernacular houses typical of those built in small towns in Mississippi between the mid 1800's and the early 1900's. Among the most notable buildings are the houses at 213 Second Street (Inventory #8), 349 Second Street (Inventory #13), 384 Second Street (Inventory #15), 390 Second Street (Inventory # 16a), 846 Second Street (Inventory #39), the 600 block of Second Street (Inventory #27-31), the Old Catholic Church (Inventory # 2) and the Friars Point Methodist Church (Inventory #7a).

Criteria Exceptions A and B apply to several resources in the district. Exception A applies to one historic church on Second Street, the Friars Point Methodist Church. Exception B applies to the Old Catholic Church, the Robinson-Slack House on Second Street and the Old Friars Point Depot. Most of these buildings were moved east one block to avoid being demolished when the Levee was constructed where the main street of Friars Point had been located. There may have been other buildings moved after the construction of the Levee, but no documentation was available about any such moves.

Friars Point, founded in 1850, originally consisted of a Main Street and other streets east of that. This town developed along the Mississippi River, and became a very important landing point along the river. Friar's Point became the county seat of Coahoma County in 1850, the same year it was established, when the previous county seats was consumed by the River.<sup>1</sup>

---

<sup>1</sup> Linton Weeks, "Clarksdale & Coahoma County: A History," 1982.

**United States Department of the Interior  
National Park Service**

**NATIONAL REGISTER OF HISTORIC PLACES  
CONTINUATION SHEET**

Section: 8

Page: 12

Friars Point Historic District  
Coahoma County, Mississippi

---

Friars Point saw a boom in growth. River boats shipping cotton stopped in this new city on a regular basis. These boats brought mail and other luxuries to Friars Point. This prosperity would see its peak in the decade prior to the Civil War. After the War came the railroads.

Friars Point existed because of the river, but the nearby town of Clarksdale existed because of the railroads. The Yazoo & Mississippi Valley Railroad ran through Clarksdale, and this railroad line would usurp the river's role of transporting cotton. Clarksdale not only became the center of transportation in the area, they also became the county seat. After 50 years, the county seat was once again moved. This time away from the river.

In 1927, the Mississippi River flooded, wiping out thousand of acres of agricultural land in Mississippi. The devastation of the flood was vast, but the results of the flood had a much more direct impact on Friars Point. The present Levee was constructed to avoid future floods of such magnitude. Main Street in Friars Point was taken out to make room for the new levee. Several of the buildings on Main Street were moved one block east to save them from destruction, but countless others were simply destroyed to make way for the Levee.

The buildings along Second Street and the cross streets, are the best surviving examples of the architecture of Friars Point--a once prosperous, now quiet, little town on the Mississippi River.



**United States Department of the Interior  
National Park Service**

**NATIONAL REGISTER OF HISTORIC PLACES  
CONTINUATION SHEET**

Section: 9 & 10 Page: 13

Friars Point Historic District  
Coahoma County, Mississippi

---

**Bibliography**

Mississippi Department of Archives and History. Historic Preservation Division. Historic Resources Division, Coahoma County.

Sanborn maps, 1886, 1893, 1897, 1904, 1909, 1918, 1924

Weeks, Linton, *Clarksdale & Coahoma County: A History*. Carnegie Public Library: Clarksdale, Mississippi, 1982.

WPA Research Project for Coahoma County. On file at Mississippi Department of Archives and History, Jackson.

**Geographical Data**

Verbal Boundary Description: The district boundaries are delineated on the accompanying Coahoma County Tax Maps. (scale 1"=100')

Boundary Justification: The district includes a group of contiguous residential, commercial, religious, governmental and industrial buildings that represent the architectural development of Friars Point during the period of significance, c.1840-1940.

**United States Department of the Interior  
National Park Service**

**NATIONAL REGISTER OF HISTORIC PLACES  
CONTINUATION SHEET**

Section: Photos Page: 14 Friar's Point Downtown Historic District  
Coahoma County, Mississippi

---

**PHOTOGRAPHS**

1. Friars Point Historic District
2. Coahoma County, Mississippi
3. Jennifer V.O. Baughn
4. Spring 1998
5. Mississippi Department of Archives and History

Photo 1 of 22	View of 100 Second Street, facing west
Photo 2 of 22	View of 101 Second Street, facing northeast
Photo 3 of 22	View of 201 Second Street, facing east
Photo 4 of 22	View of 202 Second Street, facing west
Photo 5 of 22	View of 208 Second Street, facing west
Photo 6 of 22	View of 213 Second Street, facing east
Photo 7 of 22	View of 324 Second Street, facing west
Photo 8 of 22	View of 349 Second Street, facing northeast
Photo 9 of 22	View of 384 Second Street, facing west
Photo 10 of 22	View of 390 Second Street, facing west
Photo 11 of 22	View of 401 Second Street, facing east
Photo 12 of 22	View of 500 Second Street, facing west
Photo 13 of 22	View of 501 Second Street, facing northeast
Photo 14 of 22	View of 574 Second Street, facing west
Photo 15 of 22	View of 574 1/2 Second Street, facing north
Photo 16 of 22	View of 601 & 603 Second Street, facing east
Photo 17 of 22	View of 654 Second Street, facing south
Photo 18 of 22	View of 700 Second Street, facing west
Photo 19 of 22	View of 774 Second Street, facing southwest
Photo 20 of 22	View of 846 Second Street, facing east
Photo 21 of 22	View of 203 Third Street, facing east
Photo 22 of 22	View of 305 Washington Street, facing north

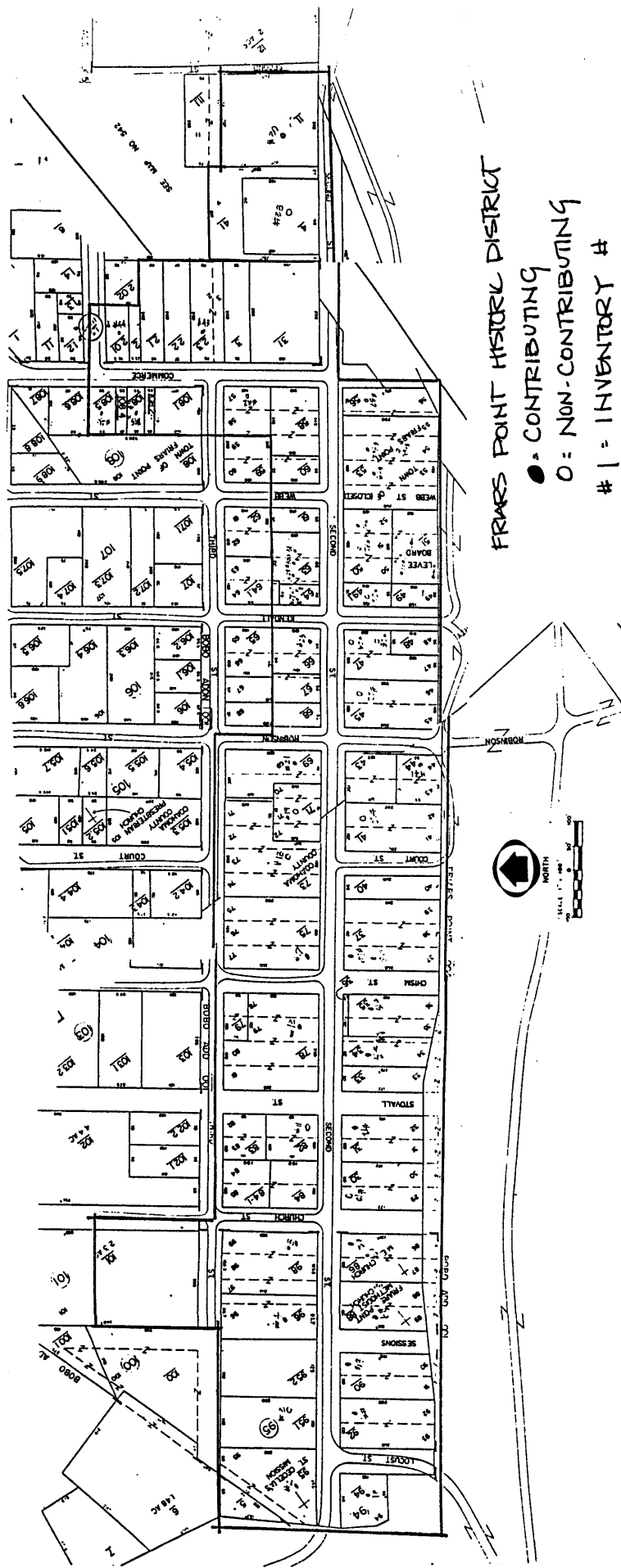

FRAMES POINT HISTORIC DISTRICT

- CONTRIBUTING
- NON-CONTRIBUTING
- # INVENTORY #
- - - BOUNDARY

