

1767

United States Department of the Interior  
National Park Service

RECEIVED  
OCT 23 1990

National Register of Historic Places  
Registration Form

NATIONAL  
REGISTER

This form is for use in nominating or requesting determinations of eligibility for individual properties or districts. See instructions in *Guidelines for Completing National Register Forms* (National Register Bulletin 16). Complete each item by marking "x" in the appropriate box or by entering the requested information. If an item does not apply to the property being documented, enter "N/A" for "not applicable." For functions, styles, materials, and areas of significance, enter only the categories and subcategories listed in the instructions. For additional space use continuation sheets (Form 10-900a). Type all entries.

1. Name of Property

historic name Warrick, John Wesley and Grace Shafer, House  
other names/site number NEHBS # MD04-001

2. Location

street & number RR 2, Box 11 n/a not for publication  
city, town Meadow Grove n/a vicinity  
state Nebraska code NE county Madison code 119 zip code 68752

3. Classification

Ownership of Property	Category of Property	Number of Resources within Property	
		Contributing	Noncontributing
<input checked="" type="checkbox"/> private	<input checked="" type="checkbox"/> building(s)	<u>2</u>	<u>      </u> buildings
<input type="checkbox"/> public-local	<input type="checkbox"/> district	<u>      </u>	<u>      </u> sites
<input type="checkbox"/> public-State	<input type="checkbox"/> site	<u>1</u>	<u>      </u> structures
<input type="checkbox"/> public-Federal	<input type="checkbox"/> structure	<u>      </u>	<u>      </u> objects
	<input type="checkbox"/> object	<u>3</u>	<u>      </u> Total

Name of related multiple property listing: na Number of contributing resources previously listed in the National Register 0

4. State/Federal Agency Certification

As the designated authority under the National Historic Preservation Act of 1966, as amended, I hereby certify that this  nomination  request for determination of eligibility meets the documentation standards for registering properties in the National Register of Historic Places and meets the procedural and professional requirements set forth in 36 CFR Part 60. In my opinion, the property  meets  does not meet the National Register criteria.  See continuation sheet.  
James A. Harrison Signature of certifying official October 14, 1990 Date  
State or Federal agency and bureau

In my opinion, the property  meets  does not meet the National Register criteria.  See continuation sheet.  
Signature of commenting or other official \_\_\_\_\_ Date \_\_\_\_\_  
State or Federal agency and bureau \_\_\_\_\_

5. National Park Service Certification

I, hereby, certify that this property is:  
 entered in the National Register. Entered in the National Register  
 See continuation sheet.  
 determined eligible for the National Register.  See continuation sheet.  
 determined not eligible for the National Register.  
 removed from the National Register.  
 other, (explain): \_\_\_\_\_  
Adrian Byers Signature of the Keeper 11/28/90 Date of Action

**6. Function or Use**

Historic Functions (enter categories from instructions)

Domestic/single dwelling

Domestic/secondary structure

Current Functions (enter categories from instructions)

Domestic/single dwelling

Domestic/secondary structure

**7. Description**

Architectural Classification

(enter categories from instructions)

Queen Anne

Materials (enter categories from instructions)

foundation brick

walls wood

roof wood

other

Describe present and historic physical appearance.

The John Wesley and Grace Shafer Warrick House, located in the south part of Meadow Grove in Madison County, Nebraska, is a large two-and-one-half story nineteen room frame house built in 1903. The Warrick House is an excellent and well-preserved example of the Free Classic Queen Anne style, and is a landmark structure in the Meadow Grove community. In the early 1920s a basement and large frontal porch was added. The interior retains original features such as decorative woodwork, glazed tile fireplaces, sliding doors and a large hallway and staircase. The nomination includes two (2) contributing buildings: the house and carriage barn, and one (1) contributing structure: a row of 4 brick piers. The interior and the exterior of the house and carriage barn retain the features that distinguish them as turn-of-the-century buildings. The property is in excellent repair and displays good architectural integrity.

The Warrick House is located in the south part of Meadow Grove, Nebraska (1980 population: 400) in Madison County, a northeast Nebraska county that is bisected west to east by the Elkhorn River. When the house was built, it reflected the financial success that Mr. Warrick had achieved as a dealer in lumber, grain, and livestock.

The large two-and-one-half story frame house sits in a large well landscaped acreage that is framed by four brick piers, (1922) formerly joined by hedge rows, that provide a formal approach to the property. The house sits on a red brick foundation that was added on as a full finished basement in 1922. Also added at that time was the distinctive front porch that fully enclosed the front first floor of the house. Classical columns on brick pedestals are on all four corners of the front porch, which is also fully enclosed and finished. The balcony is enclosed by a railing of

**United States Department of the Interior  
National Park Service**

**National Register of Historic Places  
Continuation Sheet**

Section number 7 Page 2

---

spindlework supports. The roof is steeply pitched front to back with two cross gables. A small flat deck crowns the hip. The two cross gables and front gable are noteworthy for their decorative half-timbering and palladian windows. Modillions can also be seen as support arches over a second floor screened-in porch. A second enclosed porch displays wall covering of wood shingles overlay. This porch is used for a summer sleeping porch.

The back entrance has been altered by the addition of a greenhouse in 1988. Before the addition an enclosed porch was in that area. Large two-story bay windows dominate the south and north facades. A second-story bay window is also found on the east facade. Before the addition of the enclosed front porch in 1922, the main facade of the house was dominated by a porch that followed the curvature of the house with support of classical columns both on the first floor and on the second (see photo #3). The second floor columns support the front gable and the side gable. The front was also dominated by a large bay window, with leaded glass windows on each side of the main front door. Sometime after the 1922 remodeling the front porch was enclosed.

The Queen Anne style is distinguished by asymmetry, variety in roof shapes, patterned shingles, decorative woodwork, and large bay windows. The Warrick House illustrates Queen Anne variety of textures and materials and Free Classic detailing in its use of classical columns and Palladian windows. Its use of wood shingling and decorative half-timbering is also representative of the style.

The interior of the Warrick House retains many of its original features including a variety of woods used in doors, moldings and floors. The maple molding and staircase in the front hall embellish the solid oak flooring that covers all of the first and second floors. The fireplace in the main living room is white tile surrounded by maple molding. The first floor is also dominated by solid walnut bookshelves, a dining room trestle table and writing desk, made from walnut trees planted in the surrounding yard. All bedrooms have dressing rooms with large walk-in closets.

**United States Department of the Interior  
National Park Service****National Register of Historic Places  
Continuation Sheet**Section number 7 Page 3

---

The carriage barn (built c. 1903) is very complimentary to the house, both in terms of its styling and setting. Its steeply pitched hip roof is set off by two lower cross gables, and is dominated by a square cupola. Each cross gable has a large window in the middle. The carriage barn has been converted into a garage, however most of the building retains its original appearance when it was used to house horses for carriages.

The property has a concrete curbed driveway on the south that leads up to the carriage barn. The house is dominated by a large cottonwood and maple tree in front that were planted at the time the house was built in 1903. To the north are rows of ponderosa pine, and scotch pine trees. The property has many maple, oak, pine, cottonwood and fir trees. On the south side of the house (see site plan) was also a 1920s brick and wood pergola, which was covered by trumpet vines. On the north was a large goldfish pond, bordered by a rose trellis. The pergola and fish pond are no longer extant. A wash house and chicken house were also once located on the site.

The John Wesley Warrick House has been continuously owned and lived in by the Warrick family since it was built. John Wesley Warrick Jr.'s widow Ruth lives in the next house south, and John Wesley Warrick III lives next to the carriage barn. Robert H. and Gudrun C. Warrick have lived in the house since their marriage in 1963.

**8. Statement of Significance**

Certifying official has considered the significance of this property in relation to other properties:

nationally  statewide  locally

Applicable National Register Criteria  A  B  C  D

Criteria Considerations (Exceptions)  A  B  C  D  E  F  G

Areas of Significance (enter categories from instructions)

Architecture  
\_\_\_\_\_  
\_\_\_\_\_  
\_\_\_\_\_  
\_\_\_\_\_

Period of Significance

1903-22  
\_\_\_\_\_  
\_\_\_\_\_

Significant Dates

1903  
1922  
\_\_\_\_\_

Cultural Affiliation

na  
\_\_\_\_\_  
\_\_\_\_\_

Significant Person

na  
\_\_\_\_\_

Architect/Builder

unknown  
\_\_\_\_\_

State significance of property, and justify criteria, criteria considerations, and areas and periods of significance noted above.

The John Wesley and Grace Shafer Warrick House is architecturally significant (Criterion C) as the most distinct and sophisticated turn-of-the-century residence in Meadow Grove. The grandiose Queen Anne dwelling is located on a large landscaped lot and stands as a landmark in town. The building of the house represented the accomplishments of a successful rural businessman who operated a lumber, grain, and livestock business. The period of significance is derived from the original construction date of the house (1903) through significant later remodelings (1922).

The Warrick House, the most architecturally distinct residential dwelling in Meadow Grove, is an excellent local example of the Free Classic Queen Anne style. The style is characterized by irregular form, steeply pitched rooflines, full frontal porches, bay windows, and use of various elements such as decorative shingles, half-timbering, classical columns, and Palladian windows (McAlester, 1984, pp. 263-264). In Nebraska, the style enjoyed widespread popularity in residential architecture during the 1880s-1900. Queen Anne stylistic features found in the Warrick House include a multi-hipped and gabled roof with wood shingles, half-timbering on the gables with Palladian windows, large bay windows on three facades and the use of classical columns on the first and second levels.

The house stands as a landmark, both visually and historically in the town. Visually the dwelling is impressive due to both its size and design. The house is located on the south edge of town on a large residential lot, and this, along with the carriage barn and surrounding landscape features, enhance its local landmark status. Historically, the house is associated with the Warricks, a locally prominent family.

See continuation sheet

**9. Major Bibliographical References**

Gary Kuchar and Mrs. Lenora Kuchar, They Called It Meadow Grove, Volume 1, Osborne, KS: Osborn Publishing Co. Inc., 1979.

McAlester, Virginia and Lee. A Field Guide to American Houses. New York: Alfred A. Knopf, 1984.

See continuation sheet

**Previous documentation on file (NPS):**

- preliminary determination of individual listing (36 CFR 67) has been requested
- previously listed in the National Register
- previously determined eligible by the National Register
- designated a National Historic Landmark
- recorded by Historic American Buildings Survey # \_\_\_\_\_
- recorded by Historic American Engineering Record # \_\_\_\_\_

**Primary location of additional data:**

- State historic preservation office
- Other State agency
- Federal agency
- Local government
- University
- Other

Specify repository: \_\_\_\_\_

**10. Geographical Data**

Acres of property 2.5

**UTM References**

Zone	Easting	Northing
14	604530	4653240

B 

Zone	Easting	Northing

D 

Zone	Easting	Northing

See continuation sheet

**Verbal Boundary Description**

The property is described as the east 242 feet of the north 176 feet and the west 319 feet of the north 166 feet of tax lot 28, in the southeast quarter of the northeast quarter of Section 26, Township 24 north, Range 4 east, Meadow Grove, Madison County, Nebraska.

See continuation sheet

**Boundary Justification**

The boundary encompasses that track of land which contains the house, carriage barn and the immediate surrounding landscape that has historically been associated with the property.

See continuation sheet

**11. Form Prepared By**

name/title Robert Warrick

organization Husband of Owner date April 25, 1990

street & number RR 2, Box 11 telephone (402) 634-2361

city or town Meadow Grove state Nebraska zip code 68752

**United States Department of the Interior  
National Park Service**

**National Register of Historic Places  
Continuation Sheet**

Section number 8 Page 2

---

Historic residential architecture in Meadow Grove, for the most part, consists of one to one-and-one-half story modest frame dwellings of vernacular design. In the Nebraska Historic Buildings Survey of Meadow Grove, only three other houses in town (MD04-12, MD04-15, MD04-18) compare to the Warrick House in the number of stories and construction material. All three dwellings are two-and-one-half stories, frame construction, and exhibit some decorative detailing. However, none attain the high degree of styling or setting of the Warrick property. The Queen Anne styling of the house, the complimentary carriage barn, and the large landscaped lot with conifer and deciduous trees, make the Warrick property a sophisticated and distinct turn-of-the-century architectural grouping.

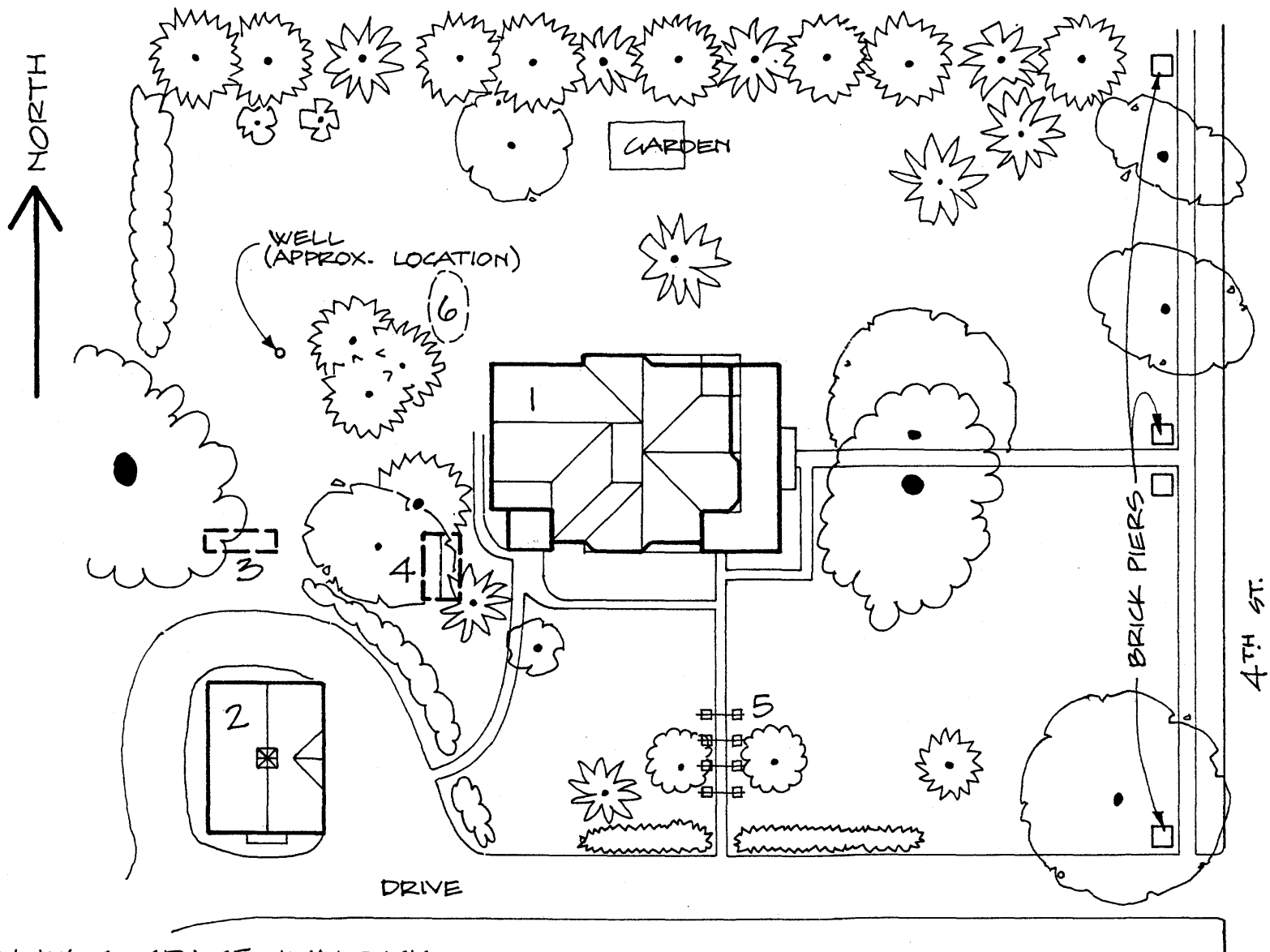

JOHN W. & GRACE WARRICK  
 HOUSE (NEHBS #MDO4-1)  
 MEADOW GROVE, NEBRASKA

SITE PLAN - NO SCALE  
 DRAWN BY DELL DARLING FROM FIELD  
 NOTES BY BOB PLUSCHENDORF  
 JUNE 1990.

- KEY
- 1. HOUSE
  - 2. CARRIAGE HOUSE / BARN
  - 3. CHICKEN HOUSE (NOT EXTANT)
  - 4. WASH HOUSE (NOT EXTANT)
  - 5. PERGOLA (NOT EXTANT)
  - 6. GOLDFISH POND (NOT EXTANT)