

FORM A - AREA

JAN 02 1990

Area Letter Form numbers in this Area

CH-F	CH-59, CH-018, CH-019
------	-----------------------

MASSACHUSETTS HISTORICAL COMMISSION  
80 BOYLSTON STREET, BOSTON, MA 02116

Town Newton (Chestnut Hill)

Name of Area (if any) Monadnock Road

Historic District

Present Use residential

General Date or Period 1890s-1930s

General Condition excellent

Acreage 1313400 sq. ft. / 30.15 A

Recorded by Candace Jenkins/Susan Abele

Organization Newton Historical Comm.

Date 6/1987; rev. 5/1988

Photos (3"x3" or 3"x5" black & white) Indicate on back of each photo street addresses for buildings shown. Staple to left side of form.

Sketch Map. Draw a general map of the area indicating properties within it. Number each property for which individual inventory forms have been completed. Label streets including route numbers, if any. Indicate north. (Attach a separate sheet if space here is not sufficient).

See attached map

UTM REFERENCE A 19/320 120 14689 190  
B 19/320 750 14689 060  
C 19/320 670 14688 730  
D 19/320 160 14688 860  
 USGS QUADRANGLE NEWTON  
 SCALE 1:25000

## NATIONAL REGISTER CRITERIA STATEMENT (if applicable)

The Monadnock Road Historic District possesses integrity of location, design, setting, materials, workmanship, feeling and association. It is significant as a reflection of Newton's rapid growth in the early 20th century, and the way in which former estates and open lands were subdivided to accommodate residential expansion. It is especially important as a cohesive and well preserved collection of early to mid-20th century houses which illustrates the styles and tastes popular during that period. The Monadnock Road Historic District meets criteria A & C of the NRHP.

## ARCHITECTURAL SIGNIFICANCE Describe important architectural features and evaluate in terms of other areas within the community.

The Monadnock Road Historic District is located in the western part of Chestnut Hill. Centered on the winding length of Monadnock Road, it also includes portions of Tudor Road, Hammond Street, Hammondswood Road, Wachusett Road and Hobart Road. The eastern half of the district is part of the area laid out as the Liggett Estate subdivision in 1924. It is a quiet, pleasant neighborhood characterized by gentle hills, curving streets intersecting at angles, and large wooded and landscaped lots, all of which combine to provide a sense of privacy for each home. The houses were largely constructed in the 1920s with some from the 1910s and 1930s as well. They are large commodious structures, some of which are near estate quality. Styles represented include Craftsman, Colonial Revival, Tudor Revival, Spanish Colonial, and a handful of older Queen Anne houses and recent modern houses. A total of sixty-three houses are included.

## HISTORICAL SIGNIFICANCE Explain historical importance of area and how the area relates to the development of other areas of the community. (see cont. sheet)

As first conceived by the Newton Boulevard Syndicate, Commonwealth Avenue (NC-B) - or the Newton Boulevard as it was then known, went only as far as Centre Street. Members of the Newton Boulevard Syndicate, which included among others Robert Bishop and several members of the Ward family, were willing to give cash and land in lieu of betterments if a route through their holdings was approved. A Boulevard Commission was established to study the project and in 1893, gave an interim report submitting the route proposed by the Newton Boulevard Syndicate to the city for surveys and estimates. The Commission's final report (which expanded the project through the city to the Charles River in Auburndale) gave Newton a major east-west road through its mid-section. In following the initial proposal of the Newton Boulevard Syndicate it opened a major portion of the city for development. Construction began in 1894 and Commonwealth Avenue was open to traffic the following year.

Almost immediately, infill in older areas of Chestnut Hill and Newton Centre, south of the new road, was stimulated and large landowners like Robert Bishop were able to begin to develop their property by the late 90s. With the exception of the Waban Hill area,

## BIBLIOGRAPHY AND/OR REFERENCES

(see cont. sheet)

INVENTORY FORM CONTINUATION SHEET

MASSACHUSETTS HISTORICAL COMMISSION  
Office of the Secretary, Boston

Community: Newton (Chestnut Hill)	Form No: CH-F
Property Name: Monadnock Road H.D.	

Indicate each item on inventory form which is being continued below.

**ARCHITECTURAL SIGNIFICANCE (cont.)**

Representative houses in the Monadnock Road Historic District are described below:

The most prevalent style in the area is the **Tudor Revival**, accounting for almost half of the houses. They are found throughout the area, but are most common on Monadnock and Tudor Roads in the actual subdivision. An excellent example of the style is provided by **112 Monadnock Road** (1927). It is a 2 1/2 story brick and half-timber structure enclosed by a slate hip roof with a facade gable and superimposed entry gable to the right. As is the case with other elaborate examples of the style, it employs cast stone as trim for the entry and for a large bank of windows spanning the first and second stories on the right facade. Another variant of the style is **107 Monadnock Road** (1923). This 2 1/2 story house is entirely clad with decorative half-timbering including curved and diamond shaped members. The facade is broken up by a dominant facade gable to the left with superimposed entry gable nearly centered on the facade. To the right is a large wall dormer and a lower roof slope which contains a sunporch. Upper story windows contain diamond pane sash adding to the surface complexity. The entry has a stone surround and is headed by a carved bargeboard more often seen on older Craftsman houses.

The **Colonial Revival** style is also well represented in the area, accounting for nearly a third of the houses. Most are well-developed two story five bay examples but Capes, Garrisons and Dutch Colonials are also found in limited numbers. The most elaborate example of the style and one which is individually outstanding is **59 Wachusett Road** (1918). Set on a rock faced hill and fronted by a balustraded terrace, it is a five bay brick structure rising two stories to a slate gable roof with pedimented dormers. It is trimmed with a heavy beltcourse separating the stories with quoins at the corners and at the slightly recessed center bay. The entry is treated with a balustraded porch with columns and carved consoles as supports. Windows contain 6/6 sash and are headed by splayed brick lintels with cast stone keystones. A balustraded sunporch projects from the left side to the plane of the terrace. Another good example is **137 Monadnock Road** (1927) which is also a large five bay brick structure rising two stories to a slate gable roof. Its entry is treated with sidelights and a Doric frieze beneath a lintel shelf, and is flanked by full length windows with arched heads. A typical Dutch Colonial is found at **50 Wachusett Road** (1906). Several Colonial/Craftsman hybrids exist as well. One is the two story stucco clad house at **63 Monadnock Road** (1906). Its stucco cladding, bracketed roof and pergola sunporch are all typical Craftsman features, but its entry with engaged Ionic columns supporting a pulvinated frieze and a heavy segmental pediment with modillions is pure Colonial Revival of the best quality. The most atypical example of the style is the

Staple to Inventory form at bottom

INVENTORY FORM CONTINUATION SHEET

MASSACHUSETTS HISTORICAL COMMISSION  
Office of the Secretary, Boston

D. 2 01 3	NEWTON, MASSACHUSETTS
Community: Newton (Chestnut Hill)	Form No: CH-F
Property Name: Monadnock Road H.D.	

Indicate each item on inventory form which is being continued below.

Architectural Significance (cont.)

Spanish Colonial house at **21 Monadnock Road** (1910). Although it is not an outstanding example, it does employ the typical stucco clad wall surfaces, red tile roof on carved brackets and arched windows.

The **Craftsman** style is encountered less commonly, and often it is combined with Colonial or Tudor features. Almost all are stucco clad. Two similar examples are found at **11 Tudor Road** (1923) and **150 Monadnock Road** (1919). Both are the broad clipped gable end type found in limited numbers in several subdivisions. The Tudor Road house has a brick first story and stuccoed second story separated by a pent roof. The center entry has a Colonial surround with sidelights and a pedimented hood on consoles (see also 108 Hammond Street). The Monadnock Road house is entirely stucco clad and lack the pent roof. Its entry is treated with sidelights and a half-timbered pediment on Tuscan columns

**Verbal Boundary Description and Justification:** The Monadnock Road Historic District in western Chestnut Hill, contains 63 houses and 3 vacant lots on Mondanock Road, Tudor Road, Hammond Street, Hammondswood Road, Wachusett Road and Hobart Road. Boundaries are the lot lines of these properties as shown on the attached Engineering Map. The boundaries are drawn to recognize the unusually cohesive nature of this stylish residential area. Less distinguished and later buildings are excluded on all sides.

**HISTORICAL SIGNIFICANCE (cont.)**

development of property on the northside of Commonwealth Avenue up to Centre Street, much of it owned by the Ward family, was somewhat slower. After the turn-of-the-century the pace of development began to pick up; by the explosive period of the 1920s new subdivisions lay on both sides of Commonwealth Avenue. Development along Commonwealth Avenue itself moved generally from east to west and was also virtually completed by the late 1920s.

The Monadnock Road Historic District grew out of an 1895 subdivision drawn by Olmsted, Olmsted and Elliot for the Newton Boulevard Syndicate. Montvale Road and Terrace, which were part of the Syndicate plan, were built up before the turn of the century, but much of Monadnock and Wachusett Roads remained in flux and did not develop until the

Staple to Inventory form at bottom

INVENTORY FORM CONTINUATION SHEET

MASSACHUSETTS HISTORICAL COMMISSION  
Office of the Secretary, Boston

Community: Newton (Chestnut Hill)	Form No: CH-F
Property Name: Monadnock Road H.D.	

Indicate each item on inventory form which is being continued below.

Historical Significance (cont.)

teens and twenties. Most of the area was owned by syndicate member Robert Bishop who also owned all the property in the abutting Gray Cliff Expanded Historic District (NC-O)

The Monadnock Road Historic District includes part of the adjacent Liggett Estate, which was owned by Drug Store magnate Louis K. Liggett from 1916 to 1937. Liggett had begun to develop portions of his estate in 1919 and 1923, in the area of Tudor Road and the extension of Monadnock Road from Hammondswood Road. In 1941, after his death, the remainder of the estate and the house, which was modeled after a Welsh manor house (1895; Chapman and Frazer, architects), was given by Cardinal O'Connell to Boston College and became known as O'Connell Hall. It is now surrounded by several dormitories which occupy the east side of Tudor Road abutting the District.

A large number of well know local and Boston architects were responsible for commissions in this area. Houses developed by Louis Liggett, including **11 Tudor Road** and **107 Monadnock Road**, were designed by the well known Boston firm of Haven & Hoyt. Houses developed by the Cragie Realty Trust or the Nutting Realty Trust (trustees were the same in both cases) were designed by Newton architect Hawley W. Morton. These included **52, 84, and 104 Hammondswood Road, 45 Tudor Road, and 93, 96, 106, 112, 122, and 129 Monadnock Road**. (Real estate developer W. Mark Noble lived in the house at 122 Monadnock Road.) Architect Oscar Thayer designed the house at **10 Monadnock Road** which appeared in *The House Beautiful* September 1915. Architect Henry Richmond presumably designed his own house, built in c. 1906 at **63 Monadnock Road**. Harry Morton Ramsay designed houses at **71 and 72 Monadnock Road** and Newhall & Blevins designed **71 Hammondswood Road**. **59 Wachusett Road** was designed by F. J. Robinson. Other architects working in the area included Peare & Quiner, W. J. Freethy, Krokyn & Browne, Royal Barry Wills, David J. Abrahams, and George H. Sidebottom.

**BIBLIOGRAPHY/REFERENCE**

Engineering Dept. Records: N-53-. 16364 (1919), N-56. 18237 (1923)  
Build. Dept. Rec: Hammondswood Rd, Tudor Rd, Wachusett Rd, Monadnock Rd.  
City Directories and Atlases, *COPAR Directory*, *Biographical Dictionary*, *Withy Newton's 19th Century Architecture*, *Newton Centre*, *Oak Hill*, *Chestnut Hill*, *Comm. Ave.*

NEWTON, MASS. - MRA : PHOTOGRAPH FROM BEAUTIFUL NEWTON, NEWTON  
GRAPHIC PUBLISHING CO., NEWTON, MASS., n.d.



RESIDENCE OF FREDERIC F. CUTLER, HOBART ROAD, NEWTON CENTRE.

244 117 HOBART ROAD

NEWTON, MASS. - MRA : PHOTOGRAPH FROM NEWTON WAR MEMORIAL  
NEWTON GRAPHIC PUBLISHING CO., NEWTON, MASS., n.d.



W. MARK NOBLE, JR.  
ONE TWENTY TWO MONADNOCK ROAD NEWTON CENTRE

INVENTORY FORM CONTINUATION SHEET

MASSACHUSETTS HISTORICAL COMMISSION  
Office of the Secretary, Boston

Community: <i>Newton</i>	Form No: <i>CH-F</i>
Property Name:	

Indicate each item on inventory form which is being continued below.

Staple to Inventory form at bottom

INVENTORY FORM CONTINUATION SHEET

MASSACHUSETTS HISTORICAL COMMISSION  
Office of the Secretary, Boston

Community: <i>Newton</i>	Form No: <i>CH-E</i>
Property Name:	

Indicate each item on inventory form which is being continued below.

Staple to Inventory form at bottom

NEWTON, MASS. MRA - 1988 - MORADNOCK ROAD HISTORIC DISTRICT

Page 1 of 4

<u>Street Address</u>	<u>SBL</u>	<u>Area(sf)</u>	<u>Historic Name</u>	<u>Form#</u>	<u>Date</u>	<u>Style</u>	<u>Status</u>
	61-6-4	19289	Vacant lot				
	61-15-8	5434	Vacant Lot				
	61-7-3	14498	Vacant Lot				
	61-16-3	7442	Vacant Lot				
419 Beacon St.	61-17-1	29100	house garage		1923	Tudor	c c
501 Beacon St.	61-20-1	21404	house w/attached garage		1925	Tudor	c
87 Hammond St.	61-15-9	30040	house carriage house	CH-59	1898	Ch.	c c
100 Hammond St.	61-13-1	14067	house w/attached garage		1929	Tudor	c
101 Hammond St.	61-16-11	20418	house w/attached garage		1927	Tudor	c
108 Hammond St.	61-13-21	19225	house w/attached garage		1923	Eclectic	c
132 Hammond St.	61-12-24	13230	house w/attached garage		1928	Tudor	c
146 Hammond St.	63-13-1	18077	house		1929	Tudor	c
52 Hammondswood Rd.	61-16-10	14863	house w/attached garage		1928	Tudor	c
71 Hammondswood Rd.	61-18-8	15745	house w/attached garage pool		1924	CR	c n
83 Hammondswood Rd.	61-18-9	14540	house w/attached garage		1928	CR	c
84 Hammondswood Rd.	61-17-10	19686	house w/attached garage		1928	Tudor	c
94 Hammondswood Rd.	61-17-9	20073	house garage		1928	Tudor	c c
99 Hammondswood Rd.	61-19-1	13940	house w/attached garage		1928	Tudor	c
104 Hammondswood Rd.	61-17-8	22135	house w/attached garage		1929	Tudor	c
111 Hammondswood Rd.	61-19-2	12314	house w/attached garage		1928	Tudor	c
107 Hobart Rd.	61-6-1	10729	house		1899	QA	c
117 Hobart Rd.	61-6-2	29577	house garage		1911	CR	c c
142 Hobart Rd.	61-7-6	22300	house w/attached garage		1916	Tudor	c
143 Hobart Rd.	61-6-6	19606	house garage		1910	Craftsman	c c
155 Hobart Rd.	61-6-5	74022	house w/attached garage		1920	Tudor	c

NEWTON, MASS. MRA - 1988 - MONADNOCK ROAD HISTORIC DISTRICT

158	Hobart Rd.	61-18-1	27893	house w/attached garage		1916	CR	c
168	Hobart Rd.	61-18-16	19720	house garage		1923	CR	c
185	Hobart Rd.	61-21-13	11510	house w/attached garage		1927	Tudor	c
193	Hobart Rd.	61-21-14	10390	house w/attached garage		1927	Tudor	c
194	Hobart Rd.	61-20-4	26396	house		1928	Eclectic	c
15	Hobart Terrace	61-6-3	50480	house garage		1908	Craftsman	c
126	Manet Rd.	61-21-1	12930	house garage		1916	CR	c
4	Monadnock Rd.	61-8-11	30900	house garage		1897	Craftsman	c
10	Monadnock Rd.	61-8-10	17349	house w/attached garage	CH-018	1914	CR	c
11	Monadnock Rd.	61-7-1	17030	house w/attached garage		1952	Modern	nc
20	Monadnock Rd.	61-8-9	19082	house garage		1897	QA	c
21	Monadnock Rd.	61-7-2	14050	house		1910	Craftsman	c
28	Monadnock Rd.	61-8-8	12527	house		1897	QA	c
34	Monadnock Rd.	61-6-7	14010	house w/attached garage		1939	CR	nc
45	Monadnock Rd.	61-7-4	17600	house w/attached garage		1916	CR	c
56	Monadnock Rd.	61-15-3	25109	house w/attached garage		1926	Tudor	c
63	Monadnock Rd.	61-18-6	12993	Henry P. Richmond House		1906	CR/Crafts.	c
71	Monadnock Rd.	61-18-7	13577	house w/attached garage		1927	Tudor	c
72	Monadnock Rd.	61-15-2	11086	house w/attached garage		1926	Tudor	c
80	Monadnock Rd.	61-15-1	15027	house w/attached garage		1948	Modern	nc
93	Monadnock Rd.	61-17-11	20481	house w/attached garage		1928	Tudor	c
96	Monadnock Rd.	61-16-9	16400	house w/attached garage		1928	Tudor	c
106	Monadnock Rd.	61-16-8	19220	house w/attached garage		1927	Tudor	c
107	Monadnock Rd.	61-17-12	16620	house w/attached garage		1923	Tudor	c
112	Monadnock Rd.	61-16-7	19130	house w/attached garage outbuilding		1927	Tudor	c

## NEWTON, MASS. MRA - 1988 - MONADNOCK ROAD HISTORIC DISTRICT

				pool					
121	Monadnock Rd.	61-17-15	18050	house w/attached garage pool/cabana		1936	CR		
122	Monadnock Rd.	61-16-6	13170	house w/attached garage	CH-019	1927	Tudor		
129	Monadnock Rd.	61-17-14	20928	house w/attached garage		1928	Tudor		
137	Monadnock Rd.	61-17-15	37722	house arbor		1927	CR		
145	Monadnock Rd.	61-17-3	30740	house garage		1924	Tudor		
				outbuilding					
150	Monadnock Rd.	61-16-5	32802	house garage		1919	Tudor		
				outbuilding					
				garden house					
3	Montvale Rd.	61-5-16	16200	house garage		1920	Eclectic		
19	Montvale Rd.	61-5-17	9015	house garage		1917	CR		
11	Tudor Rd.	61-16-1	21968	house w/attached garage		1923	Crafts./CR		
27	Tudor Rd.	61-16-2	19738	house w/attached garage pool		1925	Tudor		
45	Tudor Rd.	61-16-4	17201	house w/attached garage		1928	Tudor		
25	Wachusett Rd.	61-18-5	14606	house w/attached garage		1911	Shingle		
38	Wachusett Rd.	61-18-5	10000	house w/attached garage		1925	CR		
46	Wachusett Rd.	61-18-4	11400	house w/attached garage		1906	Dutch		
50	Wachusett Rd.	61-18-3	22412	house garage		1906	CR		
59	Wachusett Rd.	61-7-5	15642	house garage		1918	CR		
60	Wachusett Rd.	61-18-2	28562	house		1929	Tudor		

NEWTON, MASS. MRA - 1988 - HONADNOCK ROAD HISTORIC DISTRICT

garage

Number of buildings	63	
Number of contributing buildings	59	Sum of square feet in field "area"
Number of non-contributing buildings	4	(Streets not included)
Number of structures	25	Number of vacant lots (4)
Number of contributing structures	17	
Number of non-contributing structures	9	
Number of contributing objects	1	

1313400  
30.15A

United States Department of the Interior  
National Park Service

National Register of Historic Places  
Inventory—Nomination Form

For NPS use only  
received 1/22/86  
date entered

Continuation sheet

Item number

Page

Multiple Resource Area  
Thematic Group

Name Newton MRA  
State Middlesex County, MA

Nomination/Type of Review

Date/Signature

121. Whittemore's Tavern--  
Bourne House

Entered in the  
National Register

for Keeper

Melrose Byers 9/4/86

Attest

122. Working Boys Home

Entered in the  
National Register

for Keeper

Melrose Byers 9/4/86

Attest

123. Brae-Burn Historic District

Entered in the  
National Register

for Keeper

Melrose Byers 2/16/90

Attest

124. Commonwealth Avenue Historic District

Entered in the  
National Register

for Keeper

Melrose Byers 2/16/90

Attest

125. Day Estate Historic District

Entered in the  
National Register

for Keeper

Melrose Byers 2/16/90

Attest

126. Gray Cliff Historic District  
(Boundary Increase)

Entered in the  
National Register

for Keeper

Melrose Byers 2/16/90

Attest

127. Monadnock Road Historic District

Entered in the  
National Register

for Keeper

Melrose Byers 2/16/90

Attest

128. Morton Road Historic District

Entered in the  
National Register

for Keeper

Melrose Byers 2/16/90

Attest

\* 129. Newton Highlands Historic District  
(Boundary Increase)

for Keeper

Bobby L. Savage 02/16/90

Attest

\* 130. Newtonville Historic District  
(Boundary Increase)

Richard A. Davison

for Keeper

Bobby L. Savage 2/16/90

Attest

UNITED STATES DEPARTMENT OF THE INTERIOR  
NATIONAL PARK SERVICE

NATIONAL REGISTER OF HISTORIC PLACES  
EVALUATION/RETURN SHEET

REQUESTED ACTION: NOMINATION

PROPERTY NAME: Monadnock Road Historic District

MULTIPLE NAME: Newton MRA

STATE & COUNTY: MASSACHUSETTS, Middlesex

DATE RECEIVED: 1/02/90      DATE OF PENDING LIST: 1/16/90  
DATE OF 16TH DAY: 2/02/90      DATE OF 45TH DAY: 2/16/90  
DATE OF WEEKLY LIST:

REFERENCE NUMBER: 90000019

NOMINATOR: STATE

REASONS FOR REVIEW:

APPEAL: N DATA PROBLEM: N LANDSCAPE: N LESS THAN 50 YEARS: N  
OTHER: N PDIL: N PERIOD: N PROGRAM UNAPPROVED: N  
REQUEST: N SAMPLE: N SLR DRAFT: N NATIONAL: N

COMMENT WAIVER: N

ACCEPT     RETURN     REJECT    2/16/90 DATE    Entered in the  
National Register

ABSTRACT/SUMMARY COMMENTS:

RECOM./CRITERIA \_\_\_\_\_  
REVIEWER \_\_\_\_\_  
DISCIPLINE \_\_\_\_\_  
DATE \_\_\_\_\_

DOCUMENTATION see attached comments Y/N see attached SLR Y/N

CLASSIFICATION

count  resource type

STATE/FEDERAL AGENCY CERTIFICATION

FUNCTION

historic  current

DESCRIPTION

architectural classification  
 materials  
 descriptive text

SIGNIFICANCE

Period Areas of Significance--Check and justify below

Specific dates Builder/Architect  
Statement of Significance (in one paragraph)

- summary paragraph
- completeness
- clarity
- applicable criteria
- justification of areas checked
- relating significance to the resource
- context
- relationship of integrity to significance
- justification of exception
- other

BIBLIOGRAPHY

GEOGRAPHICAL DATA

acreage  verbal boundary description  
 UTM's  boundary justification

ACCOMPANYING DOCUMENTATION/PRESENTATION

sketch maps  USGS maps  photographs  presentation

OTHER COMMENTS

Questions concerning this nomination may be directed to

Phone \_\_\_\_\_

Signed \_\_\_\_\_

Date \_\_\_\_\_



Leiggett Estate ~~HD~~ / Monadnock Rd HD  
107 Monadnock Rd  
Newton, MA  
Newton, MA-MRA

C. Jenkins  
5/87  
neg. C Jackson Homestead  
mead

5/11-18



Seggett Estate ~~H.D.~~ / Monadnock Rd. HD  
150 Monadnock Rd.  
Newton, MA  
Newton, MA-MRA

C. Jenkins

5/87

neg @ Jackson Homestead

view

87/11 - 16



Liggett Estate ~~HD~~ / Mondnock Rd 170  
Newton, MA-MRA  
59 Wachusett Rd.  
Newton, MA

C. Jenkins  
5/87  
neg. @ Jackson Homestead  
uses

8/11-20



Liggett Estate ~~Head~~ / Monadnock Rd. H.D.  
63 Monadnock Rd.  
Newton, MA

Newton, MA-MRA

C. Jenkins

5/87

reg@Jackson Homestead

view

82/11-19



Leggett Estate #~~1~~ of Monadnock Rd. H.D.

Newton, MA-MRA

10 Monadnock Rd.  
Newton, MA

C. Jenkins

4/87

req. @ Jackson Homestead  
Inns - North

GH-018

87/8-33

Newton, MA-MRA

Monadnock Road Historic District  
Engineering Map 1979  
Scale: 1"=1000" Reduced  
Page: 75, 76, 91, 92

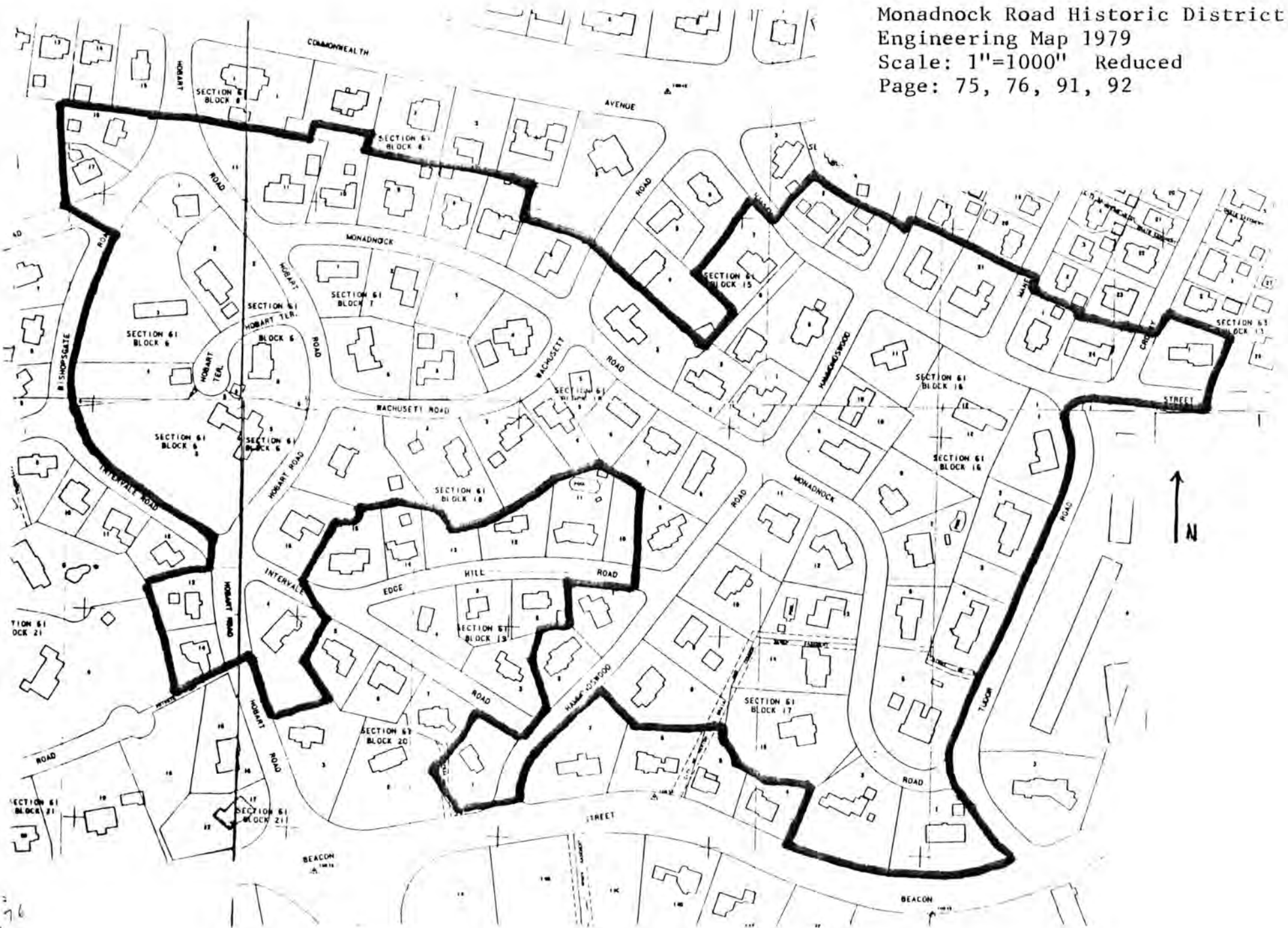

75, 76  
-16, 92