

ARIZONA STATE HISTORIC PROPERTY INVENTORY

IDENTIFICATION

SURVEY AREA NAME: Phoenix Commercial
 HISTORIC NAME: Anchor Manufacturing Co.
 ADDRESS/LOCATION: 551 S. Central
 CITY/TOWN: Phoenix
 TAX PARCEL NUMBER: 112/26/55, 57
 OWNER: Lisa Marie Fink
 OWNER ADDRESS: 706 S. Central
Phoenix, AZ 85004
 HISTORIC USE: auto body & iron work
 PRESENT USE: vacant
 BUILDING TYPE: Commercial/
 STYLE: 20th Century Commercial
 CONSTRUCTION DATE: 1928 (both bays)
 ARCHITECT/BUILDER: unknown
 INTEGRITY: original site/ altered minor
 CONDITION: fair/cosmetic problems

COUNTY: Maricopa SURVEY SITE: 41-3
 USGS QUAD: Phoenix
 T 1N R 3E S 8 S 1/2 1/4 OF THE 1/4
 UTM Zone 12 Easting 400295 Northing 3700650

Description (contd.)

ROOF TYPE: gabled
 ROOF SHEATHING: V-groove metal
 EAVES TREATMENT: parapet S & W
 WINDOWS: 1 light wood awning
 ENTRY: 2 entrances face Central.
corner-modified
 PORCHES: n/a

DESCRIPTION

STORIES: 1 DIMENSIONS: (l) 100(w) 150
90 X 125
 STRUCTURAL MATERIAL: brick & wood
concrete bond beam above storefronts
 FOUNDATION MATERIAL: concrete
 WALL SHEATHING: corrugated metal E & N
wire cut brick S & W facades
 APPLIED ORNAMENT: part of an early garage
door N. bay, tinted mortar

STOREFRONTS: wood frames with transoms
display windows, remodeled with concrete
 NOTABLE INTERIOR: trusses
 OUTBUILDINGS: n/a
 ALTERATIONS: building: corner - early
storefronts

PHOTOGRAPH

PHOTOGRAPHER: C. Mercer
 DATE: August 1983 VIEW: NE
 NEGATIVE NUMBER: PC Roll 10, Frame 6

SKETCH MAP:

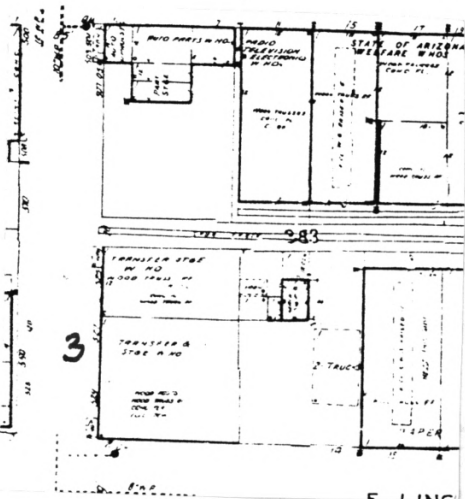

ADDITIONAL DESCRIPTION/ANALYSIS (annotated form):

Building was built as 2 bays each with its own entrance, for each of the 2 distinct services offered by the company.

SIGNIFICANCE:

AREAS OF SIGNIFICANCE: COMMERCE COMMUNITY PLANNING _____ ECONOMICS _____
EXPLORATION/SETTLEMENT _____ GOVERNMENTAL _____ MILITARY _____ RELIGION _____ SCIENCE _____
THEATRE _____ TRANSPORTATION _____ TOURISM _____ OTHER(specify) _____

HISTORIC ASSOCIATIONS (be concise):

PROMINENT OCCUPANT/HISTORIC ASSOCIATION(S) Anchor Mfg. company which built, and first occupied this building, constructed the decorative iron works for many of Arizona's significant
RELATIONSHIP TO LOCAL DEVELOPMENT (continued below)

CULTURAL AFFILIATIONS _____

ARCHITECTURAL STYLE Unique example of 20th Century Commercial structure.

MAJOR ARCH. FORM/MATERIAL The building is a unique solution for the storefront form:
(continued below)

ENGINEERING/STRUCTURAL _____

DISTRICT/STREETScape CONTRIBUTION _____

DISCUSSION AS REQUIRED: (Historic Associations, cont.)
buildings and residences, including the Orpheum Theatre, Phoenix, and Sacred Heart Church, Nogales.

Features tinted mortar, stepped parapets and band beams.
(Major Arch. Form/Material) continued.

the brick storefront is integrated with the wood and steel space enclosures behind.
See MRA text, Item 8, pages 38,71.

CONTEXT: ISOLATED/RURAL _____ RESIDENTIAL STREET _____ COMMERCIAL CENTRAL SQUARE _____
CBD: _____ OTHER: Strip

BIBLIOGRAPHY/SOURCES:

Phoenix Directory

Arizona Republic : 6/24/28, Sec. 3, 1:2

LISTING IN OTHER SURVEYS: _____

NATIONAL REGISTER STATUS:
LISTED _____ DETERMINED ELIGIBLE _____ DETERMINED NOT ELIGIBLE _____ NOT EVALUATED _____

COMMENTS/DEVELOPMENT PLANS/THREATS:

SURVEYOR J. Garrison etal SURVEY DATE May 1984 DATE FORM COMPLETED May 1984



Historic Commercial Properties of Phoenix -

Thematic

Site #41-3 (Anchor Manufacturing Company)

Supplemental photo #1

Photo by William J. Perreault

Date: June 1985