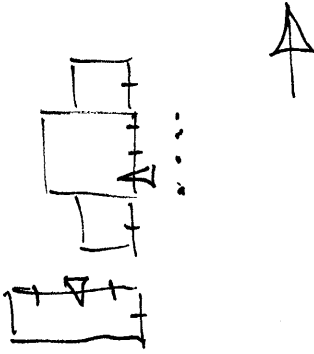

KENTUCKY HISTORIC RESOURCES INVENTORY

Js-N-12

1. Historic Name (s) <u>Silver Hill/McConnell-Woodson-Phillips house</u>		22. ADD/County <u>Bluegrass/Jessamine</u> <input type="checkbox"/>	
Original Owner <u>William B. McConnell</u>		23. Zoning Classification <u>Magisterial District</u>	
Present Name <u>Judge Phillips house</u>		24. U.S.G. S. Quadrant (15'/75') <u>Nicholasville</u>	
3. Owner's Name <u>Dr. Joseph Swintosky</u>		25. UTM Reference <u>116</u> <u>7113320</u> <u>4194760</u> Zone Easting Northing	
4. Owner's Address <u>303 S. Main Street, Nicholasville 40356</u>		26. Prehistoric Site <u>Historic Site</u> Object <u>Building</u> Structure	
5. Location <u>303 S. Main Street, Nicholasville</u>		27. District Name: Yes <u>No</u>	
6. Open to Public Yes <u>No</u>		28. Significance Evaluation <u>National Register</u>	
7. Visible from road Yes <u>Yes</u> No		29. Status National Landmark <input type="checkbox"/> Date _____ National Register <input type="checkbox"/> _____ Landmark Certificate <input type="checkbox"/> _____ Kentucky Survey <input type="checkbox"/> _____ Local Landmark <input type="checkbox"/> _____ HABS/HAER <input type="checkbox"/> _____	
8. Ownership Private <input checked="" type="checkbox"/> Local <input type="checkbox"/> State <input type="checkbox"/> Federal <input type="checkbox"/>		30. Theme Primary <u>architecture</u> <input type="checkbox"/> Secondary <u>women's movement</u> <input type="checkbox"/> Other <input type="checkbox"/>	
9. Local Contact/Organization		31. Endangered Yes <input type="checkbox"/> <u>No</u>	
10. Site Plan with North Arrow 		11. Architect	
See Attached Sheet		12. Builder	
		13. Date <u>c. 1850;</u> <u>from pre- 1812*</u>	
		14. Style <u>Federal; Gothic</u> <input type="checkbox"/>	
		15. Original Use <u>house (two)</u>	
		16. Present Use <u>house; storage</u>	
		17. Condition <input type="checkbox"/> Interior <input type="checkbox"/> Exterior <u>good/altered</u>	
18. Description <u>Three-part composition; Flemish bond central block is 2-story, 3-bay, side passage plan belt course; 1-story wings in American bond; c. 1908 remodeling included addition of portico, roof balustrades (window &amp; door trim?) and window lengthening; interior end chimneys; frame house adjacent to south is board-and-batten, central passage, with central gable and pointed-arch and trefell windows.</u>		32. <u>ATTACH PHOTO</u>	
19. History <u>* Birthplace of Dr. Lena Phillips, 15 September 1881; she was founder of Business and Professional Women's Clubs in 1919 and 1st president of International B. &amp; P. W. in 1930; Samuel Hughes Woodson bought house in 1812 from McConnell; Woodson was the 1st County Clerk, a State Representative and a US representative.</u>		Roll No. <u>36-37</u> Picture No. _____ Direction _____	
20. Significance <u>Politics/Government: Samuel Woodson, a former owner, was an early prominent political figure, serving as the first county clerk and later as a state and U.S. representative.</u> <u>Architecture: these houses illustrate a particularly striking juxtaposition of styles; in the brick are found</u>		33. Tape No. _____ Negative No. _____ 34. Prepared by: <u>NCP - KTG</u>	
21. Source of Information <u>Federal and Colonial Revival styles - the frame Gothic house provides further stylistic variations.</u>		35. Organization <u>KHC</u> 36. Date <u>summer 1977</u>	
*Lexington <u>Herald-Leader</u> , B. L. Mastin; 1971 survey form; historic marker.		37. Revision Dates _____ 38. Staff Review _____	

KENTUCKY HISTORIC RESOURCE INVENTORY SUPPLEMENT  
BOUNDARY AND LOCATION INFORMATION

Historic Property Name William B. McConnell house Site # JA 712  
Multiple Resource/Thematic Nomination Title Jessamine Co.

U.T.M. Coordinates - List multiple UTMs if property is ten or more acres.

A. 16 713320 4194760 D. \_\_\_\_\_  
B. \_\_\_\_\_ E. \_\_\_\_\_  
C. \_\_\_\_\_ F. \_\_\_\_\_

Verbal Boundary Description Acreage 1.7 acres

Beginning at A, at S. Main Street at the corner of a side street and the property, thence S 370 ft to a rock fence at B, thence outside said fence, N 200 ft to C, thence N along driveway to D at a corner of the property, thence with property line to E and F at the side street, and with said street to the beginning.

Sketch of Site Plan (Showing outbuildings, structures, landscape features and the site boundary as described above.)

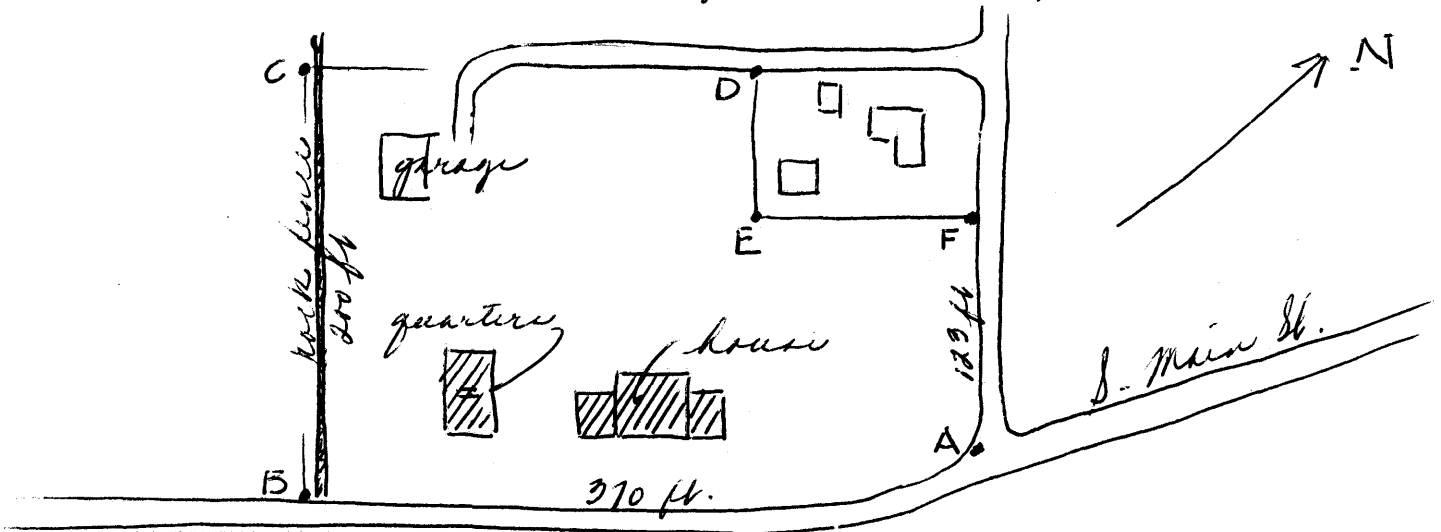

Official Courthouse Property Reference: