



Historic Sites Survey Inventory No. 6

ARCHITECTURAL DESCRIPTION: The Hall-Henderson House is a one-and-a-half story, gable/hip roofed, Queen Anne house on a residential corner lot facing west. The central steeply-pitched hipped roof is interrupted by a steeply-pitched gable which features decorative paneling and a wheel window. Gabled pavilions are located at the northwest and southeast corners. A shallow hip-roofed wrap-around porch with turned posts and balusters and pierced brackets shields the main entrance which consists of a single-leaf door surmounted by a transom. The fenestration on the first story consists of triple-hung floor-to-ceiling windows and four-over-four double-hung sash. The northwestern pavilion has a highly ornamented gable featuring wooden latticework and three corbeled brackets which surmount two square one-light windows. This decorative motif is also on the gable of the southeast pavilion. The front pavilion also features a flat-roofed square bay window with four-over-four double-hung sash components defined by applied and indented panels. The Hall-Henderson House of Sardis is identical to the Tait-Taylor House of Como and has been documented as being constructed in 1892 (Sanborn Maps). Another identical residence was

(continued)

ALTERATIONS:

None

OUTBUILDINGS:

None extant

LANDSCAPE FEATURES:

house is sheltered from enclosing street by densely grouped trees.

STATEMENT OF SIGNIFICANCE:

Along with the Tait-Taylor House, the Hall-Henderson House is a transitional building coming between the L-shaped cottages of the 1880s and the pre-dominantly two-story Queen Anne/Colonial Revival houses of the early 1900s. The Hall-Henderson House retains many of Johnson's finest design features: the square-cut bay windows, ornamental gables, and gallery details.

NAME: Hall-Henderson House ✓
 STREET NO: Sycamore Street ✓
 TOWN/VIC: Sardis ✓
 COUNTY: Panola ✓
 BLOCK/LOT: See Verbal Boundary Description
 PRESENT OWNER: Mrs. H. C. Ford
 ADDRESS 208 Sycamore Street, Sardis, Mississippi 38666
 PRESENT USE: Residence
 FORMER USE: Residence
 DATE: Ca. 1892
 STYLE: Vernacular Queen Anne
 ARCH/BUILDER: Andrew Johnson
 SOURCE OF DATE: Identical house in Como-documented 1892, Sanborn Maps - Johnson family tradition
 ENVIRONMENT: Residential
 LEVEL OF SIGNIFICANCE
 NEIGHBORHOOD
 LOCAL
 STATE X
 NATIONAL

PHOTOS

NEG. #

SITE OR AREA PLAN WITH NORTH ARROW AND SHAPE OF STRUCTURE

SACAMORE

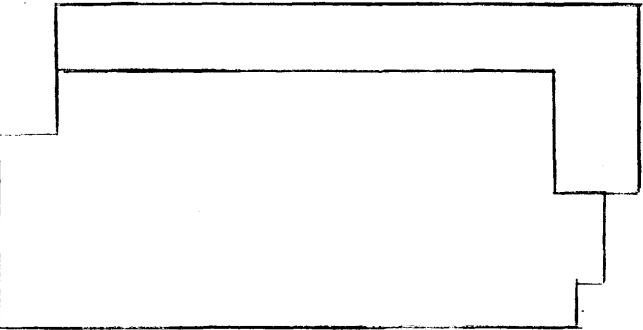

CONTINUATION:

ARCHITECTURAL DESCRIPTION

constructed in Longtown (Panola County) for J. G. Goodwin. The Goodwin House was later destroyed by fire. Stylistic traits of Andrew Johnson's 1890s work are the square-cornered wrap-around porches, the square-cut bay windows with applied and indented panels, and the decorative gables.

PHYSICAL CONDITION:

Good

THREATS:

None

VERBAL BOUNDARY DESCRIPTION:

R. W. Crump Survey of 1871, Town of Sardis
 Res and all lot 1 Except Fraction of NW corner Block 25,
 Sec 26 T7 R7

ACREAGE: less than one

UTM REF:

A	<u>1</u> <u>6</u>	<u>2</u> <u>3</u> <u>2</u> <u>1</u> <u>5</u> <u>0</u>	<u>3</u> <u>8</u> <u>1</u> <u>4</u> <u>1</u> <u>5</u> <u>0</u>
	ZONE EASTING		NORTHING
C	<u> </u>	<u> </u> <u> </u> <u> </u> <u> </u> <u> </u> <u> </u> <u> </u> <u> </u> <u> </u> <u> </u> <u> </u> <u> </u>	<u> </u> <u> </u> <u> </u> <u> </u> <u> </u> <u> </u> <u> </u> <u> </u> <u> </u> <u> </u> <u> </u> <u> </u> <u> </u>
B	<u> </u>	<u> </u> <u> </u> <u> </u> <u> </u> <u> </u> <u> </u> <u> </u> <u> </u> <u> </u> <u> </u> <u> </u> <u> </u>	<u> </u> <u> </u> <u> </u> <u> </u> <u> </u> <u> </u> <u> </u> <u> </u> <u> </u> <u> </u> <u> </u> <u> </u> <u> </u>
	ZONE EASTING		NORTHING
D	<u> </u>	<u> </u> <u> </u> <u> </u> <u> </u> <u> </u> <u> </u> <u> </u> <u> </u> <u> </u> <u> </u> <u> </u> <u> </u>	<u> </u> <u> </u> <u> </u> <u> </u> <u> </u> <u> </u> <u> </u> <u> </u> <u> </u> <u> </u> <u> </u> <u> </u> <u> </u>

FORM PREPARED BY:

P. Ana Gordon, Historian
 Mississippi Department of Archives and History

DATE

Jan. 1983