



United States Department of the Interior

NATIONAL PARK SERVICE
1849 C Street, N.W.
Washington, D.C. 20240

The attached property, the Ames Hitchens Chicken Farm, as part of the Nanticoke Indian Community, in Sussex County, Delaware, reference number 79003311, was listed in the National Register of Historic Places by the Keeper of the National Register on 4/26/1979, as evidenced by the FEDERAL REGISTER/WEEKLY LIST notice of Tuesday, March 18, 1980, Part II, Vol.45, No. 54, page 17451. The attached nomination form is a copy of the original documentation provided to the Keeper at the time of listing.

Keeper of the National Register of Historic Places

9/8/2008
Date

UNITED STATES DEPARTMENT OF THE INTERIOR
NATIONAL PARK SERVICE

FOR NPS USE ONLY

RECEIVED

DATE ENTERED

**NATIONAL REGISTER OF HISTORIC PLACES
INVENTORY -- NOMINATION FORM**

Nanticoke Indian Community

CONTINUATION SHEET

ITEM NUMBER 7

PAGE 3

One may expect a high degree of similarity in the tools and activities related to farming (an essentially commercial activity) and lower degree of similarity in subsistence-related activities.

Acroage: 3 acres

Verbal Boundary Description: The farmhouse, log corncribs and associated structures are surrounded by cultivated fields. The nominated property includes only the house and outbuilding complex.

UTM: 18/482280/4273140

4. Warren T. Wright Farmhouse Site (S-758)

Location: North site of Route 24 about one quarter mile south of the intersection of Route 24 and County Road 297.

Description: Although recently destroyed by fire, early photographs indicate that the Warren T. Wright Farmhouse closely resembled the Robert Davis Farmhouse and may have been built by the same carpenter. The remains are partially visible. No alteration has been made to the site since the demolition of the farmhouse.

Significance: The Warren T. Wright Farmhouse Site offers the opportunity to study the degree of material assimilation exhibited by separatist Indian farmers in the early-twentieth century when the community was undergoing "consciousness-raising" as a result of the studies of Frank G. Speck in the Indian River area. Warren Wright was a leader in the nativist movement of the period. Expected data categories are the same as for the Robert Davis Farmhouse.

Acroage: One acre.

Verbal Boundary Description: A one acre plot of unplowed land surrounded by cultivated fields and private residences.

UTM: 18/481940/4273390

5. Ames Hitchens Chicken Farm (S-755)

Location: North of Route 24, approximately 200 yards behind Harmony Church.

Description: The chicken farm of Ames Hitchens is composed of a two-story, wood frame, gable-front structure with living quarters and two long, one-story, flat-roof buildings, used as chicken houses. The two-story structure is covered

FORM AS SUBMITTED TO O.A.H.P.

UNITED STATES DEPARTMENT OF THE INTERIOR
NATIONAL PARK SERVICE

FOR NPS USE ONLY

RECEIVED

DATE ENTERED

NATIONAL REGISTER OF HISTORIC PLACES
INVENTORY -- NOMINATION FORM

Nanticoke Indian Community

CONTINUATION SHEET

ITEM NUMBER 7 PAGE 4

with clapboard, while the one story structures are covered with composition siding. Apparently the original two-story structure was only a single bay wide across the front, and was later expanded on one side, thereby extending the gable roof. An enclosed porch supported by columns was added to the upper front elevation, leaving the first floor section open as a garage. The main entrance, on the side of the extended section, is reached by a closed string staircase. The windows on the dwelling are 6/6 double-hung sash. The gable-shaped roof is covered with a combination of composition shingles and metal. The eaves and gable ends are covered with a fascia board. A simple, square, exterior brick chimney exists on the east side of the dwelling. The one-story chicken houses are located on the west side of the two-story section. The windows are 6/6 double hung sash and are grouped in twos. The first flat roof overhangs on the front elevation.

Significance: The abandoned Ames Hitchens chicken farm is the last of these structures still standing within the Indian River Nanticoke community. The presence of such structures indicates the assimilation of the Nanticoke community into the larger rural community of early-twentieth-century Sussex County.

Acreage: Three acres.

Verbal Boundary Description: The Ames Hitchens Chicken Farm is located at the end of a farm lane beginning on Route 24 east of Harmony Church and about 200 yards from the church. The property is bounded on the north, west, and south by woods and on the east by cultivated fields. The nominated portion of the property includes only the chicken houses and the attached domestic structure.

UTM: 18/481000/4272970

6. Indian Mission School (Nanticoke Indian Center) (S-757)

Location: Indian Mission School fronts the south side of Route 24 midway between County Roads 312A and 313A.

Description: The present Indian Mission School was designed as a one-story educational facility, and is currently maintained as the Nanticoke Indian Center. It replaced a one-room frame structure destroyed by fire in 1948. The exterior load-bearing walls are constructed with masonry units covered with stucco, surmounted by a gable roof with composition shingles and a simple cornice with returns. The main facade features a concrete block covered entrance. The windows are both 6/6 and 9/9 double hung sashes.

FORM AS SUBMITTED TO O.A.M.P.

FORM AS SUBMITTED TO OAHM.

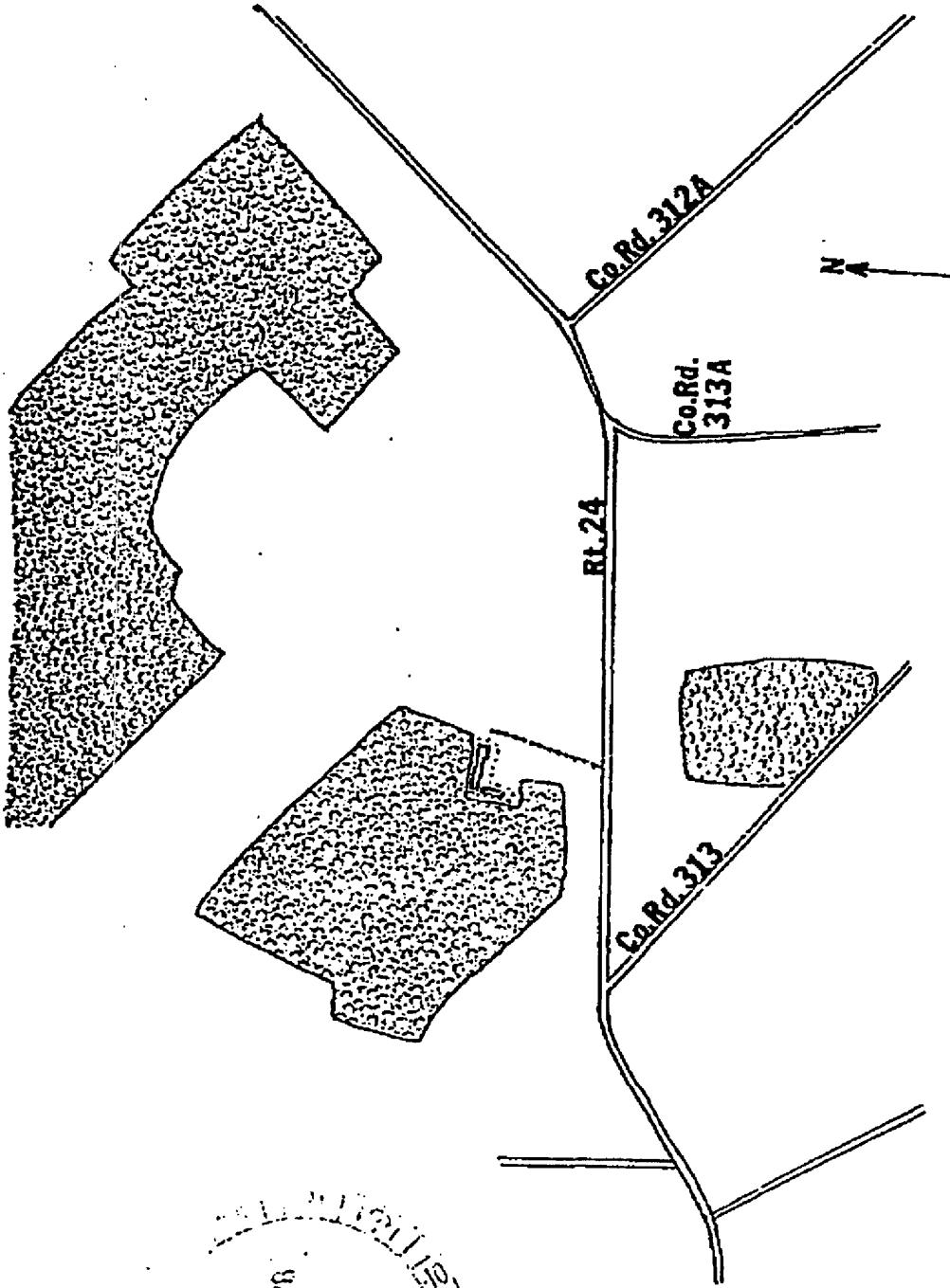

RECEIVED
 APR 19 1978
 DELAWARE HISTORICAL AND CULTURAL AFFAIRS

DELAWARE DIVISION OF HISTORICAL AND CULTURAL AFFAIRS

DELAWARE DIVISION OF HISTORICAL AND CULTURAL AFFAIRS

DRAWN BY DRG DATE 4/78 SCALE 1:9600

FILE S-755 TITLE NANTICONE

1000 N. Main St. Dover, DE 19901

Name: Ames Hitchens Chicken Farms

Location: Rt. 24, near Millsboro, Delaware

Photographer: Frank W. Porter, III

Date: December 1977

Location of Negative: Div. of Hist. & Cultural Affairs,
S/ASHP, Hall of Records, Dover, Delaware 19901

Description: View to the north showing attached
dwelling.

Photograph Number: 5

APR 10 1978

FORM AS SUBMITTED TO A

