

United States Department of the Interior  
Heritage Conservation and Recreation Service

National Register of Historic Places  
Inventory—Nomination Form

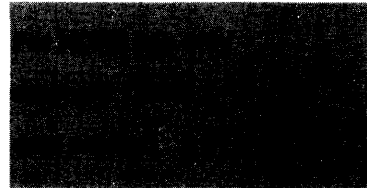

82

See instructions in *How to Complete National Register Forms*  
Type all entries—complete applicable sections

1. Name

historic Payne, Lewis, House

and/or common Highlands

2. Location

street & number Lansing Lane, off Weisenberger Mill Road NA not for publication

city, town Midway *Mc*  vicinity of congressional district 6th

state Kentucky code 021 county Woodford code 239

3. Classification

<b>Category</b>	<b>Ownership</b>	<b>Status</b>	<b>Present Use</b>	
<input type="checkbox"/> district	<input type="checkbox"/> public	<input checked="" type="checkbox"/> occupied	<input checked="" type="checkbox"/> agriculture	<input type="checkbox"/> museum
<input checked="" type="checkbox"/> building(s)	<input checked="" type="checkbox"/> private	<input type="checkbox"/> unoccupied	<input type="checkbox"/> commercial	<input type="checkbox"/> park
<input type="checkbox"/> structure	<input type="checkbox"/> both	<input type="checkbox"/> work in progress	<input type="checkbox"/> educational	<input checked="" type="checkbox"/> private residence
<input type="checkbox"/> site	<b>Public Acquisition</b>	<b>Accessible</b>	<input type="checkbox"/> entertainment	<input type="checkbox"/> religious
<input type="checkbox"/> object	<input checked="" type="checkbox"/> NA in process	<input checked="" type="checkbox"/> yes: restricted	<input type="checkbox"/> government	<input type="checkbox"/> scientific
	<input checked="" type="checkbox"/> NA being considered	<input type="checkbox"/> yes: unrestricted	<input type="checkbox"/> industrial	<input type="checkbox"/> transportation
		<input type="checkbox"/> no	<input type="checkbox"/> military	<input type="checkbox"/> other:

4. Owner of Property

name Mr. and Mrs. William G. Clark

street & number Highlands Farm

city, town Midway  vicinity of state Kentucky

5. Location of Legal Description

courthouse, registry of deeds, etc. Woodford County Courthouse

street & number

city, town Versailles state Kentucky

6. Representation in Existing Surveys

title No has this property been determined eligible?  yes  no

date  federal  state  county  local

depository for survey records

city, town state

## 7. Description

<b>Condition</b>		<b>Check one</b>	<b>Check one</b>
<input checked="" type="checkbox"/> excellent	<input type="checkbox"/> deteriorated	<input type="checkbox"/> unaltered	<input checked="" type="checkbox"/> original site
<input type="checkbox"/> good	<input type="checkbox"/> ruins	<input checked="" type="checkbox"/> altered	<input type="checkbox"/> moved    date _____
<input type="checkbox"/> fair	<input type="checkbox"/> unexposed		

### Describe the present and original (if known) physical appearance

The Lewis Payne House is a massive Greek Revival residence, attractively situated on a 270-acre horse farm off Weisenberger Mill Road near Midway,<sup>1</sup> a small rural community ten miles west of Lexington. Characterized by verdant undulating hills, the area is primarily agricultural and contains some of Kentucky's most prestigious horse farms. Facing northwest toward Lansing Lane, the house is encircled by large picturesque shade trees and is further enhanced by a long narrow entrance lane flanked by wood fencing.

The front (northwest) facade is distinguished by an impressive two-story portico supported by paired Ionic columns and an elaborate classical central entrance. The doorway is encompassed in a frontispiece consisting of pilasters and free standing Ionic columns in antis. Atop this component, the frieze boasts a Greek honeysuckle motif.

The main block, three bays in width, is almost equalled in size by an expansive rear ell. An open double gallery, supported by brick piers, is located on the northeast wall.<sup>2</sup> Principle elevations (northwest and northeast walls) are laid in Flemish bond, with the southeast and southwest walls laid in common bond. Four chimneys serve the structure, two flanking the main block and two in the ell, each of which is incorporated into the supporting walls. Semi-advanced pilasters separate the bays on the northeast and northwest elevations, which are the two most visible sides.

Most of the interior woodwork consists of shouldered architrave door trim, surmounted by a simple cornice. The main parlor (left front) trim is slightly different, having no shoulder. In addition, the main entrance boasts pilaster shafts which separate the sidelights and the door. In the central hall the principle staircase is a "half turn with landings." The steps themselves are accented through the use of an abstract Greek key motif. In keeping with the classic theme, the mantelpieces are composed of heavy pilasters set on blocks, which support a plain frieze and cornice.

Few interior alterations have been undertaken, and, with the exception of new plumbing and kitchen facilities, the house is virtually originally intact. The only exterior alteration is a small two-story enclosure on the south side of the ell.

Two historic outbuildings remain on the immediate property. Now used as a residence, a one and one-half story brick smokehouse sits just west of the main house. The window openings are topped by wood lintels, and the cornice is boxed. An early log structure (now weatherboarded) is located approximately 100 feet west of the house.

Because of the large scale of the house and its historic associations as a farm residence, it is felt that the nominated area should encompass the tree-lined, fenced approach to the residence, which forms an important part of the visual setting. Also included are two historic outbuildings (smokehouse and log structure), located directly to the rear of the house (see map 2).

<sup>1</sup>See the National Register nomination for for the Midway Historic District, Woodford County, Kentucky, listed in the National Register November 17, 1978.

<sup>2</sup>The original two-story gallery on the southwest wall has been altered to one story.

# 8. Significance

Period	Areas of Significance—Check and justify below			
<input type="checkbox"/> prehistoric	<input type="checkbox"/> archeology-prehistoric	<input type="checkbox"/> community planning	<input type="checkbox"/> landscape architecture	<input type="checkbox"/> religion
<input type="checkbox"/> 1400–1499	<input type="checkbox"/> archeology-historic	<input type="checkbox"/> conservation	<input type="checkbox"/> law	<input type="checkbox"/> science
<input type="checkbox"/> 1500–1599	<input type="checkbox"/> agriculture	<input type="checkbox"/> economics	<input type="checkbox"/> literature	<input type="checkbox"/> sculpture
<input type="checkbox"/> 1600–1699	<input checked="" type="checkbox"/> architecture	<input type="checkbox"/> education	<input type="checkbox"/> military	<input type="checkbox"/> social/
<input checked="" type="checkbox"/> 1700–1799	<input type="checkbox"/> art	<input type="checkbox"/> engineering	<input type="checkbox"/> music	<input type="checkbox"/> humanitarian
<input type="checkbox"/> 1800–1899	<input type="checkbox"/> commerce	<input type="checkbox"/> exploration/settlement	<input type="checkbox"/> philosophy	<input type="checkbox"/> theater
<input type="checkbox"/> 1900–	<input type="checkbox"/> communications	<input type="checkbox"/> industry	<input type="checkbox"/> politics/government	<input type="checkbox"/> transportation
		<input type="checkbox"/> invention		<input type="checkbox"/> other (specify)

**Specific dates** c. 1845      **Builder/Architect** Unknown

**Statement of Significance (in one paragraph)**

The Lewis Payne House, located on a large horse farm in the Bluegrass region of Kentucky, is an impressive example of the Greek Revival style. Significant features include the two-story tetrastyle portico, a finely detailed classical entrance, and a galleried northeast facade.

The land on which the house was built was originally owned by Judge Caleb Wallace, who built a house and law office on his property. After his death, the farm, composed of 1600 acres, was inherited by his son Christian. In 1838, he sold part of the land to Lewis T. Payne, who probably built the residence some time in the 1840s.<sup>1</sup> Payne was from a very prominent Scott County family--the son of Asa Payne and Theodosia Turner and the grandson of General John Payne and Betsy Johnson. General Payne was well known for his military exploits during the War of 1812, as was his wife's father, Colonel Robert Johnson, one of Scott County's earliest settlers.<sup>2</sup>

In 1863 Lewis Payne sold his farm to Horace G. Craig, who operated a nearby mill. (It was Horace Craig for whom Craig's Mill Road was named, now locally known as the Weisenberger Mill Road.) In 1867, Craig sold the property to John J. Rogers. A year later it changed hands again, coming into the possession of James McKee, who willed it to his daughter Catherine McKee Withrow, who retained ownership until 1900. It resold several times after that date before it was purchased in 1924 by James Ware Parrish, whose granddaughter Mrs. William G. Clark is the present owner.<sup>3</sup>

The surviving exterior and interior detailing establish the house as an important representative of the Greek Revival mode. Notable features include the entrance with an elaborate frontispiece consisting of pilasters and free standing Ionic columns in antis, classical cornice on three sides, triple windows on the front and rear walls, and side galleries. The original interior trim, although not elaborate, is virtually intact.

<sup>1</sup>Waveland, an historic house in Fayette County which bears a striking resemblance to the Payne House, is thought to have been built c. 1845. (See National Register form for Waveland, Fayette County, Kentucky.)

<sup>2</sup>Midway Woman's Club, A History of Midway. No pages.

<sup>3</sup>In 1903 the farm was sold to settle Mrs. Withrow's estate. James Withrow bought out his sisters and brothers and in 1904 sold the property to May Viley Lansing, a niece of Lewis Payne's second wife. (The lane to Criag's Mill Pike was paved at this time, hence the name Lansing Lane.

In 1909 the property was purchased by J. J. Richardson and in 1910 Richardson sold  
(continued)

# 9. Major Bibliographical References

Information provided by the owner, Mrs. William G. Clark, 1981.

Midway Woman's Club. A History of Midway. 1972.

# 10. Geographical Data **ACREAGE NOT VERIFIED** **UTM NOT VERIFIED**

Acreege of nominated prberty Approx. 3.8 acres

Quadrangle name Versailles and Midway

Quadrangle scale 1:24000

### UMT References

A	1 16	7 0 14	9 18 10	4 12	2 11	8 12 10
	Zone	Easting		Northing		

B	1 16	7 0 14	8 16 15	4 12	2 11	7 14 10
	Zone	Easting		Northing		

C	1 16	7 0 14	8 11 10	4 12	2 11	7 18 10
---	------	--------	---------	------	------	---------

D	1 16	7 0 14	8 13 10	4 12	2 11	8 10 10
---	------	--------	---------	------	------	---------

E	1 6	7 0 14	4 0 0	4 12	2 12	2 14 10
---	-----	--------	-------	------	------	---------

F	1 16	7 0 14	4 17 10	4 12	2 12	3 11 10
---	------	--------	---------	------	------	---------

G						
---	--	--	--	--	--	--

H						
---	--	--	--	--	--	--

### Verbal boundary description and justification

(See Map 2). The boundary extends from the south side of Lansing Rdad 10' from the entrance drive (Pt. 1), extending southeastward 10' from the entrance drive, following

### List all states and counties for properties overlapping state or county boundaries

state	NA	code	county	code
state		code	county	code

# 11. Form Prepared By

name/title Charlotte Schneider, Architectural Historian; Gloria Mills, Historian

organization Heritage Division--Dept. of the Arts date December 1981

street & number 2200 Capital Plaza Towers telephone 502/564-7508

city or town Frankfort state Kentucky

# 12. State Historic Preservation Officer Certification

The evaluated significance of this property within the state is:

national  state  local

As the designated State Historic Preservation Officer for the National Historic Preservation Act of 1966 (Public Law 89-665), I hereby nominate this property for inclusion in the National Register and certify that it has been evaluated according to the criteria and procedures set forth by the Heritage Conservation and Recreation Service.

State Historic Preservation Officer signature Mary Corman Appel

title SHPO date 3/11/82



UNITED STATES DEPARTMENT OF THE INTERIOR  
NATIONAL PARK SERVICE

FOR NPS USE ONLY

RECEIVED

DATE ENTERED

**NATIONAL REGISTER OF HISTORIC PLACES  
INVENTORY -- NOMINATION FORM**

Payne, Lewis, House  
Woodford County, Kentucky  
CONTINUATION SHEET

ITEM NUMBER 8

PAGE 2

Footnotes

3 (continued)

it to E. L. Lillard. The house was sold in 1918 to J. M. Ledridge. John and Charles Steele purchased it from Ledridge in 1919 and James Ware Parrish bought it from the Steeles in 1924. (From information provided by the present owners.)

UNITED STATES DEPARTMENT OF THE INTERIOR  
NATIONAL PARK SERVICE

**NATIONAL REGISTER OF HISTORIC PLACES  
INVENTORY -- NOMINATION FORM**

FOR NPS USE ONLY

RECEIVED

DATE ENTERED

Lewis Payne House  
Woodford County, Kentucky

CONTINUATION SHEET

ITEM NUMBER 10 PAGE 2

Verbal Boundary Description

the fence line to the circular drive directly in front of the main house (Pt. 2) The boundary then extends in an eastward direction, again following the fence line which at this point is about 200' from the main house. The line then turns southeastwardly to a point directly east of the log structure (Pt. 4) and extends westwardly to the east side of the drive. It then turns southward to a point (Pt. 6) on the north side of the drive. It then turns westwardly and runs about 175' to the intersection of a line extending from the north side of the rear drive and fence line which lies 100' west of the main house. The line then turns northwestwardly, following the fence line 100' from the house for about 430' (Pt. 10). The line at a point directly west of the circular drive then turns eastwardly, to within 10' of the west side of the linear entrance drive. It then extends northwestwardly to the south side of Lansing Road. The line then turns eastward, running along the south side of the road to the point of beginning.

Boundary Justification

The boundary is drawn to include the formal approach to the house, and surrounding domestic space which is enclosed by fencing on three sides. Two historic outbuild- located directly to the rear of the main house are encompassed within these boundaries.

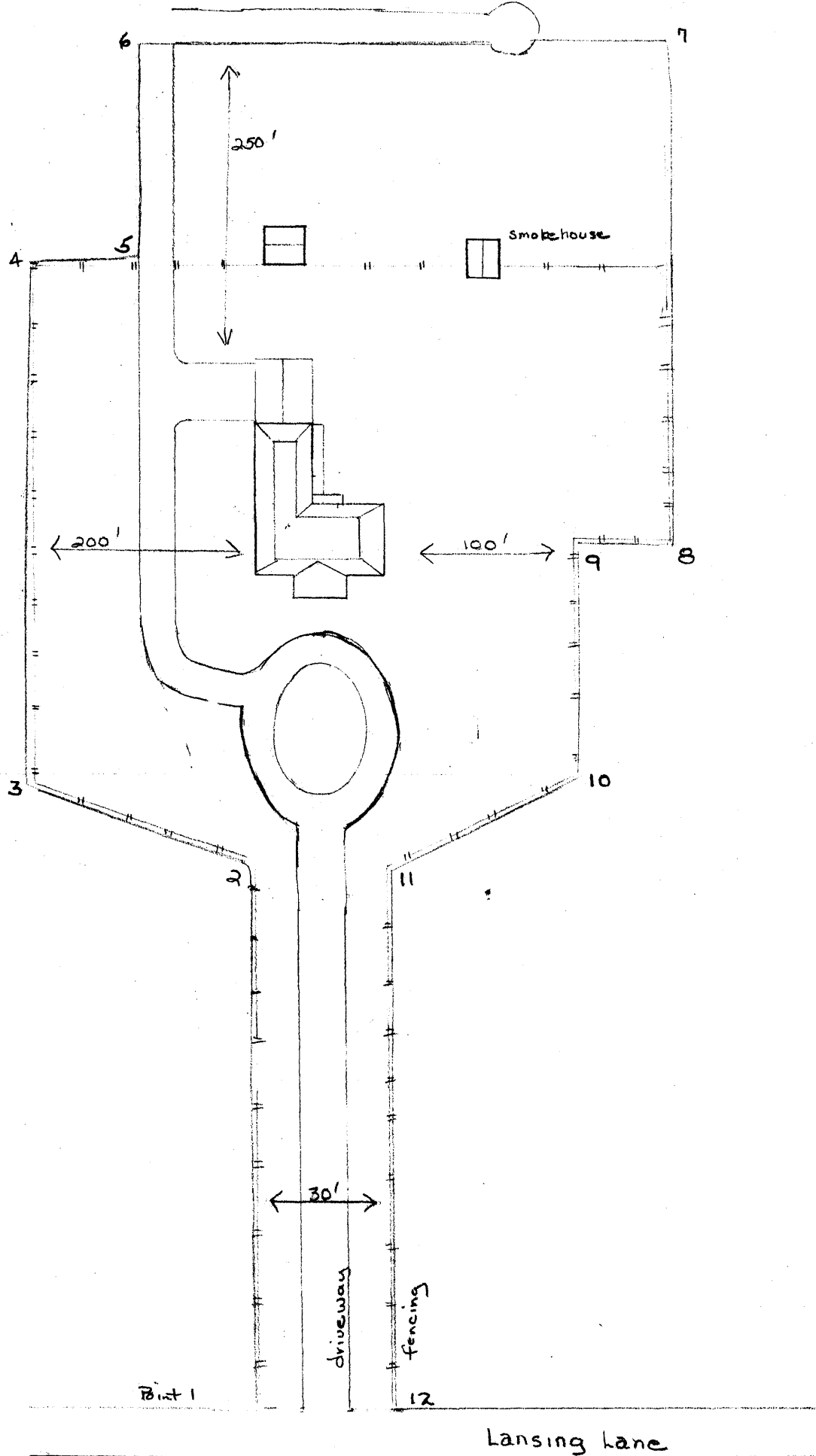

MAP 2  
 Lewis Payne House  
 Woodford County, Kentucky

Sketch Map. Not to scale.  
 By Eugene Dorn

Boundaries shown in red.

# PART OF WOODFORD CO

## PRECINCT NO 1

Scale 1 1/4 Inches to the Mile

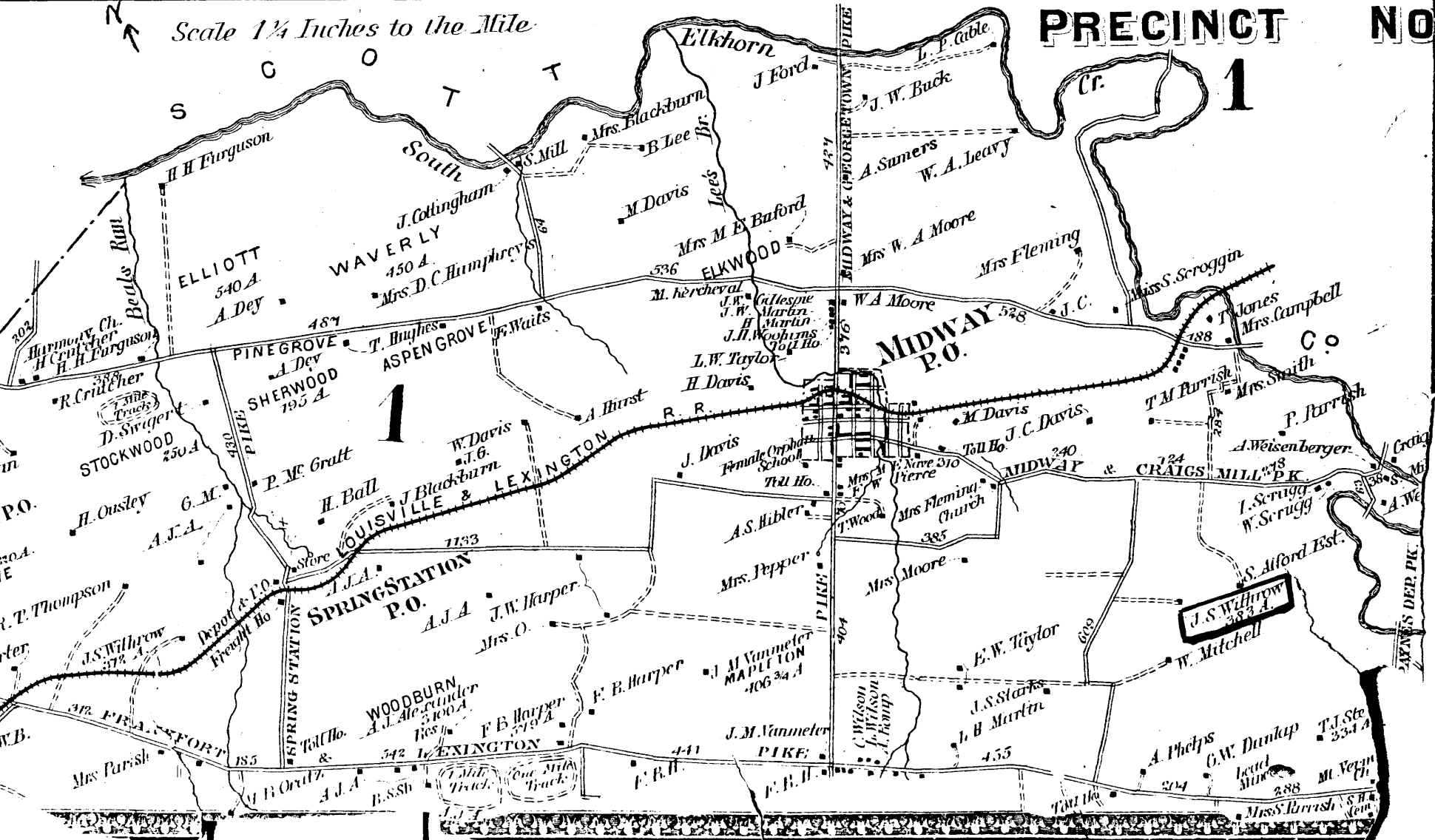



MAP 3

Lewis Payne House  
Woodford County, Kentucky

Atlas of Bourbon, Clark, Fayette,  
Jessamine & Woodford counties,  
Ky.  
By D. G. Beers & Co. Phil. 1877