

**United States Department of the Interior
National Park Service**

For NPS use only

**National Register of Historic Places
Inventory—Nomination Form**

received APR 17 1986
date entered

See instructions in *How to Complete National Register Forms*
Type all entries—complete applicable sections

1. Name

historic Central Louisiana State Hospital Dairy Barn

and/or common same

2. Location

street & number Central Louisiana State Hospital, U.S. HWY 71/165/167 N/A not for publication

city, town Pineville N/A vicinity of

state LA code 22 county Rapides Parish code 079

3. Classification

Category	Ownership	Status	Present Use
<input type="checkbox"/> district	<input checked="" type="checkbox"/> public	<input checked="" type="checkbox"/> occupied	<input type="checkbox"/> agriculture
<input checked="" type="checkbox"/> building(s)	<input type="checkbox"/> private	<input type="checkbox"/> unoccupied	<input type="checkbox"/> commercial
<input type="checkbox"/> structure	<input type="checkbox"/> both	<input type="checkbox"/> work in progress	<input type="checkbox"/> educational
<input type="checkbox"/> site	Public Acquisition	Accessible	<input type="checkbox"/> entertainment
<input type="checkbox"/> object	N/A in process	<input checked="" type="checkbox"/> yes: restricted	<input type="checkbox"/> government
	N/A being considered	<input type="checkbox"/> yes: unrestricted	<input type="checkbox"/> industrial
		<input type="checkbox"/> no	<input type="checkbox"/> military
			<input type="checkbox"/> museum
			<input type="checkbox"/> park
			<input type="checkbox"/> private residence
			<input type="checkbox"/> religious
			<input type="checkbox"/> scientific
			<input type="checkbox"/> transportation
			<input checked="" type="checkbox"/> other: hospital paint shop

4. Owner of Property

name State of Louisiana, Department of Health and Human Resources

street & number P. O. Box 3776 504-342-6671

city, town Baton Rouge N/A vicinity of state LA 70821

5. Location of Legal Description

courthouse, registry of deeds, etc. Rapides Parish Courthouse

street & number 701 Murray St. P. O. Box 952

city, town Alexandria state LA 71301

6. Representation in Existing Surveys

title LA Historic Sites Survey has this property been determined eligible? yes no

date 1985 federal state county local

depository for survey records LA State Historic Preservation Office

city, town Baton Rouge state LA

7. Description

Condition		Check one	Check one
<input type="checkbox"/> excellent	<input type="checkbox"/> deteriorated	<input type="checkbox"/> unaltered	<input checked="" type="checkbox"/> original site
<input checked="" type="checkbox"/> good	<input type="checkbox"/> ruins	<input checked="" type="checkbox"/> altered	<input type="checkbox"/> moved date <u> N/A </u>
<input type="checkbox"/> fair	<input type="checkbox"/> unexposed		

Describe the present and original (if known) physical appearance

The Central Louisiana State Hospital Dairy Barn (1923) is a two story frame structure with attached single story wings. It has a commanding position atop a knoll overlooking Lake Buhlow at the northern end of the state hospital grounds. The removal of the original dairy machinery is the only alteration the building has received.

The clapboard sided structure features numerous nine light casement windows. The two wings project from the south end of the main block at angles, yielding an overall "Y" shape. The central two story block culminates in a massive curving gambrel roof with flared eaves. The enormous loft interior reveals the supporting structure, a series of continuous curving ribs made up of laminated boards which run from plate to plate. The attic is vented at the south end by a Serlian motif. Other than this the fenestration detailing is plain. The building's massing is enlivened by six oversized roof vent stacks. Other noteworthy features include a rooftop crane on the eave of the north elevation, sliding doors made of planks, and original concrete floors.

8. Significance

Period	Areas of Significance—Check and justify below			
<input type="checkbox"/> prehistoric	<input type="checkbox"/> archeology-prehistoric	<input type="checkbox"/> community planning	<input type="checkbox"/> landscape architecture	<input type="checkbox"/> religion
<input type="checkbox"/> 1400–1499	<input type="checkbox"/> archeology-historic	<input type="checkbox"/> conservation	<input type="checkbox"/> law	<input type="checkbox"/> science
<input type="checkbox"/> 1500–1599	<input type="checkbox"/> agriculture	<input type="checkbox"/> economics	<input type="checkbox"/> literature	<input type="checkbox"/> sculpture
<input type="checkbox"/> 1600–1699	<input checked="" type="checkbox"/> architecture	<input type="checkbox"/> education	<input type="checkbox"/> military	<input type="checkbox"/> social/ humanitarian
<input type="checkbox"/> 1700–1799	<input type="checkbox"/> art	<input type="checkbox"/> engineering	<input type="checkbox"/> music	<input type="checkbox"/> theater
<input type="checkbox"/> 1800–1899	<input type="checkbox"/> commerce	<input type="checkbox"/> exploration/settlement	<input type="checkbox"/> philosophy	<input type="checkbox"/> transportation
<input checked="" type="checkbox"/> 1900–	<input type="checkbox"/> communications	<input type="checkbox"/> industry	<input type="checkbox"/> politics/government	<input type="checkbox"/> other (specify)
		<input type="checkbox"/> invention		

Specific dates 1923 **Builder/Architect** Joseph H. Carlin

Statement of Significance (in one paragraph) Criterion C

The Central Louisiana State Hospital Dairy Barn is of statewide significance in the area of architecture as a very unusual example of a farm outbuilding. The barn was designed by an architect, which makes it most unusual among surviving old barns in Louisiana. Its essential style is taken from midwestern dairy barns of the early twentieth century, but there are differences. Chief among them is the curvilinear gambrel roof, a feature both difficult to build and functionally unnecessary. Secondly, there are the egregiously oversized vent stacks. Finally, there is the Serlian motif attic vent. In many ways the design is a caricature rather than an example of the classic midwestern barn. It stands out among the vast stock of early twentieth century farm outbuildings in Louisiana because it was styled for visual effect. Unlike virtually all other examples in the state, its design was not wholly functional, and it did not represent the cheapest, most expeditious solution to the problem of providing for a barn. Rather, it represented an architectural folly built for dramatic picturesque effect. The State Historic Preservation Office is not aware of any comparable "outbuilding" in Louisiana.

Historical Note:

Joseph H. Carlin, a patient at Central Louisiana State Hospital from September 13, 1909 to August 1, 1912, is noted on the barn cornerstone as the "builder." The cornerstone for another building on the hospital grounds (Rose Cottage, 1917, N.R.) lists Carlin as the "architect." Carlin was admitted to Central from Rayne, Louisiana. According to hospital records, he became ill after constructing a Catholic church. Nothing else is known of him.

Central Louisiana State Hospital was created by enabling legislation in 1902 to provide for the treatment of blacks suffering from mental illness. The legislation was amended in 1904 to provide for the treatment of Caucasians as well as blacks. The facility opened on January 6, 1906.

The greater majority of the original buildings that made up Central have been demolished. Rose Cottage (1917-N.R.) is the oldest extant building. The other remaining older buildings include the dairy barn (1923), the Administration Building and Fuqua Hospital (Unit 1) (1927), and Unit 3 (1937). The remainder of the buildings were constructed in 1942 or the early 1950's.

9. Major Bibliographical References

Historical data on the dairy barn and Joseph H. Carlin provided by Central Louisiana State Hospital. Copy in National Register file.
1923 cornerstone.

10. Geographical Data

Acreage of nominated property 4 acres

Quadrangle name Alexandria, LA

Quadrangle scale 1:24000

UTM References

A

1	5
---	---

5	5	3	2	0	0
---	---	---	---	---	---

3	4	6	6	5	2	0
---	---	---	---	---	---	---

B

--	--

--	--	--	--

--	--	--	--	--	--

C

--	--

--	--	--	--

--	--	--	--	--	--

D

--	--

--	--	--	--

--	--	--	--	--	--

E

--	--

--	--	--	--

--	--	--	--	--	--

F

--	--

--	--	--	--

--	--	--	--	--	--

G

--	--

--	--	--	--

--	--	--	--	--	--

H

--	--

--	--	--	--

--	--	--	--	--	--

Verbal boundary description and justification

Please refer to enclosed sketch map. Boundaries were drawn to discretely encompass the resource. To have included all the acreage under single ownership would have meant including the entire hospital complex.

List all states and counties for properties overlapping state or county boundaries

state	code	county	code
N/A			

state	code	county	code

11. Form Prepared By

Assisted by Central Louisiana State Hospital,
A. David Poe, Director, Environmental

name/title National Register Staff
Division of Historic Preservation
organization State of Louisiana

Services
date February 1986

street & number P. O. Box 44247

telephone 504-922-0358

city or town Baton Rouge

state LA 70804

12. State Historic Preservation Officer Certification

The evaluated significance of this property within the state is:

national state local

As the designated State Historic Preservation Officer for the National Historic Preservation Act of 1966 (Public Law 89-665), I hereby nominate this property for inclusion in the National Register and certify that it has been evaluated according to the criteria and procedures set forth by the National Park Service.

State Historic Preservation Officer signature



Robert B. DeBlieux

title State Historic Preservation Officer

date March 27, 1986

For NPS use only

I hereby certify that this property is included in the National Register

Entered in 1986
National Register

date 5-15-86

for 
Keeper of the National Register

Attest:

date

Chief of Registration

CENTRAL LOUISIANA
HOSPITAL RAPIDES
PARISH, LA.

DAIRY BARN

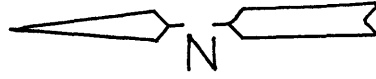

NOT TO SCALE

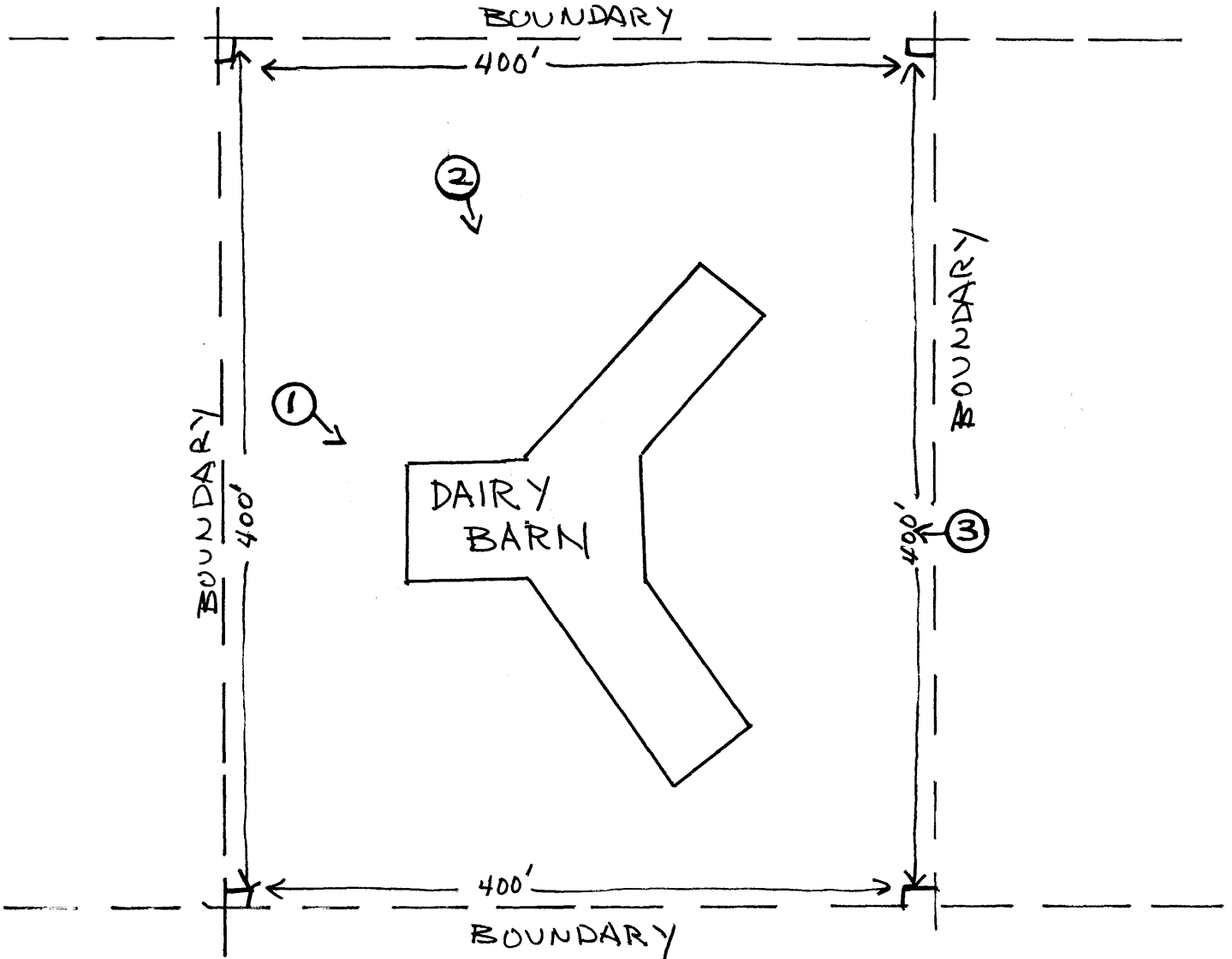

The boundary line is a 400' square whose center point is the center of the North-South roof ridge on the main portion of the barn. The sides of the square follow the cardinal directions. Approx 4 Acres