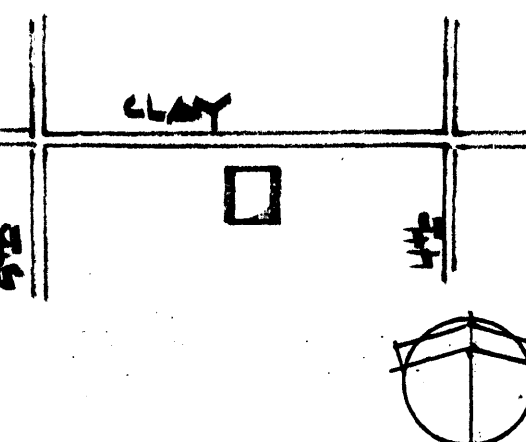
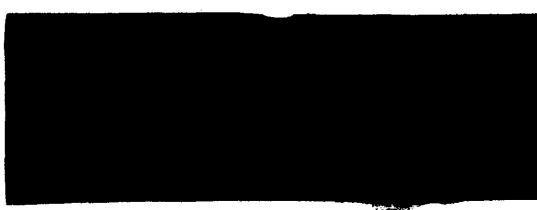

KENTUCKY HISTORIC RESOURCES INVENTORY

Site No. Sh - S 61

1. Historic Name(s) <input checked="" type="checkbox"/> Bethel A.M.E. Church Original Owner _____		22. ADD/County KIPDA / SHELBY 106	
2. Present Name Bethel A.M.E. Church		23. U.S.G.S. Quadrant (15'/75') SHELBYVILLE 	
3. Location <input checked="" type="checkbox"/> 414 Henry Clay St., Shelbyville, Ky. 40065		24. UTM Reference 116 656260 4230400 Zone Easting Northing	
4. Owner's Name Same		25. Coordinate Accuracy 	
5. Owner's Address _____		26. Prehistoric Site _____ Object _____ Historic Site _____ Structure _____ <input checked="" type="checkbox"/> Building _____ Other _____	
6. Open to Public Yes <input checked="" type="checkbox"/> No _____	7. Visible from road Yes <input checked="" type="checkbox"/> No _____	8. Ownership X Private _____ Local _____ State _____ Federal _____	
9. Local Contact/Organization SHELBY COUNTY HISTORICAL SOCIETY		27. National Register District Name: MULTIPLE RESOURCES OF SHELBYVILLE 	
10. Site Plan with North Arrow 		28. Significance Evaluation National Register 	
		29. Status _____ Date _____ National Landmark National Register Landmark Certificate Kentucky Survey Local Landmark HABS/HAER 	
		30. Historic Theme Primary Religious Secondary Black History Other _____	
		31. Endangered Yes _____ No _____	
		32. Preservation Project Status 	
		Actual Cost in \$1,000s 	
		33. ATTACH PHOTO 	
4. Description One story brick building; "incomplete" corner towers; pointed arch openings; stone detail; porch modified with concrete pad; cast iron fence; concrete foundation		11. Architect _____ 12. Builder _____ 13. Date 1916 A. 6 B. 14. Style A. Gothic Revival D B. 15. Original Use Church H 16. Present use Same 17. Condition Good B	
		No. Stories One A Single Pile _____ NA <input checked="" type="checkbox"/> Double Pile _____ Floor Plan Structural Fabric Brick A. C B. Decorative Fabric A. B. Roof Form _____	
(Continue on Back)			
19. History Church was established in 1858.		Roll No. <u>6:22, 23</u> Picture No. _____ Direction _____	
		34. Prepared by: Helen Powell KTG/ Ky. Heritage Council 1979	
20. Significance Bethel AME Church is best example of integration of Gothic Revival and Classical Revival styles. The sanctuary is also important in the evolution of black		35. Organization CARMAN AND POWELL, INC.	
		36. Date 1983	
21. Source of Information religious life in Shelbyville.		37. Revision Dates _____ 38. Staff Review _____	

KENTUCKY HISTORIC RESOURCE INVENTORY SUPPLEMENT
BOUNDARY AND LOCATION INFORMATION

Historic Property Name Bethel A.M.E. Church Site # SH-S-61

Multiple Resource/Thematic Nomination Title Multiple Resources of Shelbyville

U.T.M. Coordinates - List multiple UTM's if property is ten or more acres.

A. 16 656260 4230400 D. _____

B. _____ E. _____

C. _____ F. _____

Verbal Boundary Description

Acreeage less than 1/2 acre

Beginning at a point in the southwest corner of the intersection of Clay and Fourth St., then west 200 feet to a point of beginning; then west 60 feet to a point; then south 80 feet to a point; then east 60 feet to a point; then north 80 feet to the point of beginning.

Sketch of Site Plan (Showing outbuildings, structures, landscape features and the site boundary as described above.)

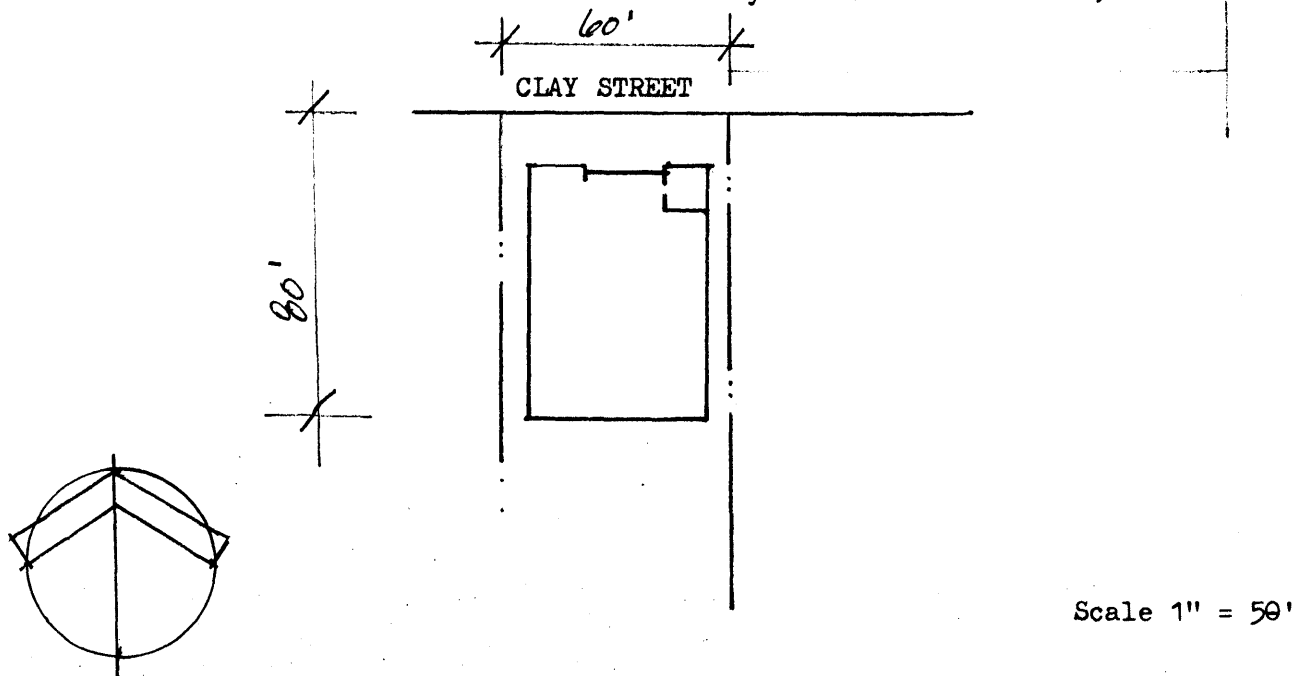

Official Courthouse Property Reference: