

NATIONAL REGISTER OF HISTORIC PLACES  
INVENTORY - NOMINATION FORM  
FOR FEDERAL PROPERTIES  
(Type all entries - complete applicable sections)

STATE: California
COUNTY: Ventura
FOR NPS USE ONLY
ENTRY DATE

1. NAME

COMMON:  
Bard, Thomas R., Estate

AND/OR HISTORIC:  
Berylwood

2. LOCATION

STREET AND NUMBER:  
U. S. Naval Construction Battalion Center

CITY OR TOWN:  
Port Hueneme

CONGRESSIONAL DISTRICT:  
20th Congressional District

STATE: California	CODE 06	COUNTY: Ventura	CODE 111
----------------------	------------	--------------------	-------------

3. CLASSIFICATION

CATEGORY (Check One)	OWNERSHIP	STATUS	ACCESSIBLE TO THE PUBLIC
<input checked="" type="checkbox"/> District <input type="checkbox"/> Site <input type="checkbox"/> Object <input type="checkbox"/> Building <input type="checkbox"/> Structure <input type="checkbox"/> Object	<input checked="" type="checkbox"/> Public <input type="checkbox"/> Private <input type="checkbox"/> Both	Public Acquisition: <input type="checkbox"/> In Process <input type="checkbox"/> Being Considered	<input checked="" type="checkbox"/> Occupied <input type="checkbox"/> Unoccupied <input type="checkbox"/> Preservation work in progress
PRESENT USE (Check One or More as Appropriate)			
<input type="checkbox"/> Agricultural <input type="checkbox"/> Commercial <input type="checkbox"/> Educational <input checked="" type="checkbox"/> Entertainment	<input type="checkbox"/> Government <input type="checkbox"/> Industrial <input checked="" type="checkbox"/> Military <input type="checkbox"/> Museum	<input type="checkbox"/> Park <input checked="" type="checkbox"/> Private Residence <input type="checkbox"/> Religious <input type="checkbox"/> Scientific	<input type="checkbox"/> Transportation <input type="checkbox"/> Other (Specify) _____ _____ _____
Yes: <input checked="" type="checkbox"/> Restricted <input type="checkbox"/> Unrestricted <input type="checkbox"/> No			

4. AGENCY

Department of Defense, Department of the Navy

REGIONAL HEADQUARTERS: (If applicable)  
Western Division, Naval Facilities Engineering Command

CITY OR TOWN:  
San Bruno

STATE:  
California

CODE  
06

5. LOCATION OF LEGAL DESCRIPTION

COURTHOUSE, REGISTRY OF DEEDS, ETC:  
Ventura County Recorder

STREET AND NUMBER:  
2387 E. Main Street

CITY OR TOWN:  
Ventura

STATE:  
California

CODE  
06

6. REPRESENTATION IN EXISTING SURVEYS

TITLE OF SURVEY: Survey of Historic Buildings, Structures and Monuments  
within the Naval Shore Establishment

DATE OF SURVEY: 1963  Federal  State  County  Local

DEPOSITORY FOR SURVEY RECORDS:  
Naval Facilities Engineering Command

STREET AND NUMBER:  
200 Stovall Street

CITY OR TOWN:  
Alexandria

STATE:  
Virginia

CODE  
51

SEE INSTRUCTIONS

STATE:

COUNTY:

ENTRY NUMBER

DATE

FOR NPS USE ONLY

NATIONAL REGISTER OF HISTORIC PLACES  
INVENTORY - NOMINATION FORM

(Continuation Sheet)

STATE California	
COUNTY Ventura	
FOR NPS USE ONLY	
ENTRY NUMBER	DATE

(Number all entries)

7. DESCRIPTION (continued) (Page 1)

Today the Thomas R. Bard House is used by the United States Naval Construction Battalion Center as an Officers Club. The building alterations made by the Navy since their acquisition of the property in 1951 are the enclosure of the North Porch for a private dining room, the enclosure of the South Terrace for a cocktail room and bar, and the removal of the elevator and various interior partitions.

The Richard Bard House was originally built in 1910 as a one-story cottage, but, between 1918 and 1926, it was remodeled and enlarged extensively by several ground floor and two-story additions. Near this site was the original bachelor bungalow used by Senator Bard until the construction of the first Thomas R. Bard House. The Richard Bard House served as the residence of the Senator and his family from 1911 to 1912 while the present mansion was being built. Although several of the Bard children occupied the house at various other times, it eventually became the permanent residence of Senator Bard's son, Richard, and his family. The house is an attractive combination of one-story and two-story portions made of wood frame with wood exterior siding and a composition roof. This delightful, early 20th Century, country home has an interior floor area of 4,717 square feet, a volume of 54,140 cubic feet, 7 bedrooms and 4 and ½ baths. The Navy has used the Richard Bard House almost exclusively as Senior Officer's Quarters and, for this reason, the building has remained virtually unchanged since its last enlargement in 1926.

The remaining buildings and facilities, although lacking significance in themselves, are, nonetheless, an integral part of the Thomas R. Bard Estate. They provide continuity to the estate as a whole and are reminiscent of its growth from pioneer hardships to 20th Century magnificence.

The Milk House has undergone many changes since its construction in 1918. It is a charming, wooden, one-story, country structure of wood frame with a mansard roof of wooden shingles. The building was extensively remodeled in 1945 for conversion by the Navy into married officer's quarters. In 1954 it was moved to a new location and remodeled even further; a second floor was added within the original Milk House structure and the result was a floor area of 1,758 square feet, a volume of 16,284 cubic feet, 3 bedrooms and 2 baths.

The Bard Guest House, built in 1925, is yet another one-story, wood-frame, country house with composition roofing. It is more commonly known as the Doll House because of its small size. The interior consists of a floor area of 764 square feet, a volume of 8,058 cubic feet, two bedrooms, a living room, one bath, and a kitchen. The building was originally rehabilitated in 1945 for use as married officer's quarters, but has since become a suite for bachelor officers.

The swimming pool, tennis courts, garage and gardener tool shed serve the United States Naval Construction Battalion Center in their original capacity. The private cemetery, once located west of the tennis courts and approximately 400 feet north of the Thomas R. Bard House, was moved in 1951 to a permanent

NATIONAL REGISTER OF HISTORIC PLACES  
INVENTORY - NOMINATION FORM

(Continuation Sheet)

STATE	
California	
COUNTY	
Ventura	
FOR NPS USE ONLY	
ENTRY NUMBER	DATE

(Number all entries)

7. DESCRIPTION (Continued) (Page 2)

Memorial Cemetary at the extreme southeast corner of the central wooded portion of the estate. Interred there are the remains of Senator Bard, his wife, and an infant son.

No description of the Bard Estate would be complete without mention of the unique botanical gardens which comprise the wooded area of the Bard Estate. Noted for their profusion and variety of rare ornamental trees and other plants, the gardens are truly of international origin. The tree, shrub, and flower seedlings were collected by Senator Bard from various parts of the world and planted between 1871 and 1915. Today there are approximately 260 rare trees represented by 46 genera and 78 species.

8. SIGNIFICANCE (Continued)

POLITICAL

Bard's success as a businessman, landowner, and community leader, as well as his personal integrity and leadership ability, made it only natural that he should be called to public service. In 1867 Bard was elected as one of the three supervisors of Santa Barbara County. Serving in this capacity until 1872, he was influential in the formation of Ventura County from the southern sector of Santa Barbara County. Through the years Thomas Bard was always a participant, if not as a candidate himself, as an active, important supporter, in local, state, and national politics. Finally, in 1900, he was elected by the State Legislature, following an unusual extra session and political battle, as a United States Senator from California. During his tenure of office he attained a position of respect and was conspicuous in many important legislative matters.

Thomas Bard's lifetime accomplishments are more numerous than those noted above. In addition, he was president of the Berylwood Investment Company, the Bank of Ventura (which he helped found in 1875), the Bank of Hueneme (which he incorporated), the Las Posas Water Company, the Simi Land and Water Company, the Sespel Oil Company, the Torrey Canon Oil Company, and the Mission Transfer Company. He served as director of the State Board of Agriculture, 1886-1887, the Graham and Loftus Oil Company, the Sacramento Valley Sugar Company, and the Potter Hotel Company. He was instrumental in the construction and establishment of several local churches and in the formation of the Pioneer Society of Ventura County.

LANDSCAPE ARCHITECTURE

The landscape architecture of Berylwood has gained international recognition for its botanical gardens which contain many rare and choice plants and trees. Botanists from many areas have visited the Bard Estate to examine these beautiful specimens. At present, the United States Naval Construction Battalion Center is preserving this international collection of trees.

**B. SIGNIFICANCE**

PERIOD (Check One or More as Appropriate)

- Pre-Columbian       16th Century       18th Century       20th Century  
 15th Century       17th Century       19th Century

SPECIFIC DATE(S) (If Applicable and Known)

AREAS OF SIGNIFICANCE (Check One or More as Appropriate)

- |  |  |   |  |
|--|--|---|--|
| <input type="checkbox"/> Aboriginal          | <input type="checkbox"/> Education                         | <input checked="" type="checkbox"/> Political | <input type="checkbox"/> Urban Planning  |
| <input type="checkbox"/> Prehistoric         | <input type="checkbox"/> Engineering                       | <input type="checkbox"/> Religion/Philosophy  | <input type="checkbox"/> Other (Specify) |
| <input type="checkbox"/> Historic            | <input checked="" type="checkbox"/> Industry               | <input type="checkbox"/> Science              | _____                                    |
| <input type="checkbox"/> Agriculture         | <input type="checkbox"/> Invention                         | <input type="checkbox"/> Sculpture            | _____                                    |
| <input type="checkbox"/> Architecture        | <input checked="" type="checkbox"/> Landscape Architecture | <input type="checkbox"/> Social/Humanitarian  | _____                                    |
| <input type="checkbox"/> Art                 | <input type="checkbox"/> Literature                        | <input type="checkbox"/> Theater              | _____                                    |
| <input checked="" type="checkbox"/> Commerce | <input type="checkbox"/> Military                          | <input type="checkbox"/> Transportation       | _____                                    |
| <input type="checkbox"/> Communications      | <input type="checkbox"/> Music                             |   |  |
| <input type="checkbox"/> Conservation        |  |   |  |

STATEMENT OF SIGNIFICANCE

The primary historical significance of Berylwood lies in the home of Thomas R. Bard, an important pioneer and colonizer of California. A dynamic businessman and politician, he was instrumental in bringing American customs and business methods to that part of Spanish California now known as Ventura County. Later in his life he gained statewide and national recognition as a United States Senator (California, 1900-1905).

**INDUSTRIAL**

Thomas Bard first came to California in 1865 as the representative of Thomas A. Scott, President of the Pennsylvania Railroad and Assistant Secretary of War under President Abraham Lincoln. Scott was an extensive landholder in the fledgling state, and one of his dreams was to develop the vast oil resources in this region. Bard, as Assistant Superintendent, and later Superintendent, of the California and Philadelphia Petroleum Company, began the first regulation oil drillings in California and the first efforts to develop California's oil fields. Eventually, in 1883, Bard joined the experienced Pennsylvania oilmen, Wallace Hardison and Lyman Stewart, in another California landmark oil venture. Together they built the first refinery in California, laid the first California oil pipeline, and built the Pacific Coast's first tanker ship. Finally, in 1890, nine of California's oil industry pioneers, including Thomas Bard, pooled their interests and formed the Union Oil Company of California, the oldest petroleum company in the West. Thomas Bard was elected the first President of the company and served in that capacity from 1890 to 1894.

**COMMERCIAL**

In 1868 Thomas Bard acquired from Thomas Scott all of his interests in the Mexican Land Grant, Rancho El Rio de Santa Clara o'la Colonia. He became the owner of 21,375.39 acres which were later divided into 40 subdivisions. Berylwood was a portion of Subdivisions 87 and 89 of the Rancho, and his selection of this site as his personal residence stemmed from one of his other thriving enterprises, the construction of Hueneme Wharf and the development of Hueneme as a seaport. In the late 1860s, Bard became cognizant of a natural submarine canyon which existed along Hueneme's coastline. With great foresight he constructed a wharf along this canyon in 1871. As a result, Hueneme became the second largest grain shipping port on the Pacific coast between 1871 and 1895. Until the railway came to the nearby town of Oxnard in 1898, the wharf also provided the principal means for transportation to and from all Ventura County south of the Santa Clara River.

(continued)

SEE INSTRUCTIONS

9. MAJOR BIBLIOGRAPHICAL REFERENCES

Hutchinson, W. H., Oil, Land, and Politics: The California Career of Thomas Robert Bard. 2 volumes. Norman: University of Oklahoma Press, 1965

Sheridan, Sol N., History of Ventura County California. Chicago: The S. J. Clarke Publishing Co., 1926

Blanchard, Sarah Eliot, Memories of a Child's Early California Days, Los Angeles: The Ward Ritchie Press, 1961.

10. GEOGRAPHICAL DATA

LATITUDE AND LONGITUDE COORDINATES DEFINING A RECTANGLE LOCATING THE PROPERTY			O R	LATITUDE AND LONGITUDE COORDINATES DEFINING THE CENTER POINT OF A PROPERTY OF LESS THAN TEN ACRES		
CORNER	LATITUDE	LONGITUDE		LATITUDE	LONGITUDE	
	Degrees Minutes Seconds	Degrees Minutes Seconds		Degrees Minutes Seconds	Degrees Minutes Seconds	
NW	34 ° 09 ' 39 ..	119 ° 11 ' 55 ..				
NE	34 ° 09 ' 39 ..	119 ° 11 ' 40 ..				
SE	34 ° 09 ' 17 ..	119 ° 11 ' 40 ..				
SW	34 ° 09 ' 17 ..	119 ° 11 ' 55 ..				

APPROXIMATE ACREAGE OF NOMINATED PROPERTY: 62.45 acres

LIST ALL STATES AND COUNTIES FOR PROPERTIES OVERLAPPING STATE OR COUNTY BOUNDARIES

STATE:	CODE	COUNTY:	CODE

11. FORM PREPARED BY

NAME AND TITLE: Julie F. Streets, Archivist DATE: \_\_\_\_\_

BUSINESS ADDRESS: NAVFAC Historian's Office, Code 2231

STREET AND NUMBER: U. S. Naval Construction Battalion Center PHONE: (805) 982-5146

CITY OR TOWN: Port Hueneme STATE: California CODE: 06

12. CERTIFICATION OF NOMINATION

State Liaison Officer recommendation:

Yes  
 No  
 Non

JUN 23 1975

*Harold Prock*  
 State Liaison Officer Signature

In compliance with Executive Order 11593, I hereby nominate this property to the National Register, certifying that the State Liaison Officer has been allowed 90 days in which to present the nomination to the State Review Board and to evaluate its significance. The recommended level of significance is  National  State  Local

\_\_\_\_\_  
 Federal Representative Signature Date

\_\_\_\_\_  
 Title

NATIONAL REGISTER VERIFICATION

I hereby certify that this property is included in the National Register.

\_\_\_\_\_  
 Director, Office of Archeology and Historic Preservation

Date \_\_\_\_\_

ATTEST: \_\_\_\_\_

\_\_\_\_\_  
 Keeper of The National Register

SEE INSTRUCTIONS

NATIONAL REGISTER OF HISTORIC PLACES  
INVENTORY - NOMINATION FORM

(Continuation Sheet)

STATE	
California	
COUNTY	
Ventura	
FOR NPS USE ONLY	
ENTRY NUMBER	DATE

(Number all entries)

9. MAJOR BIBLIOGRAPHICAL REFERENCES

Ventura County Historical Society, The Ventura County Historical Society Quarterly, V, No. 2, 1960

Ventura County Historical Society, The Ventura County Historical Society Quarterly, XII, No. 3, 1967

Ventura County Historical Society, The Ventura County Historical Society Quarterly, XVII, No. 4, 1972

The Bard Collection, Naval Facilities Engineering Command Archives,  
Port Hueneme, California

Form 10-301  
(July 1968)

UNITED STATES DEPARTMENT OF THE INTERIOR  
NATIONAL PARK SERVICE  
**NATIONAL REGISTER OF HISTORIC PLACES**  
**PROPERTY MAP FORM**  
(Type all entries - attach to or enclose with map)

1. NAME		
COMMON	AND/OR HISTORIC	NUMERIC CODE (Assigned by NPS)
Bard, Thomas R., Estate	Berylwood	
2. LOCATION		
STATE	COUNTY	TOWN
California	Ventura	Port Hueneme
STREET AND NUMBER		
U. S. Naval Construction Battalion Center		
3. MAP REFERENCE		
SOURCE	DATE	SCALE
U. S. Geological Survey, Oxnard Quadrangle	1949	1:24,000

REQUIREMENTS: PROPERTY BOUNDARIES, WHERE REQUIRED, AND NORTH ARROW.

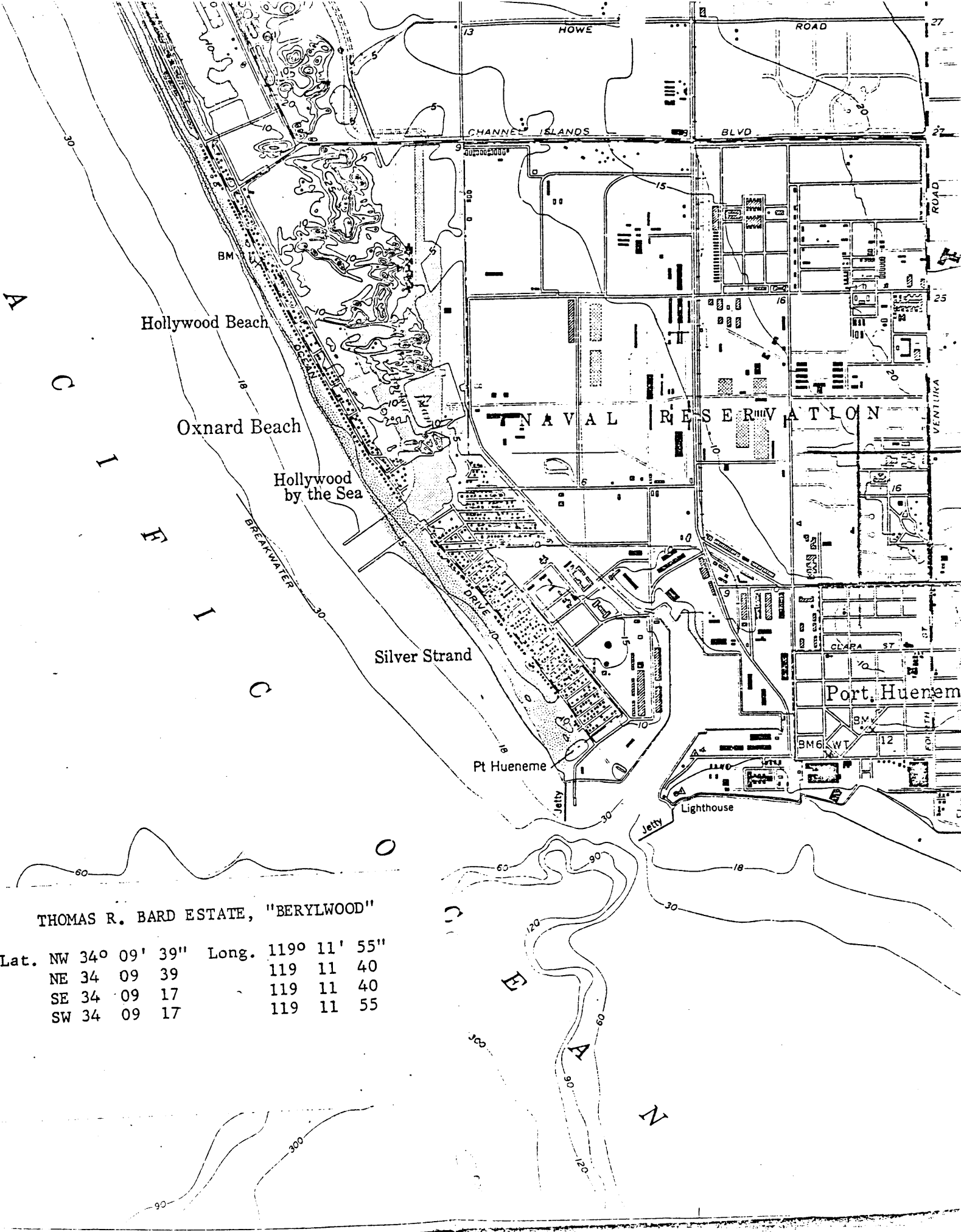

THOMAS R. BARD ESTATE, "BERYLWOOD"

Lat.	NW	34°	09'	39"	Long.	119°	11'	55"
	NE	34	09	39		119	11	40
	SE	34	09	17		119	11	40
	SW	34	09	17		119	11	55



**NATIONAL REGISTER OF HISTORIC PLACES  
PROPERTY MAP FORM**

*(Type all entries - attach to or enclose with map)*

**1. NAME**

COMMON	AND/OR HISTORIC	NUMERIC CODE <i>(Assigned by NPS)</i>
Bard, Thomas R., Estate	Berylwood	SEP 15 1977

**2. LOCATION**

STATE	COUNTY	TOWN
California	Ventura	Port Hueneme

**STREET AND NUMBER**

U. S. Naval Construction Battalion Center

**3. MAP REFERENCE**

SOURCE	DATE	SCALE
Supplementary Material: Map of Historic District		

REQUIREMENTS: PROPERTY BOUNDARIES, WHERE REQUIRED, AND NORTH ARROW.

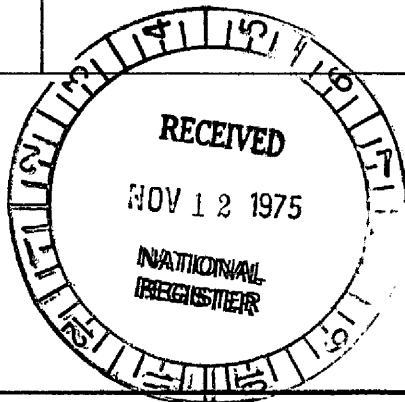

Thomas R. Bard Non-Contiguous Historic District

- A. Tennis Courts
- B. Thomas R. Bard House
- C. Swimming Pool
- D. Richard Bard House
- E. Garage
- F. Guest House
- G. Gardener Tool Shed

Note: The Milk House was moved in 1954 to a location slightly north of this map.

- 1. Botanical Gardens
  - 2. Cemetery
- Not included in nomination.



36th Avenue

A. #5069

F. #39



G. #38



BARD LANE

B. #36

E. #575



D. Qtrs. A



C. #5059

Addor Street

1.

2.

VENTURA ROAD O Club Gate

U.S. NAVAL CONSTRUCTION BATTALION CENTER  
PORT HUENEME, CALIFORNIA

Pleasant Valley Road

Thomas R. Bard Historic District

1. Tennis Courts
2. Guest House
3. Gardener Tool Shed
4. Thomas R. Bard House
5. Garage
6. Richard Bard House
7. Swimming Pool
8. Cemetery
9. Botanical Gardens

Note: The Milk House was moved in 1954 to a location slightly north of this map.

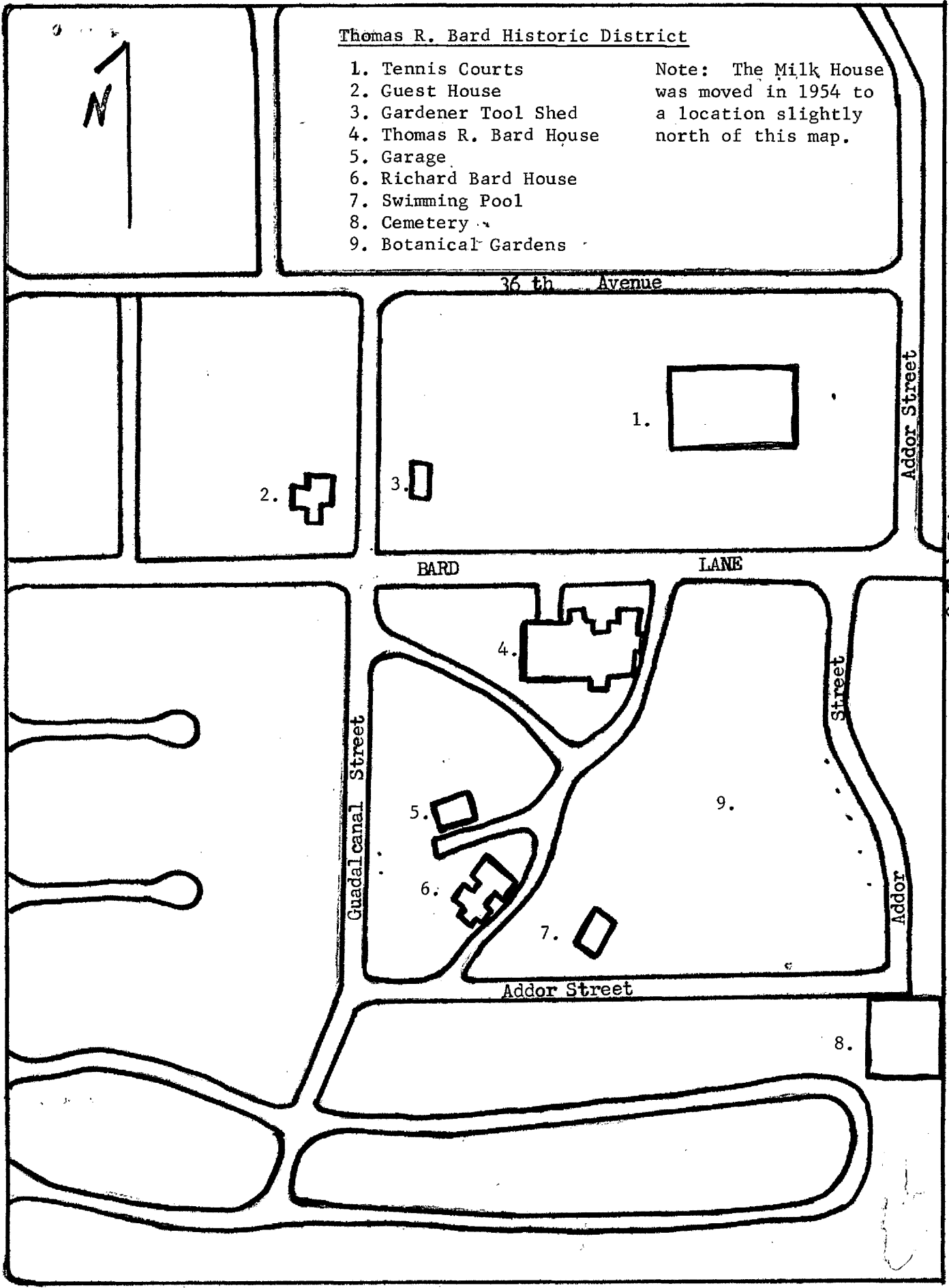

Pleasant Valley Road

O Club Gate Road

Ventura