

P140026212

NATIONAL REGISTER OF HISTORIC PLACES INVENTORY - NOMINATION FORM

(Type all entries - complete applicable sections)

STATE: Maryland

COUNTY: Queen Anne's

FOR NPS USE ONLY

ENTRY DATE: APR 11 1972



1. NAME

COMMON: Readbourne

AND/OR HISTORIC: Readbourne

2. LOCATION

STREET AND NUMBER: .8 mile northwest of intersection of Land's End Road and Sparks Mill Road. Approximately 5.4 miles southwest of

CITY OR TOWN: Centreville *vic.* CONGRESSIONAL DISTRICT: First

STATE: Maryland CODE: 24 COUNTY: Queen Anne's CODE: 035

3. CLASSIFICATION

CATEGORY (Check One)	OWNERSHIP	PUBLIC ACQUISITION	STATUS	ACCESSIBLE TO THE PUBLIC
<input type="checkbox"/> District <input checked="" type="checkbox"/> Building <input type="checkbox"/> Site <input type="checkbox"/> Structure <input type="checkbox"/> Object	<input type="checkbox"/> Public <input checked="" type="checkbox"/> Private <input type="checkbox"/> Both	<input type="checkbox"/> In Process <input type="checkbox"/> Being Considered	<input checked="" type="checkbox"/> Occupied <input type="checkbox"/> Unoccupied <input type="checkbox"/> Preservation work in progress	Yes: <input type="checkbox"/> Restricted <input type="checkbox"/> Unrestricted <input checked="" type="checkbox"/> No

PRESENT USE (Check One or More as Appropriate)

<input checked="" type="checkbox"/> Agricultural	<input type="checkbox"/> Government	<input type="checkbox"/> Park	<input type="checkbox"/> Transportation	<input type="checkbox"/> Comments
<input type="checkbox"/> Commercial	<input type="checkbox"/> Industrial	<input checked="" type="checkbox"/> Private Residence	<input type="checkbox"/> Other (Specify)	
<input type="checkbox"/> Educational	<input type="checkbox"/> Military	<input type="checkbox"/> Religious		
<input type="checkbox"/> Entertainment	<input type="checkbox"/> Museum	<input type="checkbox"/> Scientific		

4. OWNER OF PROPERTY

OWNER'S NAME: Loveland Enterprises, Incorporated (Mr. and Mrs. S.C. Loveland, Jr.)

STREET AND NUMBER: Readbourne

CITY OR TOWN: Centreville STATE: Maryland CODE: 24

5. LOCATION OF LEGAL DESCRIPTION

COURTHOUSE, REGISTRY OF DEEDS, ETC.: Queen Anne's County Courthouse

STREET AND NUMBER: Courthouse Square

CITY OR TOWN: Centreville STATE: Maryland CODE: 24

6. REPRESENTATION IN EXISTING SURVEYS

TITLE OF SURVEY: Maryland Register of Historic Sites and Landmarks

DATE OF SURVEY: 1970 Federal State County Local

DEPOSITORY FOR SURVEY RECORDS: Maryland Historical Trust

STREET AND NUMBER: 2525 Riva Road

CITY OR TOWN: Annapolis STATE: Maryland CODE: 24

SEE INSTRUCTIONS

STATE: Maryland

COUNTY: Queen Anne's

ENTRY NUMBER: APR 11 1972

FOR NPS USE ONLY

DATE

(See Continuation Sheet)

7 DESCRIPTION

CONDITION	(Check One)					
	<input checked="" type="checkbox"/> Excellent	<input type="checkbox"/> Good	<input type="checkbox"/> Fair	<input type="checkbox"/> Deteriorated	<input type="checkbox"/> Ruins	<input type="checkbox"/> Unexposed
	(Check One)			(Check One)		
	<input checked="" type="checkbox"/> Altered	<input type="checkbox"/> Unaltered	<input type="checkbox"/> Moved	<input checked="" type="checkbox"/> Original Site		

DESCRIBE THE PRESENT AND ORIGINAL (if known) PHYSICAL APPEARANCE

Readbourne is a five-part Georgian brick Mansion, the center having been built in the early 1730's by James Hollyday I; the south wing in 1791 by James Hollyday III; and the north wing in 1948 by William Fahnstock, who undertook the restoration and remodeling of the building between 1940 and 1948.

The central part of the house is the most significant, being a 'T' planned, two-story brick building with hip-roof, measuring sixty feet by twenty-three and one-half feet, with the base of the 'T' seventeen and one-half feet by twenty-three and one-half feet. Its plan is similar to Cloverfields, Queen Anne's County, but its style differs from Medieval Cloverfields in that it is an early Georgian structure.

There is a single, chamfered, water table above the basement. The same type of chamfered brick is used beneath the window sills, as the sills are set back from the face of the wall. All the brick walls are laid in Flemish bond; that of the west facade being of more uniform brick. The central entrance of the facade has a semicircular transom above double doors, reputedly the first of its type in the colonies. The semi-circular headed window on the second floor has a gauged brick keystone, as does the door. The west windows have gauged-brick jack arches; the other sides have segmental arches of common brick. The belt course of the west facade is broken above the door due to the height of the arched transom. The ends of both the main belt course and the short section above the door are finished with an ogee curve. The east facade has a window flanking the base of the 'T' on both stories. There are two tall narrow, windows on the first story of the base of the 'T'. An entrance door on the south side of the 'T' opens onto the "stone step room." Both the north and south ends of the original house are hidden by the hyphens.

Readbourne's interior consists of two large rooms flanking a central hall, with staircase and smaller room (the stone step room) in the base of the 'T'. The original walnut staircase and paneled dado remain in place from the second story to the attic. Also the fireplace wall of the second story south room has the original raised paneling, with molding around the fireplace.

The first flight of the stair is a copy of the original, installed when it and the paneling were removed from the remainder of the house in 1928. The woodwork is now at the Henry Francis duPont Museum, Winterthur, Delaware.

Some of the paneling was copied and replaced but the majority of the house has been trimmed with woodwork of eighteenth-century design.

(See Continuation Sheet)

SEE INSTRUCTIONS

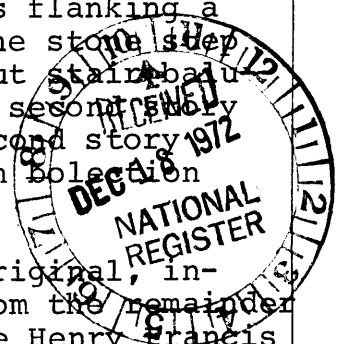

SIGNIFICANCE

PERIOD (Check One or More as Appropriate)

- Pre-Columbian 16th Century 18th Century 20th Century
 15th Century 17th Century 19th Century

SPECIFIC DATE(S) (If Applicable and Known)

AREAS OF SIGNIFICANCE (Check One or More as Appropriate)

- | | | |
|--|--|---|
| <input type="checkbox"/> Aboriginal | <input type="checkbox"/> Education | <input checked="" type="checkbox"/> Political |
| <input type="checkbox"/> Prehistoric | <input type="checkbox"/> Engineering | <input type="checkbox"/> Religion/Philosophy |
| <input type="checkbox"/> Historic | <input type="checkbox"/> Industry | <input type="checkbox"/> Science |
| <input type="checkbox"/> Agriculture | <input type="checkbox"/> Invention | <input type="checkbox"/> Sculpture |
| <input checked="" type="checkbox"/> Architecture | <input checked="" type="checkbox"/> Landscape Architecture | <input type="checkbox"/> Social/Humanitarian |
| <input type="checkbox"/> Art | <input type="checkbox"/> Literature | <input type="checkbox"/> Theater |
| <input type="checkbox"/> Commerce | <input type="checkbox"/> Military | <input type="checkbox"/> Transportation |
| <input type="checkbox"/> Communications | <input type="checkbox"/> Music | |
| <input type="checkbox"/> Conservation | | |

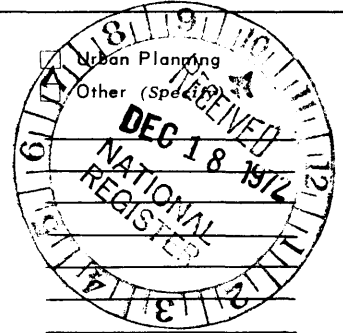

STATEMENT OF SIGNIFICANCE

Readbourne's significance is due chiefly to the Hollyday family, who built the brick house and owned the land between 1730 and 1904. Secondly, the house is the earliest major Georgian structure to remain in the state of Maryland. In scale and detail, it resembles the early Georgian buildings of Virginia and like the great Virginia mansions, Readbourne also possesses a series of fables which carry the symmetry of the house beyond its immediate yard.

The first of the Hollydays was James I (1696-1747), who was a vital figure in the development of the colony between 1720 to 1747. The public offices which he held included Commissioner of Peace for Talbot County in 1723, 1729, 1732, 1735, 1736; member of the Provincial Court at Annapolis in 1732; member of the lower house of the Maryland Assembly between 1724-1732; Treasurer of the Eastern Shore 1727-1747; Naval officer of the Port of Oxford and subsequently the entire Eastern Shore; Councillor of the Lord Proprietor and consequently a member of the Upper House of the Assembly. He married, in 1721, Sarah Covington Lloyd, the widow of Edward Lloyd II. He lived at Wye House and was guardian of the vast Lloyd estate until Edward Lloyd III "came of age" in 1729. His three children were born at Wye House. He was also a founder of the Queen Anne's County free school.

The second James Hollyday (1722-1786) followed his father's footsteps and became a prominent Maryland lawyer. He was a member of the Maryland lower House between 1751-54, and 1758-70; a member of the Council of Safety, 1775-76; a Signer of the Association of Freemen in 1775. He declined several political appointments, one of which was the First Chancellorship under Governor Thomas Johnson in 1776.

James Hollyday III, the son of Henry Hollyday of Ratcliff Manor (1758-1807) was a lawyer and an Associate Judge of the Circuit Court, composed of the Upper Eastern Shore Counties. In 1788, he was a member of the Maryland Convention which ratified the Constitution of the United States.

SEE INSTRUCTIONS

9. MAJOR BIBLIOGRAPHICAL REFERENCES

Bordley, James Jr., "The Hollyday and Related Families of the Eastern Shore of Maryland." Baltimore, Maryland Historical Society, 1962.

Earle, Swepson, "Chesapeake Bay Country", Baltimore, Thomsen-Ellis Company, 1924.

Forman, H. Chandlee, "Maryland Architecture", Cambridge, Maryland. Tidewater Publishers, 1968. (See Continuation Sheet)

10. GEOGRAPHICAL DATA

LATITUDE AND LONGITUDE COORDINATES DEFINING A RECTANGLE LOCATING THE PROPERTY			O R	LATITUDE AND LONGITUDE COORDINATES DEFINING THE CENTER POINT OF A PROPERTY OF LESS THAN TEN ACRES		
CORNER	LATITUDE	LONGITUDE		LATITUDE	LONGITUDE	
	Degrees Minutes Seconds	Degrees Minutes Seconds		Degrees Minutes Seconds	Degrees Minutes Seconds	
NW	34° 07' 38"	76° 05' 26"		° ' "	° ' "	
NE	39° 07' 56"	76° 05' 01"				
SE	39° 07' 11"	76° 03' 58"				
SW	39° 06' 53"	76° 04' 20"				

APPROXIMATE ACREAGE OF NOMINATED PROPERTY: 435 acres 212

LIST ALL STATES AND COUNTIES FOR PROPERTIES OVERLAPPING STATE OR COUNTY BOUNDARIES

STATE:	CODE	COUNTY	CODE
STATE:	CODE	COUNTY:	CODE
STATE:	CODE	COUNTY	CODE
STATE:	CODE	COUNTY	CODE

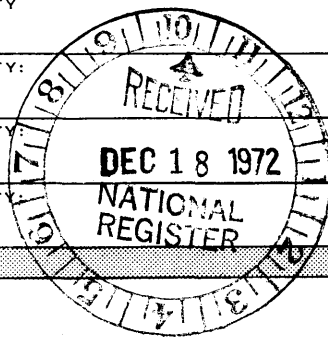

SEE INSTRUCTIONS

11. FORM PREPARED BY

NAME AND TITLE: Michael Bourne, Field Surveyor

ORGANIZATION: Maryland Historical Trust DATE: Nov. 14, 1972

STREET AND NUMBER: 2525 Riva Road

CITY OR TOWN: Annapolis STATE: Maryland CODE: 24

12. STATE LIAISON OFFICER CERTIFICATION

As the designated State Liaison Officer for the National Historic Preservation Act of 1966 (Public Law 89-665), I hereby nominate this property for inclusion in the National Register and certify that it has been evaluated according to the criteria and procedures set forth by the National Park Service. The recommended level of significance of this nomination is:

National State Local

Name Orlando Ridout IV
 Title State Liaison Officer for Maryland
 Date November 15, 1972

NATIONAL REGISTER VERIFICATION

I hereby certify that this property is included in the National Register.

Robert W. Utley
 Director, Office of Archeology and Historic Preservation

Date 4/11/73

ATTEST:
[Signature]
 Keeper of The National Register

Date 4.3.73

NATIONAL REGISTER OF HISTORIC PLACES
INVENTORY - NOMINATION FORM

(Continuation Sheet)

STATE Maryland	
COUNTY Queen Anne's	
FOR NPS USE ONLY	
ENTRY NUMBER	DATE
	APR 11 1973

(Number all entries)

READBOURNE

#6. REPRESENTATION IN EXISTING SURVEYS continued

Historic American Building Survey
Library of Congress
Washington, D.C.

11

x Federal



#7. DESCRIPTION continued

The south wing was built in 1791, about twenty feet from the main part, later connected by a hyphen. Its roof is at right angles to the main roof and there are full pediments on each gable. Its Federal detail is good, but lacks the refinement of the main part. It now houses the kitchen, family room and servants' quarters. In 1948, the north wing was added, mainly to display six eighteenth century mural-size paintings by Vernet. It compliments the house without slavishly copying the older wing. Its interior is very well executed.

#9. MAJOR BIBLIOGRAPHICAL REFERENCES continued

Hammond, John M., "Colonial Mansions of Maryland and Delaware." Philadelphia, J.B. Lippencott Company, 1914.

Hollyday Papers, Maryland Historical Society, Baltimore, Maryland.

Peebles, Anne Bradbury, "Readbourne", privately compiled for William Fahnstock, 1949.

Queen Anne's County Land Records, etc., Hall of Records, Annapolis, Maryland.

Queen Anne's County Wills and Land Records, Queen Anne's County Courthouse, Centreville, Maryland.

Scarborough, Katherine, "Homes of the Cavaliers", New York, The Macmillan Company, 1930.

Waterman, Thomas T., "The Dwellings of Colonial America", Chapel Hill, University of North Carolina Press, 1950.

INTERIOR
BY

(map 1 of 2)

UNITED STATES
DEPARTMENT OF THE ARMY
CORPS OF ENGINEERS

(CHESTERTOWN)

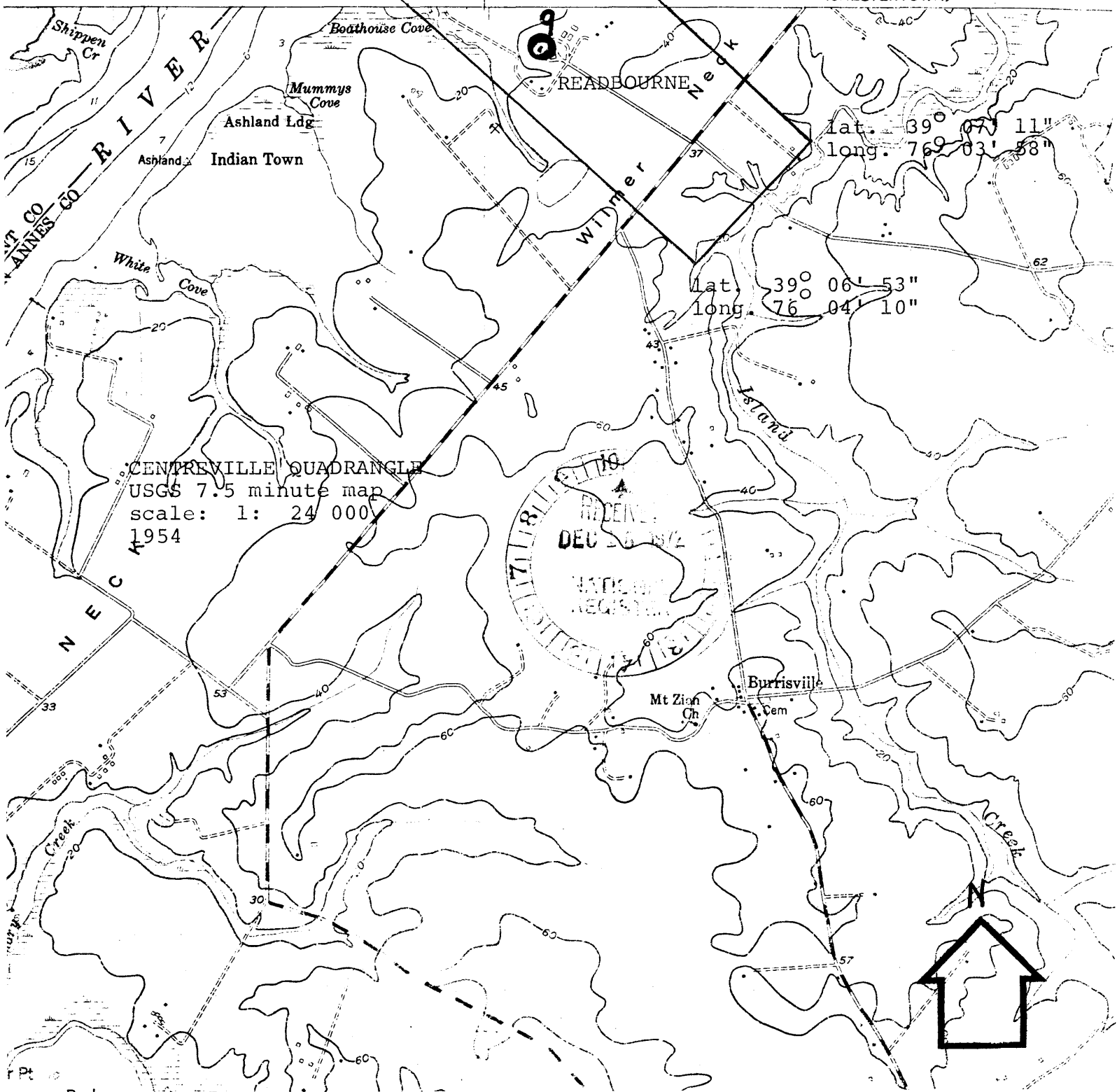

CHESTERTOWN QUADRANGLE
USGS .5 minute map
scale: 1:24 000

Pomona
Cem
Cem

Chapel

Riverside Wharf

Millers I

Nils

Broad Creek

Creek

Dam

CHESTER

Brooms Creek

Taste

Northwest Pt

Down

Old Town

QUEEN ANNES CO
KENT

Riverview

DEC 18 1972

Journey

Jarrett Cr

Melton Pt

lat. 39° 07' 56"
long. 76° 05' 01"

Bookers Wharf

Shippen Creek

Quaker Neck Landing

Shell Pt

Starkiey

lat. 39° 07' 38"
long. 76° 05' 26"

Burns

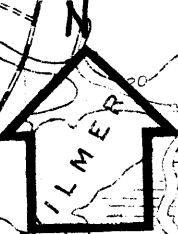

(CENTREVILLE)

gical Survey

from aerial photographs
2
y 1953
dated 1944



READBOURNE

SCALE 1:24000

1 1/2 (map 2 of 2)

