



# HISTORIC RESOURCES INVENTORY

1a. Property name, historic Phoenix Hall; Johnson-Harper House  b. Property name, common E.E. Jackson House		14. MDAH Inventory Code  <hr/> 15. County Hinds	
2. Property address/descriptive location  527 E. Palestine Street, Raymond, Mississippi		17. Was interior surveyed? <input checked="" type="checkbox"/> Yes <input type="checkbox"/> no <input type="checkbox"/> not applicable	16. Survey sequence no. 11  18. Visibility from public road or street <input type="checkbox"/> good <input checked="" type="checkbox"/> poor <input type="checkbox"/> not visible
3. Legal description Parcel #4969-465 as recorded in Second Judicial District Ownership Maps, Vol. 2 for Hinds County, Miss. Acreage = approx. 3.1 acres		19. Condition <input checked="" type="checkbox"/> excellent <input type="checkbox"/> good <input type="checkbox"/> fair <input type="checkbox"/> deteriorated <input type="checkbox"/> ruins <input type="checkbox"/> no visible remains <input type="checkbox"/> incorporated into later structure	
4. Original use Residence	5. Present use Residence	20. USGS quadrangle map (if required) (see instructions) Raymond, MS	
6. Other uses  N/A	7. Original or historically notable owner(s) or occupant(s)  Unknown	21. UTM reference (if required) (see instructions) 15 743140 3571260	
8. Date of construction <input checked="" type="checkbox"/> estimated c. 1854 <input type="checkbox"/> documented	9. Changes <input type="checkbox"/> no major changes <input type="checkbox"/> moved (date) _____ <input checked="" type="checkbox"/> major alterations (date) early 1960s	22. Current owner's name and address (see instructions) Mayor & Mrs. E.E. Jackson P.O. Drawer J Raymond, MS 39154	
10. Architect  Unknown <input type="checkbox"/> documented <input type="checkbox"/> attributed	11. Builder/contractor  Unknown <input type="checkbox"/> documented <input type="checkbox"/> attributed	23. Tenant's name (if required), and address if different from property address (see instructions) (enter in pencil)  N/A	
12. Is the property architecturally or historically important? If so, why? (continue on reverse if necessary) This house is architecturally significant locally as one of six remaining, relatively intact examples of Greek Revival residential architecture in Raymond. Its additions & alterations do not greatly diminish its architectural integrity.		24. Principal material(s) frame (clapboard)	
13. Identify any outbuildings and/or other structures or landscape features associated with this building or structure. (Attach an additional inventory form for each one that has particular architectural or historical interest.) The large yard is landscaped with oak trees, a cypress tree & shrubbery. No out-buildings remain.		25. Architectural character or style Greek Revival	
(Attach one 3 x 5 black and white photograph here.)		<b>THIS SECTION FOR MDAH USE ONLY</b>	
		26. Category building	
		27. Functional type  	
		28. Registration status and dates <input type="checkbox"/> NHL _____ <input type="checkbox"/> listed NR _____ <input type="checkbox"/> approved for NR _____ <input type="checkbox"/> federal DOE _____ <input type="checkbox"/> state landmark _____ <input type="checkbox"/> local landmark _____ <input type="checkbox"/> HABS/HAER _____	
		29. Is this property included in a historic district? <input type="checkbox"/> yes <input type="checkbox"/> NR district <input type="checkbox"/> no <input type="checkbox"/> proposed <input type="checkbox"/> local district Name of district _____ _____ <input type="checkbox"/> pivotal <input type="checkbox"/> marginal <input type="checkbox"/> contributing <input type="checkbox"/> noncontributing <input type="checkbox"/> intrusion	

30. Brief statement of the property's history This house was built by Amos Johnson, a circuit judge. It has been called Phoenix Hall because it is believed to have been constructed on the same site as Johnson's first home which burned. He sold the house to George Harper in 1861. By this time, Harper was sole owner & editor of the Hinds County Gazette. He was also active locally in religious, social and political affairs. When the Union troops came through Raymond in 1863, they threw his printing presses into a well and 2 years passed before his newspaper resumed publication.

In Jan. 1883, he turned over the editorship of the Gazette to his son, Samuel. In 1875 & 1876, George W. Harper served in the Miss. legislature. (continued)

31. Brief description. If a thorough description has been prepared separately, disregard this section and check here  The main section of this house is 1 story & 5 bays wide with a central hall plan. The front porch features pillars supporting a pedimented gable peak. The exterior wall located in this porch area is sheathed in flushboard. The centrally located front entrance is flanked by sidelights and capped by a transom, all with diamond-shaped panes of glass. The 9/9 double hung sash windows have louvred shutters. The full entablature includes a bracketed frieze. Major alterations include a new wing containing the garage on the South facade, a small wing added to the north facade (replacing the original porch, which was torn away) and a new, rear porch with a (cont

32. Additional remarks or continuation of other sections

30. The house underwent a major renovation in 1962. Leon Burton was the architect in charge.

31. brick deck and steps and wrought iron railings. A late nineteenth century porch with Eastlake elements which was located to the south of the front portico and wrapped around to the south facade was probably removed during a major rehabilitation of the house in 1962.

33. Sources of information
- Personal Observation
  - Statewide Survey File
  - North Toward Home by Willie Morris (1967)
  - A History of Raymond United Methodist Church and the Town of Raymond, Mississippi (1837-1971) (no author, no date)
  - Interview with Mrs. Margaret Jackson (1-86)

35. Photographer or photo source  
Susan Enzweiler

36. Photo roll and frame number(s)  
#1651 - 23A

37. Photo date  
10-25-85

38. Inventory form completed by (name and organization)  
Susan Enzweiler  
Mississippi Dept. of Archives & History

39. Survey project name  
Raymond

40. Date form completed  
12-85

34. Sketch of site plan. (Include north arrow. Show outline of building shape and locations of outbuildings.)

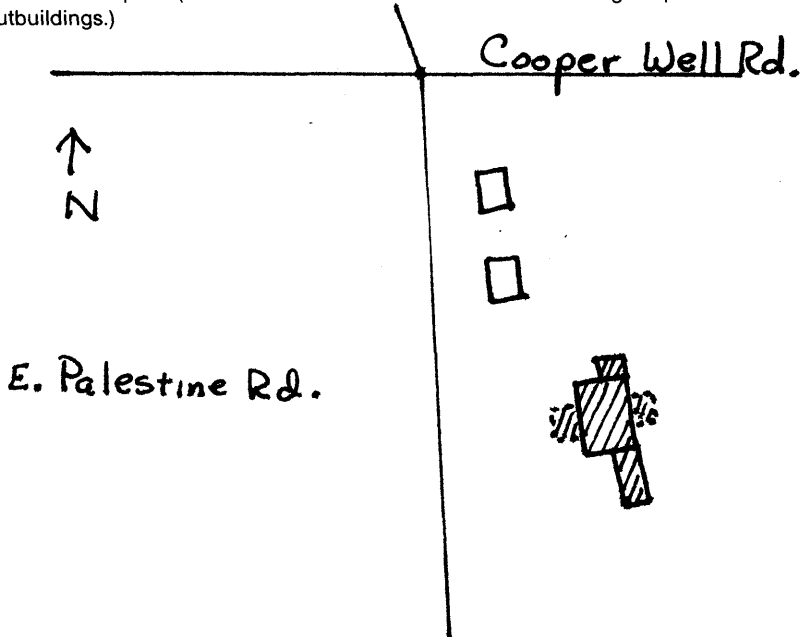

**THIS SECTION FOR MDAH USE ONLY**

41. Attached supplementary materials

42. Other materials in MDAH files
- plans, drawings
  - correspondence
  - research notes
  - clippings
  - project report
  - early photos
  - slides
  - negatives
  - other

43. Date logged, MDAH

44. Logged by