

# KENTUCKY HISTORIC RESOURCES INVENTORY

Tm-86  
Site No. \_\_\_\_\_

1. Historic Name(s) <b>Trout House</b>		22. ADD/County <b>No. Ky./Trimble</b> <span style="float: right; border: 1px solid black; padding: 2px;">1 1 2</span>	
Original Owner		23. U.S.G.S. Quadrant (15'/75') <b>Madison West</b> <span style="float: right; border: 1px solid black; padding: 2px;"> </span>	
2. Present Name <b>Blossom Hill Farm</b>		24. UTM Reference <b>16 6 3 7 8 6 0 4 2 8 1 2 4 0</b>	
3. Location <b>State <sup>KY</sup> Highway 625</b> <span style="float: right;"><i>millers</i></span>		Zone Easting Northing	
4. Owner's Name <b>Mrs. Jo Ellen Jackson</b>		25. Coordinate Accuracy <span style="float: right;"><input type="checkbox"/></span>	
5. Owner's Address <b>Route # 2, Milton, Kentucky</b>		26. Prehistoric Site Object Historic Site Structure ( Building ) Other	
6. Open to Public Yes <input type="checkbox"/> No <input checked="" type="checkbox"/>	7. Visible from road Yes <input type="checkbox"/> No <input checked="" type="checkbox"/>	8. Ownership Private <input checked="" type="checkbox"/> Local <input type="checkbox"/> State <input type="checkbox"/> Federal <input type="checkbox"/>	
9. Local Contact/Organization		27. National Register District Name: <b>Historic Resources of Trimble County</b> <span style="float: right; border: 1px solid black; padding: 2px;"> </span>	
10. Site Plan with North Arrow		28. Significance Evaluation <b>National Register</b> <span style="float: right; border: 1px solid black; padding: 2px;">D</span>	
		29. Status Date National Landmark <input type="checkbox"/> National Register <input type="checkbox"/> Landmark Certificate <input type="checkbox"/> Kentucky Survey <input type="checkbox"/> Local Landmark <input type="checkbox"/> HABS/HAER <input type="checkbox"/>	
		30. Historic Theme Primary <b>Architecture</b> <span style="float: right; border: 1px solid black; padding: 2px;">C</span> Secondary <input type="checkbox"/> Other <input type="checkbox"/>	
		31. Endangered Yes <input type="checkbox"/> No <input checked="" type="checkbox"/>	
		32. Preservation Project Status <span style="float: right;"><input type="checkbox"/></span>	
		Actual Cost in \$1,000s <span style="float: right; border: 1px solid black; padding: 2px;"> </span>	
		33. ATTACH PHOTO	
11. Architect			
12. Builder <b>Trout</b>			
13. Date <b>ca. 1859</b> A. <input checked="" type="checkbox"/> B. <input type="checkbox"/>			
14. Style A. <b>Greek Revival</b> <input checked="" type="checkbox"/> B. <input type="checkbox"/>			
15. Original Use <b>Dwelling</b> <input checked="" type="checkbox"/>			
16. Present use <b>Dwelling</b>			
17. Condition <b>Excellent</b> <input checked="" type="checkbox"/>			
18. Description <b>Two-story frame with one-story frame ell. Five-bay with central entrance with three-pane side-lights and two-pane transom. Two story, one-bay projecting pedimented portico. Windows 4/4 pane on facade. Cornice with returns. Interior gable-end brick chimneys on main block; two offcenter brick ridgeline chimneys on ell, one of which has been stuccoed. One story</b> <small>(Continue on Back)</small>		No. Stories <b>Two</b> <input checked="" type="checkbox"/>	
		Single Pile <input checked="" type="checkbox"/> NA <input type="checkbox"/>	
		Double Pile <input type="checkbox"/>	
		Floor Plan <b>Central Passage</b> <input checked="" type="checkbox"/>	
		Structural Fabric <b>Frame</b> A. <input checked="" type="checkbox"/> B. <input type="checkbox"/>	
		Decorative Fabric A. <input type="checkbox"/> B. <input type="checkbox"/>	
		Roof Form <b>Gable</b>	
19. History <b>Second of Trout Houses built by the two brothers. Windmill behind the house.</b>		Roll No. <b>57</b>	
		Picture No. <b>18 - 36</b>	
		Direction _____	
		34. Prepared by: <b>William Gus Johnson</b> <b>Senior Historian</b>	
20. Significance <b>Architecture: The Trout House is one of the best examples of frame Greek Revival houses in the County.</b>		35. Organization <b>Kentucky Heritage Council</b>	
		36. Date <b>September 1982</b>	
21. Source of Information <b>Collins, Richard. History of Kentucky, Vol. II, 1874.</b> <b>Perrin, W.H., Kentucky, A History of the State. 1887.</b> <b>Trimble County Tax Assessment Records, 1850-1870.</b>		37. Revision Dates _____ 38. Staff Review _____	

18. frame addition on open side of ell, which also has a one-story three-bay open porch. Limestone foundation. Rear windows 4/4 pane. Pilasters at each end of main block.

Outbuildings:

1. Windmill
2. One-story frame corn crib on fieldstone pillars
3. One and 1/2 story frame barn.

KENTUCKY HISTORIC RESOURCE INVENTORY SUPPLEMENT  
BOUNDARY AND LOCATION INFORMATION

Historic Property Name Trout House Site # Tm-86

Multiple Resource/Thematic Nomination Title Historic Resources of Trimble County

U.T.M. Coordinates - List multiple UTMs if property is ten or more acres.

A. 16 637860 4281240 D. \_\_\_\_\_  
 B. \_\_\_\_\_ E. \_\_\_\_\_  
 C. \_\_\_\_\_ F. \_\_\_\_\_

Verbal Boundary Description Acreage 2

Beginning at a point on the east side of the farm lane, approximately 60' from the house, proceed 200' in an eastward direction; thence 400' in a northward direction; thence 200' in a westward direction; thence 400' in a southward direction to the point of origin. The boundary is drawn to include the house and outbuildings.

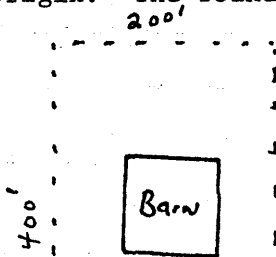

Sketch of Site Plan (Showing outbuildings, structures, landscape features and the site boundary as described above.)

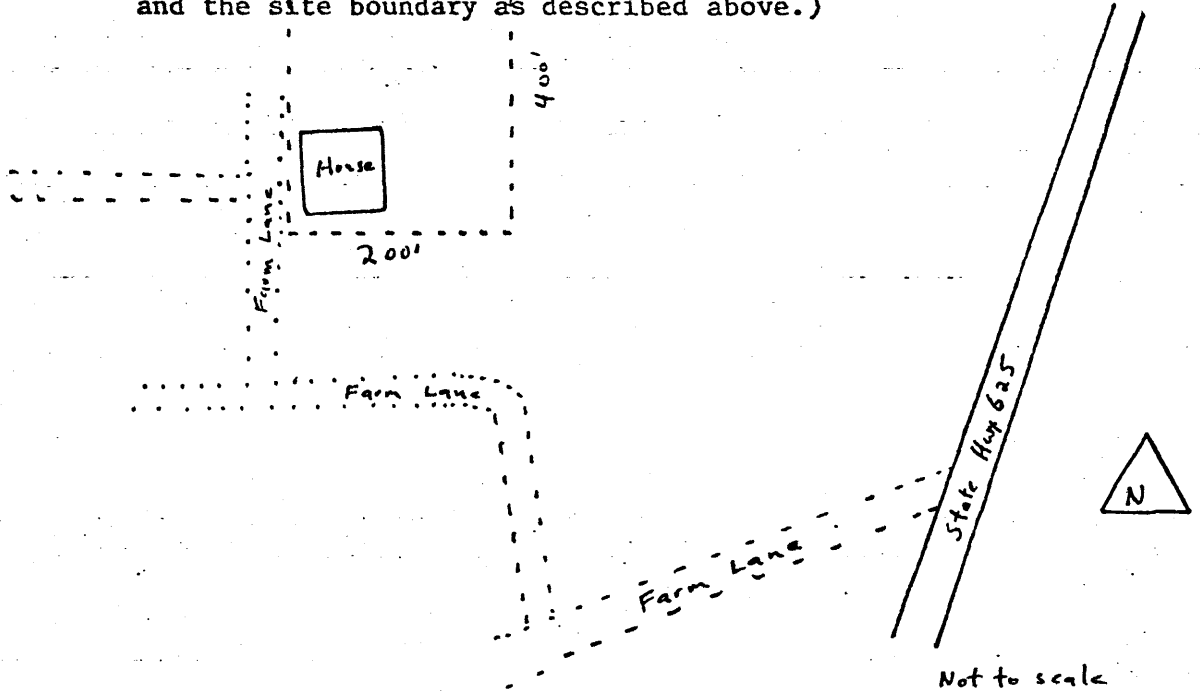

Official Courthouse Property Reference: