

PH0507784

DATA SHEET

UNITED STATES DEPARTMENT OF THE INTERIOR
NATIONAL PARK SERVICE

FOR NPS USE ONLY
RECEIVED NOV 18 1977
DATE ENTERED JUL 12 1978

NATIONAL REGISTER OF HISTORIC PLACES INVENTORY -- NOMINATION FORM

SEE INSTRUCTIONS IN *HOW TO COMPLETE NATIONAL REGISTER FORMS*
TYPE ALL ENTRIES -- COMPLETE APPLICABLE SECTIONS

NAME

HISTORIC Charles Libby House

AND/OR COMMON Goldie Rush's House

LOCATION

STREET & NUMBER 636 Rockledge Street

CITY, TOWN Oceanside — NOT FOR PUBLICATION
CONGRESSIONAL DISTRICT

STATE California 92054 VICINITY OF 10th
COUNTY CODE 06 San Diego CODE 073

CLASSIFICATION

CATEGORY	OWNERSHIP	STATUS	PRESENT USE
<input type="checkbox"/> DISTRICT	<input type="checkbox"/> PUBLIC	<input type="checkbox"/> OCCUPIED	<input type="checkbox"/> AGRICULTURE <input type="checkbox"/> MUSEUM
<input checked="" type="checkbox"/> BUILDING(S)	<input checked="" type="checkbox"/> PRIVATE	<input type="checkbox"/> UNOCCUPIED	<input type="checkbox"/> COMMERCIAL <input type="checkbox"/> PARK
<input type="checkbox"/> STRUCTURE	<input type="checkbox"/> BOTH	<input checked="" type="checkbox"/> WORK IN PROGRESS	<input type="checkbox"/> EDUCATIONAL <input checked="" type="checkbox"/> PRIVATE RESIDENCE
<input type="checkbox"/> SITE	PUBLIC ACQUISITION	ACCESSIBLE	<input type="checkbox"/> ENTERTAINMENT <input type="checkbox"/> RELIGIOUS
<input type="checkbox"/> OBJECT	<input type="checkbox"/> IN PROCESS	<input type="checkbox"/> YES: RESTRICTED	<input type="checkbox"/> GOVERNMENT <input type="checkbox"/> SCIENTIFIC
	<input type="checkbox"/> BEING CONSIDERED	<input type="checkbox"/> YES: UNRESTRICTED	<input type="checkbox"/> INDUSTRIAL <input type="checkbox"/> TRANSPORTATION
		<input type="checkbox"/> NO	<input type="checkbox"/> MILITARY <input type="checkbox"/> OTHER:

OWNER OF PROPERTY

NAME Eitan Meir Aharoni

STREET & NUMBER 636 Rockledge Street

CITY, TOWN Oceanside STATE
California 92054

LOCATION OF LEGAL DESCRIPTION

COURTHOUSE, REGISTRY OF DEEDS, ETC. San Diego County Courthouse

STREET & NUMBER 210 West Broadway

CITY, TOWN San Diego STATE
Ca

REPRESENTATION IN EXISTING SURVEYS

TITLE None

DATE — FEDERAL — STATE — COUNTY — LOCAL

DEPOSITORY FOR SURVEY RECORDS

CITY, TOWN STATE

7 DESCRIPTION

CONDITION		CHECK ONE	CHECK ONE
<input type="checkbox"/> EXCELLENT	<input type="checkbox"/> DETERIORATED	<input type="checkbox"/> UNALTERED	<input type="checkbox"/> ORIGINAL SITE
<input type="checkbox"/> GOOD	<input type="checkbox"/> RUINS	<input checked="" type="checkbox"/> ALTERED	<input checked="" type="checkbox"/> MOVED DATE <u>8/4/77</u>
<input checked="" type="checkbox"/> FAIR	<input type="checkbox"/> UNEXPOSED		

DESCRIBE THE PRESENT AND ORIGINAL (IF KNOWN) PHYSICAL APPEARANCE

GENERAL DESCRIPTION

The subject home was constructed at the turn of the century by Charles Bibby, one of the founders of the City of Oceanside. The architectural style selected for the building was Victorian as shown in the enclosed photo exhibits.

Careful investigation of the roof and floor plans hint at a deliberate attempt by the architect (unknown) to duplicate the European cathedral layout -- namely the "cross" plan.

Situated on a ridge line, the building possessed an unobstructed view of the ocean until the downtown section of Oceanside was built on said land. The access to the property was via a trail from Mission Avenue which connects the downtown area with the famed Mission San Luis Rey.

CONSTRUCTION

Materials used for construction were wood framing, lath and plaster interiors, and horizontal cedar sidings on the exterior. Exterior trim pieces were skillfully carved to fit at joints around the bay window and porches. The ceilings are 10' high on both levels. Roofs are steep and covered with wood shakes. Double hung windows were used. Porches and bay window contained tapered columns with bases and caps.

The building has two brick chimneys, both in poor condition; one serves a fireplace located at the original dining room; the other served the pot belly stove in the kitchen. The latter chimney is uniquely located on top of a thick wood cabinet used from the first floor bathroom.

The interior contains wood floors, eight inch wide stained base board, and four inch wide stained wood jambs around all doors. In addition, a wood picture rack trim (moulding) is mounted horizontally in each room approximately 8' high. There are 10 rooms in the house, a cast iron bathtub, circular staircase, and a functional entry bell. The electric light switches cover plates are solid brass.

EFFECT OF MOVE

The Charles Libby building was scheduled to be demolished at the end of July, 1977 by the previous owner in order to prepare the site for an office and apartment complex. Similar buildings in the area have been destroyed in the past few years to allow for the construction of a shopping center and Freeway I-5. The Charles Libby House is the last of its kind in Oceanside.

The Present owner relocated the building to a nearby site on August 4, 1977 (with the support and cooperation of the Oceanside City Council, the local members of the Historic Society, and the utility companies.)

(See continuation sheet)

✓

8 SIGNIFICANCE

PERIOD	AREAS OF SIGNIFICANCE -- CHECK AND JUSTIFY BELOW			
<input type="checkbox"/> PREHISTORIC	<input type="checkbox"/> ARCHEOLOGY-PREHISTORIC	<input type="checkbox"/> COMMUNITY PLANNING	<input type="checkbox"/> LANDSCAPE ARCHITECTURE	<input type="checkbox"/> RELIGION
<input type="checkbox"/> 1400-1499	<input type="checkbox"/> ARCHEOLOGY-HISTORIC	<input type="checkbox"/> CONSERVATION	<input type="checkbox"/> LAW	<input type="checkbox"/> SCIENCE
<input type="checkbox"/> 1500-1599	<input type="checkbox"/> AGRICULTURE	<input type="checkbox"/> ECONOMICS	<input type="checkbox"/> LITERATURE	<input type="checkbox"/> SCULPTURE
<input type="checkbox"/> 1600-1699	<input checked="" type="checkbox"/> ARCHITECTURE	<input type="checkbox"/> EDUCATION	<input type="checkbox"/> MILITARY	<input type="checkbox"/> SOCIAL/HUMANITARIAN
<input type="checkbox"/> 1700-1799	<input type="checkbox"/> ART	<input type="checkbox"/> ENGINEERING	<input type="checkbox"/> MUSIC	<input type="checkbox"/> THEATER
<input type="checkbox"/> 1800-1899	<input type="checkbox"/> COMMERCE	<input type="checkbox"/> EXPLORATION/SETTLEMENT	<input type="checkbox"/> PHILOSOPHY	<input type="checkbox"/> TRANSPORTATION
<input checked="" type="checkbox"/> 1900-	<input type="checkbox"/> COMMUNICATIONS	<input type="checkbox"/> INDUSTRY	<input type="checkbox"/> POLITICS/GOVERNMENT	<input type="checkbox"/> OTHER (SPECIFY)
		<input type="checkbox"/> INVENTION		

SPECIFIC DATES	c. 1902-1905	BUILDER/ARCHITECT	unknown
----------------	--------------	-------------------	---------

STATEMENT OF SIGNIFICANCE

The Charles Libby House, built sometime between 1902 and 1905 by Charles Libby, one of Oceanside's founders, remains as the best example of late Victorian/Colonial Revival architecture in Oceanside. Libby, a local real estate broker and city councilman, built the house on a prominent ridge overlooking the Pacific Ocean to attract others to the city. In the 1920's, the house was purchased by Goldie Rush -- a burlesque queen and performer who occupied the building until her death in 1968. Goldie was noted for collecting furniture which was sold upon her death. In addition, she was known to raise prize chickens and preserve fruits and vegetables. Approximately 1000 antique glass jars are still kept in the house.

Although the building has been moved, its new location approximates the old in size and topography. The house was relocated in 1977 to save it from demolition and the relocation received the full support of the City Council and local citizens. The building is basically unaltered and restoration will return it to its original condition.

The Charles Libby House is both architecturally and historically significant. In spite of the fact that it has been relocated, it represents one of Oceanside's last tangible links to its early development, and remains the city's finest example of late Victorian/Colonial Revival architecture.

9 MAJOR BIBLIOGRAPHICAL REFERENCES

No major written reference is available, however most data was gathered by communication with relatives and colleagues of the owners, Charles Libby and Goldie Rush, such as:

- Mrs. Simpson Libby -- daughter-in-law of Charles Libby (see enclosed letter)
- Mr. Robert Frazee -- grandchild of Charles Libby and presently the mayor of the City of Carlsbad (cont.)

10 GEOGRAPHICAL DATA

ACREAGE OF NOMINATED PROPERTY 1/4 acre

UTM REFERENCES

A	1 1	4 6 5 8 6 0	3 6 7 2 3 7 0	B			
	ZONE	EASTING	NORTHING		ZONE	EASTING	NORTHING
C				D			

VERBAL BOUNDARY DESCRIPTION

The historic building is relocated to a new site 90' wide, 110' deep on ridge visible from I-5. Building possesses view of mountains, City golf course, and partial view of ocean. See attached plat.

LIST ALL STATES AND COUNTIES FOR PROPERTIES OVERLAPPING STATE OR COUNTY BOUNDARIES

STATE	CODE	COUNTY	CODE
STATE	CODE	COUNTY	CODE

11 FORM PREPARED BY

NAME / TITLE

Eitan Aharoni / owner

6/20/77

ORGANIZATION

636 Rockledge Street

DATE

(work) 433-9000 Ext. 206

STREET & NUMBER

Oceanside, California 92054

TELEPHONE

CITY OR TOWN

STATE

12 STATE HISTORIC PRESERVATION OFFICER CERTIFICATION

THE EVALUATED SIGNIFICANCE OF THIS PROPERTY WITHIN THE STATE IS:

NATIONAL

STATE

LOCAL

As the designated State Historic Preservation Officer for the National Historic Preservation Act of 1966 (Public Law 89-665), I hereby nominate this property for inclusion in the National Register and certify that it has been evaluated according to the criteria and procedures set forth by the National Park Service.

STATE HISTORIC PRESERVATION OFFICER SIGNATURE

K. M. Allen

TITLE State Historic Preservation Officer

DATE November 11, 1977

FOR NPS USE ONLY

I HEREBY CERTIFY THAT THIS PROPERTY IS INCLUDED IN THE NATIONAL REGISTER

W. M. ...
 DIRECTOR, OFFICE OF ARCHEOLOGY AND HISTORIC PRESERVATION
 ATTEST: *W. M. ...*
 KEEPER OF THE NATIONAL REGISTER

DATE 7/12/78
 KEEPER OF THE NATIONAL REGISTER
 DATE 6/29/78

UNITED STATES DEPARTMENT OF THE INTERIOR
NATIONAL PARK SERVICE

**NATIONAL REGISTER OF HISTORIC PLACES
INVENTORY -- NOMINATION FORM**

FOR NPS USE ONLY
RECEIVED NOV 18 1977
DATE ENTERED JUL 12 1978

CONTINUATION SHEET

ITEM NUMBER 7

PAGE 1

The new site is located approximately 1/2 mile south, on the same topographic ridgeline, possessing panoramic view of the mountains to the east and limited view of the ocean to the west.

The site is comparable to the original site in size and is more readily visible and accessible to travellers from I-5. The zoning of the present site (R-1) insures its permanence. An effort is being made by the present owner to reconstruct the facade of the original garage (stables) and to relocate portions of the original landscaping.

The move had been supported by the community.

UNITED STATES DEPARTMENT OF THE INTERIOR
NATIONAL PARK SERVICE

**NATIONAL REGISTER OF HISTORIC PLACES
INVENTORY -- NOMINATION FORM**

FOR NPS USE ONLY	
RECEIVED	NOV 18 1977
DATE ENTERED	JUL 12 1978

CONTINUATION SHEET

ITEM NUMBER 9 PAGE 2

Bibliographical references, cont.

Lucy Chavez -- a lifelong member of the local community, a personal acquaintance of Goldie Ruch, and presently a councilwoman.
Henry Collins and Ernest Taylor -- members of the Santa Marguerita Historic Society.

ROUTE MAP



Relocation of
BLOG FROM
1102 4th St. to
636 Rockledge.
40' x 56' long.
Height clearance = 31'
(old height 26'-8")

Engineering OK R.C.S.
fire Dept. ~~W.A.T.~~ OK
Police OK by Sgt. Meyer 5-23-77
planning OK Lucita.
streets OK L.A.R.

E.M. AHARON:
CITY HALL
433-9000
R 206

REVISION	DATES

ZONING MAP		
ORDINANCE 58-1		
Commercial	Residential	Industrial
C1 NEIGHBORHOOD COMMERCIAL	PRD PLANNED RESIDENTIAL DEVELOPMENT	IP INDUSTRIAL PARK
C2 GENERAL COMMERCIAL	PCD PLANNED COMMUNITY DEVELOPMENT	M1 LIGHT INDUSTRIAL

CITY OF OCEANSIDE	
Agricultural	Suburban Agricultural
A2½ SUBURBAN AGRICULTURAL	A5 GENERAL AGRICULTURAL

new site

150 - 33

1" = 100'

7-1-75

45

SW 1/4 OF NW 1/4 SEC 26 T15 R15W SBM

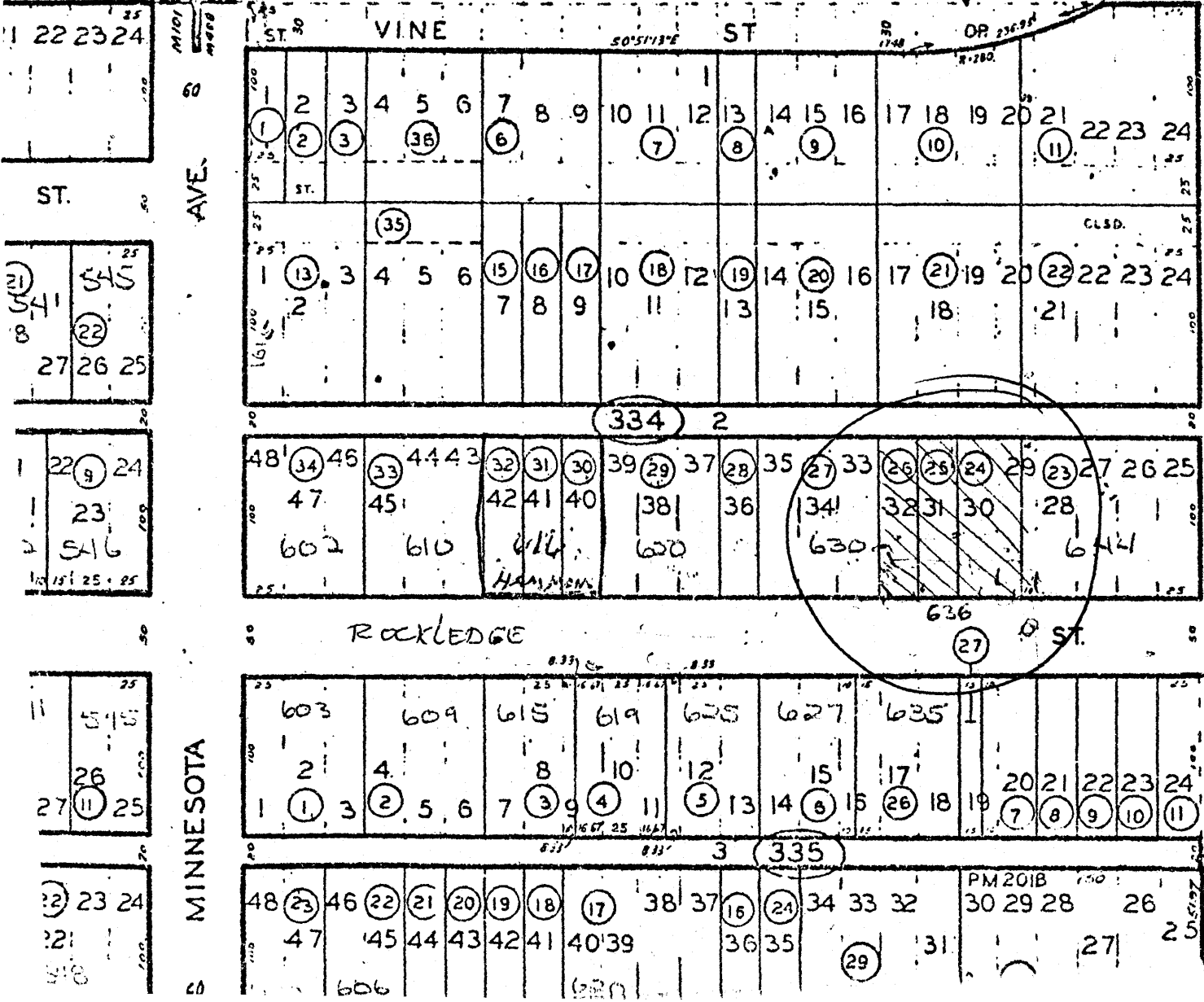

CHANGES

BLK	OLD	NEW	YR	CUT
331	10	22 23	66	3677
332	17	20 21	69	
333	7, 2	9, 10	69	5654
334	12 6 14	35	70	2482
335	15	24 25	71	1731
333	4-5	11	72	1245
334	4-5	36	72	7462
335	13	26 27	73	3427
335	12, 14, 25	29, 30	74	2931
		(1991) 416-42		
332	10	21 22	75	3656

41

MAP 1787

PLUMOSA HIS

POP. SEC. 14 SEC. 26 T15 R15W

CALIFORNIA ST.

MINNESOTA AVE.

60

22 23 24

ST.

21 541 545 22 27 26 25

22 9 24 23 546

26 27 11 25

23 24 21 548

ST. VINE ST. 50' 5 1/2' ST. 17' 48' 236' 9"

1 2 3 4 5 6 7 8 9 10 11 12 13 14 15 16 17 18 19 20 21 22 23 24
 13 3 4 5 6 15 16 17 18 19 20 21 22 23 24
 13 3 4 5 6 7 8 9 10 11 12 13 14 15 16 17 18 19 20 21 22 23 24

334 2
 48 34 45 33 44 43 32 31 30 39 29 37 28 35 27 33 26 25 24 29 23 27 26 25
 47 45 42 41 40 38 36 34 32 31 30 28 28 1 1
 602 610 614 620 630 636 644

ROCKLEDGE ST.
 603 609 615 619 625 627 635
 2 4 8 10 12 15 17 20 21 22 23 24
 1 1 3 2 5 6 7 3 9 4 11 5 13 14 6 15 26 18 19 7 8 9 10 11

335
 48 23 46 22 21 20 19 18 17 38 37 16 24 34 33 32 30 29 28 26
 47 45 44 43 42 41 40 39 36 35 29 31 27 25
 606 620