

UNITED STATES DEPARTMENT OF THE INTERIOR
NATIONAL PARK SERVICE

DATA SHEET

FOR NPS USE ONLY
RECEIVED DEC 29 1975
DATE ENTERED JAN 30 1976

NATIONAL REGISTER OF HISTORIC PLACES
INVENTORY -- NOMINATION FORM

SEE INSTRUCTIONS IN HOW TO COMPLETE NATIONAL REGISTER FORMS
TYPE ALL ENTRIES -- COMPLETE APPLICABLE SECTIONS

1 NAME

HISTORIC Lewis Street ^{R. L. ...} District

AND/OR COMMON

2 LOCATION

STREET & NUMBER #1-#33, #24-36 Lewis Street, #8-28 Trumbull Street;
#60 Gold Street

CITY, TOWN Hartford VICINITY OF 1st-William R. Cotter
STATE Connecticut CODE 09 COUNTY Hartford CODE 003

3 CLASSIFICATION

CATEGORY	OWNERSHIP	STATUS	PRESENT USE
<input checked="" type="checkbox"/> DISTRICT	<input checked="" type="checkbox"/> PUBLIC	<input checked="" type="checkbox"/> OCCUPIED	<input type="checkbox"/> AGRICULTURE <input type="checkbox"/> MUSEUM
<input type="checkbox"/> BUILDING(S)	<input checked="" type="checkbox"/> PRIVATE	<input type="checkbox"/> UNOCCUPIED	<input checked="" type="checkbox"/> COMMERCIAL <input type="checkbox"/> PARK
<input type="checkbox"/> STRUCTURE	<input type="checkbox"/> BOTH	<input type="checkbox"/> WORK IN PROGRESS	<input type="checkbox"/> EDUCATIONAL <input type="checkbox"/> PRIVATE RESIDENCE
<input type="checkbox"/> SITE	PUBLIC ACQUISITION	ACCESSIBLE	<input type="checkbox"/> ENTERTAINMENT <input checked="" type="checkbox"/> RELIGIOUS
<input type="checkbox"/> OBJECT	<input type="checkbox"/> IN PROCESS	<input checked="" type="checkbox"/> YES: RESTRICTED	<input type="checkbox"/> GOVERNMENT <input type="checkbox"/> SCIENTIFIC
	<input type="checkbox"/> BEING CONSIDERED	<input type="checkbox"/> YES: UNRESTRICTED	<input type="checkbox"/> INDUSTRIAL <input type="checkbox"/> TRANSPORTATION
		<input type="checkbox"/> NO	<input type="checkbox"/> MILITARY <input type="checkbox"/> OTHER:

4 OWNER OF PROPERTY

NAME Multiple, public and private

STREET & NUMBER City of Hartford

CITY, TOWN Hartford VICINITY OF STATE Connecticut

5 LOCATION OF LEGAL DESCRIPTION

COURTHOUSE, REGISTRY OF DEEDS, ETC. Hartford Town Clerk, Hartford Municipal Building

STREET & NUMBER 550 Main St.

CITY, TOWN Hartford STATE Connecticut

6 REPRESENTATION IN EXISTING SURVEYS

TITLE Connecticut Statewide Inventory of Historic Resources

DATE 1975 FEDERAL STATE COUNTY LOCAL

DEPOSITORY FOR SURVEY RECORDS Connecticut Historical Commission

CITY, TOWN Hartford STATE Connecticut

7 DESCRIPTION

CONDITION		CHECK ONE	CHECK ONE
<input type="checkbox"/> EXCELLENT	<input type="checkbox"/> DETERIORATED	<input type="checkbox"/> UNALTERED	<input checked="" type="checkbox"/> ORIGINAL SITE
<input checked="" type="checkbox"/> GOOD	<input type="checkbox"/> RUINS	<input checked="" type="checkbox"/> ALTERED	<input type="checkbox"/> MOVED DATE _____
<input type="checkbox"/> FAIR	<input type="checkbox"/> UNEXPOSED		

DESCRIBE THE PRESENT AND ORIGINAL (IF KNOWN) PHYSICAL APPEARANCE

Lewis Street is located in the heart of downtown Hartford, one block west of Main Street and runs for one block north to south from Gold Street to Pearl Street. The south portion of this block and adjacent structures on Trumbull and Gold Street are hereby nominated to the National Register. Five modest mid-nineteenth century brick houses remain in a cluster on the street. Adjoining Lewis Street to the east are the Old Burying Ground and Center Congregational Church and to the south is Bushnell Park, both National Register properties.

Of the five circa-1850 houses, the two on the ^{West} south side of the street are occupied by a law firm. Of the three across the street, one is devoted to offices, one is the University Club and one is vacant (firm plans exist for its use as a restaurant). On the southeast corner is a large Georgian Revival turn-of-the-century church house of the Congregational Church. Other buildings on the street include office buildings, and on the northeast corner is a multi-story parking garage.

The nineteenth century appearance and atmosphere of the Lewis Street district make it quite distinct in the center of downtown Hartford. The street developed in the first half of the nineteenth century as a group of modest frame and brick structures. Five of the brick houses remain.

The three on the east side of the street, of Greek Revival character, are similar in appearance, scale, and plan, and have identical doorways, suggesting that they were built by the same builder before 1850. Austin Daniels, a joiner, owned the property and lived on this side of the street and may have been the builder.

On the west side of the street, two houses remain for which the record is clearer. Lewis Rowell, a joiner, established his shop on Lewis Street in the 1840's and in the early 1850's built 25 Lewis Street as his home. Several years later he built 27 Lewis Street which was constructed as a semi-detached duplicate of the first house. These two structures, with their heavy cornice overhangs and elaborate Ionic portions, reflect the Italianate influence of the times.

A synopsis of buildings on the street follows:

West Side:

#1 Lewis Street-a simple three-story brick building probably erected prior to 1850 as a residence. It has been somewhat altered over the years, but much of the original fabric remains. Now used as law offices.

#3-9 Lewis Street- a two-story brick commercial building erected in 1929. It has a notable parapet front gable. It is presently owned by an architectural firm who occupy the premises as their offices.

UNITED STATES DEPARTMENT OF THE INTERIOR
NATIONAL PARK SERVICE

**NATIONAL REGISTER OF HISTORIC PLACES
INVENTORY -- NOMINATION FORM**

FOR NPS USE ONLY	
RECEIVED	DEC 9 1975
DATE ENTERED	JAN 30 1976

CONTINUATION SHEET

ITEM NUMBER 7 PAGE 1

#15-21 Lewis Street-a five-story brick and sandstone office building constructed c. 1920. The facade is notable for its pink colored sandstone piers framing pairs of windows and five arcades which are occupied by ground floor businesses.

#25 Lewis Street-built in 1851 by Lewis Rowell, a joiner, as his two-story brick residence. The house has an elaborate Ionic portico and heavy wooden cornice. The panelled front door is surrounded by sidelights and transom light decorated with acanthus leaf consoles. In 1926, an 11' x 26' shop was projected out to the sidewalk brick with a large bow window, sympathetic to the design of the house. The architects were Smith & Bassette.

#27 Lewis Street is a duplicate of #25 Lewis Street. This house was built by Lewis Rowell in 1855. The two houses have always been semi-detached and are now owned and occupied as a unit by a law firm.

#31-33 Lewis Street is a small office building constructed in 1928 by W. F. Brooks, Architect. It is a twentieth century building designed in the classical tradition. It is built of brick with considerable marble detailing, including the use of marble for steps, keystone window headers and cornices. There is an elaborate fan window with fluted Corinthian pilasters in the main elevation.

East Side:

#60 Gols Street, corner of Lewis, First Church of Christ (Center Church) Church House - a substantial brick building constructed in 1908 in the Georgian Revival style with granite ashlar foundations and heavy granite quoins at corners. The building has a colossal Ionic front facade with a heavy triangular pediment in which is an elliptical fan window. A smaller version of the same entranceway appears on a side facade.

#24 Lewis Street is a modest brick house constructed prior to 1850, perhaps by Austin Daniels. The front door which is located in the north bay of the three-bay main facade, has a simple three-light transom, plus two sidelights on each side. The door jams are molded to suggest colonettes. Massive red sandstone steps lead up to the porch and front door. The house is owned by the adjoining church and is rented as commercial offices.

UNITED STATES DEPARTMENT OF THE INTERIOR
NATIONAL PARK SERVICE

**NATIONAL REGISTER OF HISTORIC PLACES
INVENTORY -- NOMINATION FORM**

FOR NPS USE ONLY	
RECEIVED	DEC 29 1975
DATE ENTERED	JAN 20 1976

CONTINUATION SHEET

ITEM NUMBER 7

PAGE 2

#30 Lewis Street is one of the three similar two-story red brick houses on this side of the street. Since 1908 it has been occupied by the University Club who in 1926 constructed a five-story brick addition to the rear, W. F. Brooks, Architect.

#36 Lewis Street is similar to #24 and #30 Lewis Street. This three bay, two-story brick house was probably built prior to 1850. It has a heavy one-story front porch supported by four Doric columns. The porch is probably a later addition. Presently the premises are vacant, but an active plan exists to renovate the building for use as a restaurant while maintaining the exterior appearance. The house is owned by the University Club.

It should be noted that on the east side of the street, within the district, there are only two property owners - the Church and the University Club. On the west side of the street the properties are owned and occupied by lawyers and architects or are successful and well-rented office buildings. Thus, the district is now in strong hands of owners who are interested in maintaining its historical character.

8 SIGNIFICANCE

PERIOD	AREAS OF SIGNIFICANCE -- CHECK AND JUSTIFY BELOW			
<input type="checkbox"/> PREHISTORIC	<input type="checkbox"/> ARCHEOLOGY-PREHISTORIC	<input checked="" type="checkbox"/> COMMUNITY PLANNING	<input type="checkbox"/> LANDSCAPE ARCHITECTURE	<input type="checkbox"/> RELIGION
<input type="checkbox"/> 1400-1499	<input type="checkbox"/> ARCHEOLOGY-HISTORIC	<input type="checkbox"/> CONSERVATION	<input type="checkbox"/> LAW	<input type="checkbox"/> SCIENCE
<input type="checkbox"/> 1500-1599	<input type="checkbox"/> AGRICULTURE	<input type="checkbox"/> ECONOMICS	<input type="checkbox"/> LITERATURE	<input type="checkbox"/> SCULPTURE
<input type="checkbox"/> 1600-1699	<input checked="" type="checkbox"/> ARCHITECTURE	<input type="checkbox"/> EDUCATION	<input type="checkbox"/> MILITARY	<input type="checkbox"/> SOCIAL/HUMANITARIAN
<input type="checkbox"/> 1700-1799	<input type="checkbox"/> ART	<input type="checkbox"/> ENGINEERING	<input type="checkbox"/> MUSIC	<input type="checkbox"/> THEATER
<input checked="" type="checkbox"/> 1800-1899	<input type="checkbox"/> COMMERCE	<input type="checkbox"/> EXPLORATION/SETTLEMENT	<input type="checkbox"/> PHILOSOPHY	<input type="checkbox"/> TRANSPORTATION
<input checked="" type="checkbox"/> 1900-	<input type="checkbox"/> COMMUNICATIONS	<input type="checkbox"/> INDUSTRY	<input type="checkbox"/> POLITICS/GOVERNMENT	<input type="checkbox"/> OTHER (SPECIFY)
		<input type="checkbox"/> INVENTION		

SPECIFIC DATES

BUILDER/ARCHITECT

STATEMENT OF SIGNIFICANCE

Lewis Street is being nominated to the National Register of Historic Places because it is the last of the mid-nineteenth century/early twentieth century blocks in central downtown Hartford, Connecticut. It contains structures which are high-style, characteristic of the eras in which they were built.

Lewis Street is significant as a mid-nineteenth century neighborhood of modest homes, together with a turn-of-the-century church building and early twentieth century office buildings. It is now the only extant district of its era in central downtown Hartford; all others having been destroyed.

In the beginning, Lewis Street was the westernmost street on the edge of Hartford as the city developed westward from the Connecticut River. The street got its start in 1798 as a narrow passageway when title was vested in the municipality by deed of Ralph Pomeroy, William Goodwin, John Goodwin, and Solomon Taylor. In 1841 the passageway was widened and named Wells Street after Dr. Horace Wells (1815-1848), inventor of anesthesia who lived on the corner of Pearl Street. In 1883 it was renamed Lewis Street after the late Lewis Rowell, joiner and principal property owner on both sides of the street. In 1929 a petition was circulated to change the name to Wall Street in recognition of a number of brokerage and investment houses located on the street at that time, but this proposed change was voted down by the city's Street Commission.

9 MAJOR BIBLIOGRAPHICAL REFERENCES

Atlas of the City of Hartford, Connecticut, Springfield, Mass.: L. G. Richards & Co., 1896.

Atlas of Hartford City and County, Connecticut, Hartford: Baker & Tilden, 1869.

10 GEOGRAPHICAL DATA

ACREAGE OF NOMINATED PROPERTY FIVE (5)

UTM REFERENCES

A	1,8	6,93,15,0	4,6,2,6,1,4,0	B	1,8	6,9,3,2,6,0	4,6,2,6,1,4,0
	ZONE	EASTING	NORTHING		ZONE	EASTING	NORTHING
C	1,8	6,9,3,1,5,0	4,6,2,6,0,2,0	D	1,8	6,9,3,2,6,0	4,6,2,6,0,2,0

VERBAL BOUNDARY DESCRIPTION

LIST ALL STATES AND COUNTIES FOR PROPERTIES OVERLAPPING STATE OR COUNTY BOUNDARIES

STATE	CODE	COUNTY	CODE
STATE	CODE	COUNTY	CODE

11 FORM PREPARED BY

NAME / TITLE

Hartford Architecture Conservancy, for

ORGANIZATION

Connecticut Historical Commission

DATE

5/15/75

STREET & NUMBER

59 South Prospect St.

TELEPHONE

203-566-3005

CITY OR TOWN

Hartford

STATE

Connecticut

12 STATE HISTORIC PRESERVATION OFFICER CERTIFICATION

THE EVALUATED SIGNIFICANCE OF THIS PROPERTY WITHIN THE STATE IS:

NATIONAL

STATE

LOCAL

As the designated State Historic Preservation Officer for the National Historic Preservation Act of 1966 (Public Law 89-665), I hereby nominate this property for inclusion in the National Register and certify that it has been evaluated according to the criteria and procedures set forth by the National Park Service.

STATE HISTORIC PRESERVATION OFFICER SIGNATURE

John W. Shannahan

TITLE

State Historic Preservation Officer

DATE

12/16/75

FOR NPS USE ONLY

I HEREBY CERTIFY THAT THIS PROPERTY IS INCLUDED IN THE NATIONAL REGISTER

Acting

James P. [Signature]

DATE

1/30/76

DIRECTOR, OFFICE OF ARCHAEOLOGY AND HISTORIC PRESERVATION

ATTEST:

Charles Adams

DATE

1.21.76

KEEPER OF THE NATIONAL REGISTER

Acting

UNITED STATES DEPARTMENT OF THE INTERIOR
NATIONAL PARK SERVICE

**NATIONAL REGISTER OF HISTORIC PLACES
INVENTORY -- NOMINATION FORM**

FOR NPS USE ONLY

RECEIVED DEC 29 1975

DATE ENTERED

JAN 20 1976

CONTINUATION SHEET

ITEM NUMBER 9 PAGE 1

Assessments, Hartford, 1865, State Library, list of taxable property.

Bailey, Harold C., An Old Hartford Street, typescript January 1, 1946, copy in author's possession, a five page history of Lewis Street.

City Atlas of Hartford, Connecticut, Philadelphia: G. M. Hopkins, C. E., 1880.

The Courant, Hartford, April 4, 1929, history of the names of the street.

Drakos, Louis J., letter September 26, 1974 in author's possession, regarding 3-9 Lewis Street, which he now owns.

Grant, Ellsworth, Yankee Dreamers and Doers, p. 215, photo of Lewis Street toward end of nineteenth century.

Hartford City Director, various editions 1838 and later.

Hartford, City of, Engineering Department, building permits, April 29, 1907 and later.

Hartford, Town Clerk, record of deeds, Vol. 74 (1847) and later Volumes.

Sage, Henry, letter October 16, 1974 to author's possession, regarding buildings at 25, 27 Lewis Street now occupied by Halloran, Sage, Phelan & Hagerty, one of which was formerly Edwin V. and Margaret Sage Mitchell bookstore.

Storrs family papers, Connecticut Historical Society library, including letter November 25, 1974 to author from Rovert Storrs, great grandson of Lewis Rowell for whom the street was named.

Trumbull, G. Hammond, ed., The Memorial History of Hartford County, Connecticut 1633-1884, Boston: Edward L. Osgood, 1886, Vol. I, page 33, biographical sketch of Zalmon A. Storrs.

LEWIS STREET

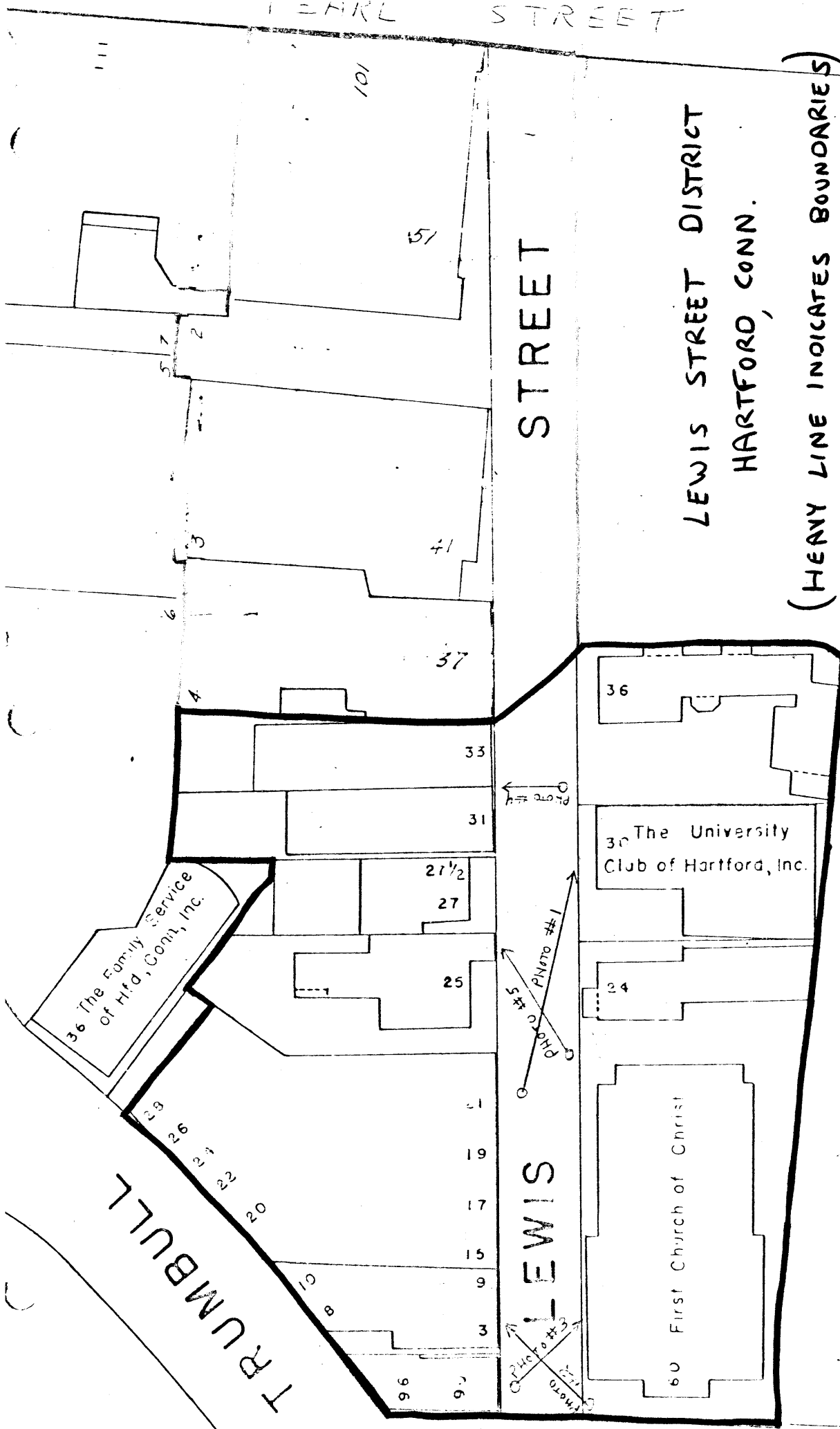

STREET

LEWIS STREET DISTRICT
HARTFORD, CONN.

(HEAVY LINE INDICATES BOUNDARIES)

Scale
1" = 50'

City of Hartford
(Continued)

TRUMBULL STREET

LEWIS

60 First Church of Christ

30 The University Club of Hartford, Inc.

36 The Family Service of Hfd., Conn., Inc.