

KENTUCKY HISTORIC RESOURCES INVENTORY

Js-174

1. Historic Name (s) Bryant house		22. ADD/County Bluegrass/Jessamine	
Original Owner Present Name		23. Zoning Classification Magisterial District	
3. Owner's Name Eugene Goss		24. U.S.G. S. Quadrant (15'/75') Nicholasville	
4. Owner's Address Box 897, Harlan, Kentucky 40831		25. UTM Reference Zone: 16 Easting: 714820 Northing: 4200160	
5. Location Rt. 27, west side, 2 miles north of Nicholasville		26. Prehistoric Site Historic Site: Buildings	
6. Open to Public Yes <input type="checkbox"/> No <input checked="" type="checkbox"/>	7. Visible from road Yes <input checked="" type="checkbox"/> No <input type="checkbox"/>	27. District Yes <input type="checkbox"/> No <input checked="" type="checkbox"/>	
9. Local Contact/Organization		28. Significance Evaluation National Register	
8. Ownership Private <input checked="" type="checkbox"/> Local <input type="checkbox"/> State <input type="checkbox"/> Federal <input type="checkbox"/>		29. Status National Landmark <input type="checkbox"/> National Register <input type="checkbox"/> Landmark Certificate <input type="checkbox"/> Kentucky Survey <input type="checkbox"/> Local Landmark <input type="checkbox"/> HABS/HAER <input type="checkbox"/>	
10. Site Plan with North Arrow 		11. Architect 12. Builder 13. Date mid-19th century 14. Style Greek Revival	
See Attached Sheet acreage centered between house and barn; brick barn, Unfortunately both the slavequarters and the root cellar are no longer there.		15. Original Use house 16. Present Use house 17. Condition Interior good <input type="checkbox"/> Exterior good <input type="checkbox"/>	
18. Description 2-story, 5-bay brick; double-pile, central passage plan; Flemish bond, jack arches, freestanding Greek Doric columns (fluted) at both lower and upper doors; pilasters beside columns at 1st floor, crossette architrave at 2nd floor; 9/6 windows below, 6/6 up; marbellized interior woodwork; rear facade; later gingerbread front porch; <del>a symmetrical contemporary brick slave quarters</del> and brick barn; root cellar near house has unusually high quality stone construction.		30. Theme Primary: architecture Secondary: agriculture Other:	
19. History 1877 atlas - J. Bryant		31. Endangered Yes <input type="checkbox"/> No <input checked="" type="checkbox"/>	
20. Significance Architecture: the Bryant house is a well-preserved good example of local Greek Revival architecture. Agriculture: the group of remaining contemporary outbuilding (slave quarters, root cellar, barn) are significant reminders of the mid-19th century farm.		32. ATTACH PHOTO	
21. Source of Information		Roll No. 9 Picture No. Direction	
23. Zoning Classification		33. Tape No. Negative No.	
24. U.S.G. S. Quadrant		34. Prepared by: NCP - KTG	
25. UTM Reference		35. Organization KHC	
26. Prehistoric Site		36. Date summer 1977	
27. District		37. Revision Dates	
28. Significance Evaluation		38. Staff Review	

6/4/77

KENTUCKY HISTORIC RESOURCE INVENTORY SUPPLEMENT  
BOUNDARY AND LOCATION INFORMATION

Historic Property Name J. Keyser House Site # JA 174  
Multiple Resource/Thematic Nomination Title Jennings Co.

U.T.M. Coordinates - List multiple UTMs if property is ten or more acres.

A. 16 714280 4200160 D. \_\_\_\_\_  
B. \_\_\_\_\_ E. \_\_\_\_\_  
C. \_\_\_\_\_ F. \_\_\_\_\_

Verbal Boundary Description Acreage 3.22 acres

Site enclosed by A-B-C-D as shown below; includes brick house and brick barn. A-B is parallel with, and 100 feet in front of the house. D-A is 205 ft N of the house.

Sketch of Site Plan (Showing outbuildings, structures, landscape features and the site boundary as described above.)

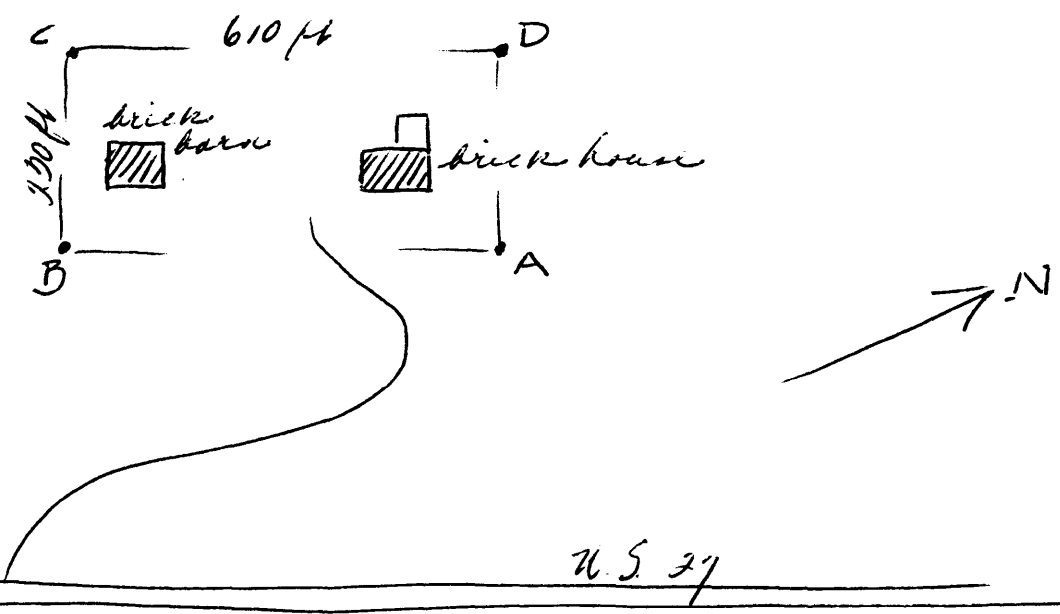

Official Courthouse Property Reference: