

United States Department of the Interior
National Park Service

National Register of Historic Places
Registration Form

1235

N/A

This form is for use in nominating or requesting determinations for individual properties and districts. See instructions in How to Complete the National Register of Historic Places Registration Form (National Register Bulletin 16A). Complete each item by marking "x" in the appropriate box or by entering the information requested. If any item does not apply to the property being documented, enter "N/A" for "not applicable." For functions, architectural classification, materials, and areas of significance, enter only categories and subcategories from the instructions. Place additional entries and narrative items on continuation sheets (NPS Form 10-900a). Use a typewriter, word processor, or computer to complete all items.

1. Name of Property

historic name American Legion Hut
other names/site number _____

2. Location

street & number Southwest corner, intersection of Hoover St. and Jackson Ave. not for publication _____
city or town Hampton vicinity _____
state South Carolina code SC county Hampton code 049 zip code 29924

3. State/Federal Agency Certification

As the designated authority under the National Historic Preservation Act of 1986, as amended, I hereby certify that this nomination request for determination of eligibility meets the documentation standards for registering properties in the National Register of Historic Places and meets the procedural and professional requirements set forth in 36 CFR Part 60. In my opinion, the property meets does not meet the National Register Criteria. I recommend that this property be considered significant nationally statewide locally. (See continuation sheet for additional comments.)

Mary W. Edmonds 9/13/00
Signature of certifying official Date

Mary W. Edmonds, Deputy State Historic Preservation Officer, S.C. Dept. of Archives and History, Columbia, S.C.
State or Federal agency and bureau

In my opinion, the property meets does not meet the National Register criteria. (See continuation sheet for additional comments.)

Signature of commenting or other official Date

State or Federal agency and bureau

4. National Park Service Certification

I, hereby certify that this property is:

Signature of the Keeper

Date of Action

entered in the National Register Mary M. May 10/22/00
 See continuation sheet.
 determined eligible for the National Register
 See continuation sheet.
 determined not eligible for the National Register
 removed from the National Register
 other (explain): _____

American Legion Hut
Name of Property

Hampton County, South Carolina
County and State

5. Classification

Ownership of Property
(Check as many boxes as apply)

Category of Property
(Check only one box)

Number of Resources within Property
(Do not include previously listed resources)

- private
- public-local
- public-State
- public-Federal

- building(s)
- district
- site
- structure
- object

Contributing	Noncontributing
1	
1	0

buildings
sites
structures
objects
Total

Name of related multiple property listing
(Enter "N/A" if property is not part of a multiple property listing.)
N/A

Number of contributing resources previously listed
in the National Register
0

6. Function or Use

Historic Functions
(Enter categories from instructions)

Category: SOCIAL

Subcategory: Meeting Hall

Current Functions
(Enter categories from instructions)

Category: SOCIAL

Subcategory: Meeting Hall

7. Description

Architectural Classification
(Enter categories from instructions)

Other: Log Cabin

Materials
(Enter categories from instructions)

foundation Brick

walls Wood/Cypress Logs

roof Asphalt/Composition

other

Narrative Description

(Describe the historic and current condition of the property on one or more continuation sheets.)

American Legion Hut
Name of Property

Hampton County, South Carolina
County and State

8. Statement of Significance

Applicable National Register Criteria

(Mark "x" in one or more boxes for the criteria qualifying the property for National Register listing)

- A Property is associated with events that have made a significant contribution to the broad patterns of our history.
- B Property is associated with the lives of persons significant in our past.
- C Property embodies the distinctive characteristics of a type, period, or method of construction or represents the work of a master, or possesses high artistic values, or represents a significant and distinguishable entity whose components lack individual distinction.
- D Property has yielded, or is likely to yield information important in prehistory or history.

Criteria Considerations

(Mark "X" in all the boxes that apply.)

- a owned by a religious institution or used for religious purposes.
- b removed from its original location.
- c a birthplace or a grave.
- d a cemetery.
- e a reconstructed building, object, or structure.
- f a commemorative property.
- g less than 50 years of age or achieved significance within the past 50 years.

Areas of Significance

(Enter categories from instructions)

Architecture

Period of Significance

1933

Significant Dates

1933

Significant Person

(Complete if Criterion B is marked above)

Cultural Affiliation

Architect/Builder

Narrative Statement of Significance

Explain the significance of the property on one or more continuation sheets.)

9. Major Bibliographical References

(Cite the books, articles, and other sources used in preparing this form on one or more continuation sheets.)

Previous documentation on file (NPS):

- preliminary determination of individual listing (36 CFR 67) has been requested.
- previously listed in the National Register
- previously determined eligible by the National Register
- designated a National Historic Landmark
- recorded by Historic American Buildings Survey # _____
- recorded by Historic American Engineering Record # _____

Primary location of additional data:

- State Historic Preservation Office
- Other State agency
- Federal agency
- Local government
- University
- Other

Name of repository:
S.C. Dept. of Archives & History

American Legion Hut
 Name of Property

Hampton County, South Carolina
 County and State

10. Geographical Data

Acreeage of Property less than one acre

UTM References

(Place additional UTM references on a continuation sheet)

Zone Easting	Northing	Zone Easting	Northing
1 <u>17</u>	<u>489019</u>	3 _____	_____
2 _____	_____	4 _____	_____

___ See continuation sheet.

Verbal Boundary Description (Describe the boundaries of the property on a continuation sheet.)

Boundary Justification (Explain why the boundaries were selected on a continuation sheet.)

11. Form Prepared By

name/title Mildred Rivers
 organization Hampton County Historic Museum date May 1999
 street & number 104 Mulberry Street telephone (843) 943-3387
 city or town Hampton state SC zip code 29924

Additional Documentation

Submit the following items with the completed form:

Continuation Sheets

Maps

- A USGS map (7.5 or 15 minute series) indicating the property's location.
- A sketch map for historic districts and properties having large acreage or numerous resources.

Photographs

Representative **black and white** photographs of the property.

Additional items

(Check with the SHPO or FPO for any additional items)

Property Owner

(Complete this item at the request of the SHPO or FPO.)

name American Legion Post 108
 street & number P.O. Box 101, Hoover Street telephone _____
 city or town Hampton state SC zip code 29924

United States Department of the Interior
National Park Service

National Register of Historic Places
Continuation Sheet

Section number 7 Page 5

American Legion Hut
Name of Property
Hampton County, South Carolina
County and State

The American Legion Hut is a one-story, T-shaped cypress log building with a truss roof constructed in 1933 at the corner of Hoover Street and Jackson Avenue in Hampton, South Carolina. The Hut was constructed as, and continues to be, a meeting hall for the Hampton American Legion Post 108 as well as serving as a site for civic and social events. Local workers built the Hut supported by funds from the Reconstruction Finance Corporation, a federal agency that provided loans for work relief projects during the Great Depression.

The exterior walls of the building were constructed of saddle-notched cypress logs with a white mortar chinking and rests on a brick pier foundation. The hip roof is covered with asphalt shingles. The exposed rafters are of pine and are twenty-four inches on center. The roof sheathing is squared edge pine in various sizes including 1"x6", 1"x8", and 1"x10". The three-quarter width front porch deck is supported by brick piers, cypress log plates and sleepers, and features round solid wood columns supporting a hipped roof. Leading to the porch and building entrance are brick steps with brick and cast stone pedestal walls and a pipe hand rail down the middle. The entrance consists of double-leaf five-panel wood doors, and is flanked by two six-over-six light, double hung wood windows. Most other windows are either paired or tripartite six-over-six light, double-hung sash, with an occasional short pair or single. Framing all windows and extending to the foundation level are vertically-placed half-round logs simply applied over the log wall construction. An additional half-round log has been applied under the center of each paired window, which creates a look of underpanels. A large brick chimney with a brick corbel coping course rises along the northeast slope of the building's rear ell at its intersection with the main block. A brick chimney flue intersects the same roof slope nearer the rear of the ell. A small historic brick extension, laid in American bond, is located at the intersection of the main block and rear ell along the southwest elevation. A single-leaf, horizontal-paneled wood door with masonry steps is at the center of the rear ell's terminal wall.

On the interior, the floor is made up of 1"x4" tongue-and-groove oak boards. The floor rests on 10"x10" pine girders with 2"x8" pine floor joists 24" on center and 1"x12" square edged pine diagonal subflooring. All interior walls in the building are exposed cypress logs with the chinking revealed. The assembly room features a brick fireplace along its rear wall and a log truss ceiling. At its peak, the ceiling is eighteen feet above the floor. The dining hall ceiling is exposed to the roof system as well. The kitchen and restrooms have a pine beaded board ceilings. All interior doors are wood and contain five horizontal panels.

Minimal alterations to the building include a small brick room on the south side, lattice panels between the brick foundation piers, a window air conditioning unit, gas heat in the dining hall, lights on either side of the front entrance, and a central air conditioning unit in the assembly room.

United States Department of the Interior
National Park Service

National Register of Historic Places
Continuation Sheet

Section number 8 Page 6

American Legion Hut
Name of Property
Hampton County, South Carolina
County and State

The American Legion Hut is a log building constructed in 1933 at the southwest corner of the intersection of Hoover Street and Jackson Avenue in Hampton, South Carolina. The building is eligible for inclusion in the National Register of Historic Places under Criterion C for its architecture which was designed and constructed by American Legion Post 108 members and relief workers assisted by the Reconstruction Finance Corporation (RFC). The cypress logs used in constructing the Hut were harvested locally and prepared for construction by Jim Polk and Jim Barnes, local carpenters who were experienced in log construction. J. E. Fennell organized the labor for the local relief council.

The RFC was signed into law in January 1932 by President Herbert Hoover. The RFC was intended to help rejuvenate the depressed economy by providing loans from the federal treasury to banks, railroads, credit unions and mortgage companies. With the national economy still struggling, Hoover signed the Emergency Relief and Construction Act in July 1932 which provided millions of dollars in RFC relief loans to the states. In the southern states, these funds were often used for family assistance programs to initiate small work relief projects. In February 1933, South Carolina received an RFC loan totaling \$2,101,015. These funds were distributed to the counties and Hampton County received an allocation of \$38,000.¹

In April 1933, the American Legion post in Hampton County announced plans to build a log cabin as a recreation center and clubhouse for its organization. Construction began on May 8, 1933, and the hut was formally opened to the public on August 2, 1933. Labor to construct the cabin was supplied by the Hampton County relief council which paid for the labor with RFC funds.² Four lots comprising approximately one acre of land for the building was given to the Town of Hampton by Senator George Warren. The Town deeded the land to Post 108 in 1940.³

Vaney Bowers and his brother Dee Bowers, both of Hampton County, cut and skinned the cypress logs used to build the cabin. They pulled the logs on mule-driven carts to the construction site. The brothers were paid \$30 by Homer Hiers who coordinated work projects with the local relief council.⁴

The American Legion Hut in Hampton has served continuously as a meeting place not only for Legion members, but also for community functions such as school dances, town festivals, family reunions, and veterans' remembrance services.

¹ James S. Olson, *Saving Capitalism: The Reconstruction Finance Corporation and the New Deal 1933-1940* (Princeton, NJ: Princeton University Press, 1988), p17-21; Roger Biles, *The South and the New Deal* (Lexington, KY: University Press of Kentucky, 1994), p33; *Hampton County Guardian*, February 22, 1933.

² "Legion Plans Club Building," *The Hampton County Guardian (Hampton, SC)*, April 12, 1933; "Work on Log Cabin is Started Monday," *The Hampton County Guardian (Hampton, SC)*, May 10, 1933; "American Legion Hut Nearing Completion," *The Hampton County Guardian (Hampton, SC)*, May 24, 1933; "Legionnaires to Open Hut," *The Hampton County Guardian (Hampton, SC)*, July 26, 1933.

³ Hampton County Register of Mesne Conveyance, Deed Book 32D, p.350; Town of Hampton, Plat Book #2, p.156.

⁴ Mildred B. Rivers, interview with Vaney Bowers, February 15, 1997, Hampton, South Carolina.

United States Department of the Interior
National Park Service

National Register of Historic Places
Continuation Sheet

Section number 9 Page 7

American Legion Hut
Name of Property
Hampton County, South Carolina
County and State

Bibliographical References

"American Legion Hut Nearing Completion." The Hampton County Guardian (Hampton, SC). May 24, 1933.

Biles, Roger. The South and the New Deal. Lexington, KY: University Press of Kentucky, 1994.

Bowers, Vaney. Interview by Mildred B. Rivers. Hampton, South Carolina: February 15, 1997.

Olson, James S. Saving Capitalism: The Reconstruction Finance Corporation and the New Deal, 1933-1940. Princeton, NJ: Princeton University Press, 1988.

Hampton County Register of Mesne Conveyance. Deed Book 32D, p.350.

"Legion Plans Club Building." The Hampton County Guardian (Hampton, SC). April 12, 1933.

"Legionnaires to Open Hut." The Hampton County Guardian (Hampton, SC). July 26, 1933.

Town of Hampton. Plat Book #2, p.156.

"Work on Log Cabin is Started Monday." The Hampton County Guardian (Hampton, SC). May 10, 1933.

United States Department of the Interior
National Park Service

National Register of Historic Places
Continuation Sheet

Section number 10 Page 8

American Legion Hut
Name of Property
Hampton County, South Carolina
County and State

Verbal Boundary Description

The boundary of the nominated property is the block in the town of Hampton bordered by Hoover Street, Jackson Avenue, Everett Street, and Alabama Street, shown as the black line marked "American Legion Hut" on the accompanying Hampton County Tax Map 119-02-11-004, Parcel 11, Lot 4, drawn at a scale of 1" = 100'.

Boundary Justification

The nominated property is restricted to the building and its immediate surroundings.

United States Department of the Interior
National Park Service

National Register of Historic Places
Continuation Sheet

Section number Photographs Page 9 American Legion Hut
Name of Property
Hampton County, South Carolina
County and State

The following information is the same for each of the photographs:

Name of Property: American Legion Hut
Location of Property: Hoover Street, Hampton, Hampton County, SC

Name of Photographer: J. C. Clifton
Date of Photographs: June 1997
Location of Original Negatives:

1. Facade left oblique
2. Facade right oblique
3. Rear elevation right oblique
4. Rear elevation left oblique
5. Interior looking to Southeast entrance
6. Interior looking to Southeast entrance
7. Two windows on Southwest interior
8. Northwest wall with fireplace
9. West wall going into the kitchen
10. Rafters with flag in main room
11. Northwest wall of kitchen
12. Northwest corner on right in kitchen
13. Inside Restroom
14. Left corner to Northwest restroom

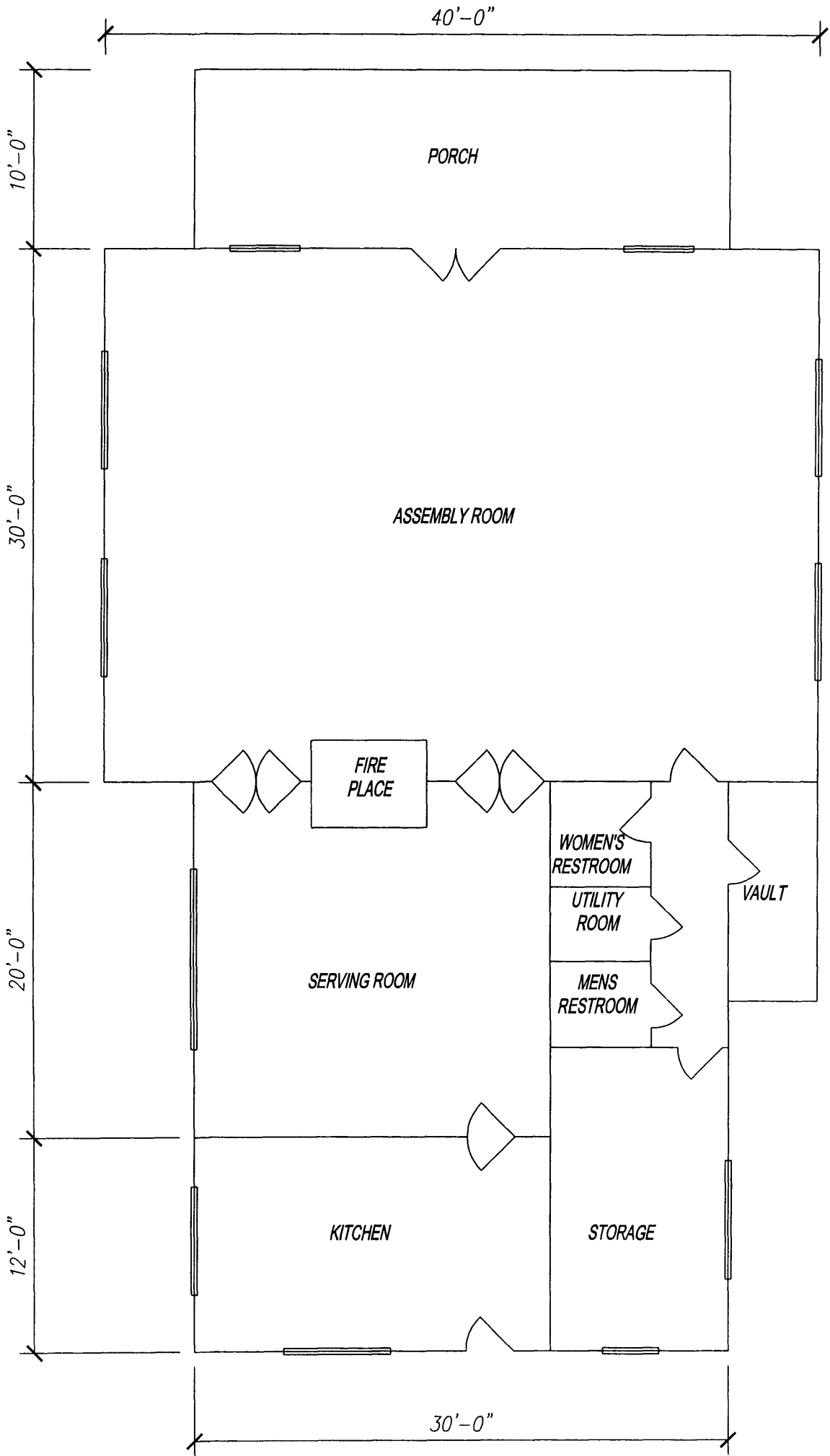

**United States Department of the Interior
National Park Service**

**National Register of Historic Places
Continuation Sheet**

Section number _____ Page _____

SUPPLEMENTARY LISTING RECORD

NRIS Reference Number: 00001235

Date Listed: 10/27/00

American Legion Hut
Property Name

Hampton SOUTH CAROLINA
County State

N/A

Multiple Name

This property is listed in the National Register of Historic Places in accordance with the attached nomination documentation subject to the following exceptions, exclusions, or amendments, notwithstanding the National Park Service certification included in the nomination documentation.

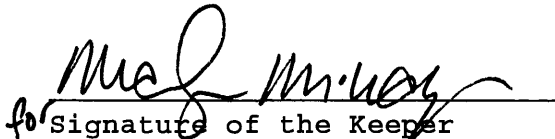
Signature of the Keeper

11/7/00
Date of Action

=====
Amended Items in Nomination:

Section No. 8

This nomination is amended to remove Criterion C, for architecture, and substitute Criterion A, for social history. The narrative documents the important role of the RFC, a New Deal Depression-relief agency, in the construction of the building. There is insufficient context to justify architectural significance for the log construction.

This amendment has been confirmed with the South Carolina SHPO.

DISTRIBUTION:

- National Register property file
- Nominating Authority (without nomination attachment)