



City Arlington, MA

Address 252 Gray Street

Historic Name William Prentiss House

Use: Present Residential

Original Residential

DESCRIPTION:

Date ca. 1850-1860

Source Arlington Maps

Style Greek Revival

Architect Unknown

Exterior wall fabric Clapboard

Outbuildings None

Major alterations (with dates) _____

Front raised roof dormer, side porch,
and front porch (20th century).

Moved No Date N/A

Approx. acreage Less than one acre

Setting The Prentiss House sits on
the side of a hill in the midst of
a residential neighborhood.

UTH: 19/321240/4698080

SKETCH MAP

Show property's location in relation to nearest cross streets and/or geographical features. Indicate all buildings between inventoried property and nearest intersection. Indicate north.

Recorded by Betsy Friedberg

Organization Mass. Historical Commission

Date 12/84

(Staple additional sheets here)

ARCHITECTURAL SIGNIFICANCE (Describe important architectural features and evaluate in terms of other buildings within the community.)

One of the oldest buildings in Arlington Heights is this simple one-and-a-half-story dwelling. Built ca. 1860, its rectangular plan, corner boards, and fascia are similar to Greek Revival cottages located in the eastern part of Arlington, but is an unusual form for this section of Arlington Heights. The main facade's wall dormer is probably a 20th century addition.

HISTORICAL SIGNIFICANCE (Explain the role owners played in local or state history and how the building relates to the development of the community.)

In 1869, this building's owner was listed as William Prentiss. He was one of the few farmers who lived in the Walnut, Mount Vernon, and Gray Streets section of Arlington Heights. In the 1870s, the western portion of Gray Street was known as Prentiss Street. It terminated in a dead end just to the east of what is now 252 Gray Street. During the early 20th century, the Hobbs family, and later the Higgins family, lived in this house.

CRITERIA FOR EVALUATION

The William Prentiss House possesses integrity of location, setting, materials, and workmanship. It fulfills Criterion C of the National Register of Historic Places.

BIBLIOGRAPHY and/or REFERENCES (name of publication, author, date and publisher)

1875 Beers & Co. Atlas
1884 Bird's Eye View of Arlington, Arlington Advocate
1898 Stadley & Co. Atlas
1923 Sanborn Map Co. Atlas
Arlington Directories of 1869/70, 1883, 1890, 1898, 1923

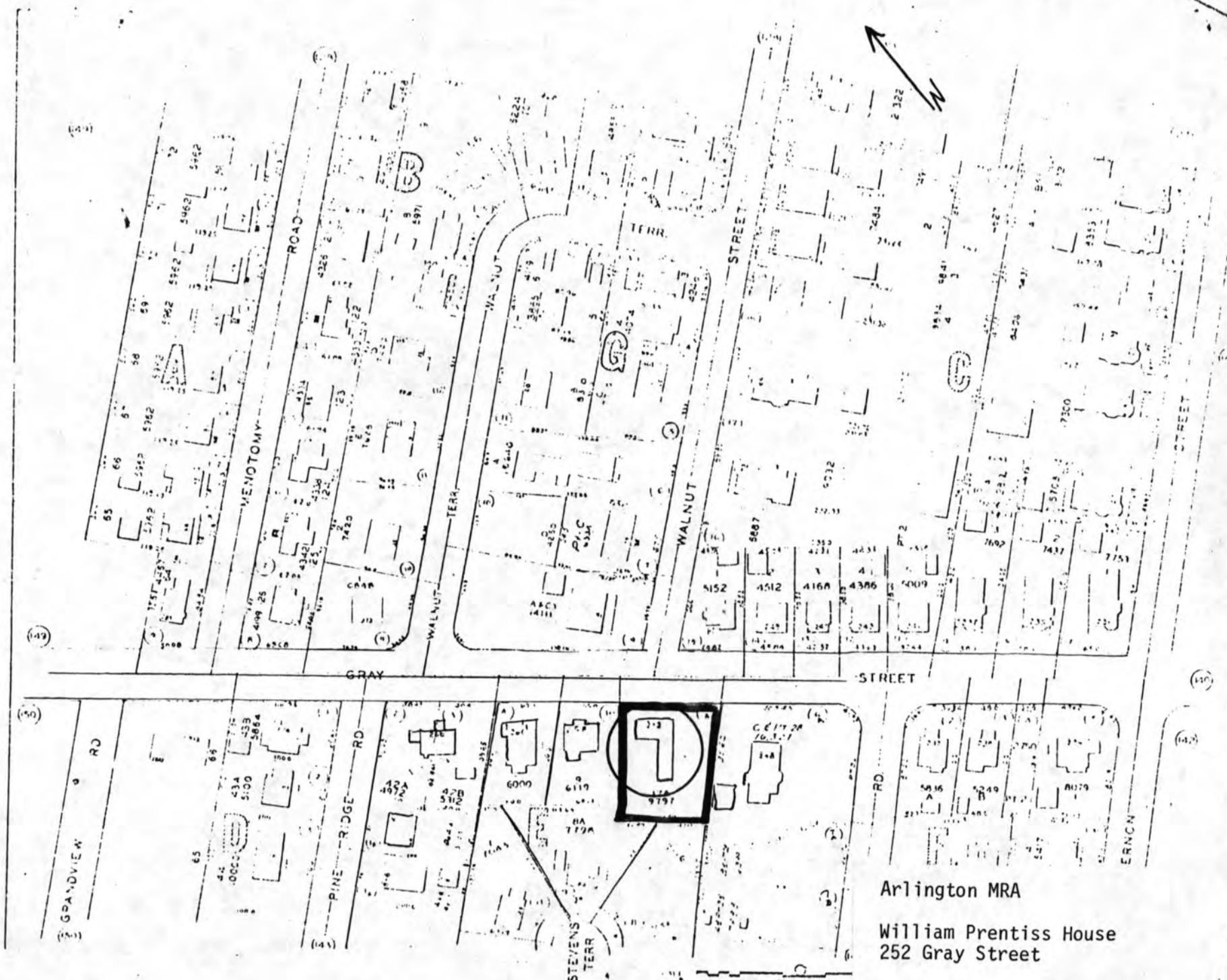

Arlington MRA

William Prentiss House
252 Gray Street

NATIONAL REGISTER OF HISTORIC PLACES
EVALUATION/RETURN SHEET

Prentiss, William, House (Arlington MRA)
Middlesex County
MASSACHUSETTS

Working No. MAR 6 1985
Fed. Reg. Date: _____
Date Due: 4/4/85 - 4/20/85
Action: ACCEPT
 RETURN 4-18-85
 REJECT
Federal Agency: _____

- resubmission
- nomination by person or local government
- owner objection
- appeal

Substantive Review: sample request appeal NR decision

Reviewer's comments:

Recom./Criteria _____
Reviewer _____
Discipline _____
Date _____
_____ see continuation sheet

Nomination returned for: technical corrections cited below
 substantive reasons discussed below

1. Name

2. Location

3. Classification

Category	Ownership	Status	Present Use
	Public Acquisition	Accessible	

4. Owner of Property

5. Location of Legal Description

6. Representation in Existing Surveys

Has this property been determined eligible? yes no

7. Description

Condition excellent good fair deteriorated ruins unexposed

Check one unaltered altered

Check one original site moved date _____

Describe the present and original (if known) physical appearance

- summary paragraph
- completeness
- clarity
- alterations/integrity
- dates
- boundary selection

8. Significance

Period _____ Areas of Significance—Check and justify below

Specific dates _____ Builder/Architect _____

Statement of Significance (in one paragraph)

- summary paragraph
- completeness
- clarity
- applicable criteria
- justification of areas checked
- relating significance to the resource
- context
- relationship of integrity to significance
- justification of exception
- other

9. Major Bibliographical References

10. Geographical Data

Acreage of nominated property _____

Quadrangle name _____

UTM References _____

Verbal boundary description and justification _____

11. Form Prepared By

12. State Historic Preservation Officer Certification

The evaluated significance of this property within the state is:

____ national ____ state ____ local

State Historic Preservation Officer signature _____

title _____ date _____

13. Other

- Maps *Power copy of maps used for defining boundaries - cannot read markings and scale.*
- Photographs
- Other

Questions concerning this nomination may be directed to _____

Signed *[Signature]* Date *4/18/85* Phone: _____

FORM B - BUILDING

MASSACHUSETTS HISTORICAL COMMISSION
294 WASHINGTON STREET, BOSTON, MA 02108

PHOTO: (3x3" or 3x5", black & white)
staple to left side of form

Photo number _____

SKETCH MAP

Show property's location in relation to nearest cross streets and/or geographical features. Indicate all buildings between inventoried property and nearest intersection. Indicate north.

See attached map.

Town Arlington, MA

Address 252 Gray Street

Historic Name William Prentiss House

Use: Present Residential

Original Residential

DESCRIPTION:

Date ca. 1850-1860

Source Arlington Maps

Style Greek Revival

Architect Unknown

Exterior wall fabric Clapboard

Outbuildings None

Major alterations (with dates) _____

Front raised roof dormer, side porch,
and front porch (20th century).

Moved No Date N/A

Approx. acreage Less than one acre

Setting The Prentiss House sits on
the side of a hill in the midst of
a residential neighborhood.

LTM: 19/321240/4698080

Recorded by Betsy Friedberg

Organization Mass. Historical Commission

Date 12/84

(Staple additional sheets here)

ARCHITECTURAL SIGNIFICANCE (Describe important architectural features and evaluate in terms of other buildings within the community.)

One of the oldest buildings in Arlington Heights is this simple one-and-a-half-story dwelling. Built ca. 1860, its rectangular plan, corner boards, and fascia are similar to Greek Revival cottages located in the eastern part of Arlington, but is an unusual form for this section of Arlington Heights. The main facade's wall dormer is probably a 20th century addition.

HISTORICAL SIGNIFICANCE (Explain the role owners played in local or state history and how the building relates to the development of the community.)

In 1869, this building's owner was listed as William Prentiss. He was one of the few farmers who lived in the Walnut, Mount Vernon, and Gray Streets section of Arlington Heights. In the 1870s, the western portion of Gray Street was known as Prentiss Street. It terminated in a dead end just to the east of what is now 252 Gray Street. During the early 20th century, the Hobbs family, and later the Higgins family, lived in this house.

CRITERIA FOR EVALUATION

The William Prentiss House possesses integrity of location, setting, materials, and workmanship. It fulfills Criterion C of the National Register of Historic Places.

BIBLIOGRAPHY and/or REFERENCES (name of publication, author, date and publisher)

- 1875 Beers & Co. Atlas
- 1884 Bird's Eye View of Arlington, Arlington Advocate
- 1898 Stadley & Co. Atlas
- 1923 Sanborn Map Co. Atlas
- Arlington Directories of 1869/70, 1883, 1890, 1898, 1923

United States Department of the Interior
National Park Service

National Register of Historic Places
Inventory—Nomination Form

For NPS use only
received
date entered

Continuation sheet

Item number

Page

Multiple Resource Area
Thematic Group

Name Arlington Multiple Resource Area
State Middlesex County, MASSACHUSETTS

Nomination/Type of Review

Date/Signature

31. Locke School

Entered in the
National Register

for Keeper Melvin Byers 9/27/85

Attest

32. Milestone

Entered in the
National Register

for Keeper Melvin Byers 9/27/85

Attest

33. Prentiss-Payson House

Entered in the
National Register

for Keeper Melvin Byers 4/18/85

Attest

34. Prentiss, William, House

Entered in the
National Register

for Keeper Melvin Byers 9/27/85

Attest

35. Proctor, William, House

Entered in the
National Register

for Keeper Melvin Byers 4/18/85

Attest

36. Rawson, Warren, Building

Entered in the
National Register

for Keeper Melvin Byers 9/27/85

Attest

37. Rawson, Warren, House

Entered in the
National Register

for Keeper Melvin Byers 4/18/85

Attest

38. Robindreau, Alfred E.,
House

Entered in the
National Register

for Keeper Melvin Byers 4/18/85

Attest

39. Robinson House

Entered in the
National Register

for Keeper Melvin Byers 4/18/85

Attest

40. Robinson-Lewis-G.F.,
Fessenden House

Entered in the
National Register

for Keeper Melvin Byers 4/18/85

Attest

NATIONAL REGISTER OF HISTORIC PLACES
EVALUATION/RETURN SHEET

Ref #
85002685

Prentiss, William, House (Arlington MRA)
Middlesex County
MASSACHUSETTS

Working No. 3/6/85
Fed. Reg. Date: 2/4/86
Date Due: 9/28/85
Action: ACCEPT 9-27-85
 RETURN
 REJECT
Federal Agency: _____

Entered in the _____
National Register _____

- resubmission
- nomination by person or local government
- owner objection
- appeal

Substantive Review: sample request appeal NR decision

Reviewer's comments:

Recom./Criteria _____
Reviewer _____
Discipline _____
Date _____
_____ see continuation sheet

Nomination returned for: _____ technical corrections cited below
_____ substantive reasons discussed below

1. Name

2. Location

3. Classification

Category	Ownership Public Acquisition	Status Accessible	Present Use

4. Owner of Property

5. Location of Legal Description

6. Representation in Existing Surveys

Has this property been determined eligible? yes no

7. Description

Condition	Check one	Check one
<input type="checkbox"/> excellent	<input type="checkbox"/> unaltered	<input type="checkbox"/> original site
<input type="checkbox"/> good	<input type="checkbox"/> altered	<input type="checkbox"/> moved date _____
<input type="checkbox"/> fair	<input type="checkbox"/> deteriorated	
	<input type="checkbox"/> ruins	
	<input type="checkbox"/> unexposed	

Describe the present and original (if known) physical appearance

- summary paragraph
- completeness
- clarity
- alterations/integrity
- dates
- boundary selection

8. Significance

Period _____ Areas of Significance—Check and justify below

Specific dates _____ Builder/Architect _____

Statement of Significance (*in one paragraph*) _____

- summary paragraph
- completeness
- clarity
- applicable criteria
- justification of areas checked
- relating significance to the resource
- context
- relationship of integrity to significance
- justification of exception
- other

9. Major Bibliographical References

10. Geographical Data

Acreage of nominated property _____

Quadrangle name _____

UTM References _____

Verbal boundary description and justification _____

11. Form Prepared By

12. State Historic Preservation Officer Certification

The evaluated significance of this property within the state is:

_____ national _____ state _____ local

State Historic Preservation Officer signature _____

title _____ date _____

13. Other

- Maps
- Photographs
- Other

Questions concerning this nomination may be directed to _____

Signed _____ Date _____ Phone: _____



Prentiss, William, House

252 Gray St.

Arlington MRA, MA

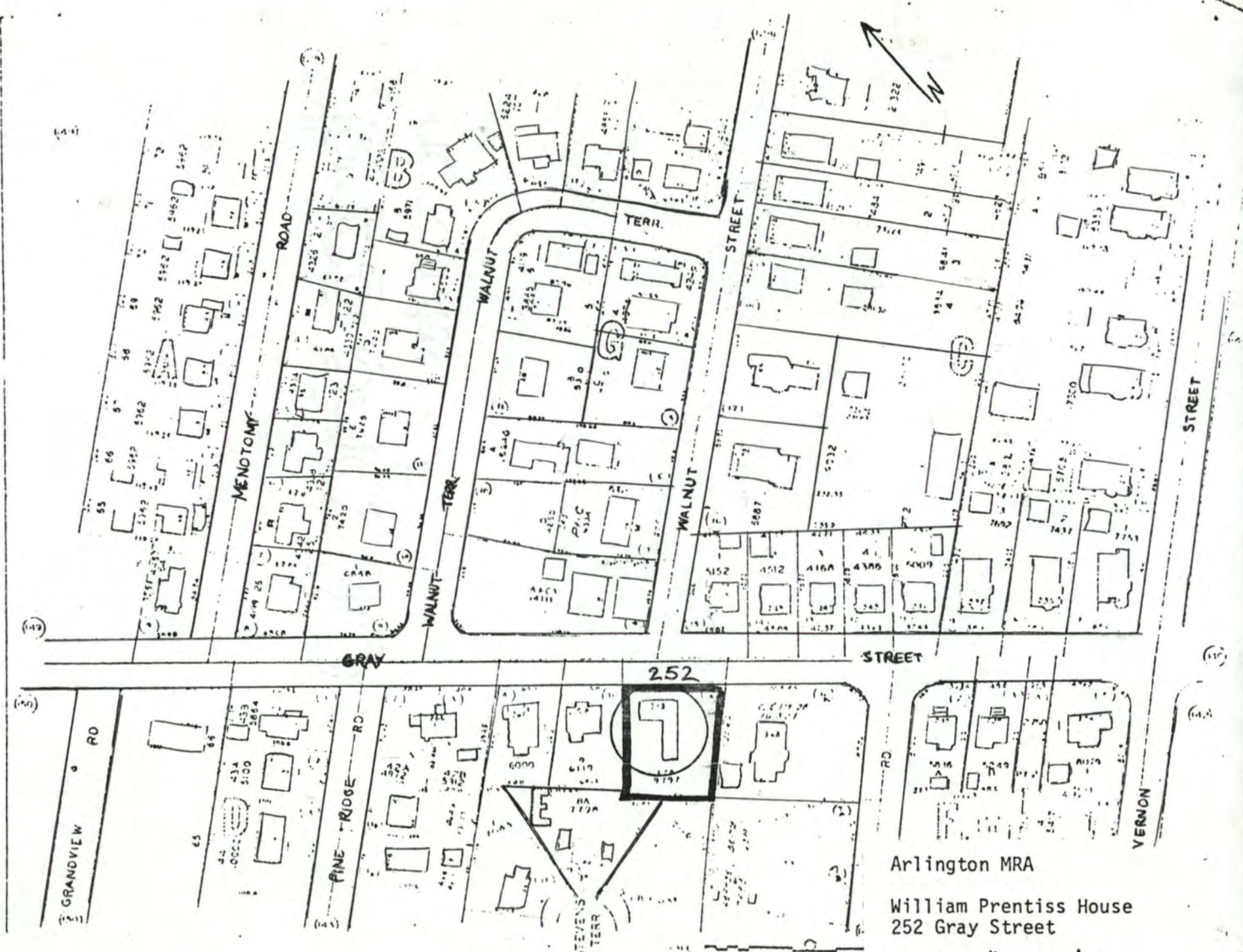

Arlington MRA
 William Prentiss House
 252 Gray Street

Scale: 1" = 120'

Block Plan #141
 Arlington Assessors Maps 1960