

MAY 23 1989

708

FORM B - BUILDING

MASSACHUSETTS HISTORICAL COMMISSION  
80 BOYLSTON STREET  
BOSTON, MA 02116

AREA

FORM NO.

C	217
---	-----

Photo (3"x3" or 3"x5", black and white) Indicate address of property on back of photo. Staple to left side of form.

Sketch Map: Draw map showing property's location in relation to nearest cross streets and/or geographical features. Indicate all buildings between inventoried property and nearest intersection(s).  
Indicate north

Town Wakefield

Address 12 West Water Street

Historic Name \_\_\_\_\_

Use: Present dwelling

Original dwelling

DESCRIPTION

Date c. 1860

Source map of 1857

Style Mansard Style

Architect NA

Exterior Wall Fabric shingles

Outbuildings none

Major Alterations (with dates) additions on south, exterior shingled (c. 1900)

Condition Good

Moved NA Date NA

Acreage Under one acre

Setting faces north on high raised lot

UTM REFERENCE 19/329800/4707370

USGS QUADRANGLE Reading, Mass.

SCALE 1:25,000

Recorded by Architectural Preservation Associates

Organization Wakefield Historical Commission

Date March 1985

**NATIONAL REGISTER CRITERIA STATEMENT (if applicable)**

The property is one of the better preserved examples of mansard-roof domestic building in Wakefield, and one of the few noted remnants of this type of house built in Wakefield's town center in the 1860s and 1870s. It retains integrity of location, setting, design, (some) materials, workmanship, feeling and association, and meets criterion C of the NRHP on the local level.

**ARCHITECTURAL SIGNIFICANCE** Describe important architectural features and evaluate in terms of other buildings within the community.

During the 1860s and into 70s there were a fairly large number of Mansard style houses and many fine public buildings in that style built in Wakefield on the west side of town. However, many have been severely altered or lost altogether. This house, though it has been shingled over, is one of the better preserved examples of the style. The slate mansard roof has its patterned surface and pedimented dormers above an eaves with paired brackets. The north facade is three bays wide, has a wide double door entry at the side and has a porch with uncommonly fine posts. The post capitals are gracefully carved acanthus leaves with bosses embellishing their bases. Paired brackets are used on the porch eaves and again on the east facade's projecting bay. Seen in the context of the nearby Wakefield mansion, Town Hall, Wakefield Block and Miller's Block, all Mansard Style buildings now gone or altered, this house was a facet of the high style

**HISTORICAL SIGNIFICANCE** Explain the role owners played in local or state history and how the building relates to the development of the community.

Wakefield town center of the 1860s.

West Water Street was not laid out until after 1830. On the map of 1857 the street appears but there are no houses on it. By 1874 Cyrus Wakefield owns all the lots on the north side of the street and on the south side, this house's side, it would appear that he had sold off the first six lots going west from Main Street and retained the rest of the south side as part of his own house's property. Wakefield is known to have built houses and to have sold them to his employees for good terms and this may be an example.

In 1874 the house was owned by George Cox who owned a billiard hall on Main Street together with William Atwell, Fr. in Walton's Block.

**BIBLIOGRAPHY and/or REFERENCES**

Middlesex County Registry of Deeds, Plan Book 13, page 46.  
Polls and Tax List 1860.  
Maps of 1874 and 1889 (G. Cox).  
Directory of 1874.

United States Department of the Interior  
National Park Service

National Register of Historic Places  
Continuation Sheet

Section number \_\_\_\_\_ Page \_\_\_\_\_

Multiple Resource Area  
Thematic Group

Name Wakefield MRA  
State Middlesex County, MASSACHUSETTS

Nomination/Type of Review

Date/Signature

21. House at 11 Wave Avenue Entered in the  
National Register

✓ Keeper Melores Byers 7/6/89

Attest \_\_\_\_\_

22. House at 11 Salem Street Entered in the  
National Register

✓ Keeper Melores Byers 7/6/89

Attest \_\_\_\_\_

23. House at 118 Greenwood Street Entered in the  
National Register

✓ Keeper Melores Byers 7/6/89

Attest \_\_\_\_\_

~~24. House at 12 West Water Street~~ Entered in the  
National Register

✓ Keeper Melores Byers 7/6/89

Attest \_\_\_\_\_

25. House at 13 Sheffield Road Entered in the  
National Register

✓ Keeper Melores Byers 7/6/89

Attest \_\_\_\_\_

26. House at 15 Chestnut Street Entered in the  
National Register

✓ Keeper Melores Byers 7/6/89

Attest \_\_\_\_\_

27. House at 15 Lawrence Avenue Entered in the  
National Register

✓ Keeper Melores Byers 7/6/89

Attest \_\_\_\_\_

28. House at 15 Wave Avenue Entered in the  
National Register

✓ Keeper Melores Byers 7/6/89

Attest \_\_\_\_\_

29. House at 18 Park Street Entered in the  
National Register

✓ Keeper Melores Byers 7/6/89

Attest \_\_\_\_\_

30. House at 18A and 20 Aborn Street Entered in the  
National Register

✓ Keeper Melores Byers 7/6/89

Attest \_\_\_\_\_

UNITED STATES DEPARTMENT OF THE INTERIOR  
NATIONAL PARK SERVICE

NATIONAL REGISTER OF HISTORIC PLACES  
EVALUATION/RETURN SHEET

REQUESTED ACTION: NOMINATION

PROPERTY NAME: House at 12 West Water Street

MULTIPLE NAME: Wakefield MRA

STATE & COUNTY: MASSACHUSETTS, Middlesex

DATE RECEIVED: 5/23/89      DATE OF PENDING LIST: 6/06/89  
DATE OF 16TH DAY: 6/22/89      DATE OF 45TH DAY: 7/07/89  
DATE OF WEEKLY LIST:

REFERENCE NUMBER: 89000708

NOMINATOR: STATE

REASONS FOR REVIEW:

APPEAL: N    DATA PROBLEM: N    LANDSCAPE: N    LESS THAN 50 YEARS: N  
OTHER: N    PDIL: N    PERIOD: N    PROGRAM UNAPPROVED: N  
REQUEST: N    SAMPLE: N    SLR DRAFT: N    NATIONAL: N

COMMENT WAIVER: N

ACCEPT     RETURN     REJECT    7/6/89 DATE

Entered in the  
National Register

ABSTRACT/SUMMARY COMMENTS:

RECOM./CRITERIA \_\_\_\_\_  
REVIEWER \_\_\_\_\_  
DISCIPLINE \_\_\_\_\_  
DATE \_\_\_\_\_

DOCUMENTATION see attached comments Y/N see attached SLR Y/N

---

CLASSIFICATION

count       resource type

---

STATE/FEDERAL AGENCY CERTIFICATION

---

FUNCTION

historic       current

---

DESCRIPTION

architectural classification  
 materials  
 descriptive text

---

SIGNIFICANCE

Period      Areas of Significance--Check and justify below

Specific dates      Builder/Architect  
Statement of Significance (in one paragraph)

summary paragraph  
 completeness  
 clarity  
 applicable criteria  
 justification of areas checked  
 relating significance to the resource  
 context  
 relationship of integrity to significance  
 justification of exception  
 other

---

BIBLIOGRAPHY

---

GEOGRAPHICAL DATA

acreage       verbal boundary description  
 UTM's       boundary justification

---

ACCOMPANYING DOCUMENTATION/PRESENTATION

sketch maps       USGS maps       photographs       presentation

---

OTHER COMMENTS

Questions concerning this nomination may be directed to

\_\_\_\_\_ Phone \_\_\_\_\_

Signed \_\_\_\_\_

Date \_\_\_\_\_



C 217

12 West Water Street.

House at

Wakefield MRA, Pa

C 217

# 12 WEST WATER ST



SCALE: 1" = 80'

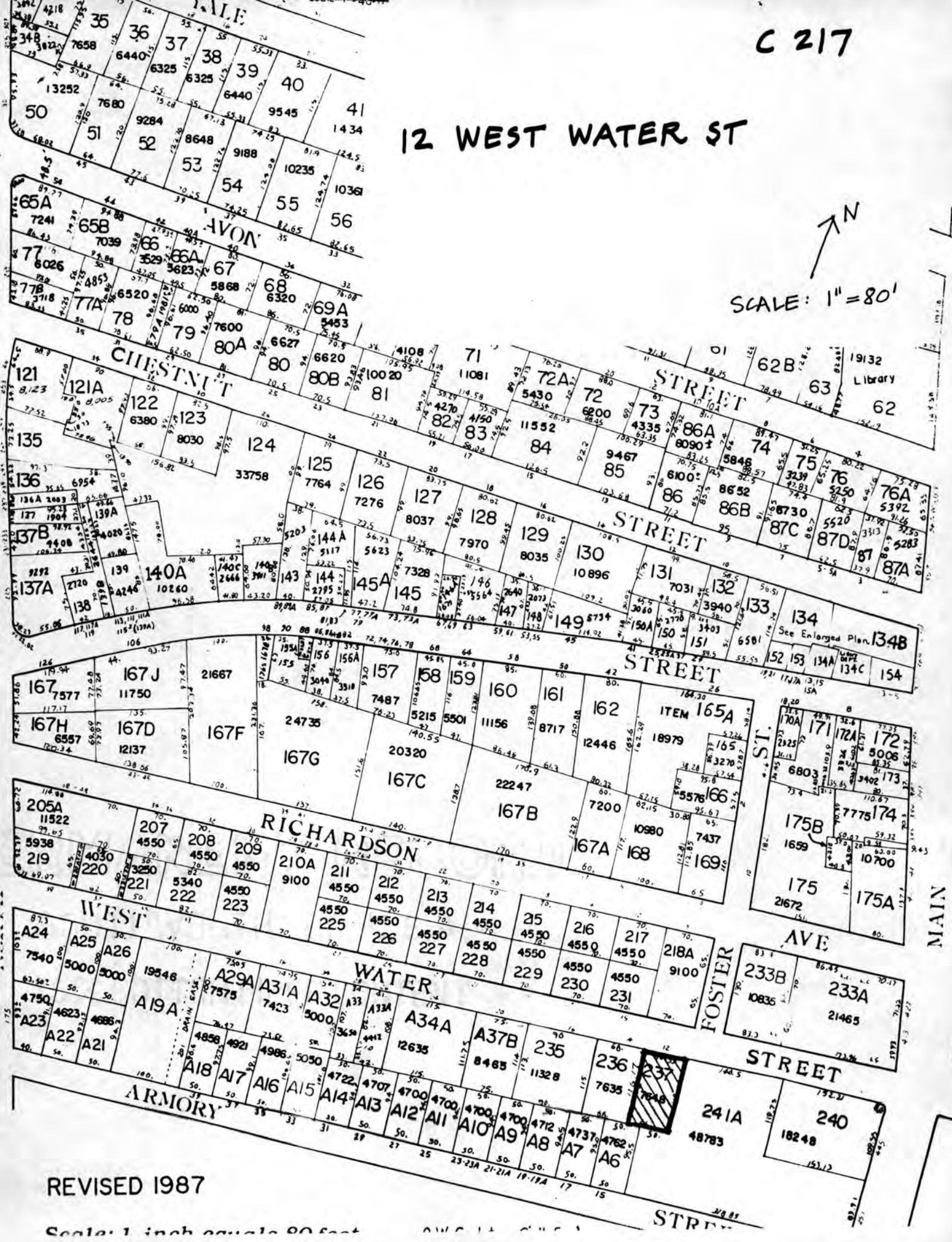

REVISED 1987

Scale: 1 inch equals 80 feet

STREET

Please refer to the map in the  
Multiple Property Cover Sheet  
for this property

Multiple Property Cover Sheet Reference Number: 64000300