

NEW JERSEY OFFICE OF CULTURAL AND ENVIRONMENTAL SERVICES

HISTORIC PRESERVATION SECTION

INDIVIDUAL STRUCTURE SURVEY FORM

HISTORIC SITES INVENTORY NO.

9713 375

HISTORIC NAME: Egbert Farm
LOCATION: 128 N. Mountain Ave.

COMMON NAME: Thomas House
BLOCK/LOT 1503/07: 24-7/67

MUNICIPALITY: Montclair
USGS QUAD: Orange

COUNTY: Essex
UTM REFERENCES:

OWNER/ADDRESS: Thomas, Vincent P. & Muriel
See above

Zone/Northing/Easting

DESCRIPTION

Construction Date: 1793
Alterations: circa 1910

Source of Date: Previous surveys

Architect: A. F. Norris (alterations)

Builder:

Style: Flemish Colonial

Form/Plan Type: Rectangular w/ ell at rear.

Number of Stories: 1½ + B

Foundation: Stone

Exterior Wall Fabric: Stone/wide clapboard side

Fenestration: 6 bays. D. H. sash 12/8 w/ shutters.

Roof/Chimneys: Gable roof/ Dutch kick/3 chimneys, 2 end & 1 interior rear.

Additional Architectural Description: Single panelled entrance door bay 4 below arched trellis work. Three hooded gable dormers w/ returns break front roof. Center dormer is smaller w/ 6/6 casement, flanking dormers recessed in roof. Bay 1 recessed back w/ paired multi-light casement w/ flanking pilasters & panels below on the first floor, 10/12 gable dormer in roof above. Single stones form lintels above 1st floor windows.

Modifications/Alterations: Most of the alterations were carried out at the same time, 1910. This includes a small wing to the rear (kitchen w/ bedroom above), back porch (now glazed) and the frame addition to the south. The dormers which break the front roof & the distinctive trellis-type hood over the front door were also added at this time. These alterations were well planned & carried out & do not detract from the character of the house.

PHOTO

Negative File No. R19, 14



Map (Indicate North)

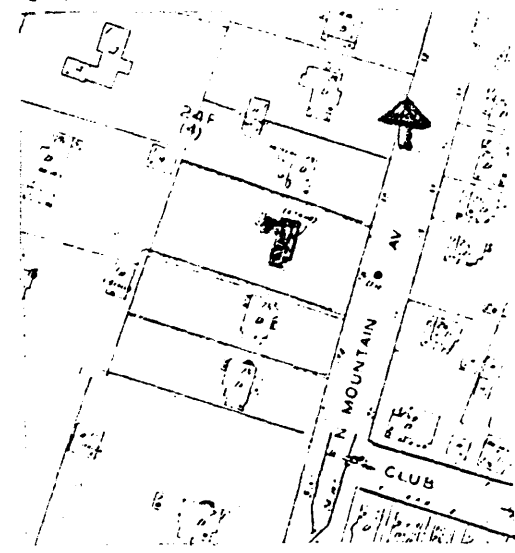

OCT 1 1986

SITING, BOUNDARY DESCRIPTION, AND RELATED STRUCTURES:

House sited on knoll in center of 105' x 210' lot, with flights of steps leading from the street. Garage built into hill slope near the south-east corner of property.

Less than one acre.

SURROUNDING ENVIRONMENT: Urban Suburban Scattered Buildings
Open Space Woodland Residential Agricultural Village
Industrial Downtown Commercial Highway Commercial Other

SIGNIFICANCE:

Known as the "Old Egbert Farm" after the first occupant, this early Montclair structure has been well documented. J. Adams, a student of architectural history from Harvard University, researched the building as part of a thesis in 1961. The Montclair Historical Society completed a form on the building in the course of their 1971 survey.

Original farm property extended from the mountain behind down the hill to Valley (Speertown Road). A stone over the doorway suggests the home was a wedding gift to a son at this time, but the evidence to support this is inconclusive. Joseph Munn purchased the home in 1836 for \$1,635.

The residence was featured in a magazine article, "The Remodeled House," by Gardner Teall, published in "American Homes and Gardens", August, 1912. The alterations were by A. F. Norris who was the architect of many fine homes in Montclair. Extensive photographs of the exterior (with "before" & "after" shots) and the interior were included. A drawing of the house appeared the next year on the cover of the same magazine.

ORIGINAL USE: Residence
PHYSICAL CONDITION: Excellent Good Fair Poor
REGISTER ELIGIBILITY: Yes Possible No Part of District
THREATS TO SITE: Roads Development Zoning Deterioration
No Threat Other

COMMENTS:

REFERENCES:

Sidney, J. C. Map of Essex County. Newark: Hiram A. Belding, 1850.

"American Homes and Gardens", Cover, January, 1913.

"A Young Farmer and His Bride," "Montclair Times," Dec. 19, 1963

RECORDED BY: Eleanor Price
ORGANIZATION: Preservation Montclair

DATE: 5/18/81