

United States Department of the Interior
National Park Service

1272
RECEIVED
JUL 17 1990
NATIONAL REGISTER

**National Register of Historic Places
Registration Form**

This form is for use in nominating or requesting determinations of eligibility for individual properties or districts. See instructions in *Guidelines for Completing National Register Forms* (National Register Bulletin 16). Complete each item by marking "x" in the appropriate box or by entering the requested information. If an item does not apply to the property being documented, enter "N/A" for "not applicable." For functions, styles, materials, and areas of significance, enter only the categories and subcategories listed in the instructions. For additional space use continuation sheets (Form 10-900a). Type all entries.

1. Name of Property

historic name B. K. Bullard House
other names/site number 8Po271

2. Location

street & number 644 South Lakeshore Boulevard n/a not for publication
city, town Lake Wales n/a vicinity
state Florida code FL county Polk code 105 zip code 33854

3. Classification

Ownership of Property	Category of Property	Number of Resources within Property	
<input checked="" type="checkbox"/> private	<input checked="" type="checkbox"/> building(s)	Contributing	Noncontributing
<input type="checkbox"/> public-local	<input type="checkbox"/> district	<u>2</u>	<u>0</u> buildings
<input type="checkbox"/> public-State	<input type="checkbox"/> site	<u> </u>	<u> </u> sites
<input type="checkbox"/> public-Federal	<input type="checkbox"/> structure	<u> </u>	<u> </u> structures
	<input type="checkbox"/> object	<u>2</u>	<u>0</u> objects
			<u>0</u> Total

Name of related multiple property listing: Lake Wales Multiple Property Group
Number of contributing resources previously listed in the National Register 0

4. State/Federal Agency Certification

As the designated authority under the National Historic Preservation Act of 1966, as amended, I hereby certify that this nomination request for determination of eligibility meets the documentation standards for registering properties in the National Register of Historic Places and meets the procedural and professional requirements set forth in 36 CFR Part 60. In my opinion, the property meets does not meet the National Register criteria. See continuation sheet.
[Signature] Date 7/11/90
Signature of certifying official
Florida State Historic Preservation Officer
State or Federal agency and bureau

In my opinion, the property meets does not meet the National Register criteria. See continuation sheet.
Signature of commenting or other official _____ Date _____
State or Federal agency and bureau _____

5. National Park Service Certification

I, hereby, certify that this property is:
 entered in the National Register.
 See continuation sheet.
 determined eligible for the National Register. See continuation sheet.
 determined not eligible for the National Register.
 removed from the National Register.
 other, (explain:)
[Signature] Date of Action 8/31/90
Signature of the Keeper Date of Action

6. Function or Use

Historic Functions (enter categories from instructions)

Domestic: Single Dwelling

Current Functions (enter categories from instructions)

Domestic: Single Dwelling

7. Description

Architectural Classification
(enter categories from instructions)

Late 19th & 20th Century Revivals:
Colonial Revival

Materials (enter categories from instructions)

foundation Concrete
walls Brick

roof Ceramic Tile
other Wood

Describe present and historic physical appearance.

PLEASE SEE CONTINUATION SHEETS

See continuation sheet

8. Statement of Significance

Certifying official has considered the significance of this property in relation to other properties:

nationally statewide locally

Applicable National Register Criteria A B C D

Criteria Considerations (Exceptions) A B C D E F G

Areas of Significance (enter categories from instructions)

Exploration/Settlement

Architecture

Significant Person

Bullard, Bernice Kennedy

Period of Significance

1914-1943

Cultural Affiliation

n/a

Significant Dates

1914

State significance of property, and justify criteria, criteria considerations, and areas and periods of significance noted above.

PLEASE SEE CONTINUATION SHEETS

See continuation sheet

9. Major Bibliographical References

- Ahl, Janyce B. Crown Jewel of the Highlands - Lake Wales, Florida. Lake Wales, 1983.
- Blumenson, John. Identifying American Architecture: A Pictorial Guide to Styles and Terms, 1600-1945. Nashville, TN, 1977.
- Kaucher, Dorothy. They Built A City. Lake Wales, FL, 1970.
- Poppeliers, John C., et al. What Style is It?: A Guide to American Architecture. Washington, D.C., 1983.

See continuation sheet

Previous documentation on file (NPS):

- preliminary determination of individual listing (36 CFR 67) has been requested
- previously listed in the National Register
- previously determined eligible by the National Register
- designated a National Historic Landmark
- recorded by Historic American Buildings Survey # _____
- recorded by Historic American Engineering Record # _____

Primary location of additional data:

- State historic preservation office
- Other State agency
- Federal agency
- Local government
- University
- Other

Specify repository: _____

10. Geographical Data

Acreeage of property Less than 1 acre

UTM References

A	<u>17</u>	<u>443140</u>	<u>3085500</u>	B			
	Zone	Easting	Northing		Zone	Easting	Northing
C				D			

See continuation sheet

Verbal Boundary Description

All that property contained in Lot 8, Block J7 of subdivision Tower View Heights in the community of Lake Wales, Polk County, Florida.

See continuation sheet

Boundary Justification

The boundary includes the entire city lot that has historically been associated with the property.

See continuation sheet

11. Form Prepared By

name/title Stephen Olausen, Barbara E. Mattick/Historic Sites Specialist

organization Bureau of Historic Preservation date July 1990

street & number R.A. Gray Blg., 500 S. Bronough Street telephone (904) 487-2333

city or town Tallahassee state Florida zip code 32399-0250

United States Department of the Interior
National Park ServiceNational Register of Historic Places
Continuation SheetSection number 7 Page 1 B.K. Bullard House, Lake Wales Multiple Property Group**SUMMARY:**

The B.K. Bullard House at 644 South Lakeshore Boulevard contributes to the Lake Wales Multiple Property Group under Associated Property Type F.2: Residential Buildings 1911-1928. Constructed in 1914 by B.K. Bullard, one of the founders of Lake Wales, the house is an excellent example of Colonial Revival Style architecture. The two-story house sits on a large, sloping lot overlooking Lake Wailes. Notable architectural features include its rectangular plan, moderately-pitched hip roof, hip roof dormer, and symmetrical facade.

PRESENT AND ORIGINAL PHYSICAL APPEARANCE:

The B.K. Bullard House is a two-story brick residential building located on a large, sloping lot overlooking Lake Wailes. The landscaped lot is dotted with palms and shrubbery. The building has a low-pitched hipped roof with boxed eaves and a central hipped dormer. The roof is surfaced with ceramic pantile.

The main (north) facade of the house features symmetrical fenestration consisting of a set of paired double-hung sash windows with 1/1 lights flanked by two single double-hung sash windows. A glass panel door with decorative sidelights and transom is located in the center of the first story. The door is flanked by two large double-hung sash windows (photo 1). A hip roofed veranda, supported by round columns on brick piers, runs the length of the front facade and wraps around the east side of the house (photo 2). The roof of the veranda also continues around the west side where it covers a porte cochere (photo 3). Other notable architectural features include two end, exterior brick chimney stacks with corbelled brick caps, an enclosed sun room with casement windows in the east bay of the veranda, and a rear cross-hip roof extension (photo 4). A contributing garage now used for storage, is located to the rear of the main house (photo 5).

The interior of the Bullard House is replete with decorative details. The main entrance leads to a central hall from which all of the rooms on the first floor are

United States Department of the Interior
National Park ServiceNational Register of Historic Places
Continuation SheetSection number 7 Page 2 B.K. Bullard House, Lake Wales Multiple Property Group

entered. At the end of the hall a split staircase leads to the second floor (photo 6). The staircase features a turned balustrade and an octagonal newel post. The doors and windows are framed with milled trim. A decorative cornice with modillions wraps around the ceiling and is supported at the corners by fluted columns (photo 7). The fireplaces have classical mantels supported by Doric columns (photo 8). The house retains an exceptional amount of its integrity; the only major change to the interior was the remodeling of an elevator bay on the first story into a bathroom.

United States Department of the Interior
National Park ServiceNational Register of Historic Places
Continuation SheetSection number 8 Page 1 B.K. Bullard House, Lake Wales Multiple Property Group**SUMMARY:**

The B.K. Bullard House at 644 South Lakeshore Boulevard is significant at the local level under Criteria A, B and C in the areas of Exploration and Settlement as the first substantial residence constructed in the fledgling community; for its association with Bernice Kennedy Bullard, one of the founders of Lake Wales; and as a good example of Colonial Revival Style architecture. The house contributes to the Lake Wales Multiple Property Group under Associated Context: **Initial Period of Development, 1911-1918** and Associated Property Type F.2: **Residential Buildings 1911-1928**.

STATEMENT OF SIGNIFICANCE:

The B.K. Bullard House was constructed in 1914 by Bernice Kennedy Bullard, one of the four founders of Lake Wales. A native of Savannah, Georgia, Bullard attended school at the Gordon Academy in Barnesville. He began his business career as a clerk with the Savannah Naval Stores Company. In 1903 he moved to Florida, where he first operated a general store in Tampa before joining with E.C. Stuart, C.L. Johnson, and G.V. Tillman to form the Sessoms Investment Company in 1906. The company purchased some 180,000 acres of land along the highlands ridge, seeking to exploit the virgin pine forests there. In 1911, a second corporation, the Lake Wales Land Company, was established to specifically deal with developing the town site of Lake Wales.

Bullard was influential in all phases of the nascent community's development. He directed all early construction projects and developed the first industry in the area, a turpentine complex. From 1915 to 1919, he served as the first president of the Lake Wales Board of Trade/Chamber of Commerce, and from 1917 to 1922 was chairman of the town council. He constructed several brick commercial buildings in Lake Wales, including the large Bullard Building located at 239-257 East Stuart Avenue in the Lake Wales Commercial Historic District. From 1922 to 1932, he served in the Florida House of Representatives.

United States Department of the Interior
National Park Service

National Register of Historic Places Continuation Sheet

Section number 8 Page 2 B.K. Bullard House, Lake Wales Multiple Property Group

The house that Bullard constructed was evidence of his optimism that the Lake Wales enterprise would ultimately prove successful. Constructed in 1914, the building is among the oldest in the community and was certainly the most grandiose of its contemporary counterparts. The house, built on a large sloping lot overlooking Lake Wailes, was constructed of brick manufactured in Bartow, the Polk County Seat, twenty miles west of Lake Wales.

The construction of the Colonial Revival house in 1914 was concurrent with the Colonial Revival Style's most significant period of application across the United States. Bullard, along with C.L. Johnson and G.V. Tillman, who constructed similar residences, chose the style to exhibit evidence to prospective settlers that Lake Wales was evolving into a solid and modern community. Bullard equipped his house with indoor plumbing, electric lights, and other modern conveniences. He lived there with his wife and four children until his death in 1943.

The Bullard House bears the hallmarks of the Colonial Revival Style, including a central entrance with a transom and sidelights and symmetry on the exterior. The interior has a typical central hall plan and elaborate woodwork. Of particular note are its fluted columns and pilasters and carved mantelpieces.

United States Department of the Interior
National Park ServiceNational Register of Historic Places
Continuation Sheet

Photographs 1 B.K. Bullard House, Lake Wales Multiple Property Group

Section number _____ Page _____

-
- 1
 - 1) B.K. Bullard House, 644 S. Lakeshore Boulevard, Lake Wales Multiple Property Group
 - 2) Lake Wales, Polk County, Florida
 - 3) Stephen Olausen
 - 4) 1989
 - 5) Historic Property Associates, St. Augustine, FL
 - 6) Main (N) facade, camera facing S
 - 7) 1 of 8
 - 2
 - 1-5) Same as for Photo 1
 - 6) E elevation, camera facing W
 - 7) 2 of 8
 - 3
 - 1-5) Same as for Photo 1
 - 6) W elevation, camera facing E
 - 7) 3 of 8
 - 4
 - 1-5) Same as for Photo 1
 - 6) Rear (S) elevation, camera facing N
 - 7) 4 of 8
 - 5
 - 1-2) Same as for Photo 1
 - 3) Max Monarch
 - 4) 1990
 - 5) Historic Property Associates, St. Augustine, FL
 - 6) N elevation, contributing garage, camera facing S
 - 7) 5 of 8
 - 6
 - 1-5) Same as for Photo 5
 - 6) Central hall and main staircase, camera facing S
 - 7) 6 of 8
 - 7
 - 1-5) Same as for Photo 5
 - 6) Detail of interior cornice and columns, camera facing SE
 - 7) 7 of 8
 - 8
 - 1-5) Same as for Photo 5
 - 6) Interior, showing mantelpiece and window and cornice treatments in living room, camera facing E
 - 7) 8 of 8

B. K. BULLARD HOUSE

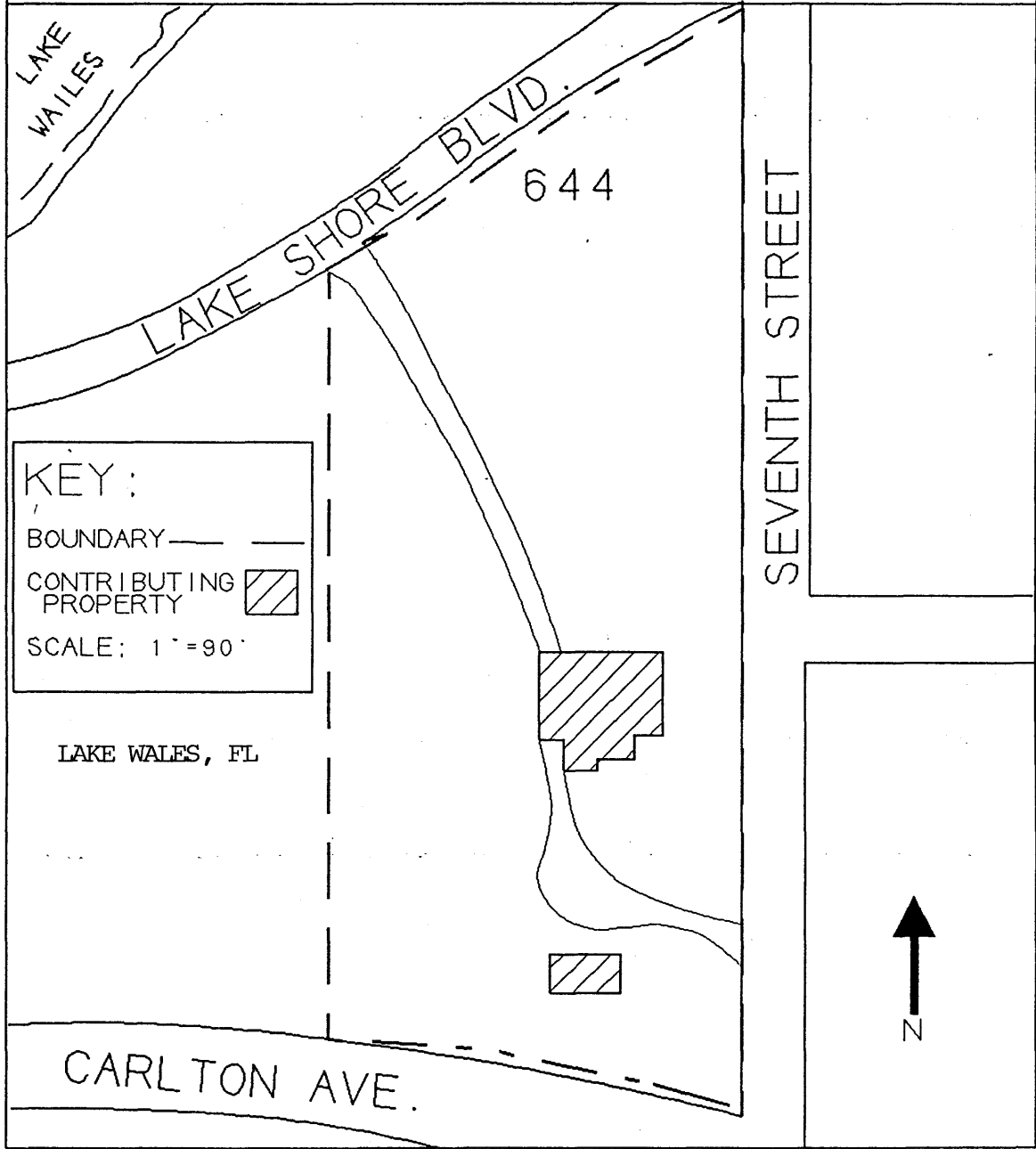

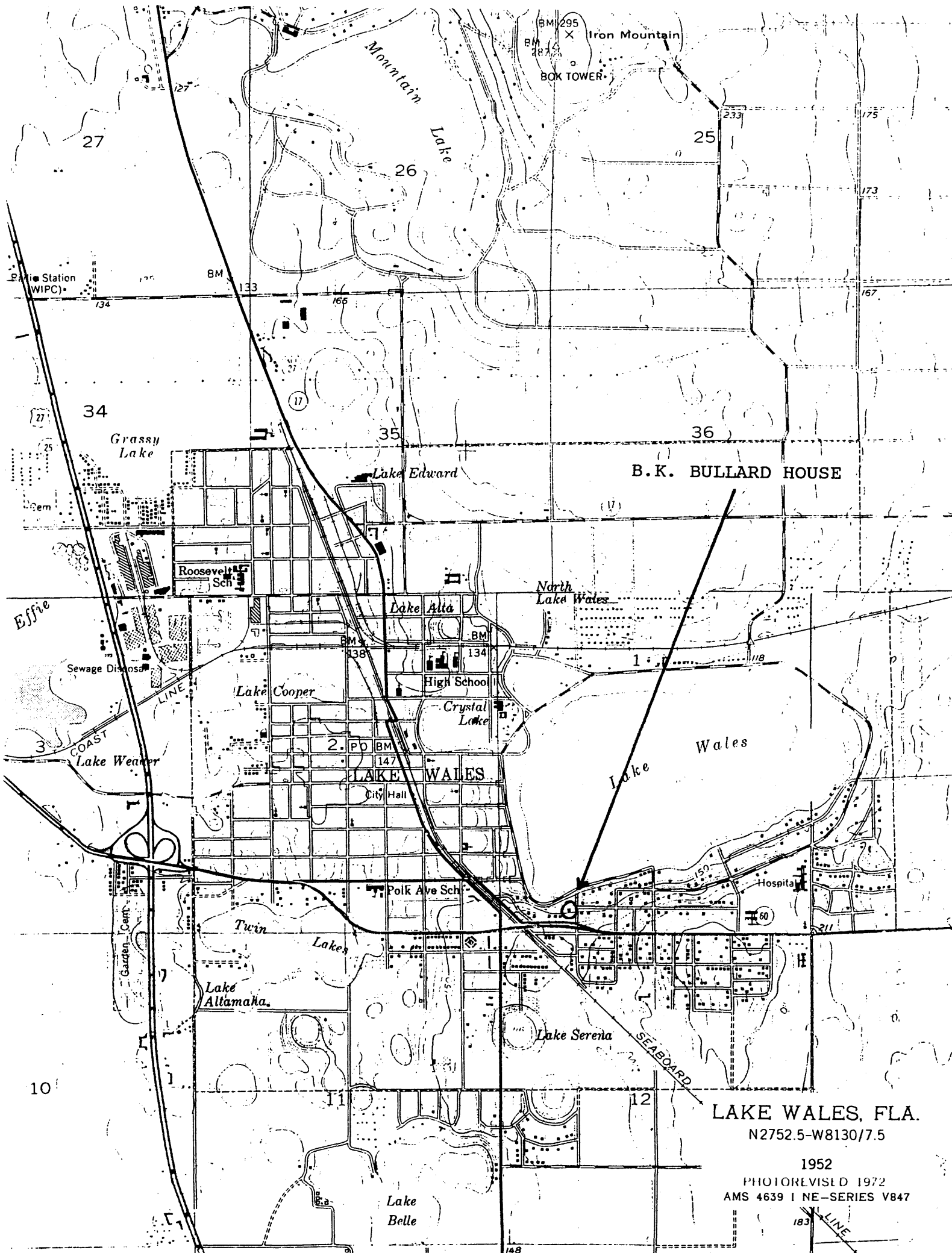

B.K. BULLARD HOUSE

LAKE WALES, FLA.
N2752.5-W8130/7.5

1952
PHOTOREVISED 1972
AMS 4639 I NE-SERIES V847

183
LINE