

United States Department of the Interior
National Park Service

National Register of Historic Places
Registration Form

NATIONAL
REGISTER

This form is for use in nominating or requesting determinations for individual properties and districts. See instructions in *How to Complete the National Register of Historic Places Registration Form* (National Register Bulletin 16A). Complete each item by marking "x" in the appropriate box or by entering the information requested. If an item does not apply to the property being documented, enter "N/A" for "not applicable." For functions, architectural classification, materials, and areas of significance, enter only categories and subcategories from the instructions. Place additional entries and narrative items on continuation sheets (NPS Form 10-900a). Use a typewriter, word processor, or computer, to complete all items.

1. Name of Property

historic name Rayville High School

other names/site number _____

2. Location

street & number 109 Madeline St. N/A not for publication

city or town Rayville N/A vicinity

state Louisiana code LA county Richland code 083 zip code 71269

3. State/Federal Agency Certification

As the designated authority under the National Historic Preservation Act, as amended, I hereby certify that this nomination request for determination of eligibility meets the documentation standards for registering properties in the National Register of Historic Places and meets the procedural and professional requirements set forth in 36 CFR Part 60. In my opinion, the property meets does not meet the National Register criteria. I recommend that this property be considered significant nationally statewide locally. (See continuation sheet for additional comments.)

Gerri Hobdy September 23, 1992
 Signature of certifying official/Title Gerri Hobdy Date
LA SHPO, Dept of Culture, Recreation and Tourism
 State of Federal agency and bureau

In my opinion, the property meets does not meet the National Register criteria. (See continuation sheet for additional comments.)

 Signature of certifying official/Title Date

 State or Federal agency and bureau

4. National Park Service Certification

I hereby certify that the property is:

- entered in the National Register. See continuation sheet.
- determined eligible for the National Register See continuation sheet.
- determined not eligible for the National Register.
- removed from the National Register.
- other, (explain: _____)

Signature of the Keeper *Belovestgen* **Entered in the National Register** Date of Action 10/29/92

Rayville High School
Name of Property

Richland Parish, LA
County and State

5. Classification

Ownership of Property
(Check as many boxes as apply)

- private
- public-local
- public-State
- public-Federal

Category of Property
(Check only one box)

- building(s)
- district
- site
- structure
- object

Number of Resources within Property
(Do not include previously listed resources in the count.)

Contributing	Noncontributing	
3		buildings
		sites
		structures
		objects
3	0	Total

Name of related multiple property listing
(Enter "N/A" if property is not part of a multiple property listing.)

N/A

Number of contributing resources previously listed in the National Register

0

6. Function or Use

Historic Functions
(Enter categories from instructions)

EDUCATION/school

Current Functions
(Enter categories from instructions)

VACANT/not in use

7. Description

Architectural Classification
(Enter categories from instructions)

Classical Revival

Materials
(Enter categories from instructions)

foundation concrete

walls brick

roof other: tar and gravel

other concrete

Narrative Description

(Describe the historic and current condition of the property on one or more continuation sheets.)

**United States Department of the Interior
National Park Service****National Register of Historic Places
Continuation Sheet**

Rayville High School, Richland Parish, LA

Section number 7 Page 1

The Rayville High School (1930) is a three story brick neo-classical building with cast concrete details located on the edge of the town's old central business district. There are two contributing support buildings, a gym and superintendent's office. The boundaries were drawn to exclude two adjacent non-historic support buildings. Despite exterior additions and the loss of its original cupola, the Rayville High School retains its National Register eligibility as a major architectural landmark in Rayville.

The otherwise basically plain building culminates in a neo-classical three bay central section that projects slightly. Its lower story is cast concrete as are the decorative details. The bays are defined by prominent Ionic pilasters. The central opening on the second story is a handsome round arch window with the muntins forming a tracery pattern. The use of a tower, in this case crowning the central section, is certainly not typical of the neo-classical style. Instead, it reminds one of the towers found above the parapet on Elizabethan country houses. The relatively small tower is richly ornamented in the neo-classical taste, including a round arch opening on each elevation accented with a keystone and impost blocks, pilasters with entablature blocks featuring sunbursts, and sunburst panels in the parapet. The front corners are defined by curving elements suggestive of volutes. The tower originally had a cupola. This feature was removed in the early 1950s.

The front entrance to the school is also elaborately detailed. Its bays are framed by Ionic pilasters with egg and dart molding. The entablature features a richly molded cornice, a dentil band and Chinese Chippendale fretwork in the frieze. Entablature blocks above the pilasters are accented with ovals. The transoms take the form of arcaded windows supported by reeded colonnettes. There is also a band of reeding below.

As originally built, the building's end sections, which are recessed, were only two stories. A third story was added c.1960. Other noteworthy exterior details include cast concrete belt courses below the first and second floor windows and one forming the architrave; bricks laid vertically above the windows and accented with a keystone (suggestive of a jack arch); and a cast concrete fountain with a shell pattern on each end of the building.

On the interior are plain classrooms of the period, featuring transoms above the doors and interior windows for ventilation. The only noteworthy interior space is a small entrance vestibule with a semicircular bay on each end and a Doric frieze. The building does not have an auditorium because there was one available at the nearby elementary school. A central staircase ascends from the lobby to the second floor. Corner staircases provide access to the third floor. Interior modifications have been minimal, consisting chiefly of the subdivision of three of the large rooms located at the ends of the building. (The dividing walls are identical to the original.)

CONTINUED

United States Department of the Interior
National Park Service

National Register of Historic Places Continuation Sheet

Rayville High School, Richland Parish, LA
Section number 7 Page 2

Assessment of Integrity:

While the loss of the cupola and the addition of a third story to the end sections have obviously impacted the architect's overall design, these changes are not serious enough to threaten the building's Register eligibility. Even with these modifications, the high school is a major architectural landmark within Rayville. Its architectural distinction lies with the neo-classical central pavilion, which is intact except for the cupola.

Contributing Elements:

To the rear of the high school, and connected to it by original covered walkways, is the contemporaneous gym. The building has gable parapet end walls and round arch windows accented with keystones and impost blocks. It was increased in size by about 40% in the early 1950s, duplicating the original brick and detailing. But for a faint line in the brickwork, one would never know. Also, an addition has been made to each of the building's original small one story wings. Because the gym is contemporaneous with the high school and the addition replicated the style of the original portion, the gym is being counted as a contributing element.

On the west side of the school is a 1938 brick bungalow-looking cottage known as the Superintendent's Office. It is identified on Sanborn Insurance Maps as "classroom and office." Because it is roughly contemporaneous with the high school and an integral part of the property's educational history, it is being listed as a contributing element.

8. Statement of Significance

Applicable National Register Criteria

(Mark "x" in one or more boxes for the criteria qualifying the property for National Register listing.)

- A** Property is associated with events that have made a significant contribution to the broad patterns of our history.
- B** Property is associated with the lives of persons significant in our past.
- C** Property embodies the distinctive characteristics of a type, period, or method of construction or represents the work of a master, or possesses high artistic values, or represents a significant and distinguishable entity whose components lack individual distinction.
- D** Property has yielded, or is likely to yield, information important in prehistory or history.

Criteria Considerations N/A
(Mark "x" in all the boxes that apply.)

Property is:

- A** owned by a religious institution or used for religious purposes.
- B** removed from its original location.
- C** a birthplace or grave.
- D** a cemetery.
- E** a reconstructed building, object, or structure.
- F** a commemorative property.
- G** less than 50 years of age or achieved significance within the past 50 years.

Narrative Statement of Significance

(Explain the significance of the property on one or more continuation sheets.)

9. Major Bibliographical References

Bibliography

(Cite the books, articles, and other sources used in preparing this form on one or more continuation sheets.)

Previous documentation on file (NPS): N/A

- preliminary determination of individual listing (36 CFR 67) has been requested
- previously listed in the National Register
- previously determined eligible by the National Register
- designated a National Historic Landmark
- recorded by Historic American Buildings Survey # _____
- recorded by Historic American Engineering Record # _____

Areas of Significance

(Enter categories from instructions)

architecture

Period of Significance

1930

Significant Dates

1930

Significant Person

(Complete if Criterion B is marked above)

N/A

Cultural Affiliation

N/A

Architect/Builder

Architect: Edward F. Neild

Primary location of additional data:

- State Historic Preservation Office
- Other State agency
- Federal agency
- Local government
- University
- Other

Name of repository:

Rayville High School
Name of Property

Richland Parish, LA
County and State

10. Geographical Data

Acreage of Property @ 1 acre

UTM References

(Place additional UTM references on a continuation sheet.)

1

1	5
---	---

6	1	6	8	2	0
---	---	---	---	---	---

3	5	9	3	6	8	0
---	---	---	---	---	---	---

Zone Easting Northing

3

--	--

--	--	--	--	--	--

--	--	--	--	--	--	--	--

Zone Easting Northing

See continuation sheet

Verbal Boundary Description

(Describe the boundaries of the property on a continuation sheet.)

Please refer to sketch map.

Boundary Justification

(Explain why the boundaries were selected on a continuation sheet.)

11. Form Prepared By

name/title National Register Staff

organization Division of Historic Preservation date June 1992

street & number P. O. Box 44247 telephone (504) 342-8160

city or town Baton Rouge state Louisiana zip code 70804

Additional Documentation

Submit the following items with the completed form:

Continuation Sheets

Maps

A **USGS map** (7.5 or 15 minute series) indicating the property's location.

A **Sketch map** for historic districts and properties having large acreage or numerous resources.

Photographs

Representative **black and white photographs** of the property.

Additional items

(Check with the SHPO or FPO for any additional items)

Property Owner

(Complete this item at the request of SHPO or FPO.)

name Richland Parish School Board

street & number P. O. Box 599 telephone _____

city or town Rayville state Louisiana zip code 71269

Paperwork Reduction Act Statement: This information is being collected for applications to the National Register of Historic Places to nominate properties for listing or determine eligibility for listing, to list properties, and to amend existing listings. Response to this request is required to obtain a benefit in accordance with the National Historic Preservation Act, as amended (16 U.S.C. 470 et seq.).

Estimated Burden Statement: Public reporting burden for this form is estimated to average 18.1 hours per response including time for reviewing instructions, gathering and maintaining data, and completing and reviewing the form. Direct comments regarding this burden estimate or any aspect of this form to the Chief, Administrative Services Division, National Park Service, P.O. Box 37127, Washington, DC 20013-7127; and the Office of Management and Budget, Paperwork Reductions Projects (1024-0018), Washington, DC 20503.

United States Department of the Interior
National Park Service

National Register of Historic Places Continuation Sheet

Rayville High School, Richland Parish, LA

Section number 8 Page 1

The Rayville High School is locally significant in the area of architecture as a major landmark in the town's historic building stock.

Although the parish seat of Rayville (population @4000) has not been surveyed, the staff of the Division of Historic Preservation is familiar with its historic buildings. The vast majority of them are twentieth century, with a small minority being late nineteenth. With but very few exceptions, Rayville's historic buildings are either unstyled or very generic, low-key examples of their style. The latter include simple Queen Anne cottages and bungalows and commercial buildings with a hint of the Italianate in their shallow arched windows.

Against the background of this largely undistinguished patrimony, the large, neo-classical Rayville High School is an obvious landmark. It is one of a handful of "high style" buildings in the community and one of extremely few that are architect designed. Within the context of Rayville, its central pavilion, complete with a tower, is quite a grand architectural statement.

**United States Department of the Interior
National Park Service**

**National Register of Historic Places
Continuation Sheet**

Rayville High School, Richland Parish, LA

Section number 9 Page 1

Building plans, Edward F. Neild, Architect.

Sanborn Insurance Maps, 1927, 1944.

Interview with Kermit Lamar Walters, long-time Assistant Superintendent of Education,
Richland Parish.

**United States Department of the Interior
National Park Service**

National Register of Historic Places Continuation Sheet

Rayville High School, Richland Parish, LA

Section number 10 Page 1

Boundary Justification

Boundaries were chosen to encompass the high school and its two contributing support buildings. They follow curblines to the north and west and the property line to the south (rear). The eastern boundary is irregular and cuts close to the nominated buildings in order to exclude adjacent less than fifty year old buildings on the school grounds.

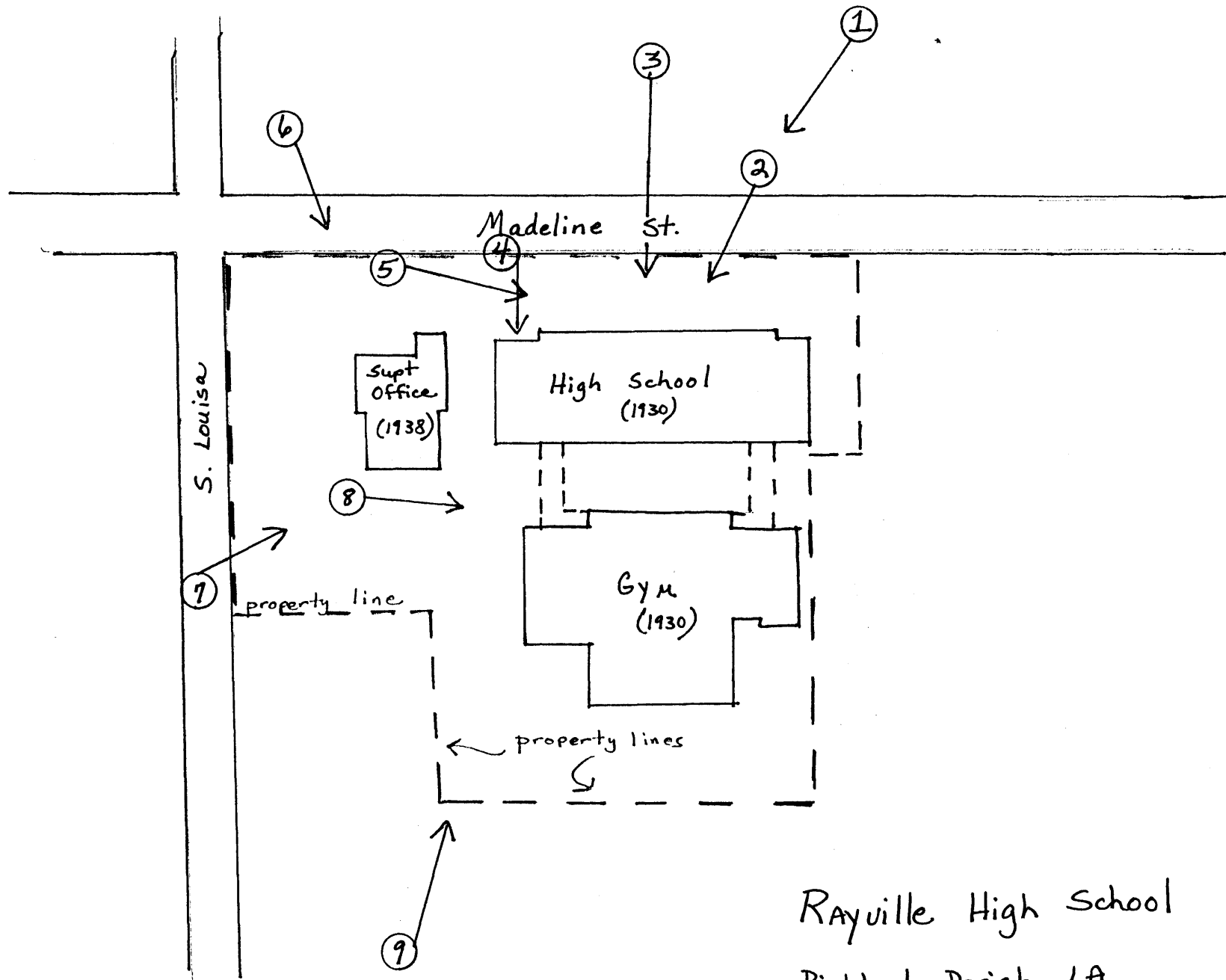

Rayville High School
 Richland Parish, LA

Scale: 1" = 60'

--- BOUNDARY

