

**United States Department of the Interior  
National Park Service**

**National Register of Historic Places  
Inventory—Nomination Form**

For NPS use only  
received **JUN 23 1983**  
date entered

See instructions in *How to Complete National Register Forms*  
Type all entries—complete applicable sections

**1. Name**

historic Munn's School

and/or common Munn's School

**2. Location**

street & number Princeton Road, (Kentucky 70)<sup>e</sup> not for publication

city, town Madisonville *vic.*  vicinity of

state Kentucky code county Hopkins code

**3. Classification**

Category	Ownership	Status	Present Use	
<input type="checkbox"/> district	<input type="checkbox"/> public	<input type="checkbox"/> occupied	<input type="checkbox"/> agriculture	<input type="checkbox"/> museum
<input checked="" type="checkbox"/> building(s)	<input checked="" type="checkbox"/> private	<input checked="" type="checkbox"/> unoccupied	<input type="checkbox"/> commercial	<input type="checkbox"/> park
<input type="checkbox"/> structure	<input type="checkbox"/> both	<input type="checkbox"/> work in progress	<input type="checkbox"/> educational	<input type="checkbox"/> private residence
<input type="checkbox"/> site	<b>Public Acquisition</b>	<b>Accessible</b>	<input type="checkbox"/> entertainment	<input type="checkbox"/> religious
<input type="checkbox"/> object	<input type="checkbox"/> <u>na</u> in process	<input checked="" type="checkbox"/> yes: restricted	<input type="checkbox"/> government	<input type="checkbox"/> scientific
	<input type="checkbox"/> <u>na</u> being considered	<input type="checkbox"/> yes: unrestricted	<input type="checkbox"/> industrial	<input type="checkbox"/> transportation
		<input type="checkbox"/> no	<input type="checkbox"/> military	<input checked="" type="checkbox"/> other: Vacant

**4. Owner of Property**

name Pennyrile Arts & Crafts Guild

street & number 1805 Forest Acres

city, town Madisonville vicinity of state Kentucky

**5. Location of Legal Description**

courthouse, registry of deeds, etc. Hopkins County Courthouse

street & number Main Street

city, town Madisonville state Kentucky

**6. Representation in Existing Surveys**

title Survey of Historic Sites in Kentucky has this property been determined eligible?  yes  no

date 1971  federal  state  county  local

depository for survey records Kentucky Heritage Council

city, town Frankfort state Kentucky

# 7. Description

**Condition**  
 excellent     deteriorated    **Check one**  unaltered    **Check one**  original site  
 good     ruins     altered     moved    date \_\_\_\_\_  
 fair     unexposed

## Describe the present and original (if known) physical appearance

Munn's School is located in a rural setting approximately 2.5 miles west of Madisonville on the Madisonville-Princeton Road (Kentucky Route 70). Munn's School is the only surviving one-room school of the 102 which were used by the Hopkins County school system at one time. Munn's School was the only brick one room school built in Hopkins County.

This the third Munn School was constructed in 1906 on the site of an earlier frame school house and across the highway from the first Munn School. It served as a public school from 1906 until 1955. A second classroom of frame construction was added in 1928. The main block of the Munn School is a one-story gabled roof, building of brick construction. Approximately 25' X 40', the building is entered through a recessed segmentally arched opening in the center of the gable end (photo 1). On either side of the entry space are small cloak rooms which are entered from the classrooms (photo 2). Light is provided by four 4 over 4 segmental arched windows on both sides of the long walls. The ceiling and end walls are utilize tongue and groove while the other walls are plastered.

The original rear door now serves as the entrance to the frame second classroom which was added at right angles to the main block in 1928 (photo 3). The frame classroom has the same dimensions as the original room except that the cloakrooms are wider because space was not required for an entry between them. The outside entrance is placed on the side of the classroom in order to provide direct access from the highway (photo 3). The light is provided by three double 4 over 4 windows. In the frame addition the cloak rooms have windows, a design improvement over the brick classroom.

A new metal roof has been added recently as the first phase in a planned rehabilitation project by the Pennyriple Arts and Crafts Guild which will utilize the building as a community center. No other outbuildings associated with the school survive.

# 8. Significance

Period	Areas of Significance—Check and justify below			
<input type="checkbox"/> prehistoric	<input type="checkbox"/> archeology-prehistoric	<input type="checkbox"/> community planning	<input type="checkbox"/> landscape architecture	<input type="checkbox"/> religion
<input type="checkbox"/> 1400–1499	<input type="checkbox"/> archeology-historic	<input type="checkbox"/> conservation	<input type="checkbox"/> law	<input type="checkbox"/> science
<input type="checkbox"/> 1500–1599	<input type="checkbox"/> agriculture	<input type="checkbox"/> economics	<input type="checkbox"/> literature	<input type="checkbox"/> sculpture
<input type="checkbox"/> 1600–1699	<input type="checkbox"/> architecture	<input checked="" type="checkbox"/> education	<input type="checkbox"/> military	<input type="checkbox"/> social/ humanitarian
<input type="checkbox"/> 1700–1799	<input type="checkbox"/> art	<input type="checkbox"/> engineering	<input type="checkbox"/> music	<input type="checkbox"/> theater
<input type="checkbox"/> 1800–1899	<input type="checkbox"/> commerce	<input type="checkbox"/> exploration/settlement	<input type="checkbox"/> philosophy	<input type="checkbox"/> transportation
<input checked="" type="checkbox"/> 1900–	<input type="checkbox"/> communications	<input type="checkbox"/> industry	<input type="checkbox"/> politics/government	<input type="checkbox"/> other (specify)
		<input type="checkbox"/> invention		

**Specific dates** 1906, 1928

**Builder/Architect**

### Statement of Significance (in one paragraph)

Munn's School is significant as the only surviving building from an important period in the development of the public school system in Hopkins County and West Kentucky.

Prior to the development of adequate transportation facilities, public education was most readily provided by constructing one room schools in the small towns and rural areas. In counties with large areas and widely dispersed populations like Hopkins County where numerous towns and villages associated with coal mining had appeared by 1900, the use of one room schools was a logical decision.

As was the case with most of the one and two roomed schools, Munn's School also served as a community center for the local populace. Residents of the Pleasant Grove, Pleasant View, Richland, Nebo and Manitou communities used the building for church services, community entertainment, Boy Scout and 4-H Club meetings, wedding, showers, parties, etc.

## 9. Major Bibliographical References

Brown, Mrs. P.G., "Personal Communication."  
Brown, Steve, "Personal Communication."  
Hopkins County Board of Education, General Records.  
Hopkins County Deed Book 25, page 501.  
Hopkins County Deed Book 51, page 288.

## 10. Geographical Data

Acreeage of nominated property less than 1 acre

Quadrangle name Madisonville West, Ky.

Quadrangle scale 1:24000

### UTM References

A 

1	6	4	5	3	0	4	0	4	1	2	9	7	5	0
Zone		Easting				Northing								

B 

Zone		Easting				Northing								

C 

Zone		Easting				Northing								

D 

Zone		Easting				Northing								

E 

Zone		Easting				Northing								

F 

Zone		Easting				Northing								

G 

Zone		Easting				Northing								

H 

Zone		Easting				Northing								

### Verbal boundary description and justification

See Attached Boundary Form

### List all states and counties for properties overlapping state or county boundaries

state	code	county	code
-------	------	--------	------

state	code	county	code
-------	------	--------	------

## 11. Form Prepared By

name/title Steve Brown, Pennyriple Arts & Crafts Guild  
Robert M. Polsgrove, Historic Sites Program Manager

organization Kentucky Heritage Council date June, 1983

street & number 9th Floor, Capital Plaza Tower telephone 564-7005

city or town Frankfort state Kentucky

## 12. State Historic Preservation Officer Certification

The evaluated significance of this property within the state is:

national  state  local

As the designated State Historic Preservation Officer for the National Historic Preservation Act of 1966 (Public Law 89-665), I hereby nominate this property for inclusion in the National Register and certify that it has been evaluated according to the criteria and procedures set forth by the National Park Service.

State Historic Preservation Officer signature Mary Ann Appel

title State Historic Preservation Officer date June 28, 1983

For NPS use only

I hereby certify that this property is included in the National Register

J. Melrose Byers  
Keeper of the National Register

Entered in the  
National Register

date 8/30/83

Attest:

date

Chief of Registration

**United States Department of the Interior  
National Park Service**

**National Register of Historic Places  
Inventory—Nomination Form**

For NPS use only  
received 4/23/87  
date entered

Munn's School  
Continuation sheet Hopkins County, Kentucky Item number 9 Page 2

---

Stone, William B., "Personal Communication" with Steve Brown.  
Todd, Mrs. Ernest, "Personal Communication" with Steve Brown.

KENTUCKY HISTORIC RESOURCE INVENTORY SUPPLEMENT  
BOUNDARY AND LOCATION INFORMATION

Historic Property Name Munn's School Site # HK-41

Multiple Resource/Thematic Nomination Title N/A

U.T.M. Coordinates - List multiple UTM's if property is ten or more acres.

A. See National Register Nomination D. \_\_\_\_\_

B. \_\_\_\_\_ E. \_\_\_\_\_

C. \_\_\_\_\_ F. \_\_\_\_\_

Verbal Boundary Description Acreage 1.3 Acres

Beginning at a markerstone approximately 110' southeast of the School, proceed 310 ft in a southwesterly direction along the right of way of KY Highway 70 (Princeton Road), thence north 180 feet, thence northeast 310 feet, thence south 180 feet to the markerstone at the point of origin. The Munn's school property includes two adjacent lots. The school is located on the more easterly lot which was acquired in 1879. The additional lot which is an area 180 ft. by 130 ft. was acquired in 1914. The Munn School is the only building located in the nominated acreage.

Sketch of Site Plan (Showing outbuildings, structures, landscape features and the site boundary as described above.)

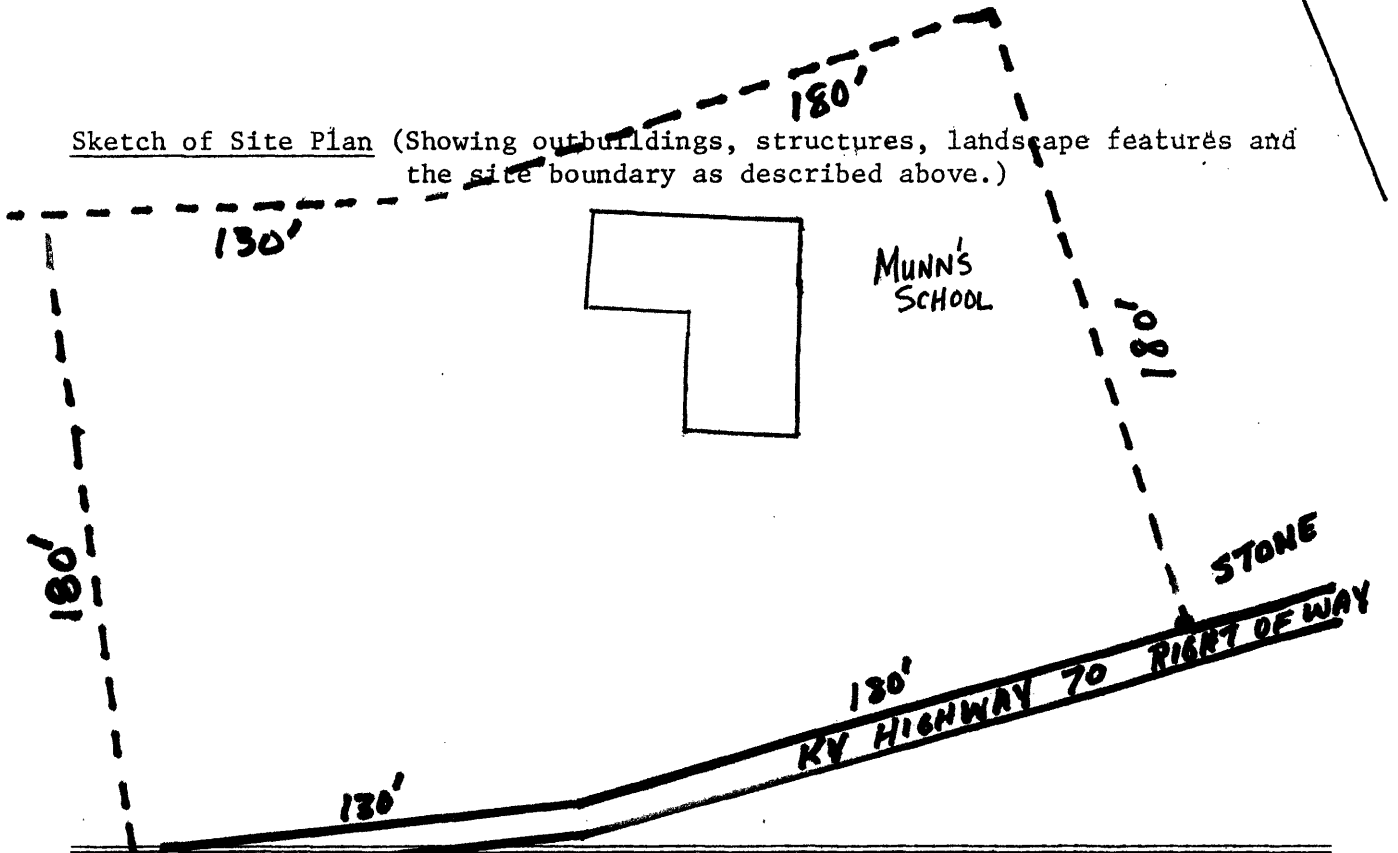

Official Courthouse Property Reference: